

EXISTING PARTITION ASSEMBLIES:

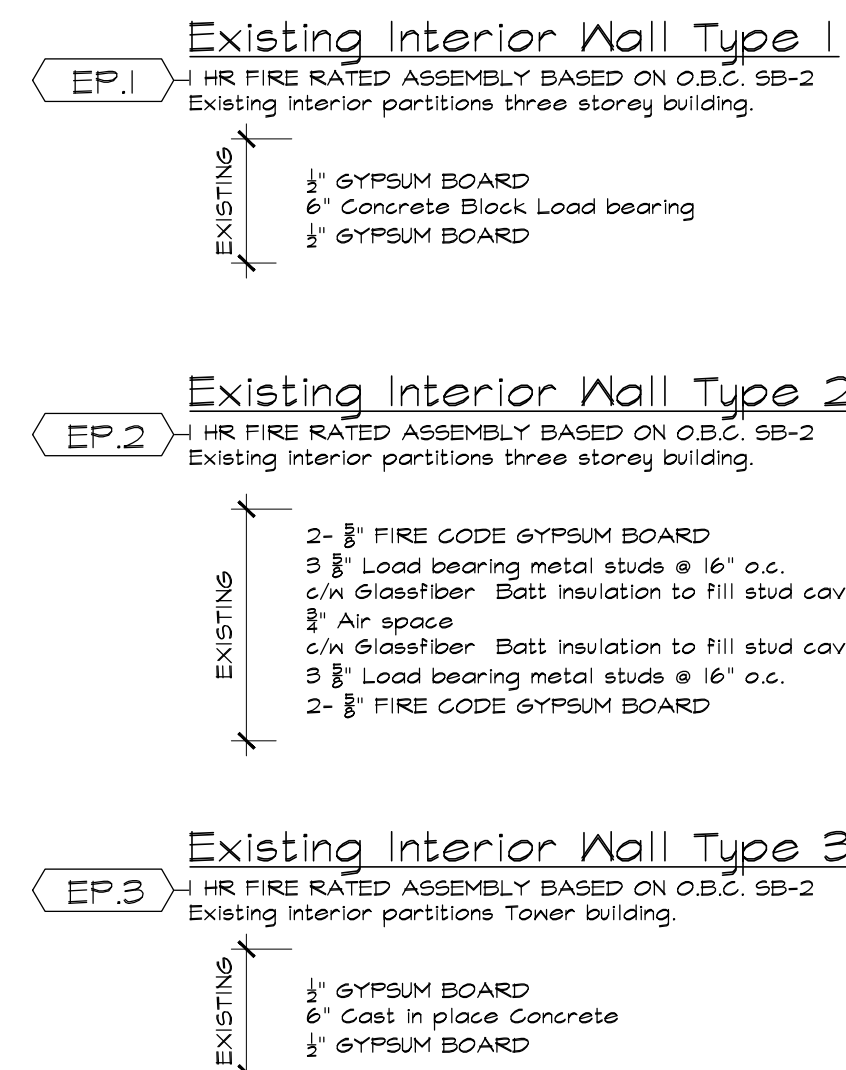

EXISTING FLOOR ASSEMBLIES:

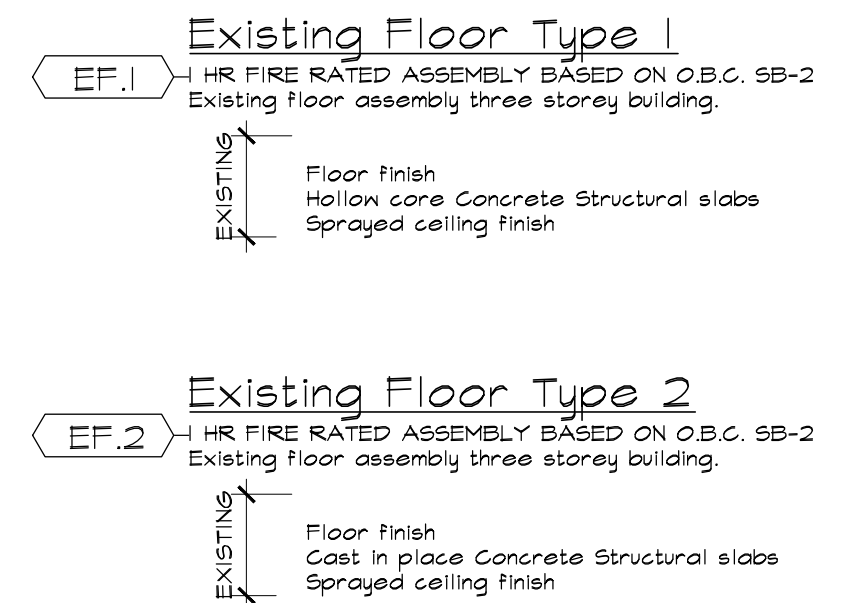

GRAB BARS
 BARRIER FREE WASHROOM ELEVATIONS
 SCALE: n.t.s.

FLOOR & ROOF ASSEMBLIES:

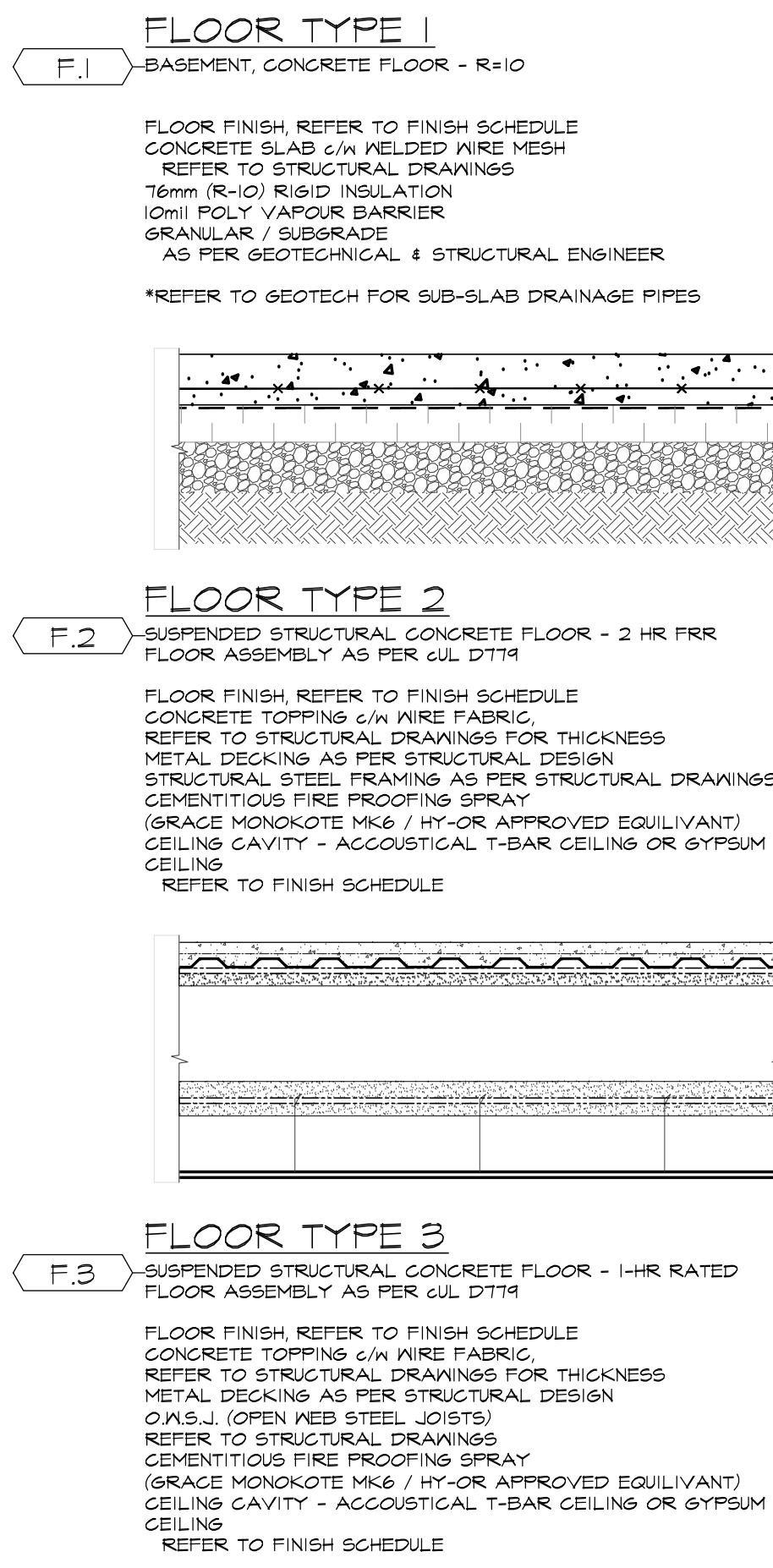

DISPENSERS
COAT HOOK

ROOF ASSEMBLIES:

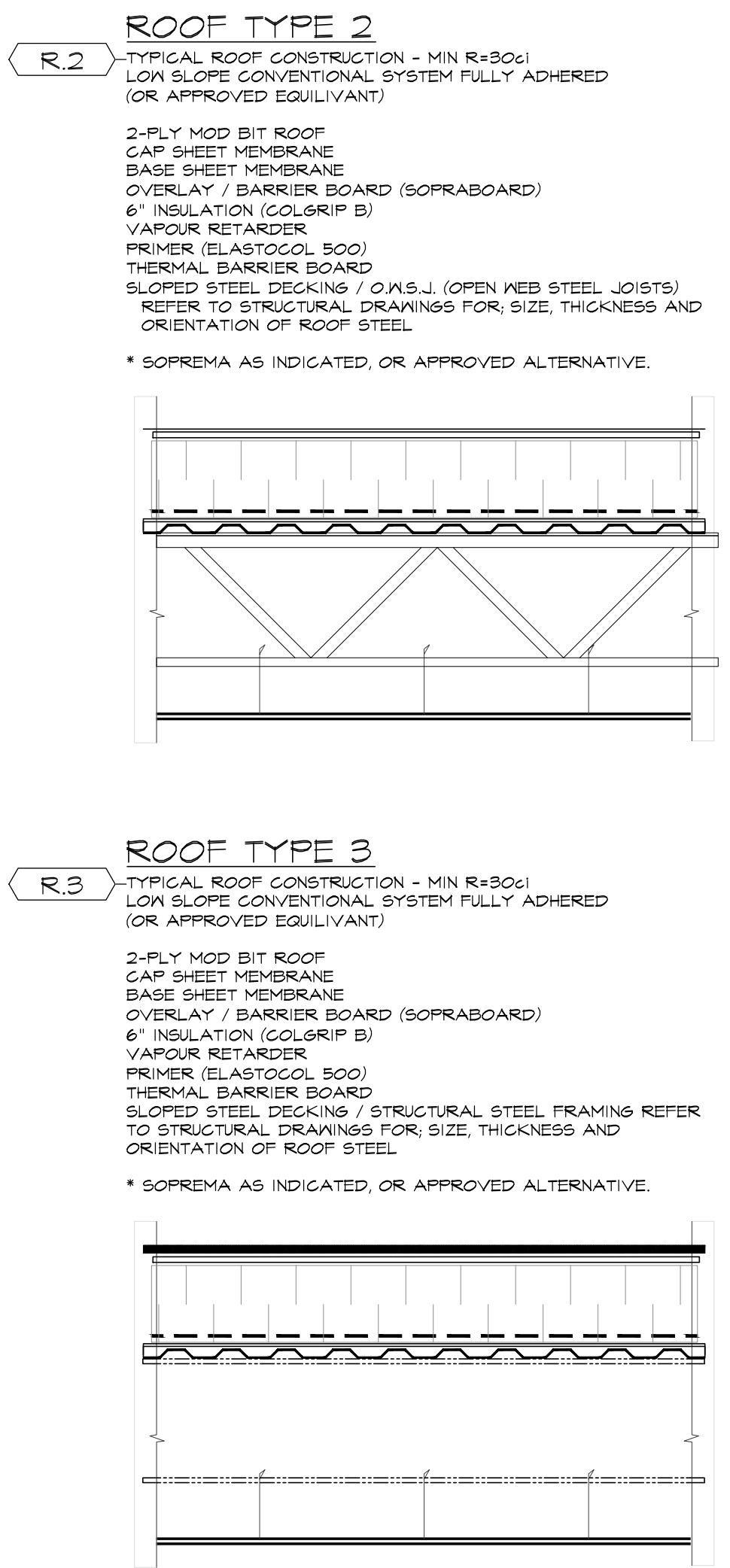

TOILET ELEVATIONS

PARTITION ASSEMBLIES:

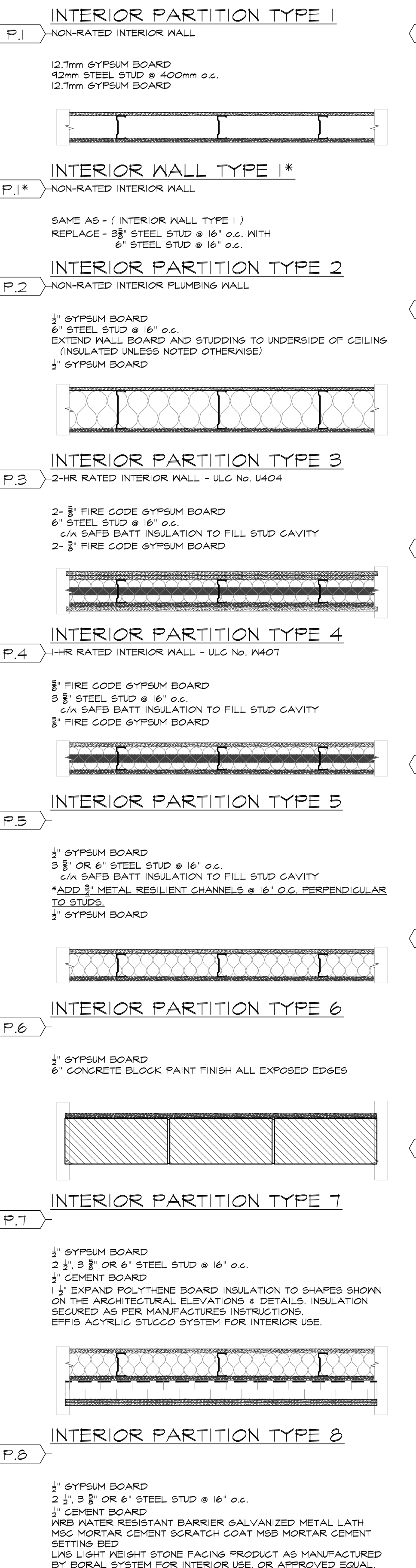

BEAM F.R.R. TYPE 1
BEAM F.R.R. TYPE 2

INTERIOR PARTITION TYPE 9

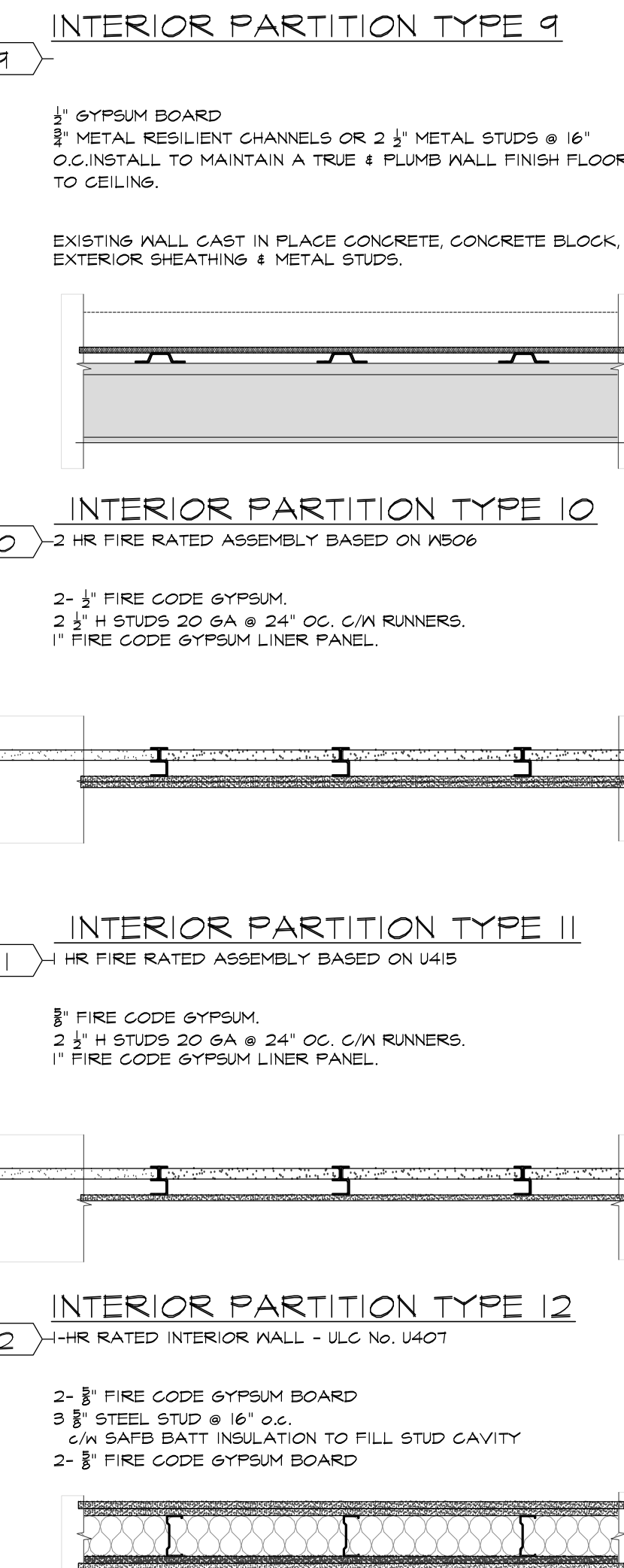

BEAM F.R.R. TYPE 1
BEAM F.R.R. TYPE 2

ROOF PARAPET ASSEMBLIES:

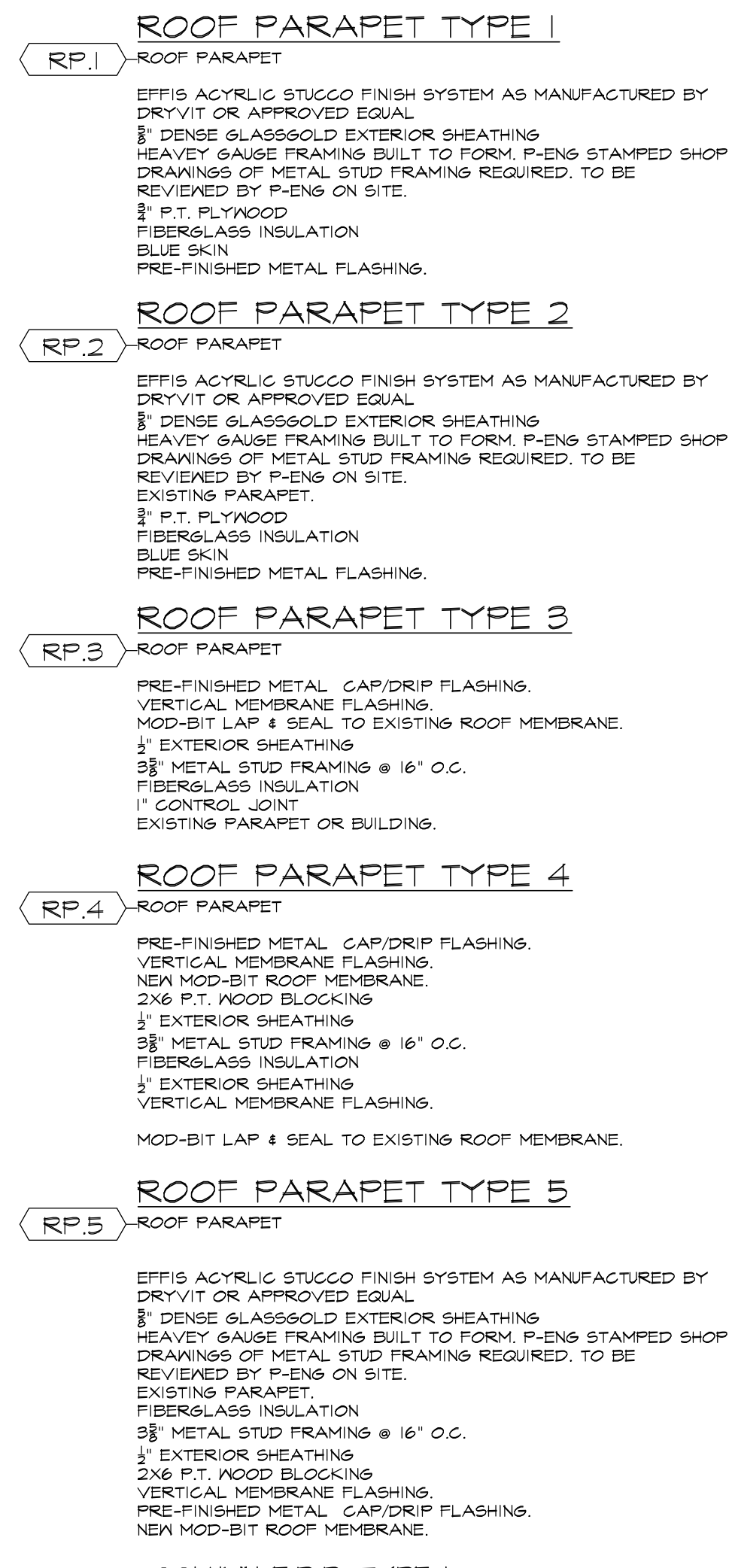

COLUMN F.R.R. TYPE 1
COLUMN F.R.R. TYPE 2
COLUMN F.R.R. TYPE 3

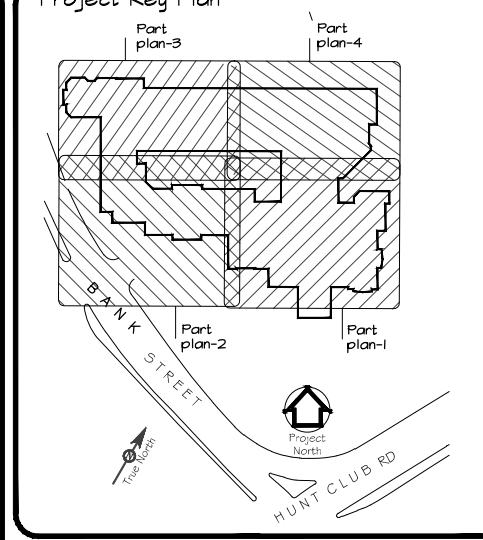

NOTES:

- 1) ALL WORK TO BE IN COMPLIANCE WITH LOCAL BUILDING CODES, REGULATIONS AND BYLAWS.
- 2) ADDITIONAL DRAWINGS MAY BE ISSUED FOR CLARIFICATION TO ASSIST PROPER EXECUTION OF WORK. SUCH DRAWINGS WILL HAVE THE SAME MEANING AND INTENT AS IF THEY WERE INCLUDED WITH PLANS IN CONTRACT DOCUMENTS.
- 3) DO NOT SCALE DRAWINGS.
- 4) ALL SUB-CONTRACTORS TO TAKE THEIR OWN ON-SITE MEASUREMENTS AND BE RESPONSIBLE FOR THEIR ACCURACY. THESE DRAWINGS ARE ONLY A GRAPHIC REPRESENTATION OF WHAT THE FINAL COMPLETED WORK SHALL LOOK LIKE.
- 5) NOTIFY SHAWN J. LAWRENCE ARCHITECT FOR ANY ERRORS AND/OR OMISSIONS PRIOR TO START OF WORK.

NO.	DATE	REVISION
1	JAN 24/14	PRELIMINARY REVIEW
2	JULY 15/14	SITE PLAN SUBMISSION
3	DEC 19/14	PERMIT SUBMISSION
4	JAN 24/15	Revisions to Plans
5	FEB 10/15	Revision to Callings
6	APR 15/15	Permit Revision Submission
7	JULY 16/15	General Plan Revisions
8	NOV 20/15	General Plan Revisions
9	MAY 3/16	General Plan Revisions

S.J.L.
S. J. LAWRENCE
 ARCHITECT INCORPORATED
 18 Deakin St, Suite 205, Ottawa, ON, K2E 8B7
 Tel: 453-729-7791 Fax: 453-729-7792
 Email: sjl@sjlarchitect.com

THIS DRAWING IS THE SOLE PROPERTY OF SHAWN J. LAWRENCE ARCHITECT INC. REPRODUCTION IS NOT PERMITTED.

DATE: MAR 14
 DRAWN BY: M.S. & J.B.
 CHECKED BY: S.J.L. & J.B.
 SCALE: AS INDICATED
 PROJECT: SOUTHWAY INN RETIREMENT HOME
 JOB NO.: SL-697-13
 DRAWING NO.: 2
 SHEET: A.002
 DATE: 2016/03/21 PM

SOUTHWAY INN
RETIREMENT HOME

CONSTRUCTION NOTES & ASSEMBLIES