



TAL-CO SUPPLEMENTAL INSTRUCTION #19			
Project Name:	RW TOMLINSON - NEW HEAD OFFICE		
Project Location:	100 Nortel Drive, Ottawa, Ontario		
ARCH. SI #:	ASK -22, ASK-23	Issued By:	Chris Simpson
STRUC. SI #:	N/A	Date Issued:	October 21, 2016
MECH. SI #:	N/A	Revision #:	N/A
ELEC. SI #:	N/A	Revision Date:	N/A

Supplemental Instructions are issued by the Construction Manager to record a clarification or revision to the previously issued Contact Documentation as reflected by the attached information prepared by the identified Professionals.

The Construction Manager shall review the Supplemental Instruction and the attached information and issue to the affected Trade Contractors identifying the following course of action by the Trade Contractor.

Notify TAL-CO within 5 days of receipt, if the attached documents will require a change to Contract Price or Schedule.

**Title:** Revised mechanical opening behind elevator shaft (Grid E/3).

**Reference:** Architectural Drawings A-102, A-112 (Typical all floors)

**Attachments:**

- ASK-22
- ASK-23

**Description of the Work:** Follow the attached sketches to revise mechanical opening behind elevator shaft/ above ground floor janitor's room (typical on floors above).

**Reason:** Additional space required to accommodate mechanical/ plumbing.

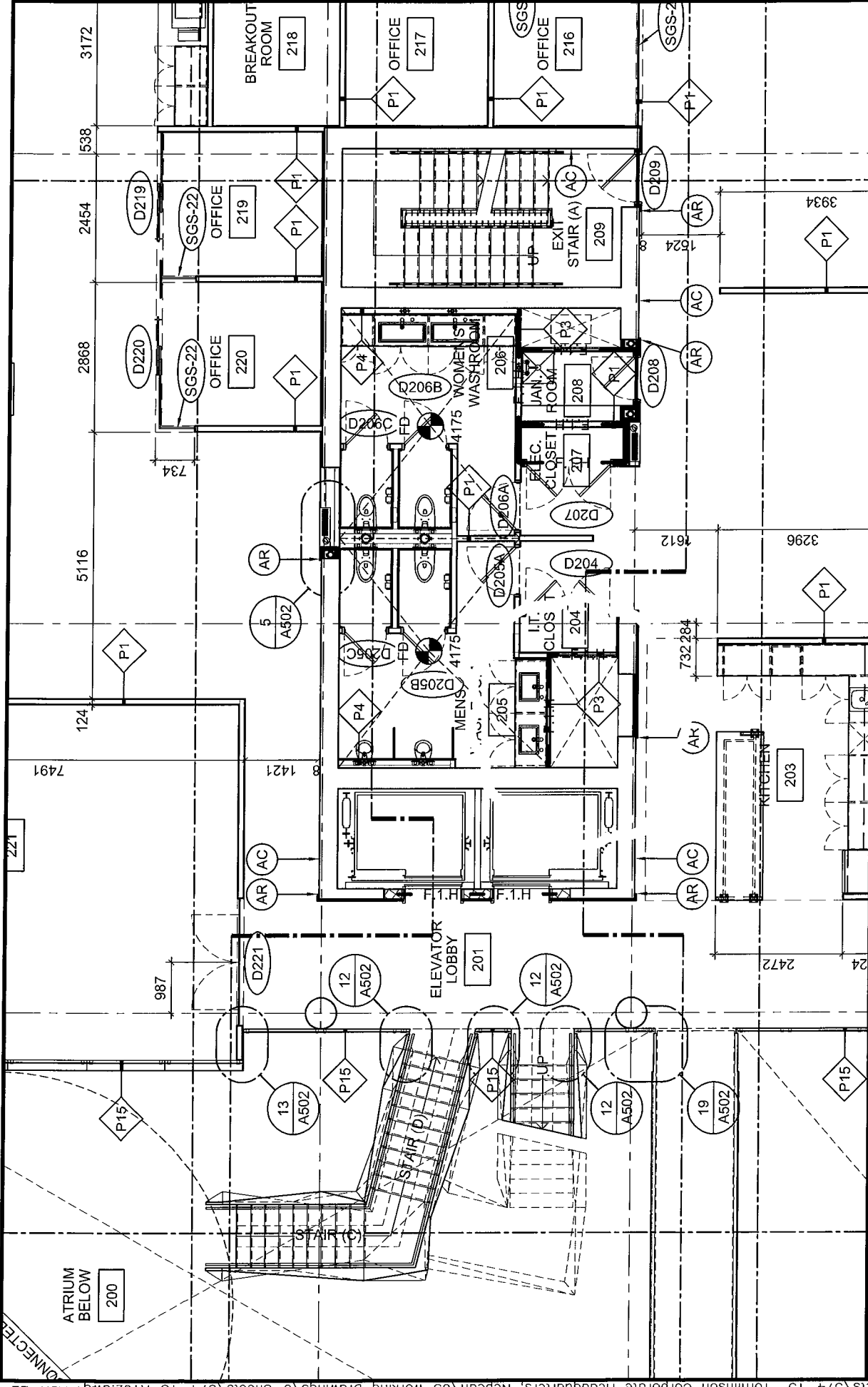

DATE:	2016/10/18
SCALE:	1:100
DRAWN BY:	JK
JOB NO.:	574-15
DRAWING NO.:	ASK-22

PROJECT: TOMLINSON NEW BUILDING

DRAWING TITLE: REFERENCE PART OF 1/A102

CONNECTED

200 ATRIUM BELOW

201 ELEVATOR LOBBY

202 STAIR (D)

203 KITCHEN

204 LIT. CLOS.

205 MENS.

206 WOMEN'S WASHROOM

207 ELEC. CLOSET

208 JAN.

209 STAIR (A)

210 OFFICE

211 OFFICE

212 OFFICE

213 OFFICE

214 OFFICE

215 OFFICE

216 OFFICE

217 OFFICE

218 BREAKOUT ROOM

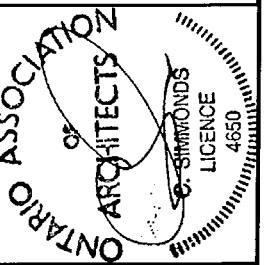

**Christopher Simmonds Architect**

THE ANNEX / 460 EGLINTON ST. OTTAWA, ON K1M 1A3  
 613-562-7888 PHONE / 613-562-7528 FAX  
 csaarchitect.com

