



TAL-CO SUPPLEMENTAL INSTRUCTION #21			
Project Name:	RW TOMLINSON - NEW HEAD OFFICE		
Project Location:	100 Nortel Drive, Ottawa, Ontario		
ARCH. SI #:	Various, see below	Issued By:	Chris Simpson
STRUC. SI #:	N/A	Date Issued:	December 7, 2016
MECH. SI #:	N/A	Revision #:	N/A
ELEC. SI #:	N/A	Revision Date:	N/A

Supplemental Instructions are issued by the Construction Manager to record a clarification or revision to the previously issued Contact Documentation as reflected by the attached information prepared by the identified Professionals.

The Construction Manager shall review the Supplemental Instruction and the attached information and issue to the affected Trade Contractors identifying the following course of action by the Trade Contractor.

Notify TAL-CO within 5 days of receipt, if the attached documents will require a change to Contract Price or Schedule.

Title: Various dimensional clarifications which have been incorporated into the Architectural - Issued For Construction Drawings.

Reference: Architectural - Issued For Construction Drawings - Dated 11-Nov-2016

Attachments:

- ASK-24
- ASK-26
- ASK-27
- ASK-28
- ASK-29
- ASK-30
- ASK-31
- ASK-32

Description of the Work: ASK's Issued For Clarification Only.

Reason: To draw attention to minor dimensional changes and/ or clarifications which have been incorporated in the construction issue set of drawings. Note that this is not a comprehensive list of all changes that have been made in the Construction Issue Drawings set and it is the responsibility of all trades and suppliers to read and follow the current set of drawings and specifications at all times.

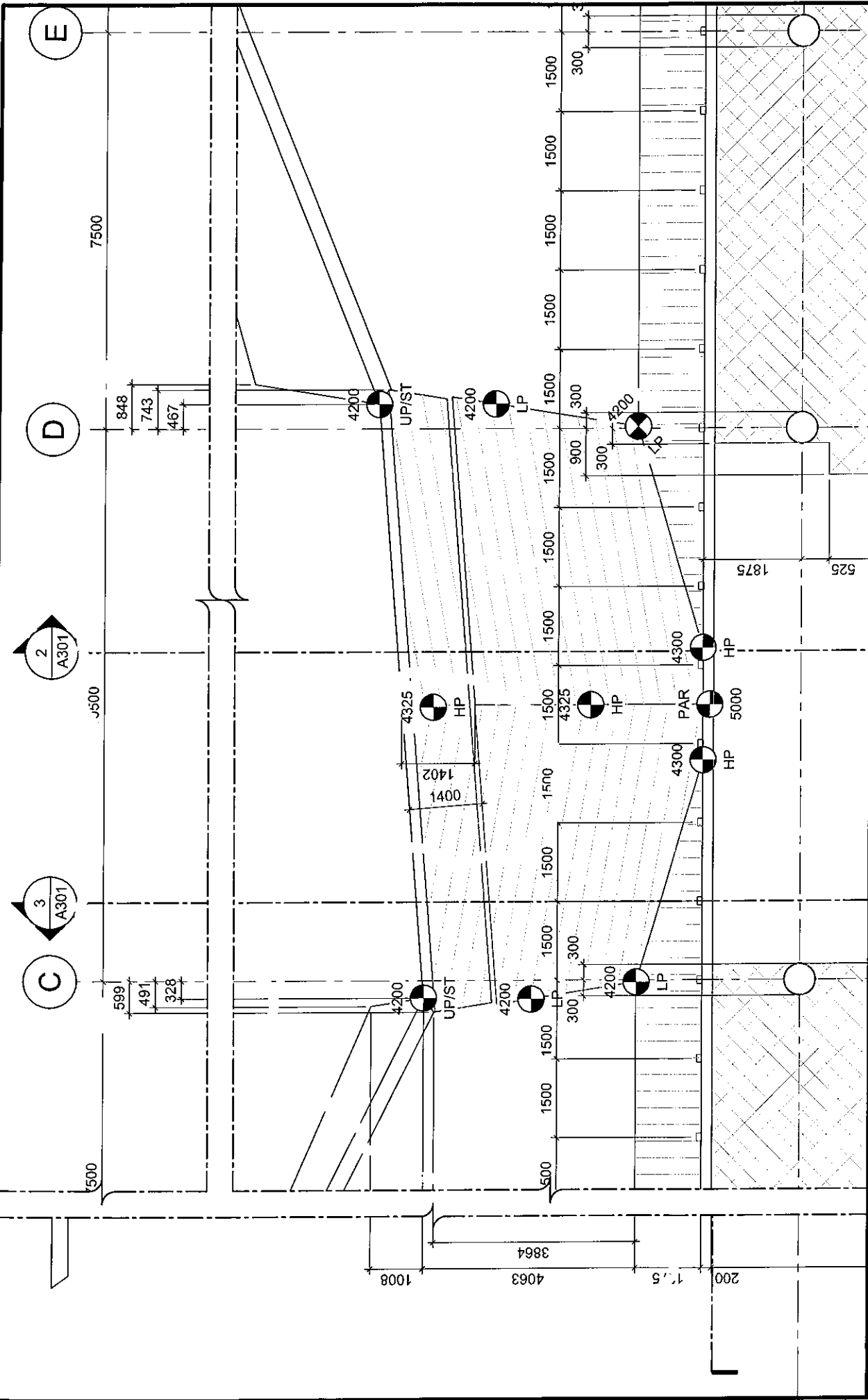

DATE:	2016/10/24
SCALE:	1:100
DRAWN BY:	JK
JOB No:	574-15
DRAWING No:	ASK-24

PROJECT:
TOMLINSON NEW BUILDING

DRAWING TITLE:
REFERENCE PART OF 1/A112

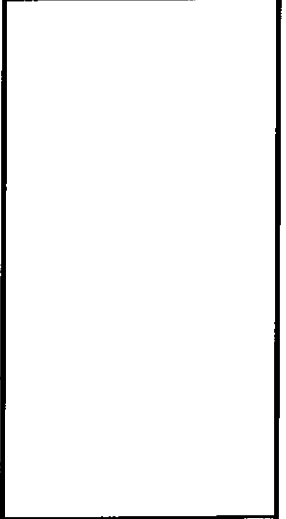

Christopher Simmonds Architect

THE ANNEX/RECULOUS ST. OTTAWA ON K1R 6A1
 413-527-7886 PHONE / 413-527-7528 FAX
 csaarchitect.com

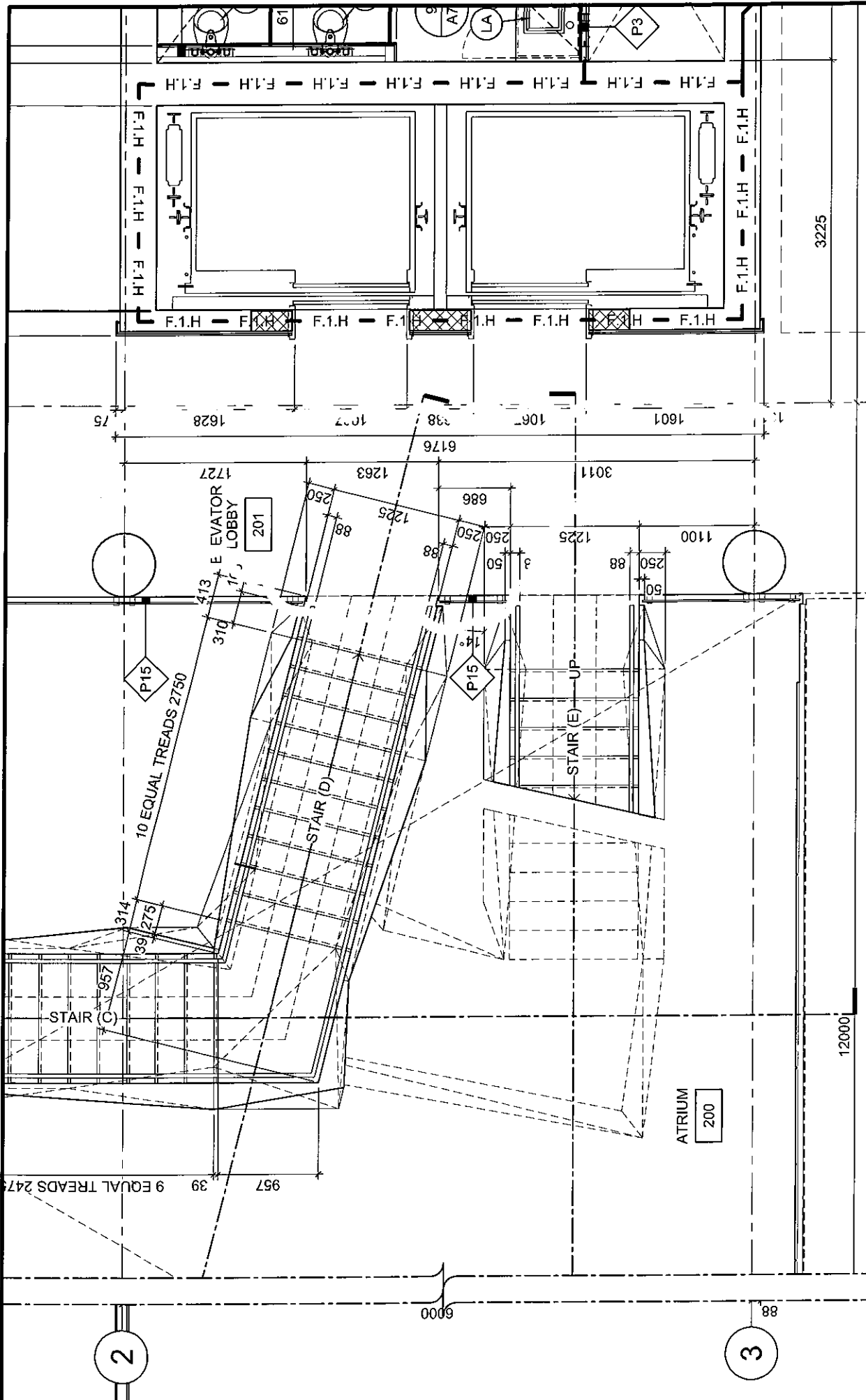

DATE:	2016/11/01
SCALE:	1:50
DRAWN BY:	JK
JOB No.:	574-15
DRAWING No.:	ASK-26

PROJECT: TOMLINSON NEW BUILDING

DRAWING TITLE: REFERENCE PART OF 2/A701

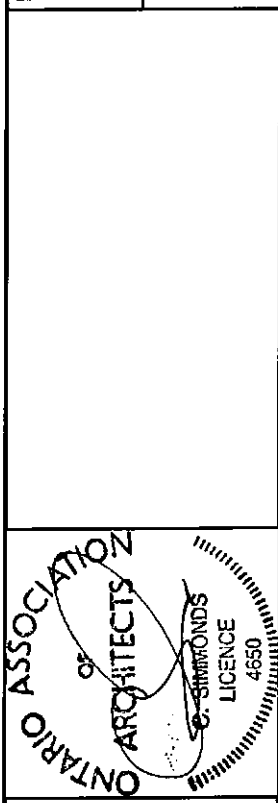

Christopher Simmonds Architect

THE ANNEX/REGULCES ST. OTTAWA, ON N1R 4S1
 613-567-7888 PHONE / 613-567-7528 FAX
 csa@simmonds.com

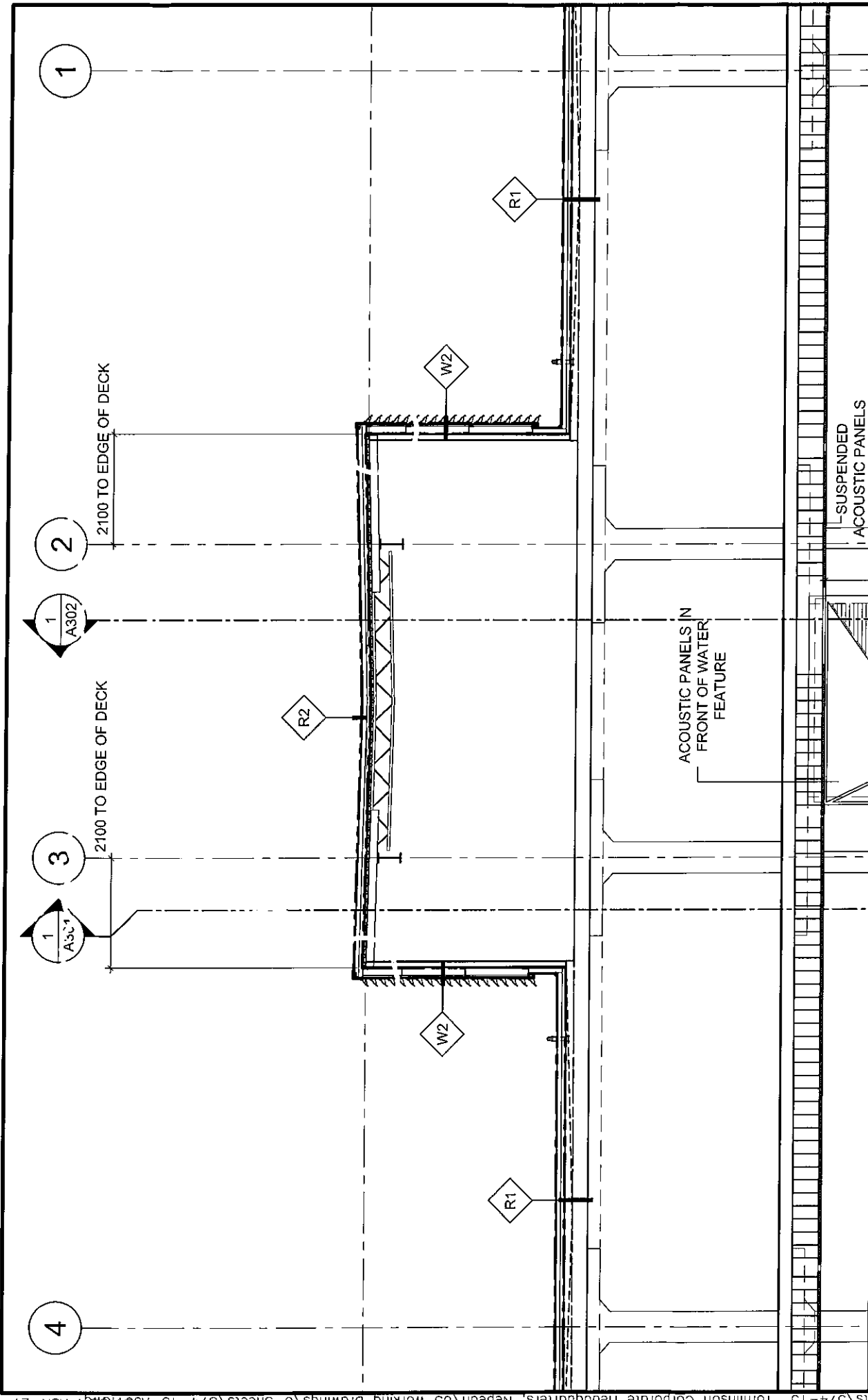

DATE:	2016/11/03
SCALE:	1:100
DRAWN BY:	JK
JOB No:	574-15
DRAWING No:	ASK-27

PROJECT:
TOMLINSON NEW BUILDING
 DRAWING TITLE:
REFERENCE PART 3/A301

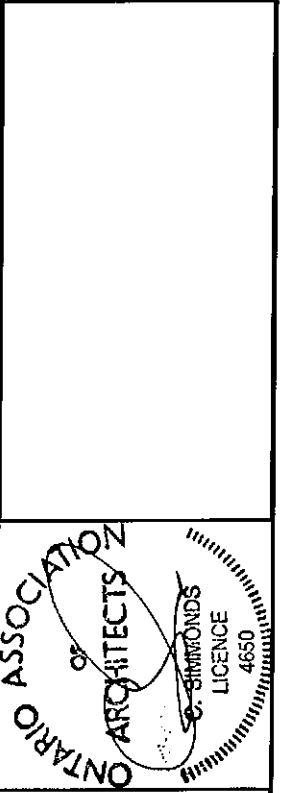

Christopher Simmonds Architect
 THE ANNEX/RECULLES ST. OTTAWA ON K1R 6S1
 613.567.7888 PHONE / 613.567.7328 FAX
 csaarchitect.com

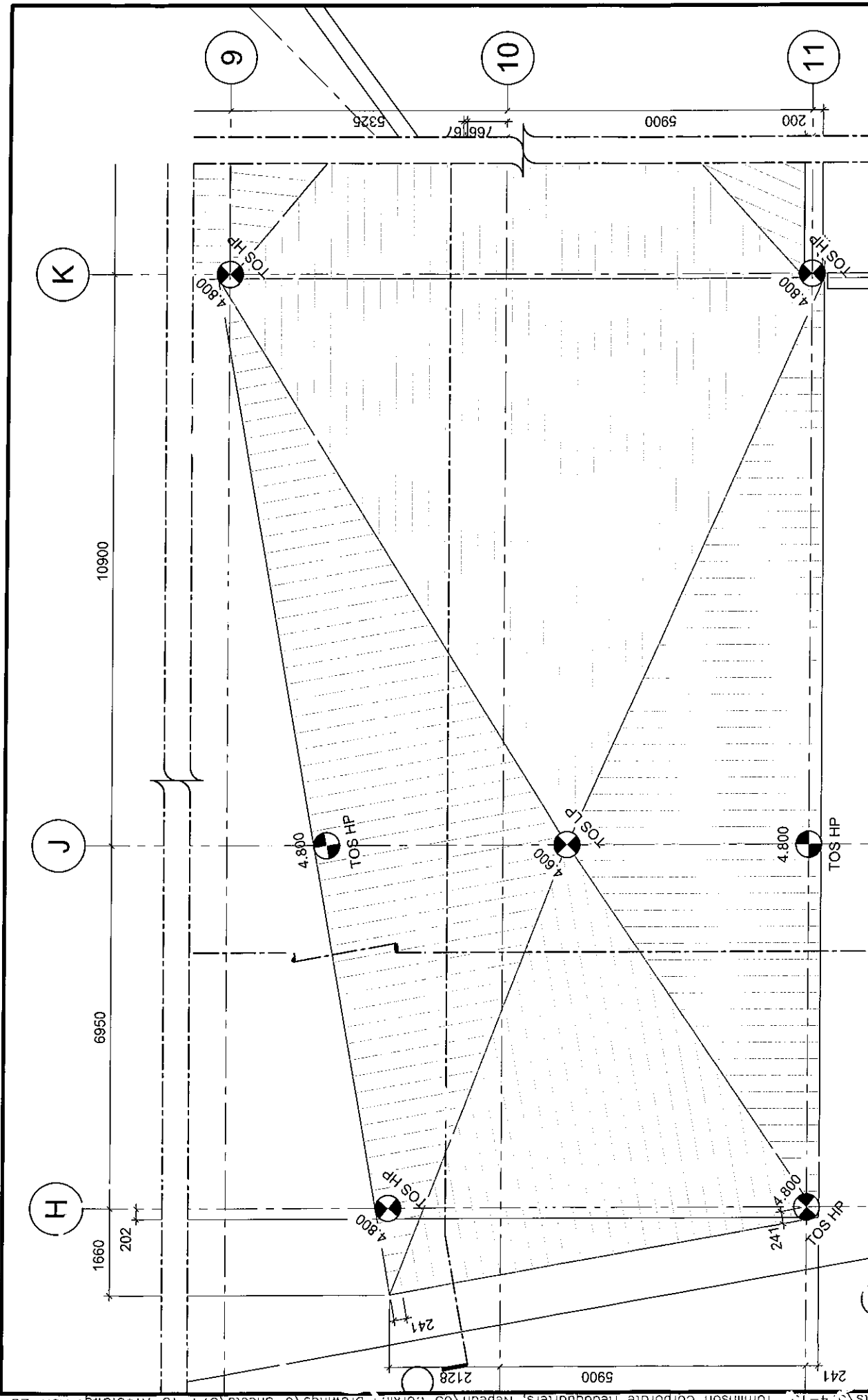

DATE:	2016/11/03
SCALE:	1:100
DRAWN BY:	JK
JOB No:	574-15
DRAWING No:	ASK-28

PROJECT:
TOMLINSON NEW BUILDING

DRAWING TITLE:
REFERENCE PART 2/A110

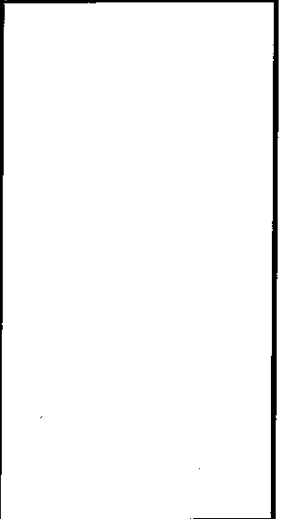

Christopher Simmonds Architect

THE ARNHEIM/ARCCLES ST. OTTAWA ON N2R 6K1
 613.567.7888 PHONE / 613.567.7328 FAX
 csaarchitect.com

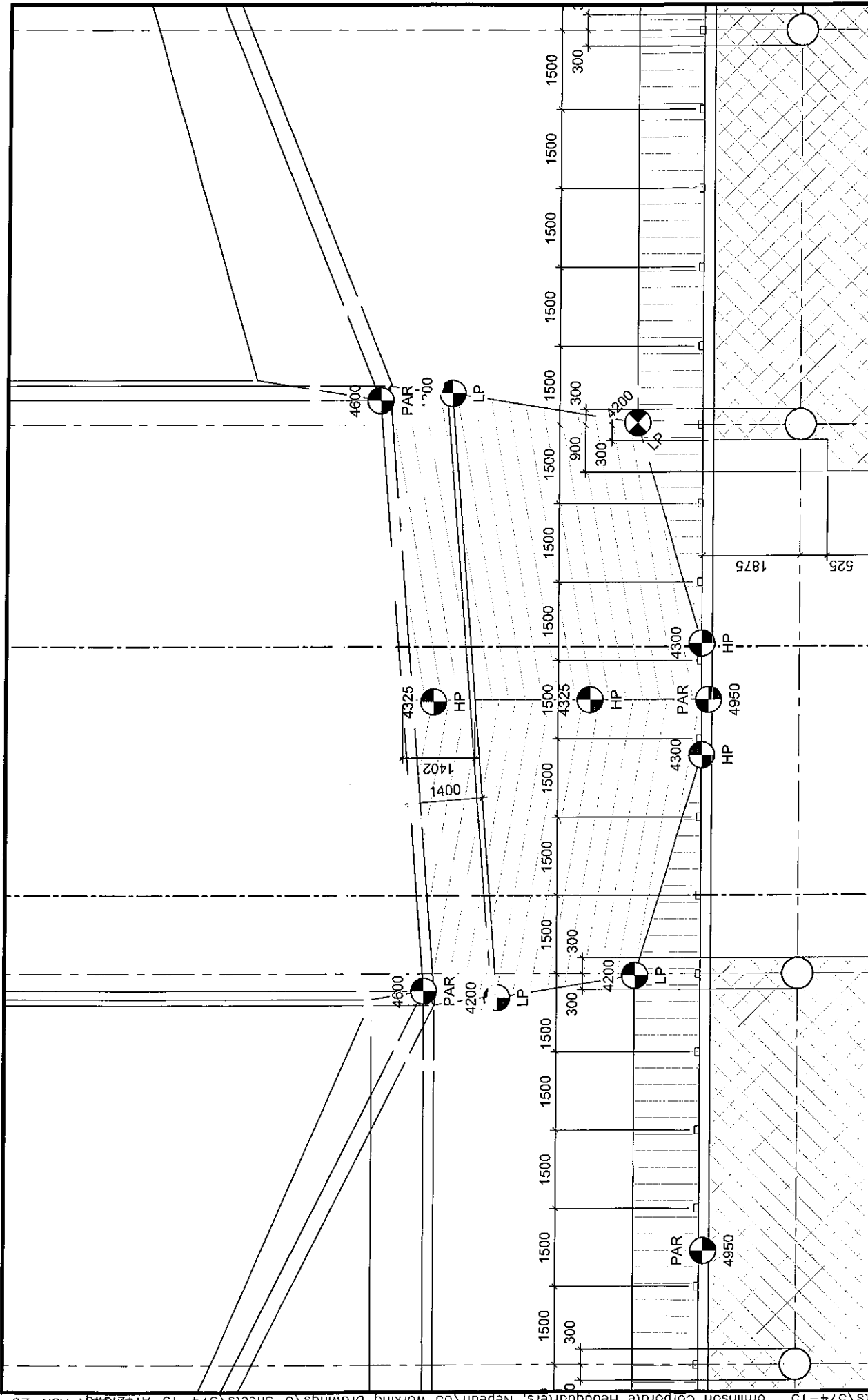

DATE:	2016/11/08
SCALE:	1:100
DRAWN BY:	JK
JOB No:	574-15
DRAWING No:	ASK-29

PROJECT:
TOMLINSON NEW BUILDING

DRAWING TITLE:
REFERENCE PART OF 1/A112

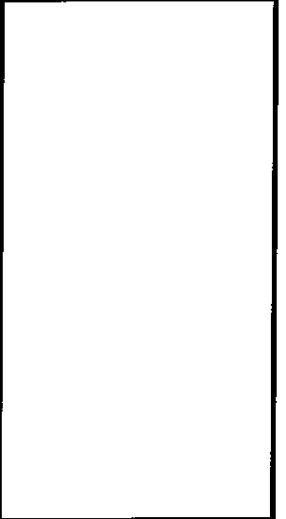

Christopher Simmonds Architect

THE ANNEY / 866 LESLIE ST. OTTAWA, ON N1R 4S3
 613-567-7888 PHONE / 613-567-7328 FAX
 csimmonds.com

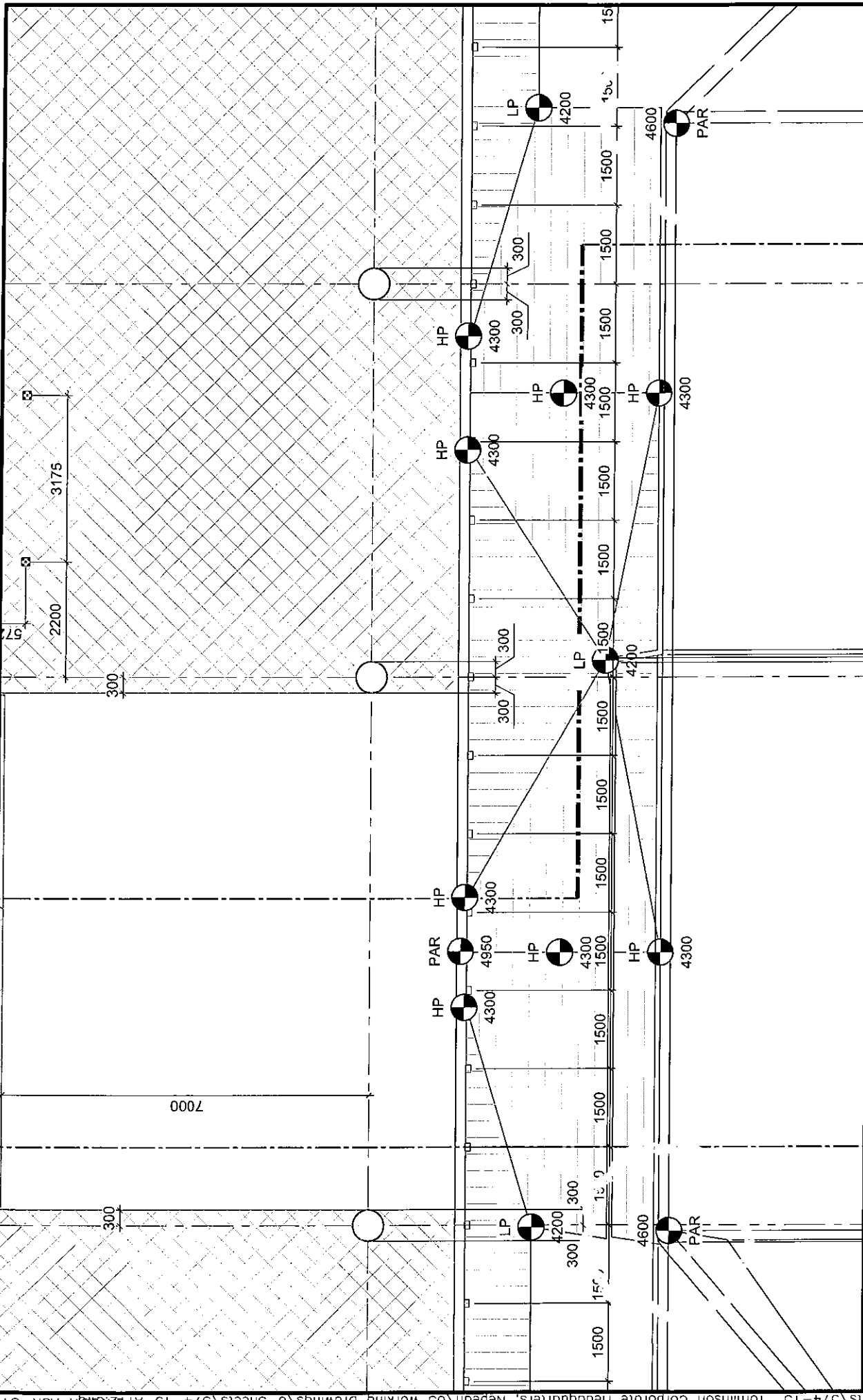

DATE:	2016/11/08
SCALE:	1:100
DRAWN BY:	JK
JOB No:	574-15
DRAWING No:	ASK-31

PROJECT:
TOMLINSON NEW BUILDING

DRAWING TITLE:
REFERENCE PART OF 1/A112

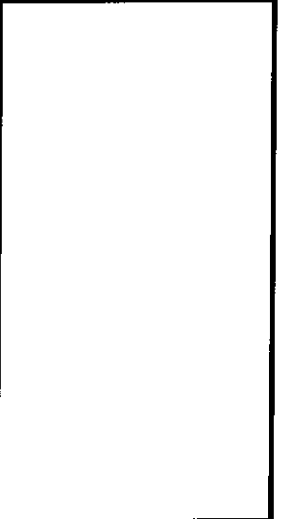

Christopher Simmonds
Architect

THE ANNEX/RECULUS ST OTTAWA ON K1R 6W5
 613.567.7888 PHONE / 613.567.7328 FAX
 csaarchitect.com

**PROPOSED 4 STOREY
OFFICE BUILDING**

MAIN BUILDING T.O.S.
099.500 GEODETIC
000.000 NOMINAL

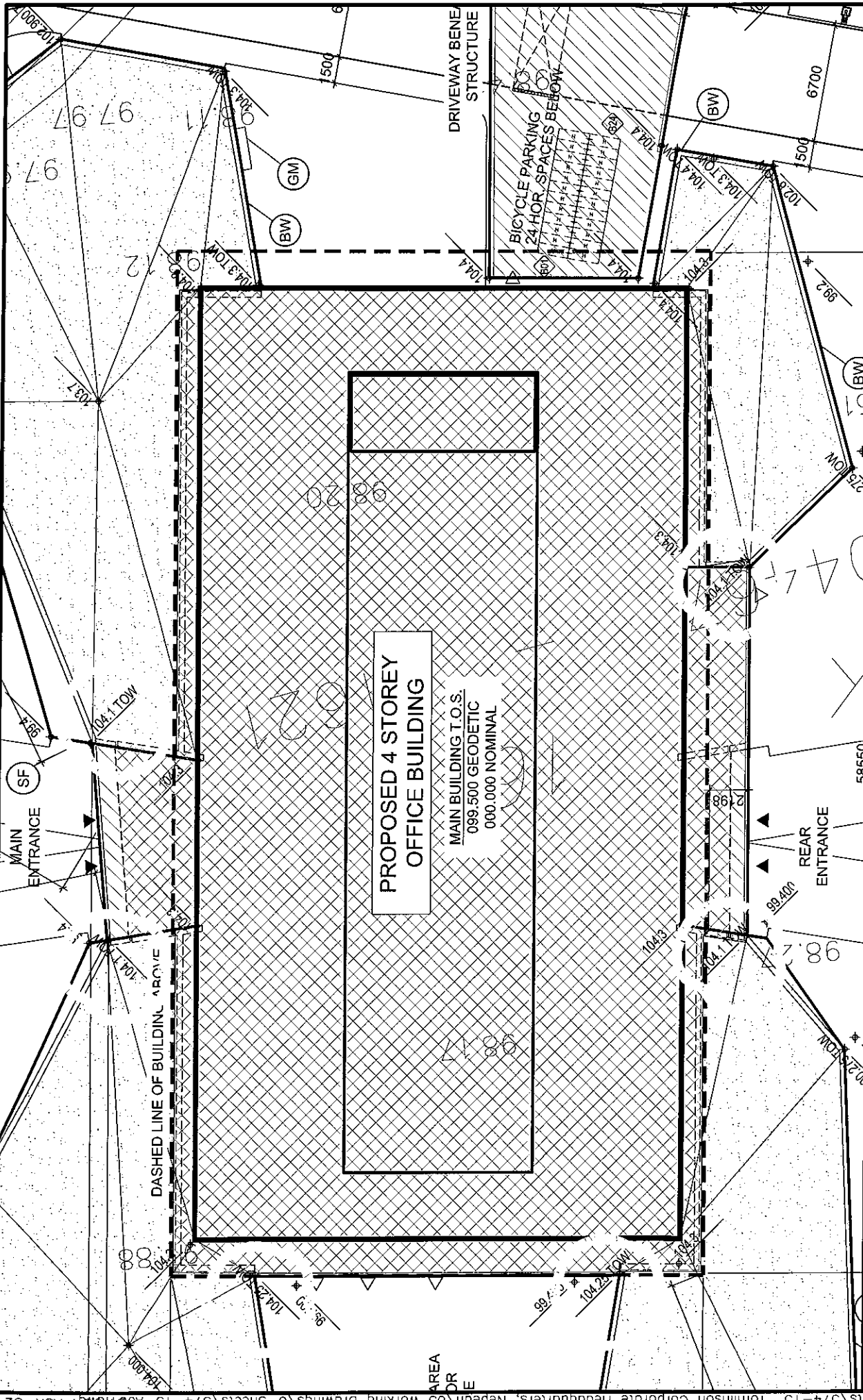

DATE:	2016/11/08
SCALE:	1:300
DRAWN BY:	JK
JOB No:	574-15
DRAWING No:	ASK-32

PROJECT:
TOMLINSON NEW BUILDING

DRAWING TITLE:
REFERENCE PART OF 1/A001

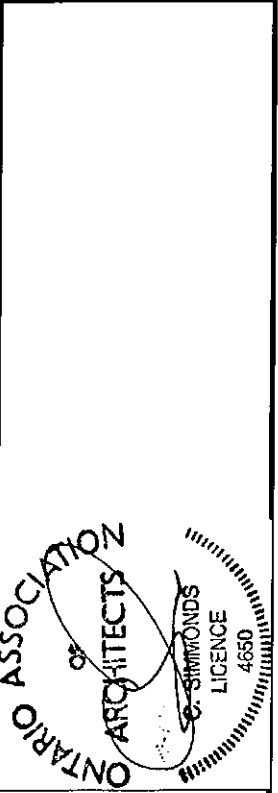

**Christopher
Simmonds
Architect**

THE ANNEX / RECULS ST OTTAWA ON K1R 6M5
613-567-7888 PHONE / 613-567-7328 FAX
csm@architect.com