



TAL-CO SUPPLEMENTAL INSTRUCTION #28 Rev 01			
Project Name:	RW TOMLINSON - NEW HEAD OFFICE		
Project Location:	100 CitiGate Drive, Ottawa, Ontario		
ARCH. SI #:	Various, see below	Issued By:	Farah Bano
STRUC. SI #:	N/A	Date Issued:	February 13, 2016
MECH. SI #:	N/A	Revision #:	1
ELEC. SI #:	N/A	Revision Date:	March 22, 2017

Supplemental Instructions are issued by the Construction Manager to record a clarification or revision to the previously issued Contact Documentation as reflected by the attached information prepared by the identified Professionals.

The Construction Manager shall review the Supplemental Instruction and the attached information and issue to the affected Trade Contractors identifying the following course of action by the Trade Contractor.

Notify TAL-CO within 5 days of receipt, if the attached documents will require a change to Contract Price or Schedule.

**Title:** Revisions to curtain wall details.

**Reference:** Architectural - Construction Update Drawings - Dated 2-Feb-2017

**Attachments:**

- |                        |         |
|------------------------|---------|
| ASK-73                 | ASK-82  |
| ASK-74                 | ASK-83  |
| ASK-75                 | ASK-84  |
| ASK-76                 | ASK-85  |
| ASK-77                 | ASK-86  |
| ASK-78                 | ASK-87  |
| ASK-79 Rev01 Mar 17/17 | ASK-88  |
| ASK-80                 | ASK-122 |
| ASK-81                 | ASK-123 |

**Description of the Work:** ASK's Issued during the course of curtain wall shop drawing review for design co-ordination purposes.

Revised ASK-79, and supplemental ASK-122 & ASK-123 issued.

**Reason:** The attached ASK's are to confirm minor detail changes related to the curtain wall system for use by the curtain wall contractor in completing their shop drawings. All other trades are to co-ordinate with these details as required for their own work.

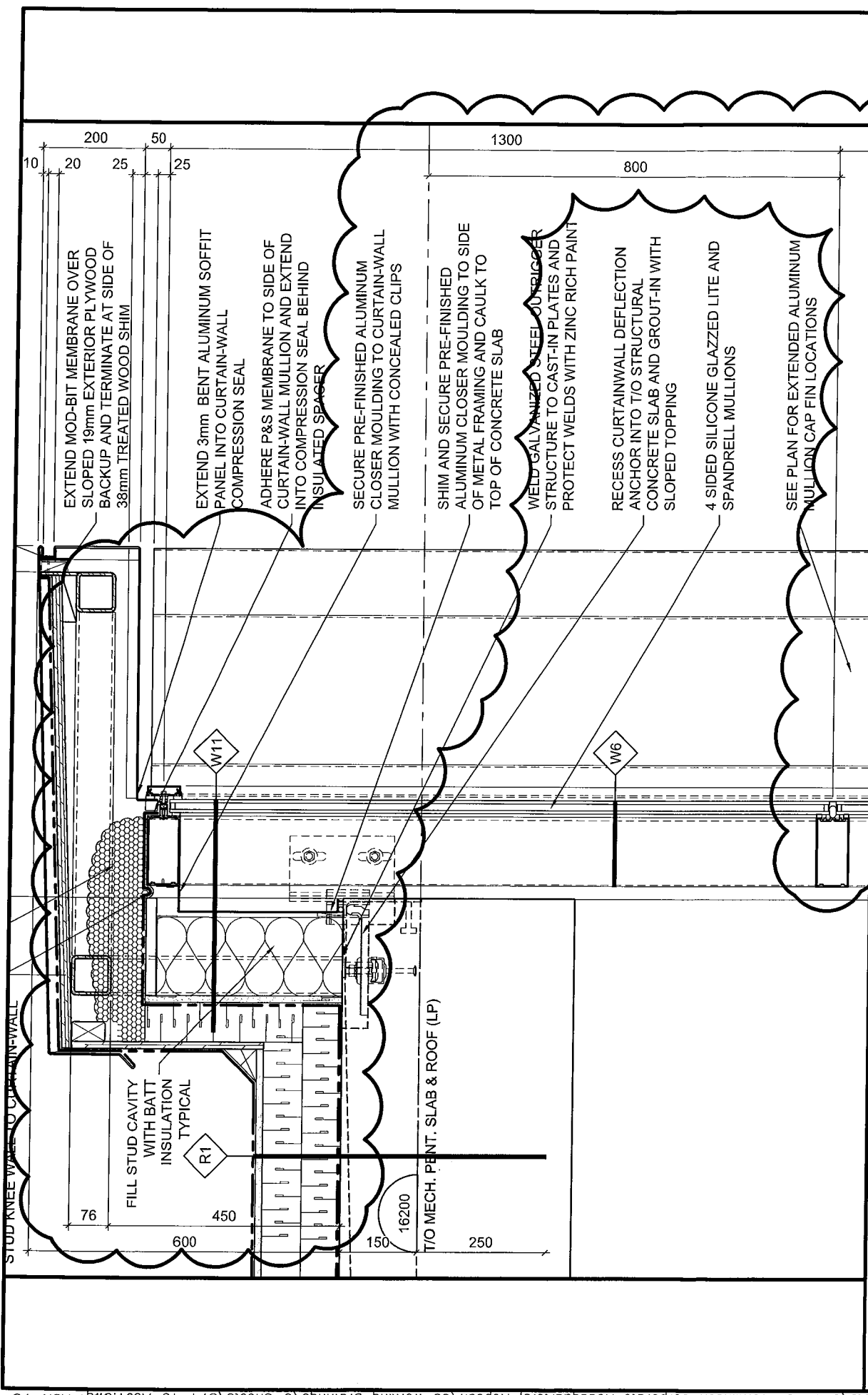

DATE:	2017/02/09
SCALE:	1:10
DRAWN BY:	JK
JOB No:	574-15
DRAWING No:	ASK-73

PROJECT: TOMLINSON NEW BUILDING

DRAWING TITLE: REFERENCE PART DETAIL 3/A601

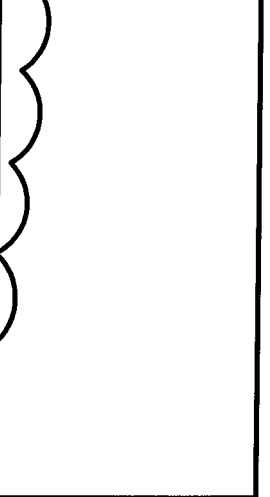

**Christopher Simmonds Architect**

THE ANNEX/4666666 ST. OTTAWA ON K1R 6A5  
 931-562-7888 PHONE / 413-567-7528 FAX  
 csaarchitect.com

Layout: ASK-74

S:\CSA Jobs\2015 Projects\574-15 Tomlinson Corporate Headquarters, Nepean\03 Working Drawings\0-Sheets\574-15-A601.dwg

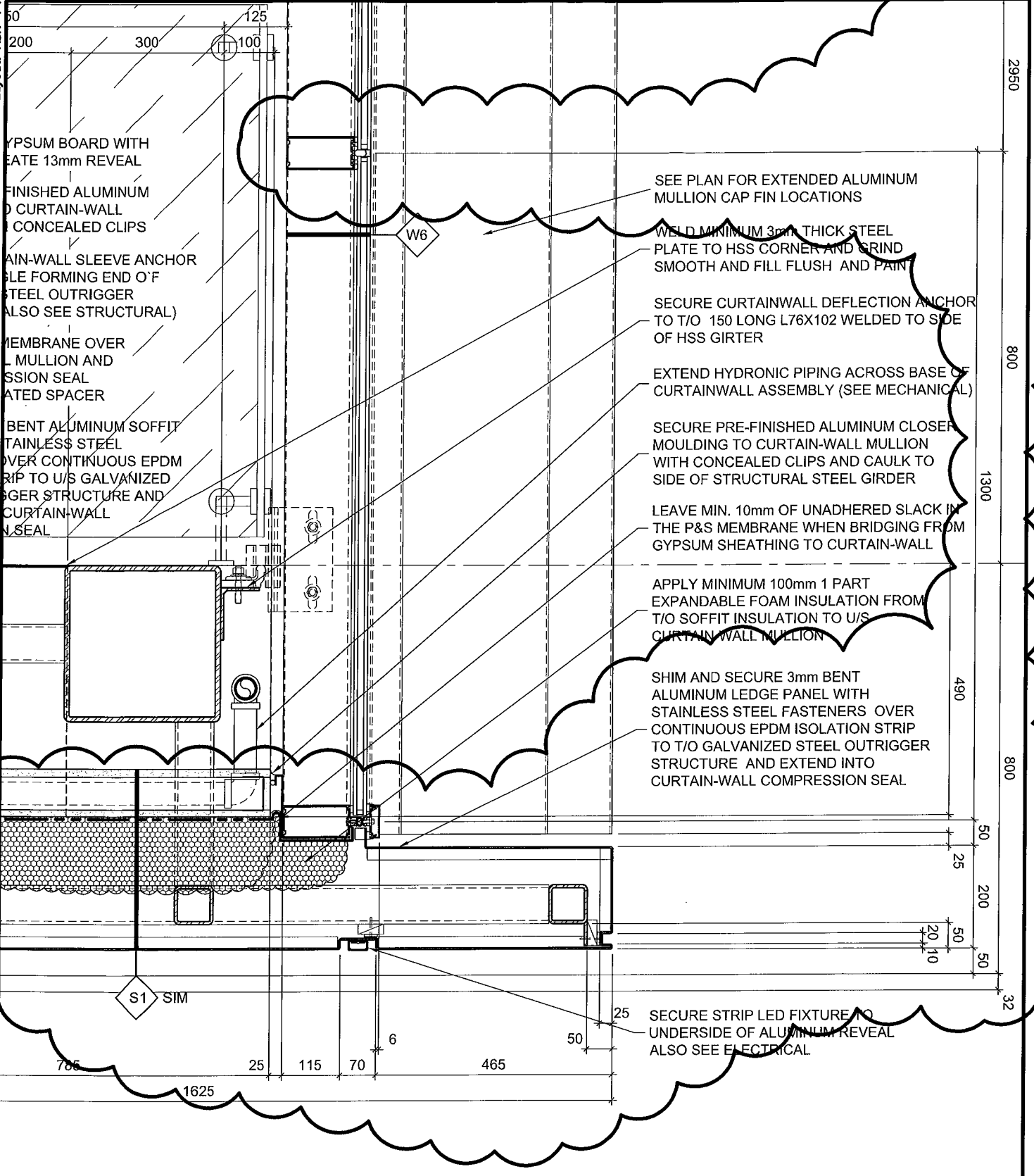

GYPSUM BOARD WITH  
REVEAL 13mm

FINISHED ALUMINUM  
CURTAIN-WALL  
CONCEALED CLIPS

RAIN-WALL SLEEVE ANCHOR  
FORMING END OF  
STEEL OUTRIGGER  
(ALSO SEE STRUCTURAL)

MEMBRANE OVER  
MULLION AND  
COMPRESSION SEAL  
SPACER

BENT ALUMINUM SOFFIT  
STAINLESS STEEL  
OVER CONTINUOUS EPDM  
STRIP TO U/S GALVANIZED  
STEEL STRUCTURE AND  
CURTAIN-WALL  
COMPRESSION SEAL

SEE PLAN FOR EXTENDED ALUMINUM  
MULLION CAP FIN LOCATIONS

WELD MINIMUM 3mm THICK STEEL  
PLATE TO HSS CORNER AND GRIND  
SMOOTH AND FILL FLUSH AND PAINT

SECURE CURTAINWALL DEFLECTION ANCHOR  
TO T/O 150 LONG L76X102 WELDED TO SIDE  
OF HSS GIRTER

EXTEND HYDRONIC PIPING ACROSS BASE OF  
CURTAINWALL ASSEMBLY (SEE MECHANICAL)

SECURE PRE-FINISHED ALUMINUM CLOSE-OFF  
MOULDING TO CURTAIN-WALL MULLION  
WITH CONCEALED CLIPS AND CAULK TO  
SIDE OF STRUCTURAL STEEL GIRDER

LEAVE MIN. 10mm OF UNADHERED SLACK IN  
THE P&S MEMBRANE WHEN BRIDGING FROM  
GYPSUM SHEATHING TO CURTAIN-WALL

APPLY MINIMUM 100mm 1 PART  
EXPANDABLE FOAM INSULATION FROM  
T/O SOFFIT INSULATION TO U/S  
CURTAIN WALL MULLION

SHIM AND SECURE 3mm BENT  
ALUMINUM LEDGE PANEL WITH  
STAINLESS STEEL FASTENERS OVER  
CONTINUOUS EPDM ISOLATION STRIP  
TO T/O GALVANIZED STEEL OUTRIGGER  
STRUCTURE AND EXTEND INTO  
CURTAIN-WALL COMPRESSION SEAL

SECURE STRIP LED FIXTURE TO  
UNDERSIDE OF ALUMINUM REVEAL  
ALSO SEE ELECTRICAL

50  
200  
300  
125  
100  
765  
1625  
25  
115  
70  
6  
465  
50  
25  
20  
10  
50  
32

2950  
800  
1300  
490  
800  
50  
25  
200  
50  
50  
32

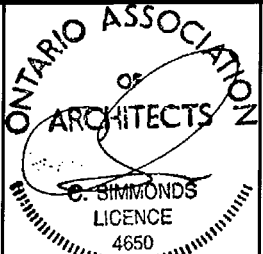

PROJECT:  
**TOMLINSON NEW BUILDING**

DRAWING TITLE:  
**REFERENCE PARTIAL DETAIL 12/A601**

DATE: 2017/02/09  
SCALE: 1:10  
DRAWN BY: JK  
JOB No: 574-15  
DRAWING No:

**ASK-74**

THE ANNEX/466 CECLES ST. OTTAWA ON K1R 6S3  
613.567.7888 PHONE / 613.567.7528 FAX  
csarchitect.com

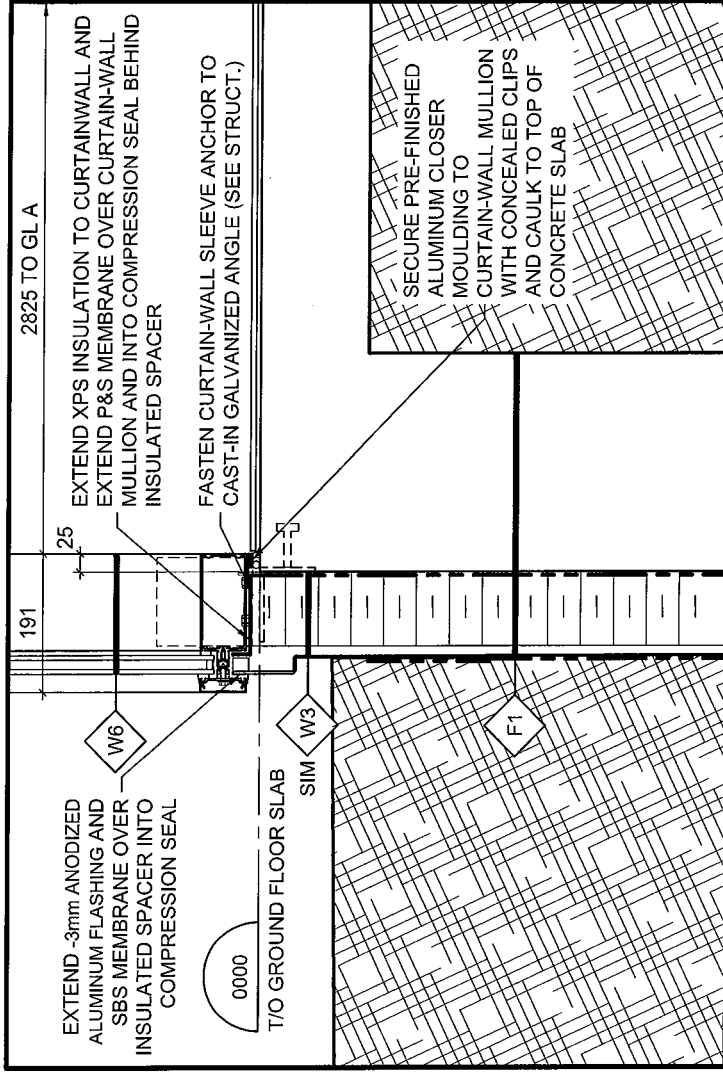

15 CURTAINWALL LITE BASE DETAIL

A602

SCALE = 1:10

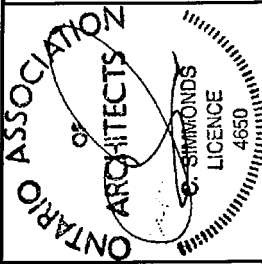
<p>DATE: 2017/02/08 SCALE: AS INDICATED DRAWN BY: JK JOB No: 574-15 DRAWING No: ASK-75</p>	<p>PROJECT: TOMLINSON NEW BUILDING</p>	<p>DRAWING TITLE: REFERENCE NEW DET. AS INDICATED</p>
 <p>THE ANNEX / 49 CECILES ST. OTTAWA ON K1K 6S3 933.567.7888 PHONE / 933.567.7228 FAX csmarchitect.com</p>		

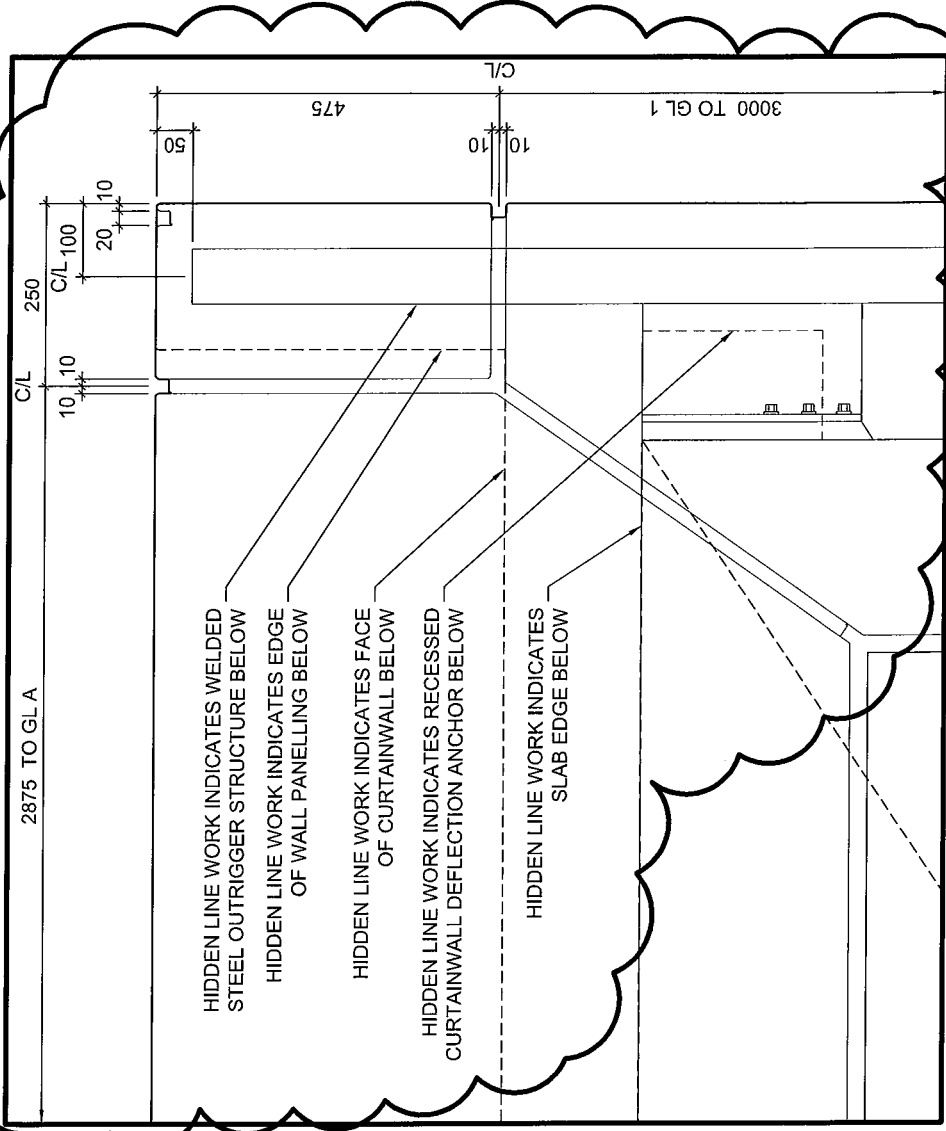

HIDDEN LINE WORK INDICATES WELDED STEEL OUTRIGGER STRUCTURE BELOW

HIDDEN LINE WORK INDICATES EDGE OF WALL PANNELLING BELOW

HIDDEN LINE WORK INDICATES FACE OF CURTAINWALL BELOW

HIDDEN LINE WORK INDICATES RECESSED CURTAINWALL DEFLECTION ANCHOR BELOW

HIDDEN LINE WORK INDICATES SLAB EDGE BELOW

3 PARAPET FLASHING DETAIL

SCALE = 1:10

A503

DATE:	2017/02/09
SCALE:	AS INDICATED
DRAWN BY:	JK
JOB No:	574-15
DRAWING No:	ASK-76

PROJECT:	TOMLINSON NEW BUILDING
DRAWING TITLE:	REFERENCE DETAIL AS INDICATED

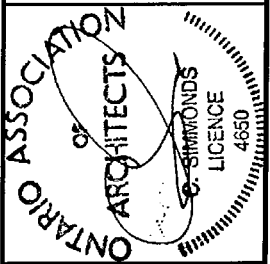

THE ANNEX / 460 CECIL ST. OTTAWA ON K1R 5S3  
 613.667.7888 PHONE / 613.567.7228 FAX  
 csaarchitect.com

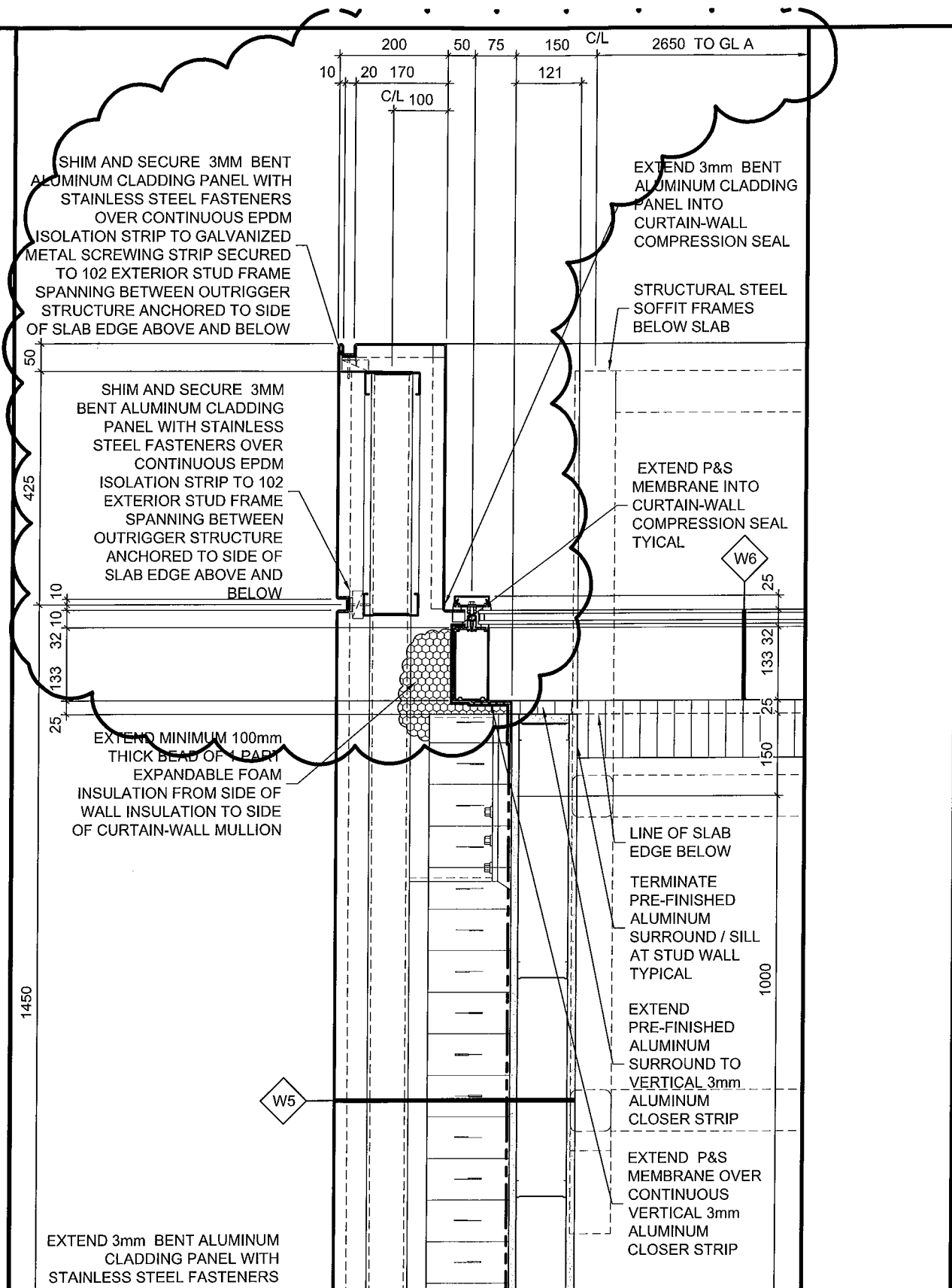

PROJECT:  
TOMLINSON NEW BUILDING

DRAWING TITLE:  
REFERENCE PARTIAL DETAIL 10/A503

DATE: 2017/02/09

SCALE: 1:10

DRAWN BY: JK

JOB No: 574-15

DRAWING No: ASK-77

P15 15mm PERGOLA PANELS (TITLE TO ABOVE 3000 TITLE TO BELOW)  
(SEE DETAILS FOR ANCHORAGE)

P16 ALUMINUM FRAMED GLASS PARTITION ASSEMBLY 114mm  
-114mm X 51 STOREFRONT MULLIONS  
-TEMPERED GLASS UNIT

P17 1HR BEAM FIRE-PROTECTION MEMBRANE (SB-2)  
-2X13mm TYPE X GYPSUM BOARD  
-41mm METAL STUDS @ 400O/C

P18 1 SIDED 64 STUD PARTITION ASSEMBLY 80mm  
-16 GYPSUM BOARD BOTH SIDES  
42 MINERAL WOOL SOUND ATTENUATING BLANKET  
-64 METAL STUDS @ 400 O/C

F1 TYPICAL FOUNDATION WALL (FROM T/O GRADE TO T/O FOOTING):  
-GEOTEXTILE FABRIC  
-13mm DRAINAGE BOARD  
-102mm XPS INSULATION  
-DAMP-PROOFING  
-VARIES REINFORCED CONCRETE (SEE STRUCTURAL)  
(EXTEND GEOTEXTILE FABRIC & DRAINAGE BOARD & DAMP-PROOFING TO U/S FOOTING)

F2 TYPICAL RETAINING WALL (FROM T/O GRADE TO T/O FOOTING):  
-VARIES REINFORCED CONCRETE (SEE STRUCTURAL)  
-13mm DRAINAGE BOARD (HIGH SIDE)  
-GEOTEXTILE FABRIC (HIGH SIDE)  
(EXTEND GEOTEXTILE FABRIC & DRAINAGE BOARD TO U/S FOOTING)

S1 ALUMINUM CLAD SOFFIT (ABOVE 2ND FLOOR):  
-3mm ANODIZED ALUMINUM PANEL SYSTEM ON GALVANIZED STEEL OUTRIGGER STRUCTURE @ 1500 O/C HORIZONTALLY  
-95 AIR SPACE  
-P&S MEMBRANE  
-CONCRETE DROP PANEL OR  
-13mm EXTERIOR GYPSUM SHEATHING  
-92mm METAL HORIZONTAL STUDS AT 407mm O/C  
CONCRETE PANELED SYSTEM TEST LEAK TIGHT OVER SPACER  
-13mm FIBERGLASS REINFORCED CONCRETE PANEL  
-46mm CONCEALED ANCHORING SYSTEM  
-SUSPENDED EXTERIOR METAL STUD FRAMING

S2

R1 -REINFORCED CONCRETE (SEE STRUCTURAL)

R2 CONVENTIONAL ROOF ON CONCRETE SLAB (OFFICE):  
-2-PLY MOD-BIT ROOFING MEMBRANE (WHITE)  
-6mm PROTECTION BOARD  
-2 LAYERS 76mm POLY-ISO INSULATION  
-P&S MEMBRANE  
-VARIES REINFORCED CONCRETE (SEE STRUCTURAL)

R3 CONVENTIONAL ROOF ON STEEL DECK (MECHANICAL PENTHOUSE):  
-2-PLY MOD-BIT ROOFING MEMBRANE (WHITE)  
-6mm PROTECTION BOARD  
-2 LAYERS 76mm POLY-ISO INSULATION  
-P&S MEMBRANE  
-13mm GYPSUM SHEATHING  
-38mm GALVANIZED METAL DECK  
-VARIES STRUCTURAL STEEL

R4 UNINSULATED CONVENTIONAL ROOF ON STEEL DECK (BRIDGE):  
-STONE BALLAST (GRAY)  
-2-PLY SBS ROOFING MEMBRANE  
-13mm GYPSUM SHEATHING  
-38mm GALVANIZED METAL DECKING  
-VARIES STRUCTURAL STEEL  
-92 CARRYING CHANNELS @ 1200 O/C  
-22 TOP-HAT CHANNELS @ 400 O/C  
-13mm FIBERGLASS REINFORCED CONCRETE PANEL

R5 INVERTED STONE ROOF (BERM ENTRANCES):  
-100mm Ø RIVER ROCK BALLAST  
-GEOTEXTILE FABRIC  
-2 X 76mm XPS INSULATION  
-13mm DRAINAGE BOARD  
-EPDM ROOFING MEMBRANE  
-VARIES REINFORCED CONCRETE (SEE STRUCTURAL)

R6 INVERTED GREEN ROOF (BERM PERIMETER):  
-300mm PLANTING MEDIUM  
-FILTER FABRIC  
-2 X 76mm XPS INSULATION  
-13mm DRAINAGE BOARD  
-EPDM ROOFING MEMBRANE  
-VARIES REINFORCED CONCRETE (SEE STRUCTURAL)

R7 CONVENTIONAL ROOF ON STEEL DECK (TEST-FACILITY):  
-STONE BALLAST (GRAY)  
-2-PLY SBS ROOFING MEMBRANE  
-6mm PROTECTION BOARD  
-2 LAYERS 76mm POLY-ISO INSULATION  
-P&S MEMBRANE  
-13mm GYPSUM SHEATHING  
-38mm GALVANIZED METAL DECK  
-VARIES STRUCTURAL STEEL

PROJECT:

TOMLINSON NEW BUILDING

DRAWING TITLE:

REFERENCE PART DETAIL 20/A002

DATE: 2017/02/09

SCALE: NOT APPLICABLE

DRAWN BY: JK

JOB No: 574-15

DRAWING No:

ASK-78

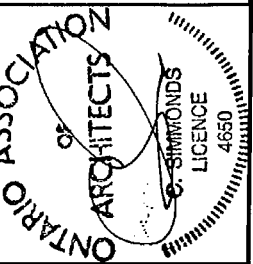

**Christopher Simmonds Architect**

THE ANNEKAY REELES ST. OTTAWA ON K1K 6A5  
613.957.7888 PHONE / 613.567.7524 FAX  
csaarchitect.com

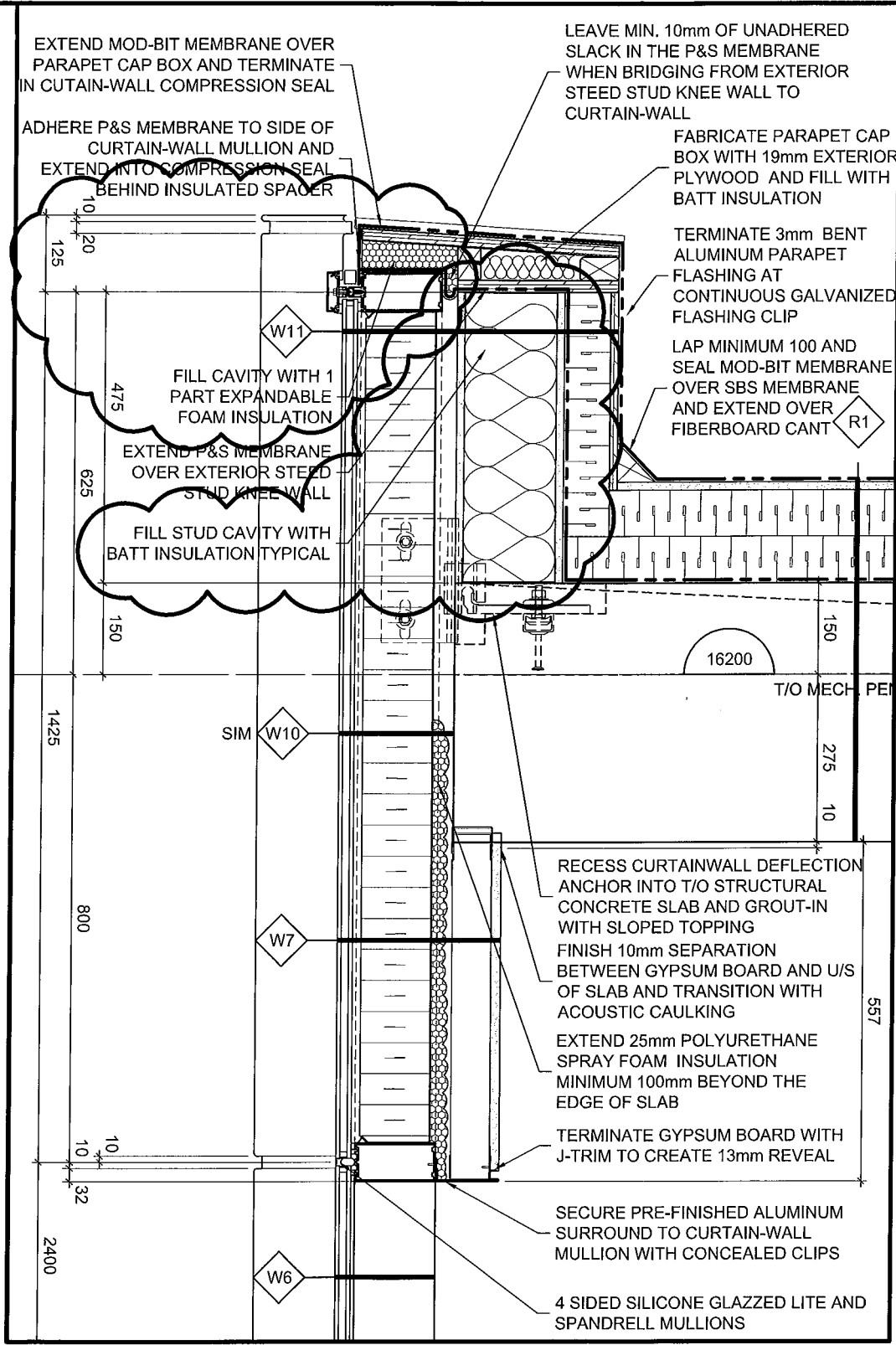

THE ANNEX / 480 CECILES ST. OTTAWA ON K1R 6S1  
613.567.7888 PHONE / 613.567.7526 FAX  
csarchitect.com

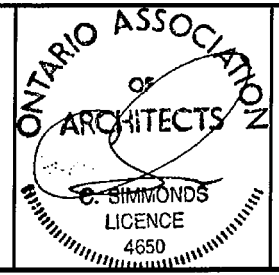

PROJECT:  
TOMLINSON NEW BUILDING

DRAWING TITLE:  
REFERENCE DETAIL 7/A602

DATE: 03/17/2017

SCALE: 1:10

DRAWN BY: JK

JOB No: 574-15

DRAWING No: ASK-79

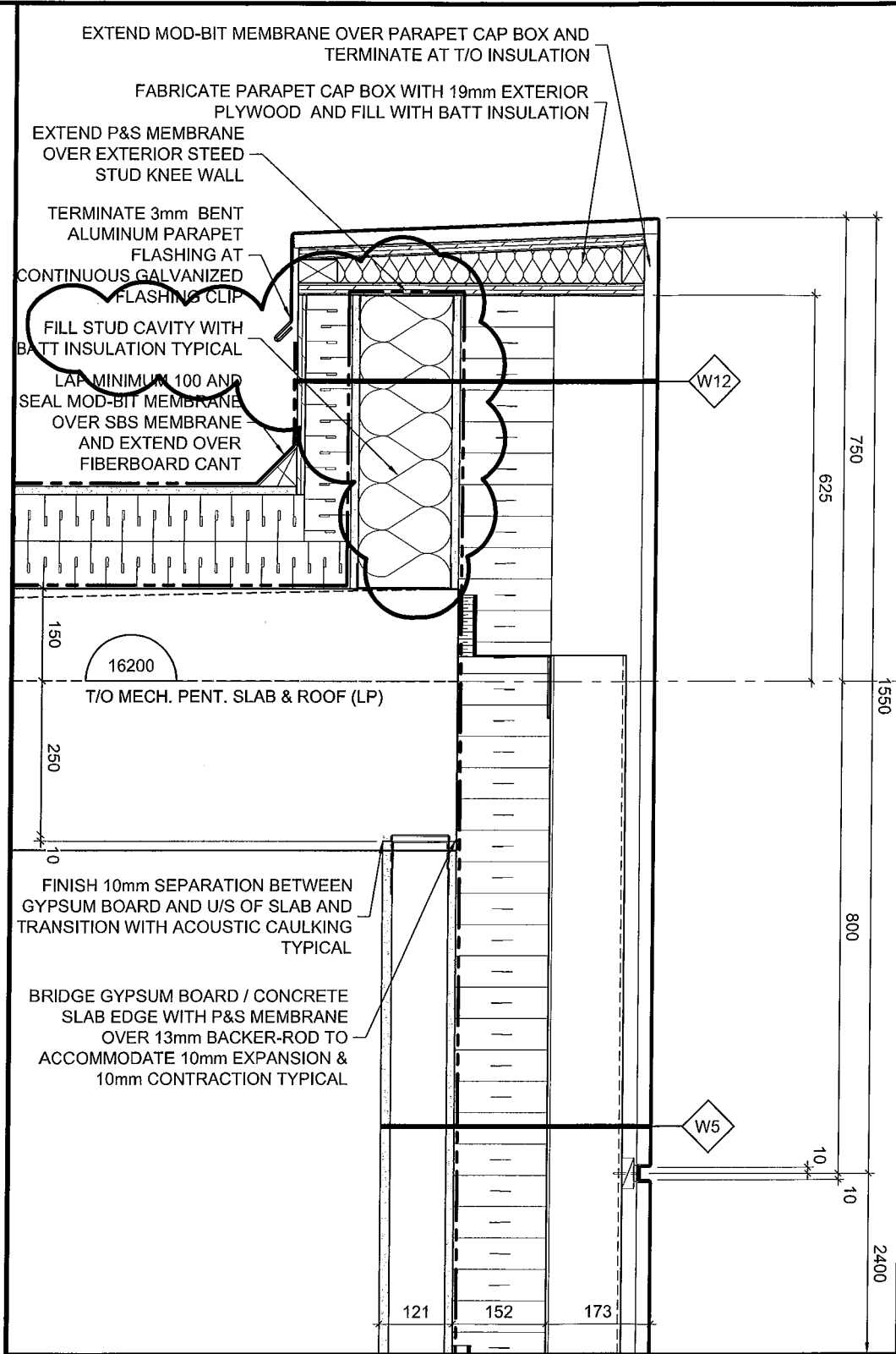

THE ANNEX / 40 ECCLERS ST. OTTAWA ON K1R 6S1  
613.567.7588 PHONE / 613.567.7526 FAX  
csarchitect.com



PROJECT:  
TOMLINSON NEW BUILDING

DRAWING TITLE:  
REFERENCE DETAIL 4/A602

DATE: 2017/02/09

SCALE: 1:10

DRAWN BY: JK

JOB No: 574-15

DRAWING No:  
**ASK-80**





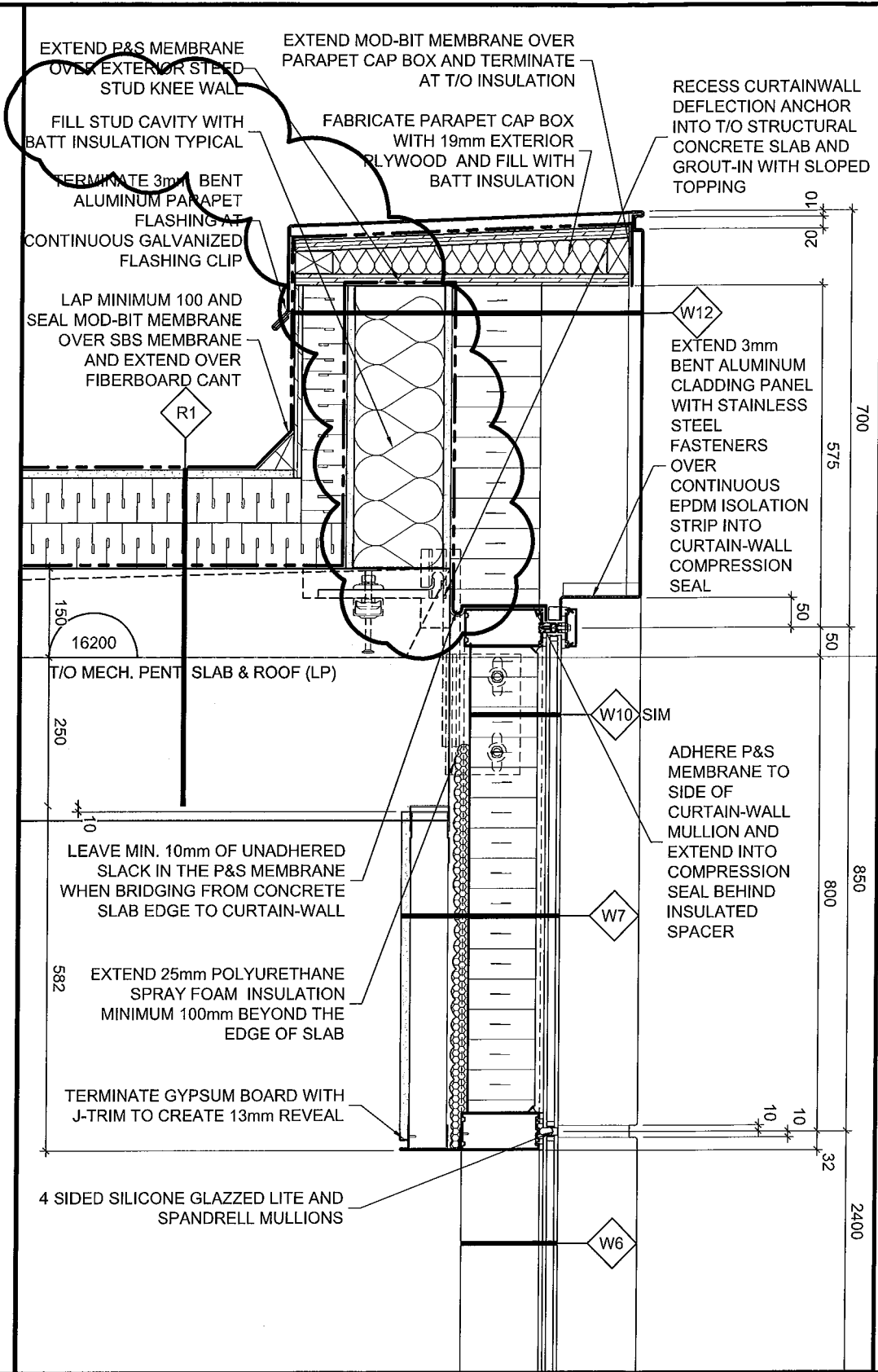

THE ANNEX/40 ECCLLES ST. OTTAWA ON K1R 6S3  
 613.567.7888 PHONE / 613.567.7528 FAX  
 csarchitect.com



PROJECT:  
**TOMLINSON NEW BUILDING**

DRAWING TITLE:  
**REFERENCE PARTIAL DETAIL 5/A601**

DATE: 2017/02/09  
 SCALE: 1:10  
 DRAWN BY: JK  
 JOB No: 574-15  
 DRAWING No:  
**ASK-83**

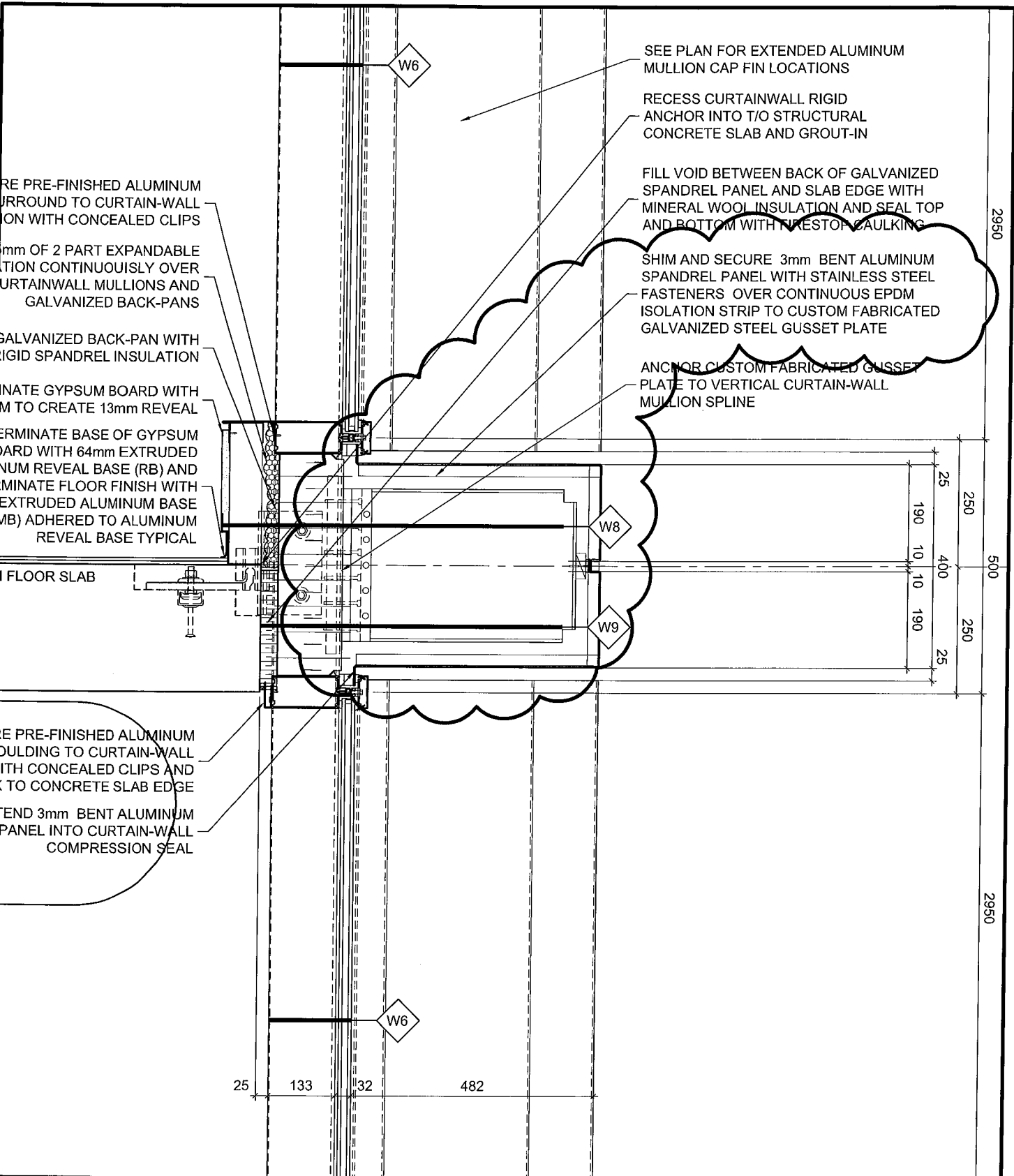

THE ANNEX / 46 ECCLES ST. OTTAWA ON K1R 6S3  
 613.567.7888 PHONE / 613.567.7528 FAX  
 cssarchitect.com



PROJECT:  
**TOMLINSON NEW BUILDING**

DRAWING TITLE:  
**REFERENCE PARTIAL DETAIL 12/A601**

DATE: 2017/02/09

SCALE: 1:10

DRAWN BY: JK

JOB No: 574-15

DRAWING No:  
**ASK-84**

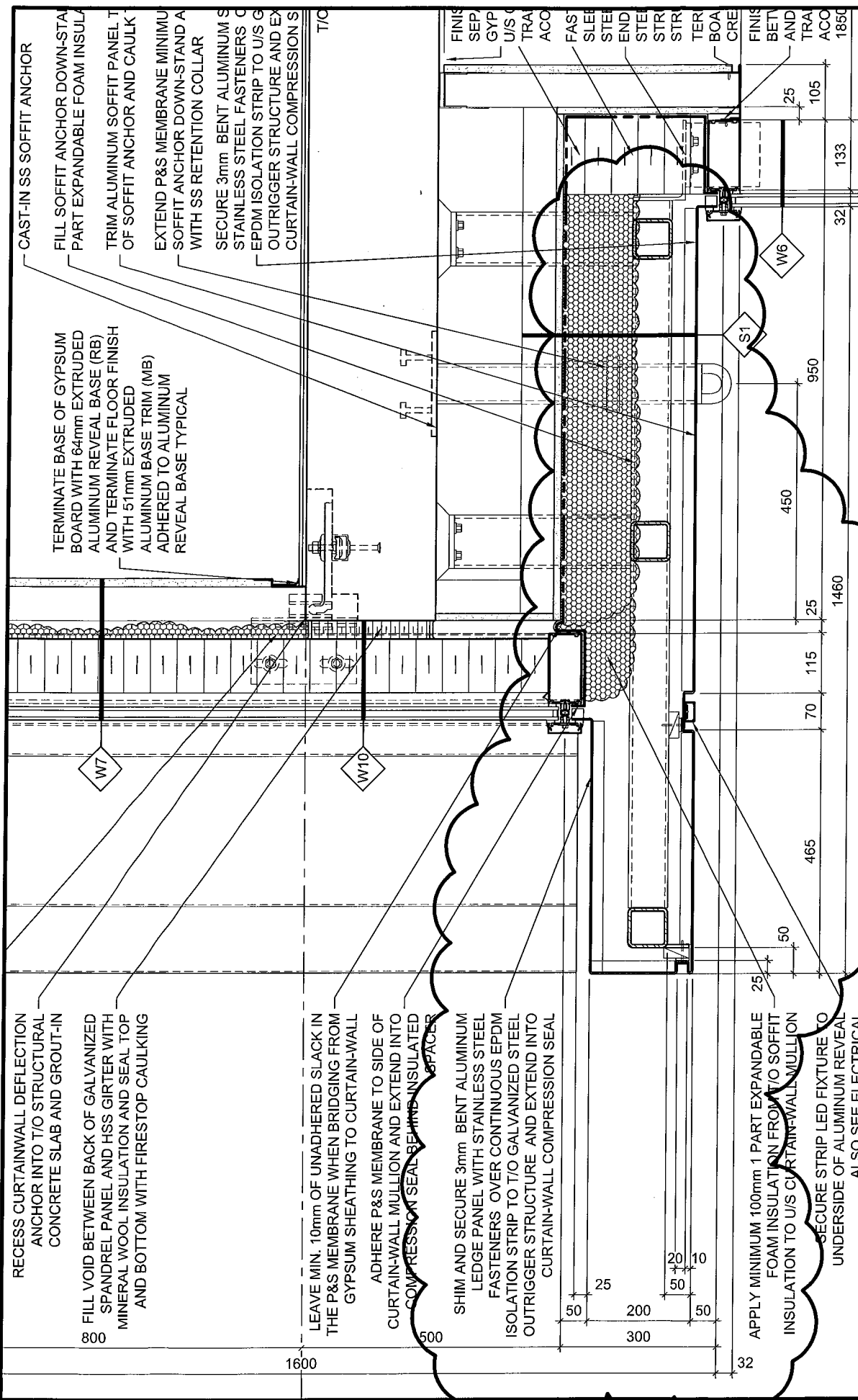

RECESS CURTAINWALL DEFLECTION ANCHOR INTO T/O STRUCTURAL CONCRETE SLAB AND GROUT-IN

FILL VOID BETWEEN BACK OF GALVANIZED SPANDREL PANEL AND HSS GIRTER WITH MINERAL WOOL INSULATION AND SEAL TOP AND BOTTOM WITH FIRESTOP CAULKING

LEAVE MIN. 10mm OF UNADHERED SLACK IN THE P&S MEMBRANE WHEN BRIDGING FROM GYPSUM SHEATHING TO CURTAIN-WALL

ADHERE P&S MEMBRANE TO SIDE OF CURTAIN-WALL MULLION AND EXTEND INTO COMPRESSION SEAL BEHIND INSULATED SPACER

SHIM AND SECURE 3mm BENT ALUMINUM LEDGE PANEL WITH STAINLESS STEEL FASTENERS OVER CONTINUOUS EPDM ISOLATION STRIP TO T/O GALVANIZED STEEL OUTRIGGER STRUCTURE AND EXTEND INTO CURTAIN-WALL COMPRESSION SEAL

APPLY MINIMUM 100mm 1 PART EXPANDABLE FOAM INSULATION FROM T/O SOFFIT INSULATION TO U/S CURTAIN-WALL MULLION

SECURE STRIP LED FIXTURE TO UNDERSIDE OF ALUMINUM REVEAL ALSO SEE ELECTRICAL

TERMINATE BASE OF GYPSUM BOARD WITH 64mm EXTRUDED ALUMINUM REVEAL BASE (RB) AND TERMINATE FLOOR FINISH WITH 51mm EXTRUDED ALUMINUM BASE TRIM (MB) ADHERED TO ALUMINUM REVEAL BASE TYPICAL

CAST-IN SS SOFFIT ANCHOR

FILL SOFFIT ANCHOR DOWN-STAIR PART EXPANDABLE FOAM INSULATION

TRIM ALUMINUM SOFFIT PANEL TO OF SOFFIT ANCHOR AND CAULK

EXTEND P&S MEMBRANE MINIMUM SOFFIT ANCHOR DOWN-STAIR WITH SS RETENTION COLLAR

SECURE 3mm BENT ALUMINUM STAINLESS STEEL FASTENERS TO EPDM ISOLATION STRIP TO U/S OUTRIGGER STRUCTURE AND EXTEND INTO CURTAIN-WALL COMPRESSION SEAL

DATE:	2017/02/09
SCALE:	1:10
DRAWN BY:	JK
JOB No.:	574-15
DRAWING No.:	ASK-85

PROJECT: TOMLINSON NEW BUILDING

DRAWING TITLE: REFERENCE PART DETAIL 11/A601

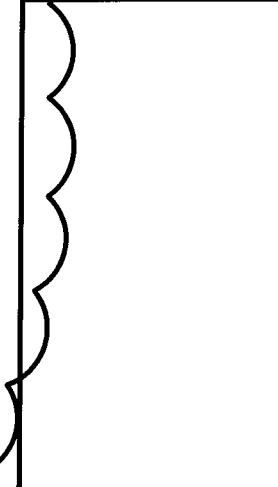

**Christopher Simmonds Architect**

THE ANNEX / RECULLES ST. OTTAWA ON K1R 8R3  
 613.567.7888 PHONE / 613.567.7528 FAX  
 csaarchitect.com

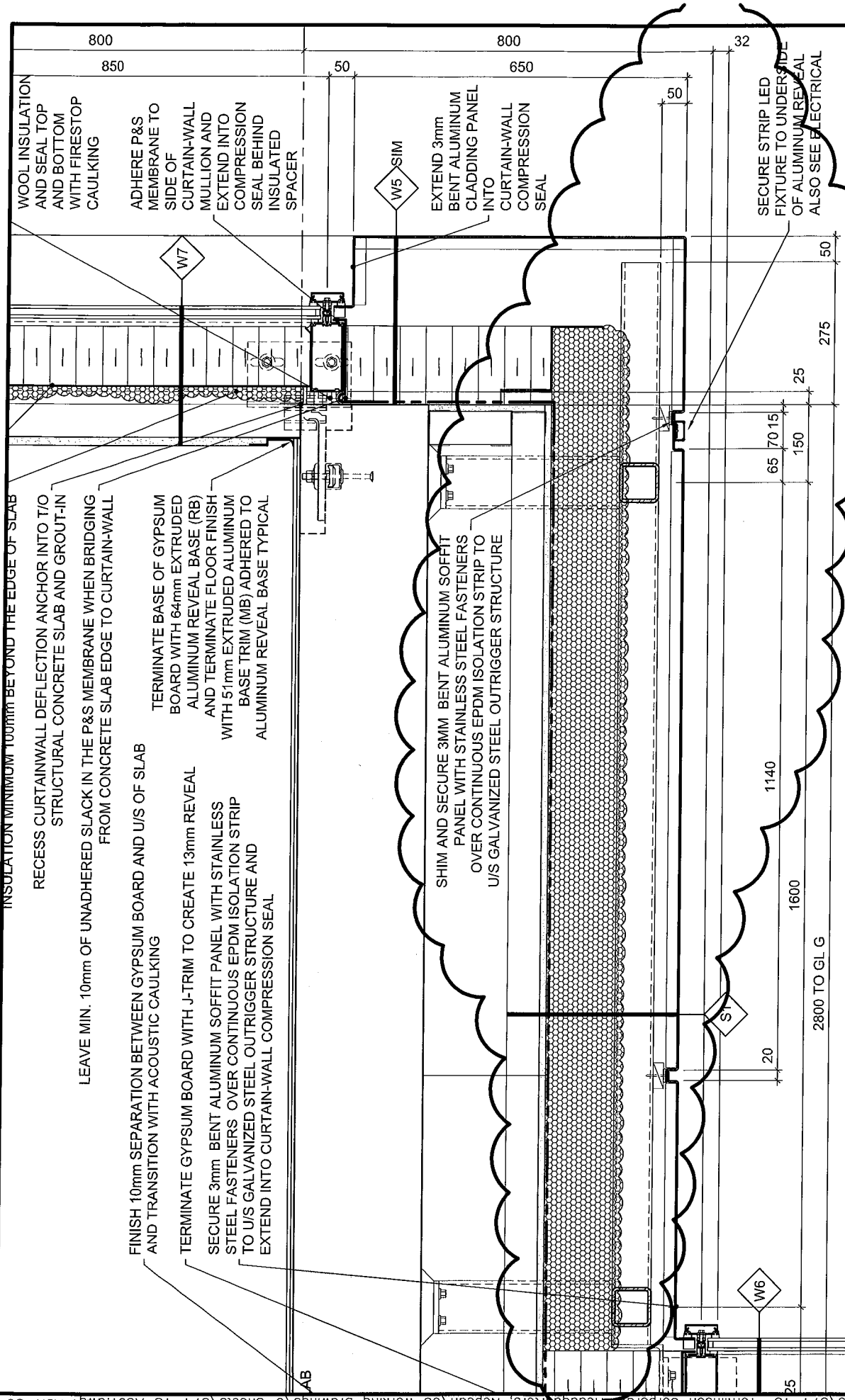

INSULATION MINIMUM 100mm BEYOND THE EDGE OF SLAB

RECESS CURTAINWALL DEFLECTION ANCHOR INTO T/O STRUCTURAL CONCRETE SLAB AND GROUT-IN

LEAVE MIN. 10mm OF UNADHERED SLACK IN THE P&S MEMBRANE WHEN BRIDGING FROM CONCRETE SLAB EDGE TO CURTAIN-WALL

FINISH 10mm SEPARATION BETWEEN GYPSUM BOARD AND U/S OF SLAB AND TRANSITION WITH ACOUSTIC CAULKING

TERMINATE GYPSUM BOARD WITH J-TRIM TO CREATE 13mm REVEAL

SECURE 3mm BENT ALUMINUM SOFFIT PANEL WITH STAINLESS STEEL FASTENERS OVER CONTINUOUS EPDM ISOLATION STRIP TO U/S GALVANIZED STEEL OUTRIGGER STRUCTURE AND EXTEND INTO CURTAIN-WALL COMPRESSION SEAL

TERMINATE BASE OF GYPSUM BOARD WITH 64mm EXTRUDED ALUMINUM REVEAL BASE (RB) AND TERMINATE FLOOR FINISH WITH 51mm EXTRUDED ALUMINUM BASE TRIM (MB) ADHERED TO ALUMINUM REVEAL BASE TYPICAL

SHIM AND SECURE 3MM BENT ALUMINUM SOFFIT PANEL WITH STAINLESS STEEL FASTENERS OVER CONTINUOUS EPDM ISOLATION STRIP TO U/S GALVANIZED STEEL OUTRIGGER STRUCTURE

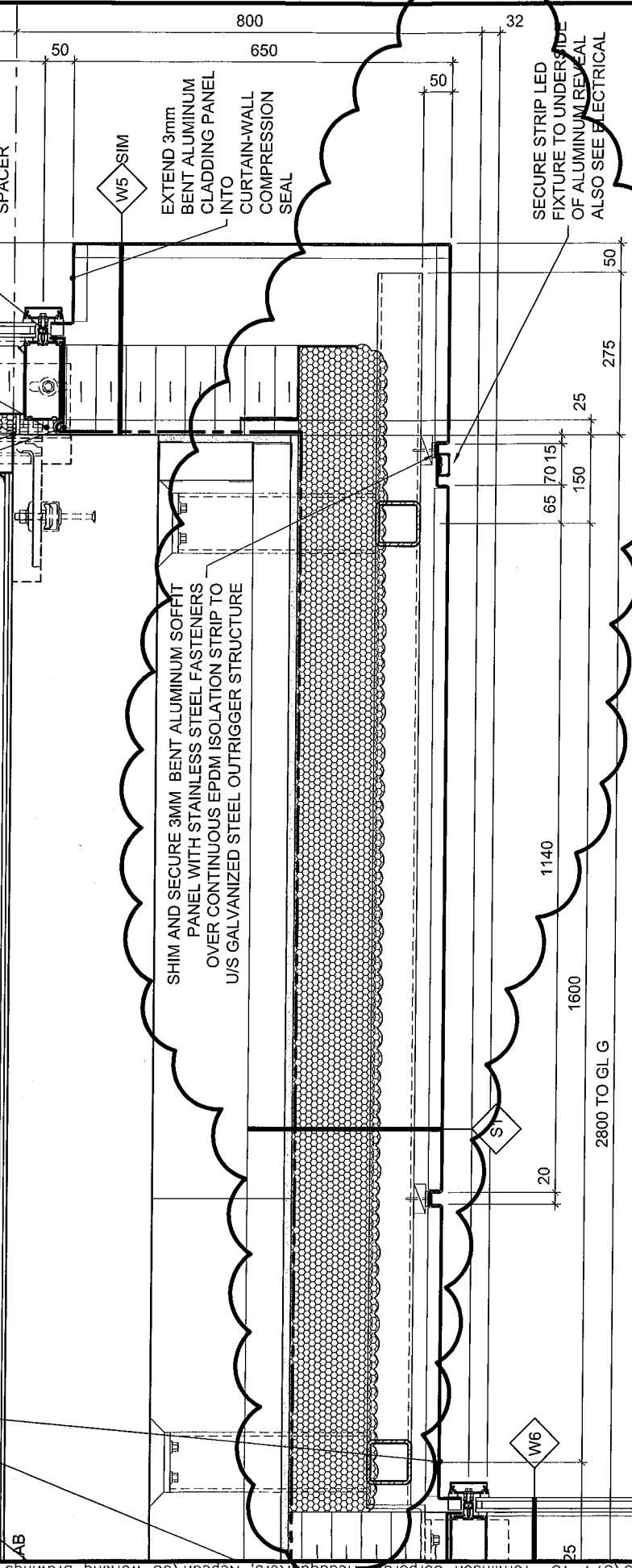

DATE:	2017/02/09
SCALE:	1:10
DRAWN BY:	JK
JOB No:	574-15
DRAWING No:	ASK-86

PROJECT:  
TOMLINSON NEW BUILDING

DRAWING TITLE:  
REFERENCE PART DETAIL 13/A601

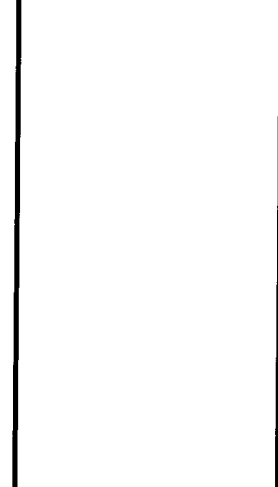

**Christopher Simmonds Architect**

115, ANNEX #600, 465, ST. OTTAWA, ON N1K 6K3  
 613.567.7888 PHONE / 613.567.7528 FAX  
 csaarchitect.com

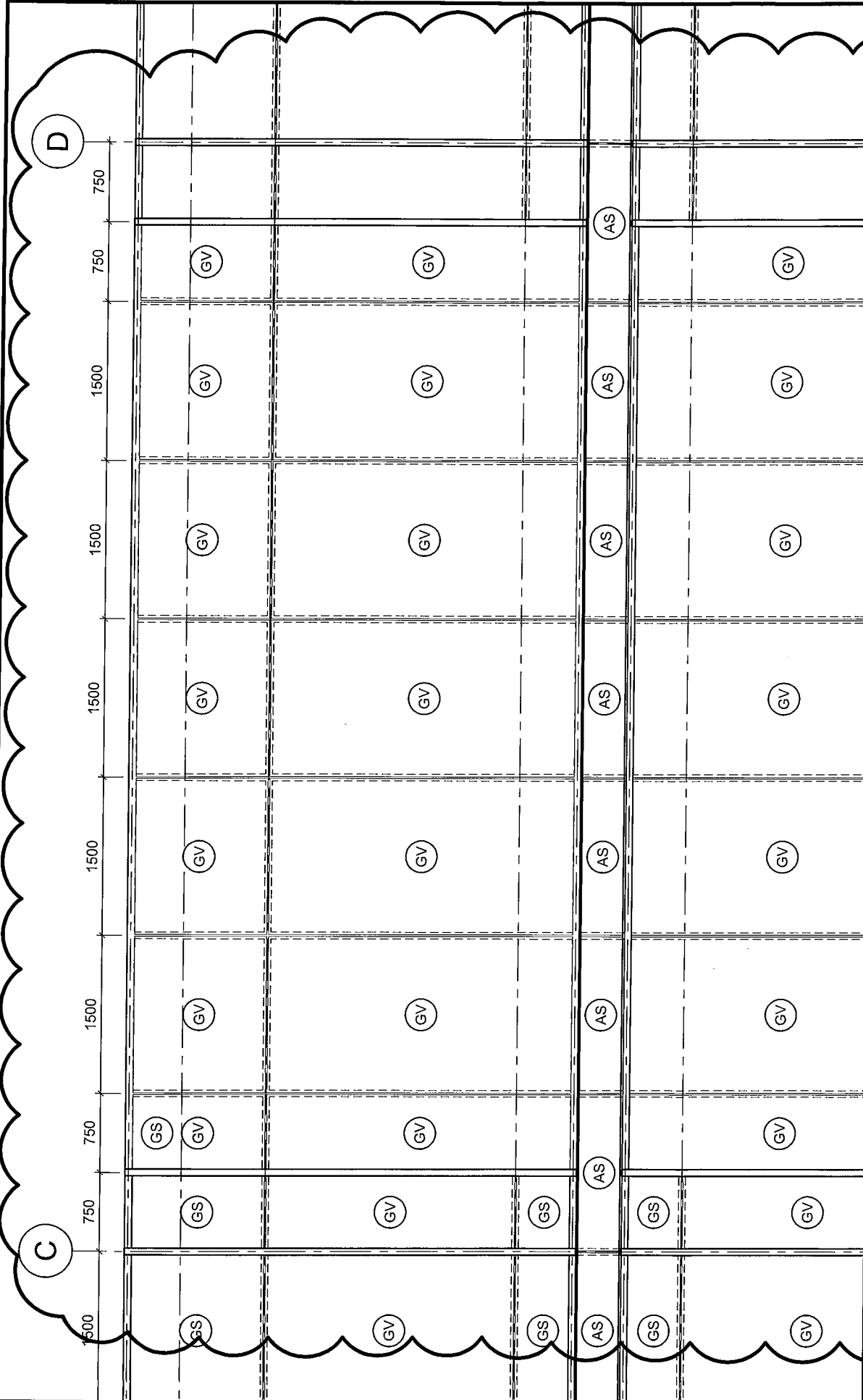

DATE:	2017/02/09
SCALE:	1:50
DRAWN BY:	JK
JOB No:	574-15
DRAWING No:	ASK-87

PROJECT:  
**TOMLINSON NEW BUILDING**

DRAWING TITLE:  
**REFERENCE PART DETAIL 4/A951**

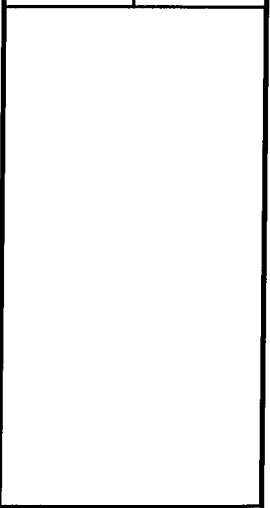

**Christopher Simmonds Architect**

THE ANNEX, WHEELER ST. OTTAWA ON K1R 6S1  
 613.567.7888 PHONE / 613.567.7528 FAX  
 csaarchitect.com

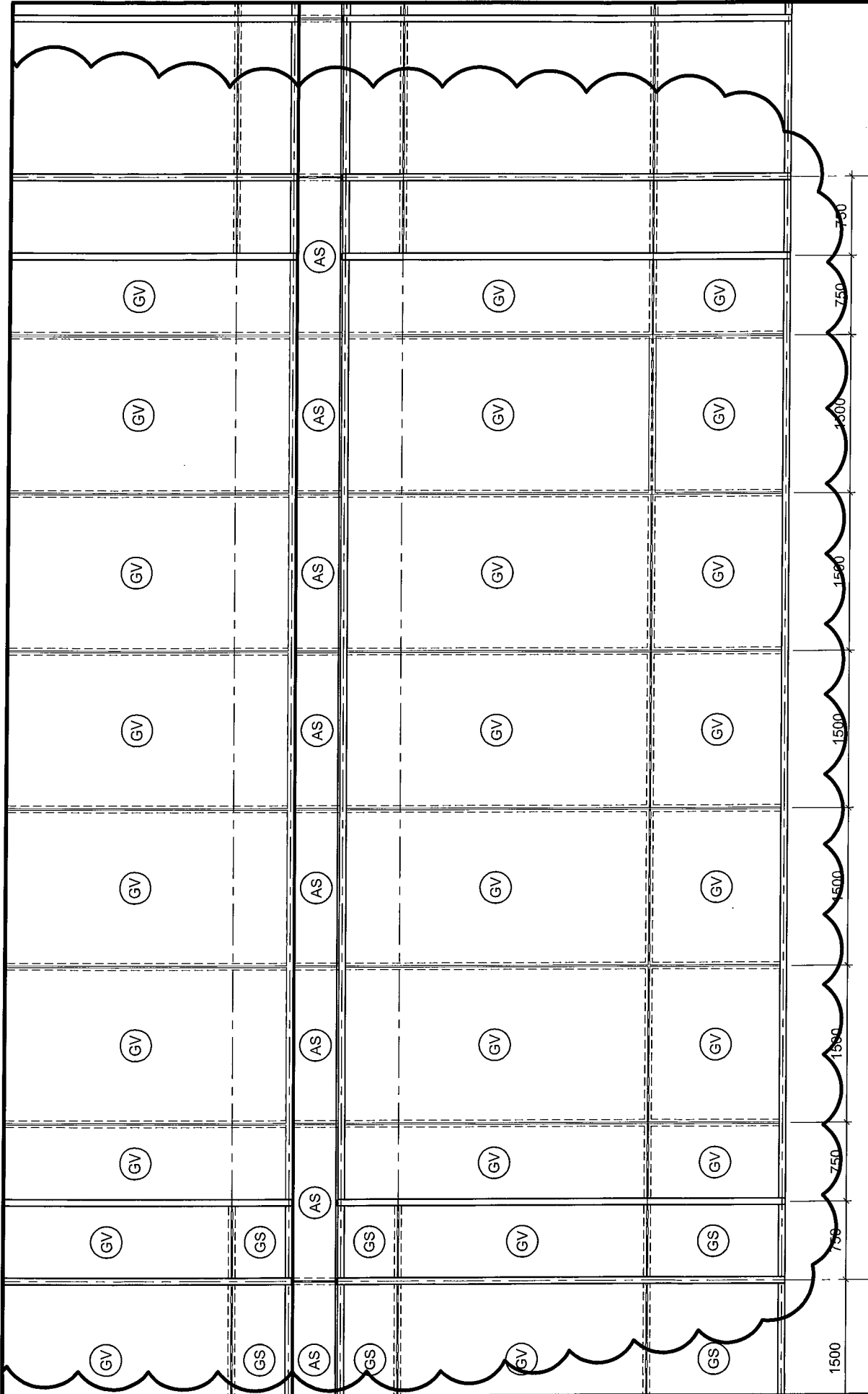

DATE:	2017/02/09
SCALE:	1:50
DRAWN BY:	JK
JOB No:	574-15
DRAWING No:	ASK-88

PROJECT:  
**TOMLINSON NEW BUILDING**

DRAWING TITLE:  
**REFERENCE PART DETAIL 4/A951**

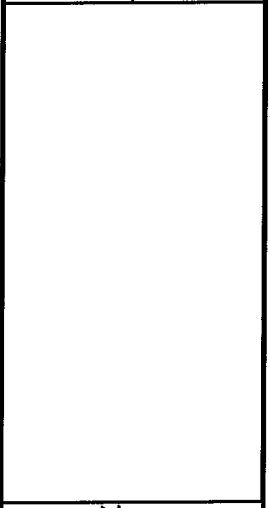

THE ANNEX/4600 LEE ST. OTTAWA ON K1R4S3  
 613.697.7888 PHONE / 613.697.7228 FAX  
 csaarchitect.com

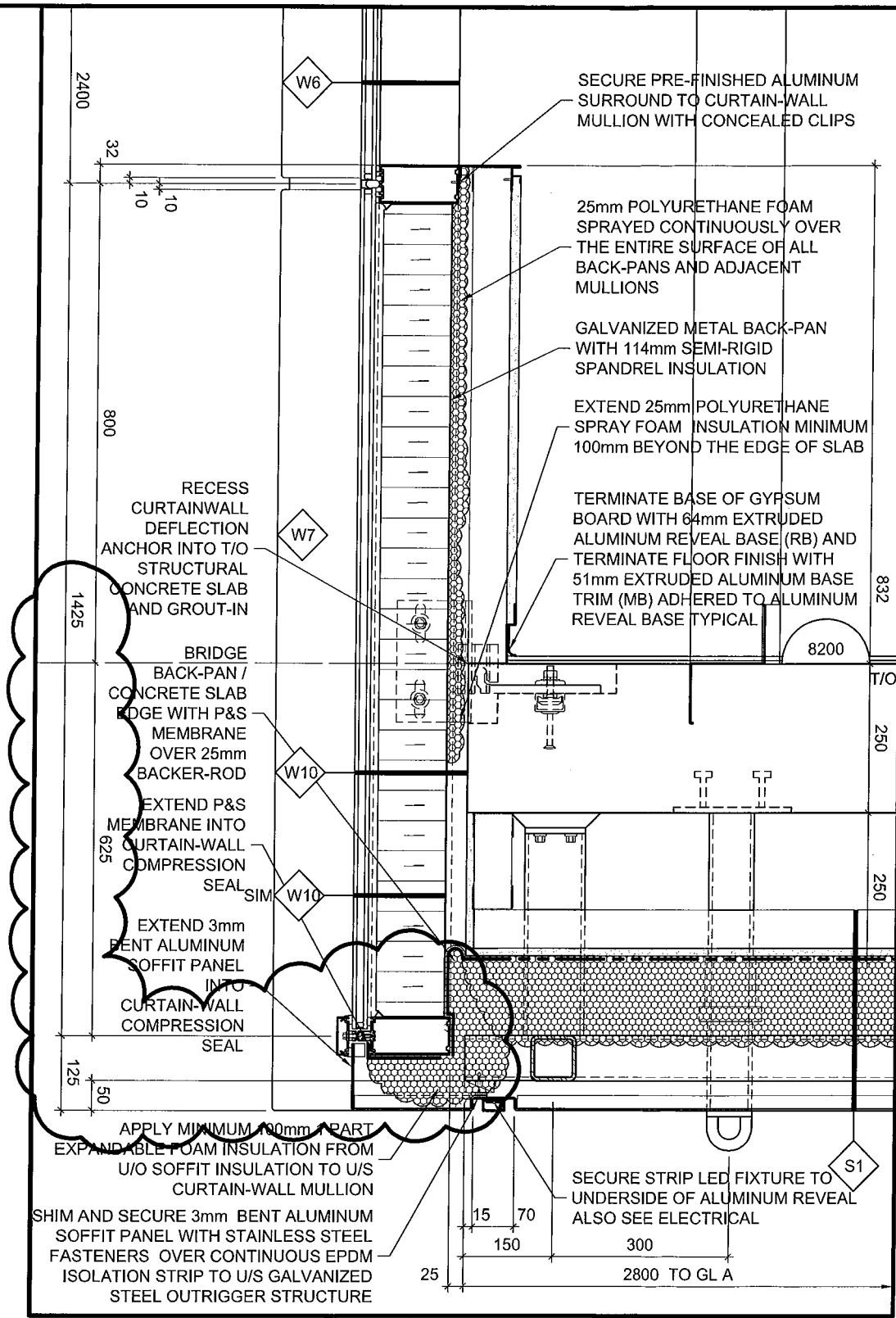

THE ANNEX / 46 ECCLES ST. OTTAWA ON K1R 6S1  
 613.567.7888 PHONE / 613.567.7528 FAX  
 csarchitect.com



PROJECT:  
 TOMLINSON NEW BUILDING

DRAWING TITLE:  
 REFERENCE DETAIL 13/A602

DATE: 03/17/2017

SCALE: 1:10

DRAWN BY: JK

JOB No: 574-15

DRAWING No:  
**ASK-122**

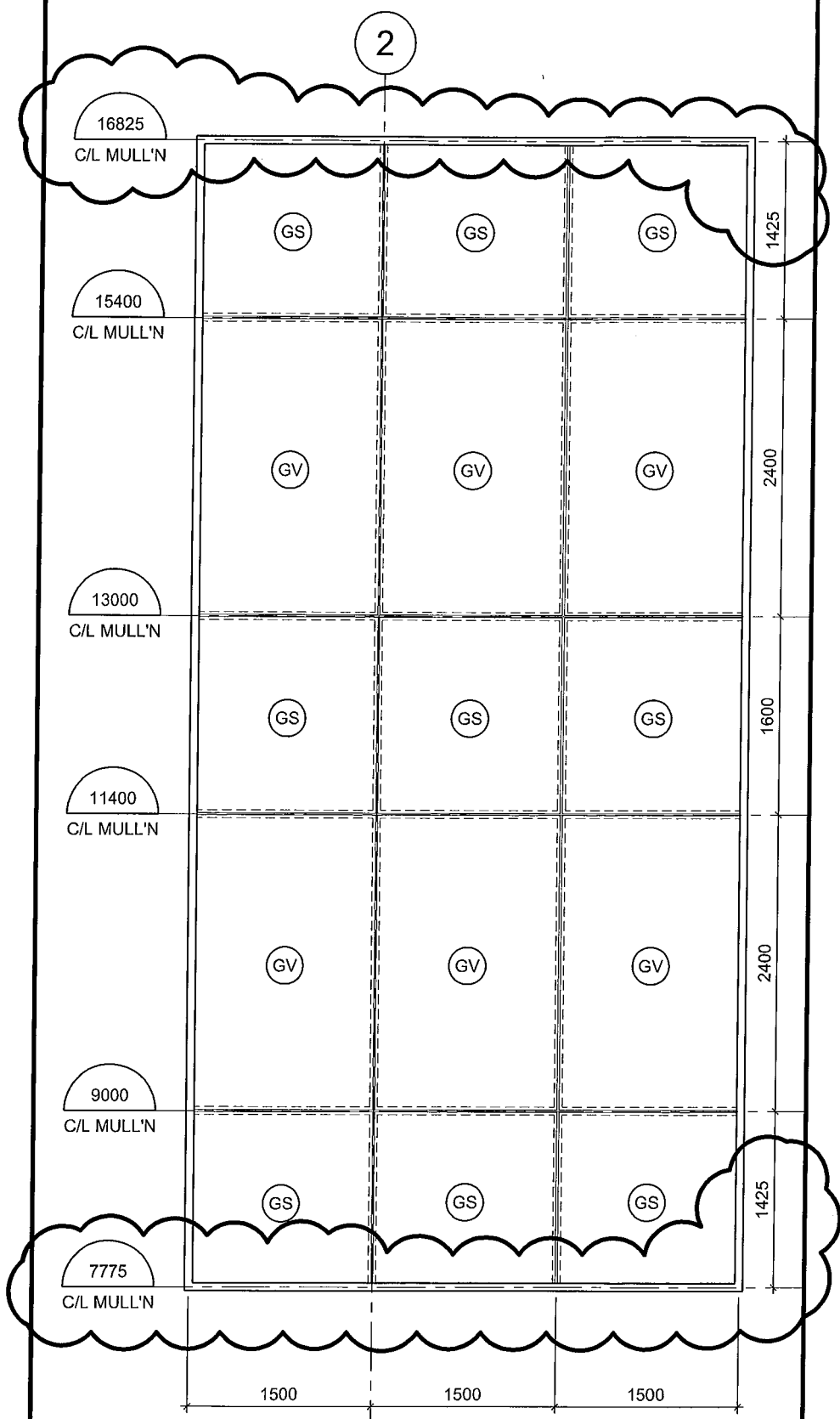

THE ANNEX / 45 ECCLES ST. OTTAWA ON K1R 6S3  
 613.567.7888 PHONE / 613.567.7526 FAX  
 csarchitect.com



PROJECT:  
 TOMLINSON NEW BUILDING

DRAWING TITLE:  
 REFERENCE DETAIL 2/A602

DATE: 03/17/2017  
 SCALE: 1:50  
 DRAWN BY: JK  
 JOB No: 574-15

DRAWING No:  
**ASK-123**