



TAL-CO SUPPLEMENTAL INSTRUCTION #50			
Project Name:	RW TOMLINSON - NEW HEAD OFFICE		
Project Location:	100 CitiGate Drive, Ottawa, Ontario		
ARCH. SI #:	Various; See below.	Issued By:	Chris Simpson
STRUC. SI #:		Date Issued:	July 24, 2017
MECH. SI #:		Revision #:	N/A
ELEC. SI #:		Revision Date:	N/A

Supplemental Instructions are issued by the Construction Manager to record a clarification or revision to the previously issued Contract Documentation as reflected by the attached information prepared by the identified Professionals.

The Construction Manager shall review the Supplemental Instruction and the attached information and issue to the affected Trade Contractors identifying the following course of action by the Trade Contractor.

Notify TAL-CO within 5 days of receipt, if the attached documents will require a change to Contract Price or Schedule.

Title: Rename/Re-label Room 422

Reference:

Architectural Drawings - Construction Update issued April 27th 2017, and subsequent drawing updates.

Attachments:

ASK - 164

ASK - 165

Room Finish Schedule 09 06 00 Rev 07

Description of the Work:

Room Finish Schedule Specification 09 06 00 re-issued with sketches to clarify room & door numberings on Floor 4, Main Building.

Reason:

To correct duplicate labeling in both rooms (Rooms 422 changed to Room 422A and 422B).

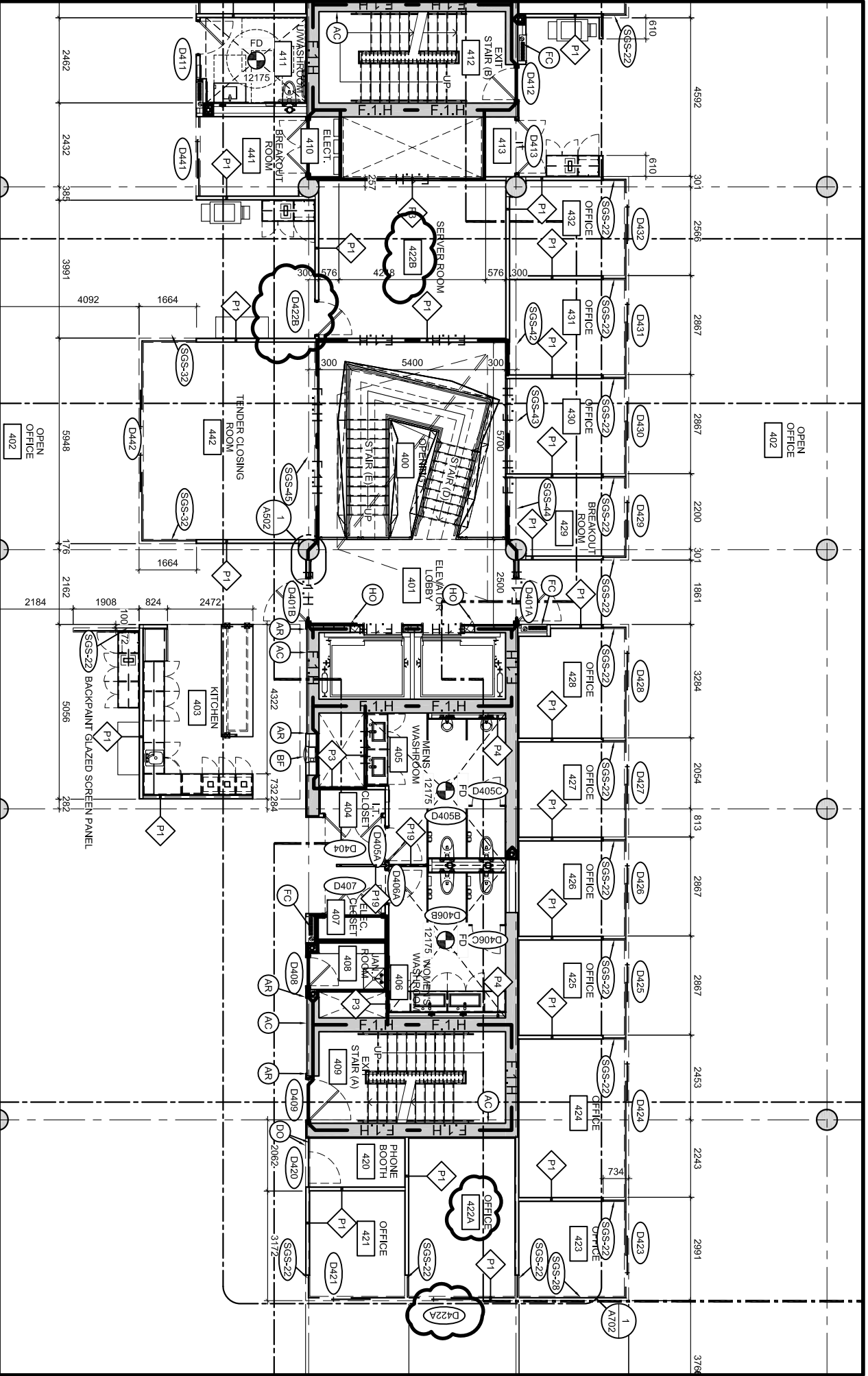

THE ANNEX/485 EGLIS ST. OTTAWA, ON K1R 6S8
 613.567.7888 PHONE / 613.567.7528 FAX
Christopher Simmonds
 Architect
 csaarchitect.com

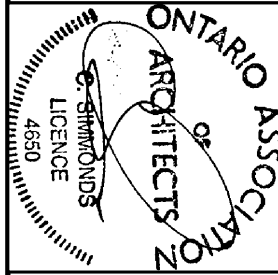

PROJECT:
TOMLINSON NEW BUILDING

DRAWING TITLE:
REFERENCE PARTIAL PLAN 1/A104

DATE: 2017/07/24
 SCALE: 1:150
 DRAWN BY: JJK
 JOB No: 574-15
 DRAWING No: ASK-165

		FOURTH FLOOR									
		D401A	1220	2440	SCD-1	3/4HR	WDF-1	3/4HR	11/A002		
		D401B	1220	2440	SCD-1	3/4HR	WDF-1	3/4HR	11/A002		
		D404	2X813	2440	SCD-1	N/A	WDF-1	N/A	9/A002		
		D405A	950	2440	SCD-1	N/A	WDF-1	N/A	9/A002		
		D405B	813	2440	SCD-1	N/A	WDF-1	N/A	9/A002		
		D405C	813	2440	SCD-1	N/A	WDF-1	N/A	9/A002		
		D406A	950	2440	SCD-1	N/A	WDF-1	N/A	9/A002		
		D406B	813	2440	SCD-1	N/A	WDF-1	N/A	9/A002		
		D406C	813	2440	SCD-1	N/A	WDF-1	N/A	9/A002		
		D407	2X813	2440	SCD-1	3/4HR	WDF-1	3/4HR	11/A002		
		D408	813	2440	SCD-1	3/4HR	WDF-1	3/4HR	11/A002		
		D409	1169	2440	SCD-2	3/4HR	WDF-1	3/4HR	11/A002		
		D410	2X762	2440	SCD-1	3/4HR	WDF-1	3/4HR	11/A002		
		D411	950	2440	SCD-1	N/A	WDF-1	N/A	9/A002		
		D412	915	2440	SCD-2	3/4HR	WDF-1	3/4HR	11/A002		
		D413	2X762	2440	SCD-1	N/A	WDF-1	N/A	9/A002		
		D414-419							RESERVED		
		D420	915	2440	SGD-1	N/A	SGS-50	N/A	N/A		
		D421	915	2750	SGD-1	N/A	SGS-27	N/A	N/A		
		D422A	915	2750	SGD-1	N/A	SGS-35	N/A	N/A		
		D422B	950	2440	SCD-1	N/A	WDF-1	N/A	9/A002		
		D423	945	2750	SGD-1	N/A	SGS-47	N/A	N/A		
		D424	915	2750	SGD-1	N/A	SGS-48	N/A	N/A		
		D425	915	2750	SGD-1	N/A	SGS-7	N/A	N/A		
		D426	915	2750	SGD-1	N/A	SGS-7	N/A	N/A		
		D427	915	2750	SGD-1	N/A	SGS-7	N/A	N/A		
		D428	915	2750	SGD-1	N/A	SGS-13	N/A	N/A		
		D429	915	2750	SGD-1	N/A	SGS-1	N/A	N/A		
		D430	915	2750	SGD-1	N/A	SGS-7	N/A	N/A		
		D431	915	2750	SGD-1	N/A	SGS-7	N/A	N/A		
		D432	915	2750	SGD-1	N/A	SGS-8	N/A	N/A		
		D433	915	2750	SGD-1	N/A	SGS-47	N/A	N/A		
		D434	915	2750	SGD-1	N/A	SGS-7	N/A	N/A		
		D435	915	2750	SGD-1	N/A	SGS-7	N/A	N/A		
		D436	915	2750	SGD-1	N/A	SGS-7	N/A	N/A		
		D437	915	2750	SGD-1	N/A	SGS-7	N/A	N/A		
		D438	915	2750	SGD-1	N/A	SGS-7	N/A	N/A		
		D439	915	2750	SGD-1	N/A	SGS-7	N/A	N/A		
		D440	915	2750	SGD-1	N/A	SGS-7	N/A	N/A		
		D441	915	2750	SGD-1	N/A	SGS-7	N/A	N/A		
		D442	915	2750	SGD-1	N/A	SGS-7	N/A	N/A		
		D443	915	2750	SGD-1	N/A	SGS-7	N/A	N/A		
		D444	915	2750	SGD-1	N/A	SGS-7	N/A	N/A		
		D445	915	2750	SGD-1	N/A	SGS-7	N/A	N/A		
		D446	915	2750	SGD-1	N/A	SGS-7	N/A	N/A		
		D447	915	2750	SGD-1	N/A	SGS-7	N/A	N/A		
		D448	915	2750	SGD-1	N/A	SGS-7	N/A	N/A		
		D449	915	2750	SGD-1	N/A	SGS-7	N/A	N/A		
		D450	915	2750	SGD-1	N/A	SGS-7	N/A	N/A		
		D451	915	2750	SGD-1	N/A	SGS-7	N/A	N/A		
		D452	915	2750	SGD-1	N/A	SGS-7	N/A	N/A		
		D453	915	2750	SGD-1	N/A	SGS-7	N/A	N/A		
		D454	915	2750	SGD-1	N/A	SGS-7	N/A	N/A		
		D455	915	2750	SGD-1	N/A	SGS-7	N/A	N/A		
		D456	915	2750	SGD-1	N/A	SGS-7	N/A	N/A		
		D457	915	2750	SGD-1	N/A	SGS-7	N/A	N/A		
		D458	915	2750	SGD-1	N/A	SGS-7	N/A	N/A		
		D459	915	2750	SGD-1	N/A	SGS-7	N/A	N/A		
		D460	915	2750	SGD-1	N/A	SGS-7	N/A	N/A		
		D461	915	2750	SGD-1	N/A	SGS-7	N/A	N/A		
		D462	915	2750	SGD-1	N/A	SGS-7	N/A	N/A		
		D463	915	2750	SGD-1	N/A	SGS-7	N/A	N/A		
		D464	915	2750	SGD-1	N/A	SGS-7	N/A	N/A		
		D465	915	2750	SGD-1	N/A	SGS-7	N/A	N/A		
		D466	915	2750	SGD-1	N/A	SGS-7	N/A	N/A		
		D467	915	2750	SGD-1	N/A	SGS-7	N/A	N/A		
		D468	915	2750	SGD-1	N/A	SGS-7	N/A	N/A		
		D469	915	2750	SGD-1	N/A	SGS-7	N/A	N/A		
		D470	915	2750	SGD-1	N/A	SGS-7	N/A	N/A		
		D471	915	2750	SGD-1	N/A	SGS-7	N/A	N/A		
		D472	915	2750	SGD-1	N/A	SGS-7	N/A	N/A		
		D473	915	2750	SGD-1	N/A	SGS-7	N/A	N/A		
		D474	915	2750	SGD-1	N/A	SGS-7	N/A	N/A		
		D475	915	2750	SGD-1	N/A	SGS-7	N/A	N/A		
		D476	915	2750	SGD-1	N/A	SGS-7	N/A	N/A		
		D477	915	2750	SGD-1	N/A	SGS-7	N/A	N/A		
		D478	915	2750	SGD-1	N/A	SGS-7	N/A	N/A		
		D479	915	2750	SGD-1	N/A	SGS-7	N/A	N/A		
		D480	915	2750	SGD-1	N/A	SGS-7	N/A	N/A		
		D481	915	2750	SGD-1	N/A	SGS-7	N/A	N/A		
		D482	915	2750	SGD-1	N/A	SGS-7	N/A	N/A		
		D483	915	2750	SGD-1	N/A	SGS-7	N/A	N/A		
		D484	915	2750	SGD-1	N/A	SGS-7	N/A	N/A		
		D485	915	2750	SGD-1	N/A	SGS-7	N/A	N/A		
		D486	915	2750	SGD-1	N/A	SGS-7	N/A	N/A		
		D487	915	2750	SGD-1	N/A	SGS-7	N/A	N/A		
		D488	915	2750	SGD-1	N/A	SGS-7	N/A	N/A		
		D489	915	2750	SGD-1	N/A	SGS-7	N/A	N/A		
		D490	915	2750	SGD-1	N/A	SGS-7	N/A	N/A		
		D491	915	2750	SGD-1	N/A	SGS-7	N/A	N/A		
		D492	915	2750	SGD-1	N/A	SGS-7	N/A	N/A		
		D493	915	2750	SGD-1	N/A	SGS-7	N/A	N/A		
		D494	915	2750	SGD-1	N/A	SGS-7	N/A	N/A		
		D495	915	2750	SGD-1	N/A	SGS-7	N/A	N/A		
		D496	915	2750	SGD-1	N/A	SGS-7	N/A	N/A		
		D497	915	2750	SGD-1	N/A	SGS-7	N/A	N/A		
		D498	915	2750	SGD-1	N/A	SGS-7	N/A	N/A		
		D499	915	2750	SGD-1	N/A	SGS-7	N/A	N/A		
		D500	915	2750	SGD-1	N/A	SGS-7	N/A	N/A		
		D501	915	2750	SGD-1	N/A	SGS-7	N/A	N/A		
		D502	915	2750	SGD-1	N/A	SGS-7	N/A	N/A		
		D503	915	2750	SGD-1	N/A	SGS-7	N/A	N/A		
		D504	915	2750	SGD-1	N/A	SGS-7	N/A	N/A		
		D505	915	2750	SGD-1	N/A	SGS-7	N/A	N/A		
		D506	915	2750	SGD-1	N/A	SGS-7	N/A	N/A		
		D507	915	2750	SGD-1	N/A	SGS-7	N/A	N/A		
		D508	915	2750	SGD-1	N/A	SGS-7	N/A	N/A		
		D509	915	2750	SGD-1	N/A	SGS-7	N/A	N/A		
		D510	915	2750	SGD-1	N/A	SGS-7	N/A	N/A		
		D511	915	2750	SGD-1	N/A	SGS-7	N/A	N/A		
		D512	915	2750	SGD-1	N/A	SGS-7	N/A	N/A		
		D513	915	2750	SGD-1	N/A	SGS-7	N/A	N/A		
		D514	915	2750	SGD-1	N/A	SGS-7	N/A	N/A		
		D515	915	2750	SGD-1	N/A	SGS-7	N/A	N/A		
		D516	915	2750	SGD-1	N/A	SGS-7	N/A	N/A		
		D517	915	2750	SGD-1	N/A	SGS-7	N/A	N/A		
		D518	915	2750	SGD-1	N/A	SGS-7	N/A	N/A		
		D519	915	2750	SGD-1	N/A	SGS-7	N/A	N/A		
		D520	915	2750	SGD-1	N/A	SGS-7	N/A	N/A		
		D521	915	2750	SGD-1	N/A	SGS-7	N/A	N/A		
		D522	915	2750	SGD-1	N/A	SGS-7	N/A	N/A		
		D523	915	2750	SGD-1	N/A	SGS-7	N/A	N/A		
		D524	915	2750	SGD-1	N/A	SGS-7	N/A	N/A		
		D525	915	2750	SGD-1	N/A	SGS-7	N/A	N/A		
		D526	915	2750	SGD-1	N/A	SGS-7	N/A	N/A		
		D527	915	2750	SGD-1	N/A	SGS-7	N/A	N/A		

NO	NAME	FLOOR		BASE		WALLS		CEILING		REMARKS
		MAT	FIN	MAT	FIN	MAT	FIN	MAT	FIN	

GROUND FLOOR										
100	ATRIUM	CT1 ST	-	-	-	CONC GYP CG AT1	EXP P	CONC AT1	CONC AT1	CPT1 bridge flooring, concrete wall finish – board form vertical, water wall coloured glass, acoustic panels in front of water wall. BR base only at GYP walls. No Base at glass and concrete partitions.
101	EAST VESTIBULE	CT1	-	-	-	CONC	EXP	CONC	EXP	
102	WEST VESTIBULE	CT1	-	-	-	CONC	EXP	CONC	EXP	
103	ELEVATOR LOBBY	CT1	-	BR MB	-	GYP	P1	CONC	EXP	BR base at GYP partitions, MB base at exposed concrete walls
104	IT CLOSET	CT1	-	CT	-	CONC GYP	EXP P1	CONC	EXP	
105	MEN'S WASHROOM	CT5	-	CT	-	CONC GYP CT6 CT8		ACT1	-	CT base to match floor tile (also align joints). Refer to interior elevations for locations
106	WOMEN'S WASHROOM	CT5	-	CT	-	CONC GYP CT6 CT8		ACT1	-	CT base to match floor tile (also align joints). Refer to interior elevations for locations
107	UNIVERSAL WASHROOM	CT5	-	CT	-	GYP CT	P1 CT4 CT8	ACT1	-	CT base to match floor tile (also align joints) Refer to interior elevations for locations
108	JANITOR'S ROOM	CT1	-	CT	-	CONC GYP	EXP P1	GYP	-	
109	EXIT STAIR A	CONC	EXP CT1	-	-	CONC	EXP	CONC	EXP P2	
110	ELECTRICAL/IT CLOSET	CT1	-	CT	-	CONC GYP	EXP P1	CONC	EXP P1	

NO	NAME	FLOOR		BASE		WALLS		CEILING		REMARKS
		MAT	FIN	MAT	FIN	MAT	FIN	MAT	FIN	
111	MAIL ROOM	CT1	-	BR	-	GYP	P1	GYP	P1	
112	EXIT STAIR B	CONC	Ext CT1	-	-	CONC	EXP	CONC	EXP P2	
113	COAT CLOSET	CT1	-	BR	-	CONC GYP	EXP	CONC	EXP P1	
114	CAFETERIA	CT1	-	BR MB	-	CONC GYP AT1 CT3	EXP P1 PL1	CONC AT1 AT2	EXP	BR base at GYP partitions, MB base at exposed concrete walls
115	KITCHEN	HF		RB	-	CONC GYP	HW	CONC	EXP	RB base-refer to specifications for Hygienic wall covering and hygienic floor covering
116	ELECTRICAL ROOM	CONC		RB	-	CONC GYP	EXP P1	CONC	EXP	Epoxy finish to concrete floor
117	HOLDING ROOM	RF		RB	-	GYP	P1	CONC	EXP	
117B	HOLDING ROOM VESTIBULE	RF		RB	-	GYP	P1	CONC	EXP	
118	EXIT CORRIDOR	CT1	-	MB	-	GYP CONC	EXP P1	GYP	P1	
119	LOADING VESTIBULE	CT1	-	MB	-	GYP	P1	CONC	EXP	
120	OPEN OFFICE	CPT 1,2,3,4	-	BR MB	-	GYP	P	CONC	EXP	BR base at GYP partitions, MB base at exposed concrete walls
121	BREAKOUT ROOM	CPT 1,2,3,4	-	BR	-	GYP	P	CONC	EXP	
122	OFFICE	CPT 1,2,3,4	-	BR	-	GYP	P	CONC	EXP	
123	OFFICE	CPT 1,2,3,4	-	BR	-	GYP	P	CONC	EXP	
124	WATER ENTRY ROOM	CONC	-	MB	-	GYP	P	CONC	EXP	Sealer to concrete floor
125	OFFICE	CPT	-	BR MB	-	GYP	P	CONC	EXP	BR base at GYP partitions, MB base at

NO	NAME	FLOOR		BASE		WALLS		CEILING		REMARKS
		MAT	FIN	MAT	FIN	MAT	FIN	MAT	FIN	
		1,2,3,4								exposed concrete walls
126	OFFICE	CPT 1,2,3,4	-	BR MB	-	GYP	P	CONC	EXP	BR base at GYP partitions, MB base at exposed concrete walls
127	UNUSED									
128A	TRAINING ROOM A	CT1	-	BR MB	-	CONC GYP	EXP P1	CONC GYP	EXP P1	GYP Bulkhead at Folding Partition. BR base at GYP partitions, MB base at exposed concrete walls
129A	TRAINING ROOM B	CT1	-	BR MB	-	CONC GYP	EXP P1	CONC GYP	EXP P1	GYP Bulkhead at Folding Partition. BR base at GYP partitions, MB base at exposed concrete walls
130	EXIT CORRIDOR B	CT1	-	MB	-	GYP	P1	GYP	P1	
131	TERRACE VESTIBULE	CT1	-	MB	-	GYP	P1	CONC	EXP	
132	GYM	CPT5	-	RB MB	-	CONC GYP	EXP P	CONC	EXP	P colour TBD. BR base at GYP partitions, MB base at exposed concrete walls
133	CLOAK ROOM	CT1	-	RB MB	-	CONC GYP	EXP P	CONC	EXP	P colour TBD. BR base at GYP partitions, MB base at exposed concrete walls
134	MEN'S VESTIBULE	CT5	-	CT	-	GYP	P1	GYP	P1	CT base to match floor tile (also align joints)
135	MEN'S WASHROOM	CT5	-	CT	-	GYP CT6	P1	GYP	P1	CT base to match floor tile (also align joints)
136	MEN'S CHANGEROOM	CT5	-	CT	-	GYP	P1	GYP	P1	CT base to match floor tile (also align joints)
137	WOMEN'S VESTIBULE	CT5	-	CT	-	CONC GYP	EXP P1	GYP	P1	CT base to match floor tile (also align joints)
138	WOMEN'S WASHROOM	CT5	-	CT	-	CONC GYP CT6	EXP P1	GYP	P1	CT base to match floor tile (also align joints)
139	WOMEN'S CHANGEROOM	CT5	-	CT	-	GYP CT6 CT7 CT8	P1	GYP	P1	CT base to match floor tile (also align joints)

NO	NAME	FLOOR		BASE		WALLS		CEILING		REMARKS
		MAT	FIN	MAT	FIN	MAT	FIN	MAT	FIN	
T05	WASHROOM	CH	-			CT	CT5			All walls up to door frame height
T06	UNIVERSAL WASHROOM	CH	-	CT-5	-	GYP CT	P1 CT4 CT8	ACT1	-	Align CT base joints with wall tile Refer to interior elevations for locations. Up to door frame height
SECOND FLOOR										
200	ATRIUM	CPT1 EP	EP P1	RB MB		CONC	EXP. / P1	-	-	Bridge –CPT 1, EP on Stair C/D risers and treads. P1 on GYP walls and remaining stair finishes
201	ELEVATOR LOBBY	CPT 1,2,3,4		BR		GYP	P1	CONC.	EXP.	
202	OPEN OFFICE	CPT 1,2,3,4		RB MB	-	GYP	P	CONC.	EXP.	BR base at GYP partitions, MB base at exposed concrete walls. P colours TBD
203	KITCHEN	CT1		BR MB		CONC GYP	EXP. / P1/ PL1	AT2		BR base at GYP partitions, MB base at exposed concrete walls. P colours TBD
204	IT CLOSET	RF	-	RB	-	GYP	P1	CONC.	EXP./P 1	
205	MEN'S WASHROOM	CT5	-	CT	-	CONC GYP CT6 CT8		ACT1	-	CT base to match floor tile (also align joints). Refer to interior elevations for locations
206	WOMEN'S WASHROOM	CT5	-	CT	-	CONC GYP CT6		ACT1	-	CT base to match floor tile (also align joints). Refer to interior elevations for locations

NO	NAME	FLOOR		BASE		WALLS		CEILING		REMARKS
		MAT	FIN	MAT	FIN	MAT	FIN	MAT	FIN	
						CT8				
207	ELECTRICAL CLOSET	RF	-	RB	-	GYP	P1	CONC.	EXP./P 1	
208	JANITOR'S ROOM	CT1	-	CT	-	CONC GYP	EXP. / P1	CONC.	EXP.	
209	EXIT STAIR A	CONC	EXP CT1	-	-	CONC	EXP	CONC.	EXP P2	
210	ELECTRICAL CLOSET	RF	-	RB	-	CONC GYP	EXP. P1	CONC.	EXP P1	
211	UNIVERSAL WASHROOM	CT5		CT	-	GYP CT	P1 CT4 CT8	ACT1		CT base to match floor tile (also align joints)
212	EXIT STAIR B	CONC	EXP CT1	-	-	CONC	EXP	CONC	EXP P2	
213	IT CLOSET	RF	-	RB	-	CONC GYP	EXP P1	CONC	EXP P1	
214	BREAKOUT ROOM	CPT 1,2,3,4		BR	-	GYP	P	CONC	EXP	
215	PHONE BOOTH	CPT 1,2,3,4		BR		GYP	P	CONC	EXP	
216	OFFICE	CPT 1,2,3,4		BR	-	GYP	P	CONC	EXP	
217	OFFICE	CPT 1,2,3,4		BR		GYP	P	CONC	EXP	
218	BREAKOUT ROOM	CPT 1,2,3,4		BR		GYP	P	CONC	EXP	P2 on North wall. All others P1
219	OFFICE	CPT 1,2,3,4		BR	-	GYP	P	CONC	EXP	
220	OFFICE	CPT 1,2,3,4		BR		GYP	P	CONC	EXP	P6 on North wall. All others P1

NO	NAME	FLOOR		BASE		WALLS		CEILING		REMARKS
		MAT	FIN	MAT	FIN	MAT	FIN	MAT	FIN	
221	LARGE MEETING ROOM	CPT 3		BR	-	GYP	P	CONC	EXP	
222	MEETING ROOM	CPT 1,2,3,4		BR	-	GYP	P	CONC	EXP	
223	OFFICE	CPT 1,2,3,4		BR	-	GYP	P	CONC	EXP	
224	OFFICE	CPT 1,2,3,4		BR	-	GYP	P	CONC	EXP	
225	OFFICE	CPT 1,2,3,4		BR	-	GYP	P	CONC	EXP	
226	OFFICE	CPT 1,2,3,4		BR	-	GYP	P	CONC	EXP	
227	OFFICE	CPT 1,2,3,4		BR	-	GYP	P	CONC	EXP	
THIRD FLOOR										
300	ATRIUM	CPT 1 EP	EP P1	BR MB		CONC GYP	EXP P1	-	-	Bridge –CPT 1, EP on Stair C/D risers and treads. P1 on GYP walls and remaining stair finishes
301	ELEVATOR LOBBY	CPT 1,2,3,4		BR		GYP	P1	CONC	EXP	
302	OPEN OFFICE	CPT 1,2,3,4		BR MB	-	GYP	P	CONC	EXP	BR base at GYP partitions, MB base at exposed concrete walls. P colours TBD
303	KITCHEN	CT1		BR MB		CONC GYP	EXP P1/ PL1	AT2		BR base at GYP partitions, MB base at exposed concrete walls. P colours TBD
304	IT CLOSET	RF	-	RB	-	GYP	P1	CONC	EXP P1	
305	MEN'S WASHROOM	CT5	-	CT	-	CONC GYP CT6		ACT1	-	CT base to match floor tile (also align joints). Refer to interior elevations for locations

NO	NAME	FLOOR		BASE		WALLS		CEILING		REMARKS
		MAT	FIN	MAT	FIN	MAT	FIN	MAT	FIN	
						CT8				
306	WOMEN'S WASHROOM	CT5	-	CT	-	CONC GYP CT6 CT8		ACT1	-	CT base to match floor tile (also align joints). Refer to interior elevations for locations
307	ELECTRICAL CLOSET	RF	-	RB	-	GYP	P1	CONC	EXP P1	
308	JANITOR'S ROOM	CT1	-	CT	-	CONC GYP	EXP P1	CONC	EXP	
309	EXIT STAIR A	CONC	EXP CT1	-	-	CONC	EXP	CONC	EXP P2	
310	ELECTRICAL CLOSET	RF	-	RB	-	CONC GYP	EXP P1	CONC	EXP P1	
311	UNIVERSAL WASHROOM	CT5		CT	-	GYP CT	P1 CT4 CT8	ACT1		CT base to match floor tile (also align joints)
312	EXIT STAIR B	CONC	EXP CT1	-	-	CONC	EXP	CONC	EXP P2	
313	IT CLOSET	RF	-	RB	-	CONC GYP	EXP P1	CONC	EXP P1	
314	OFFICE	CPT 1,2,3,4		BR	-	GYP	P	CONC	EXP	
315	OFFICE	CPT 1,2,3,4		BR	-	GYP	P	CONC	EXP	
316	PHONE BOOTH	CPT 1,2,3,4		BR	-	GYP	P	CONC	EXP	P4 on West wall. All others P1
317	PHONE BOOTH	CPT 1,2,3,4		BR	-	GYP	P	CONC	EXP	P4 on East wall. All others P1

NO	NAME	FLOOR		BASE		WALLS		CEILING		REMARKS
		MAT	FIN	MAT	FIN	MAT	FIN	MAT	FIN	
318	OFFICE	CPT 1,2,3,4		BR	-	GYP	P	CONC	EXP	
319	OFFICE	CPT 1,2,3,4		BR	-	GYP	P	CONC	EXP	
320	OFFICE	CPT 1,2,3,4		BR	-	GYP	P	CONC	EXP	
321	PHONE BOOTH	CPT 1,2,3,4		BR	-	GYP	P	CONC	EXP	P2 on West wall. All others P1
322	MEETING ROOM	CPT 1,2,3,4		BR	-	GYP	P	CONC	EXP	P4 on West wall. All others P1
323	OFFICE	CPT 1,2,3,4		BR	-	GYP	P	CONC	EXP	
324	OFFICE	CPT 1,2,3,4		BR	-	GYP	P	CONC	EXP	
325	OFFICE	CPT 1,2,3,4		BR	-	GYP	P	CONC	EXP	
326	OFFICE	CPT 1,2,3,4		BR	-	GYP	P	CONC	EXP	
327	OFFICE	CPT 1,2,3,4		BR	-	GYP	P	CONC	EXP	
328	OFFICE	CPT 1,2,3,4		BR	-	GYP	P	CONC	EXP	
329	MEETING ROOM	CPT 1,2,3,4		BR	-	GYP	P	CONC	EXP	P5 on South wall. All others P1
330	OFFICE	CPT 1,2,3,4		BR	-	GYP	P	CONC	EXP	
331	OFFICE	CPT 1,2,3,4		BR	-	GYP	P	CONC	EXP	

NO	NAME	FLOOR		BASE		WALLS		CEILING		REMARKS
		MAT	FIN	MAT	FIN	MAT	FIN	MAT	FIN	
FOURTH FLOOR										
400	OPEN (ATRIUM)	EP	EP P1	BR MB		CONC GYP	EXP P1	-	-	EP on Stair C/D risers and treads. P1 on GYP walls and remaining stair finishes
401	ELEVATOR LOBBY	CPT 1,2,3,4		BR		GYP	P1	CONC	EXP	
402	OPEN OFFICE	CPT 1,2,3,4		BR MB	-	GYP	P	CONC	EXP	BR base at GYP partitions, MB base at exposed concrete walls. P colours TBD
403	KITCHEN	CT1		BR MB		CONC GYP	EXP P1/ PL1	AT2		BR base at GYP partitions, MB base at exposed concrete walls. P colours TBD
404	IT CLOSET	RF	-	RB	-	GYP	P1	CONC	EXP P1	
405	MEN'S WASHROOM	CT5	-	CT	-	CONC GYP CT6 CT8		ACT1	-	CT base to match floor tile (also align joints). Refer to interior elevations for locations
406	WOMEN'S WASHROOM	CT5	-	CT	-	CONC GYP CT6 CT8		ACT1	-	CT base to match floor tile (also align joints). Refer to interior elevations for locations
407	ELECTRICAL CLOSET	RF	-	RB	-	GYP	P1	CONC	EXP P1	
408	JANITOR'S ROOM	CT1	-	CT	-	CONC GYP	EXP P1	CONC	EXP	
409	EXIT STAIR A	CONC	EXP CT1	-	-	CONC	EXP	CONC	EXP P2	

NO	NAME	FLOOR		BASE		WALLS		CEILING		REMARKS
		MAT	FIN	MAT	FIN	MAT	FIN	MAT	FIN	
410	ELECTRICAL CLOSET	RF	-	RB	-	CONC GYP	EXP P1	CONC	EXP P1	
411	UNIVERSAL WASHROOM	CT5		CT	-	GYP CT	P1 CT4 CT8	ACT1		CT base to match floor tile (also align joints)
412	EXIT STAIR B	CONC	EXP CT1	-	-	CONC	EXP	CONC	EXP P2	
413	IT CLOSET	RF	-	RB	-	CONC GYP	EXP P1	CONC	EXP P1	
414	NOT USED									
415	NOT USED									
416	NOT USED									
417	NOT USED									
418	NOT USED									
419	NOT USED									
420	PHONE BOOTH	CPT 1,2,3,4		BR	-	GYP	P	CONC	EXP	P5 on North wall. All others P1
421	OFFICE	CPT 1,2,3,4		BR	-	GYP	P	CONC	EXP	
422A	OFFICE	CPT 1,2,3,4		BR	-	GYP	P	CONC	EXP	
422B	SERVER ROOM	CONC		MB	-	GYP	P	CONC	EXP	Sealer to Concrete floor
423	OFFICE	CPT 1,2,3,4		BR	-	GYP	P	CONC	EXP	
424	OFFICE	CPT 1,2,3,4		BR	-	GYP	P	CONC	EXP	
425	OFFICE	CPT 1,2,3,4		BR	-	GYP	P	CONC	EXP	
426	OFFICE	CPT		BR	-	GYP	P	CONC	EXP	

NO	NAME	FLOOR		BASE		WALLS		CEILING		REMARKS
		MAT	FIN	MAT	FIN	MAT	FIN	MAT	FIN	
		1,2,3,4								
427	OFFICE	CPT 1,2,3,4		BR	-	GYP	P	CONC	EXP	
428	OFFICE	CPT 1,2,3,4		BR	-	GYP	P	CONC	EXP	
429	BREAKOUT ROOM	CPT 1,2,3,4		BR	-	GYP	P	CONC	EXP	P4 on North wall. All others P1
430	OFFICE	CPT 1,2,3,4		BR	-	GYP	P	CONC	EXP	
431	OFFICE	CPT 1,2,3,4		BR	-	GYP	P	CONC	EXP	
432	OFFICE	CPT 1,2,3,4		BR	-	GYP	P	CONC	EXP	
433	OFFICE	CPT 1,2,3,4		BR	-	GYP	P	CONC	EXP	
434	OFFICE	CPT 1,2,3,4		BR	-	GYP	P	CONC	EXP	
435	OFFICE	CPT 1,2,3,4		BR	-	GYP	P	CONC	EXP	
436	MEETING ROOM	CPT 1,2,3,4		BR	-	GYP	P	CONC	EXP	P5 on South wall. All others P1
437	OFFICE	CPT 1,2,3,4		BR	-	GYP	P	CONC	EXP	
438	OFFICE	CPT 1,2,3,4		BR	-	GYP	P	CONC	EXP	
439	OFFICE	CPT 1,2,3,4		BR	-	GYP	P	CONC	EXP	
440	OFFICE	CPT 1,2,3,4		BR	-	GYP	P	CONC	EXP	
441	BREAKOUT ROOM	CPT 1,2,3,4		BR	-	GYP	P	CONC	EXP	P4 on North wall. All others P1

NO	NAME	FLOOR		BASE		WALLS		CEILING		REMARKS
		MAT	FIN	MAT	FIN	MAT	FIN	MAT	FIN	
442	TENDER CLOSING ROOM	CPT 1,2,3,4		BR	-	GYP	P	CONC	EXP	P6 on North wall. All others P1

1.1 LEGEND

- .1 AC. Exposed Architectural Concrete, (flat colourless sealant).
- .2 ACT(#) Ceiling Tile In accordance with Section 09 51 13.
 - .1 ACT Metalworks M11 White, *Armstrong*.
- .3 AT(#) Acoustic Ceiling Panel: In accordance with Section 09 51 13.
 - .1 AT1 Hard Side Cloud White, *Kinetics*. (refer to Reflected ceiling plans for location)
 - .2 AT2 Hard Side Cloud Grey Mix 238, *Kinetics*. (refer to Reflected ceiling plans for location)
- .4 AW(#) Acoustic Wall Panel: In accordance with Section 09 53 00.
- .5 BR Reveal Baseboard: 2" high Brushed Aluminum base with ¼" cove bend recessed in GYP. ½". In accordance with Section 09 27 10.
- .6 CG(#) Coloured Glass: Ceramic Enamel finish on back surface of 6 mm tempered glass.
 - .1 CG1 Quiet Hideaway, *Dulux* (white).
 - .2 CG2 Icon Grey, *Dulux* (light Grey)
 - .3 CG3 Obsidian Glass, *Dulux* (dark grey)
- .7 CH Concrete Hardener Floor Finish: In accordance with Section 03 35 05.
- .8 CPT Carpet Tile: In accordance with Section 09 68 13 - Tile Carpeting.
 - .1 CPT1 Colour Field Patina, Slate - PAT119-153, *Milliken* – accent 1 (approx. 6% in herringbone patterned areas)
 - .2 CPT2 Colour Field Patina, Wood – PAT124, *Milliken* – accent 2 (approx. 6% in herringbone patterned areas)
 - .3 CPT3 Colour Field Patina, Limestone – PAT250, *Milliken* – field colour
 - .4 CPT4 not used
 - .5 CPT5 Colour Field Patina, Frost Steel, PAT139-157, *Milliken*

NO	NAME	FLOOR		BASE		WALLS		CEILING		REMARKS
		MAT	FIN	MAT	FIN	MAT	FIN	MAT	FIN	
.9	CN(#)	Solid Surface Countertop: in Accordance with Section 06 40 00								
	.1 CN1	Organic White 4600, <i>Ceasarstone</i>								
	.2 CN2	Deep Espresso, <i>Corian</i>								
.10	CT(#)	Ceramic Tile: In accordance with Section 09 30 05 - Ceramic Tiling.								
	.1 CT1	Coem Reverso 2 Silver Rect. Nat., <i>Centura</i> (60cm x 120cm).								
	.2 CT2	Not Used.								
	.3 CT3	Miki Basic 1x3 green haze, <i>Centura</i>								
	.4 CT4	Cellar char 8x36 34316836, <i>Centura</i> (<i>refer to Interior elevations/plans for location</i>)								
	.5 CT5	Coem Reverso 2 Silver Rect. Nat., <i>Centura</i> (60cm x 120cm). (<i>refer to Interior elevations for location</i>)								
	.6 CT6	Officine Gothic OF-04, 60 x 60 cm, LUC Finish (<i>refer to Interior elevations for location</i>)								
	.7 CT7	Cellar char 8x36 34316836, <i>Centura</i> (<i>refer to Interior elevations/plans for location</i>)								
	.8 CT8	Urban Series, White Matte NH6306 (30cm x 60cm). (<i>refer to Interior elevations for location</i>)								
	.9 CT9	Basaltina, Nero 1x2, BST3005MO12								
.11	EP	Epoxy Coating.								
.12	GYP	Gypsum Board: In accordance with Section 09 21 16 - Gypsum Board Assemblies.								
.13	HF	Hygienic Flooring: In accordance with Section 09 72 00.								
.14	HW	Hygienic Wall covering: In accordance with Section 09 72 00.								
	.1 Altro	Whiterock, White W103-W104, Altro.								
.15	MB	Brushed Metal Base: 2" high Brushed Aluminum base with ¼" cove bend, flush mounted to wall. In accordance with Section 09 27 10.								
.16	P#	Paint Finish: In accordance with Section 09 90 15 - Painting. Refer to Paint Schedule for colour.								
	.1 P1	Quiet Hideaway, eggshell finish, <i>Dulux</i> (white). <i>P1 to be used unless otherwise noted in finish schedule</i>								
	.2 P2	America's Cup, eggshell finish, <i>Dulux</i> (light blue)								
	.3 P3	Granite Grey, eggshell finish, <i>Dulux</i> (grey)								

NO	NAME	FLOOR		BASE		WALLS		CEILING		REMARKS
		MAT	FIN	MAT	FIN	MAT	FIN	MAT	FIN	

- .4 P4 Teton Sky, eggshell finish, *Dulux* (dark blue)
- .5 P5 Portuguese Sonnet, eggshell finish, *Dulux* (yellow)
- .6 P6 TBD, eggshell finish, *Dulux* (red)

.17 PL(#) Plastic Laminate: In accordance with Section **06 40 00**

- .1 PL1 **Caramello 18, Formica**
- .2 PL2 Greystone, Matte, *Formica*
- .3 PL3 **Novanoir 888, Formica**
- .4 PL4 **Dover White, Matte 7197-58, Formica**

.18 RB Resilient Floor Base: In accordance with Section 09 65 16 - Resilient Sheet Flooring.

.19 RF Resilient Flooring: In accordance with Section 09 65 16 - Resilient Sheet Flooring.

- .1 Marmoleum Walton Uni, 171 Cement, *Forbo* (2.5mm) .

.20 SL Sealed Concrete: In accordance with Section 03 35 00 - Concrete Finishing.

.21 SF Safety Flooring

- .1 Altro Classic 25, Graphite X2546R11, Altro.

.22 ST Stone.

- .1 ST1 Officine Dark OF-03

1.2 NOTES

1. All exposed edges of CT to be finished with Aluminum edge trim in accordance with Section 09 30 05.
2. All CT base joints to match floor tile and to be aligned with floor tile joints.

NO	NAME	FLOOR		BASE		WALLS		CEILING		REMARKS
		MAT	FIN	MAT	FIN	MAT	FIN	MAT	FIN	

END OF SECTION