

-098-61-1

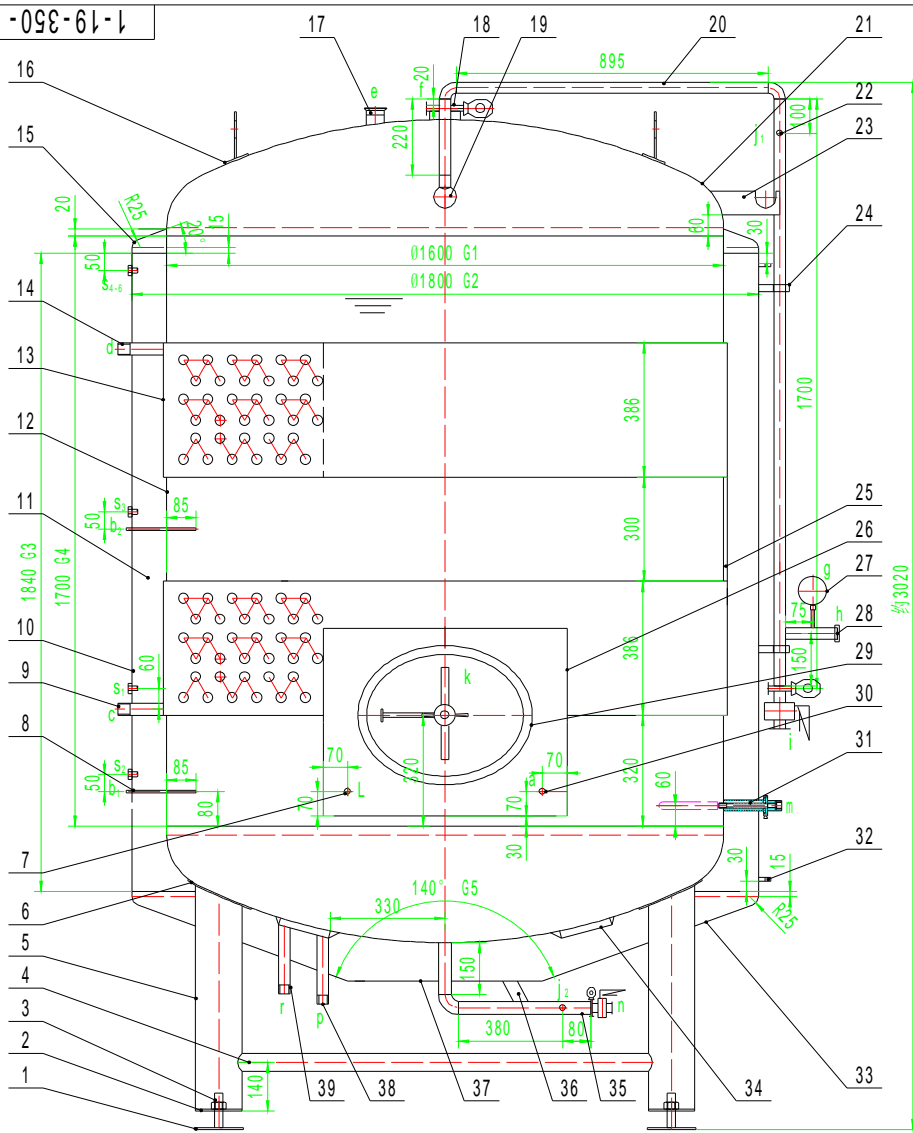

### Technical Requirement

- Total volume: 36.9BBL, effective volume: 30BBL, heat exchanging area: 4m<sup>2</sup>.
- Argon arc welding.
- After finish, do water pressure test on inner tank and dimple plate. The testing pressure of inner tank is 0.375MPa. The testing pressure of dimple plate is 0.2MPa.

### Pipe port list

Symbol	Nominal size	Face type	
a	0.75" (Ø19)	Tri-clamp	Sample valve port
b <sub>1-2</sub>	Ø14		Thermometer well
c	G1	Female thread	Body coolant inlet
d	G1	Female thread	Body coolant outlet
e	2" (Ø51)	Tri-clamp	Breather valve port
f	3.5" (Ø89)		CIP pipe casing plate
g	M20×1.5	Female thread	Pressure gauge port
h	DIN25	Knuckle male thread	Mechanical pressure regulating valve port
i	1.5" (Ø38)	Tri-clamp	CIP port
j <sub>1-2</sub>	G3/8	Male thread	Liquidometer joint
k	430×350		Side manway
L	0.75" (Ø19)	Tri-clamp	Bimetal thermometer port
m	G1/2	Female thread	Carbonation stone
n	1.5" (Ø38)	Tri-clamp	Beer outlet
S <sub>1-6</sub>	Ø16	Special joint	Wire port
p	G1	Male thread	Coil coolant inlet
r	G1	Male thread	Coil coolant outlet

### Key Size List

Symbol	Name	Key Size
G1	Inner tank diameter	Ø1600
G2	Cladding body diameter	Ø1800
G3	Cladding body height	H=1840
G4	Inner tank body height	H=1700
G5	Cladding bottom cone degree	140°

### Lifting lug diagram

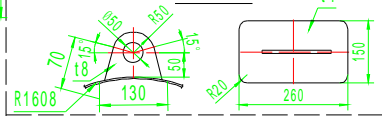

### Ladder Hook Diagram

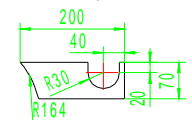

Usage									
Symbol	Description	Quantity	Material	Weight	Unit	Weight	Unit	Weight	Unit
39	Coil coolant outlet Ø33×4 L=200	1	06Cr19Ni10	0.5	0.5				
38	Coil coolant inlet Ø33×4 L=200	1	06Cr19Ni10	0.5	0.5				
37	Cladding bottom seal Ø560×3	1	06Cr19Ni10	6	6				
36	Material pipe tension brace 65×50×2	1	06Cr19Ni10	0.1	0.1				
35	Beer outlet Ø38×1.5	1	06Cr19Ni10	1	1				
34	Cooling coil W110 t1.5	1	06Cr19Ni10	6.5	6.5				
33	Cladding bottom cone t2.5	1	06Cr19Ni10	54	54				
32	Pipe support Ø38	3	06Cr19Ni10	0.05	0.2				
31	Carbonation stone	1	Component	5	5				
30	Sample valve port Ø19×1.5 L=70	1	06Cr19Ni10	0.1	0.1				
29	Side manway 450×350 PNO. 375	1	06Cr19Ni10	9.5	9.5				
28	Pressure regulating valve joint Ø28×1.5 L=70	1	06Cr19Ni10	0.2	0.2				
27	Pressure gauge and seat Ø100/W20×1.5	1	06Cr19Ni10	0.5	0.5				
26	Horn mouth W700 H540	1	06Cr19Ni10	4	4				
25	Stream guide belt 300×120×1.5	1	06Cr19Ni10	0.5	0.5				
24	Pipe support Ø38	2	06Cr19Ni10	0.1	0.2				
23	Ladder hook t8	2	06Cr19Ni10	0.9	1.8				
22	Liquidmeter joint Ø male thread head	2	06Cr19Ni10	0.05	0.1				
21	Dome head THA1600×3	2	06Cr19Ni10	64	128				
20	CIP pipe Ø38×1.5	1	06Cr19Ni10	2.8	2.8				
19	Rotary spray ball Ø53 G1 threaded	1	06Cr19Ni10	0.5	0.5				
18	Tri-clamp Ø89 (with end plate)	1 set	06Cr19Ni10	1	1				
17	Sizing tri-clamp end Ø51×1.5 L=50	1	06Cr19Ni10	0.2	0.2				
16	Lifting lug and baseplate t8/t4	2	06Cr19Ni10	1.6	3.2				
15	Cladding top seal t3	1	06Cr19Ni10	20	20				
14	Body coolant outlet Ø38×4.5 L=130	1	06Cr19Ni10	0.3	0.3				
13	Body dimple plate XI t1.2	2	06Cr19Ni10	19	38				
12	Inner tank body t3	1	06Cr19Ni10	205	205				
11	Insulation material 1.4m <sup>3</sup>		Polyurethane	55.6	77.8				
10	Cladding body t2	1	06Cr19Ni10	169	169				
9	Tank body coolant inlet Ø38×4.5 L=130	1	06Cr19Ni10	0.3	0.3				
8	Thermometer well Ø14×2 L=200	2	06Cr19Ni10	0.1	0.2				
7	Bimetal thermometer port Ø19×1.5 L=70	1	06Cr19Ni10	0.1	0.1				
6	Leg reinforcing plate 200×200×4	4	06Cr19Ni10	1.3	5.2				
5	Leg Ø133×3 L=650	4	06Cr19Ni10	8.7	34.8				
4	Leg tension brace Ø51×2 L=800	4	06Cr19Ni10	2.1	8.4				
3	Adjustable bolt M24×100	4	06Cr19Ni10	0.5	2				
2	Leg baseplate Ø124×5	4	06Cr19Ni10	0.6	2.4				
1	Bottom plate Ø140×5	4	06Cr19Ni10	0.7	2.8				

序号	代号	名称	数量	材料	单件重量	总计重量	备注
Zhongde Equipment Co., Ltd. Shandong							材料名称: 06Cr19Ni10 项目名称: 2013-149
职责	设计	设计	设计	设计	设计	设计	设计
设计	设计	设计	设计	设计	设计	设计	设计
审核	审核	审核	审核	审核	审核	审核	审核
批准	批准	批准	批准	批准	批准	批准	批准
30BBL Bright Beer Tank				1-19-350-			
重量/kg: 792.700			比例: 1:10	共 页	第 页		

借 (通) 用 记	件 登 号
图 号	图 号
底 图 号	底 图 号
签 字	签 字
日 期	日 期
档 案 员	日 期