



TAL-CO SUPPLEMENTAL INSTRUCTION #68			
PRINTER STATION - GLASS PARTITION CLARIFICATION			
Project Name:	RW TOMLINSON - NEW HEAD OFFICE		
Project Location:	100 CitiGate Drive, Ottawa, Ontario		
ARCH. SI #:	ASK 202	Issued By:	Farah Bano
STRUC. SI #:	N/A	Date Issued:	November 9, 2017
MECH. SI #:	N/A	Revision #:	N/A
ELEC. SI #:	N/A	Revision Date:	N/A

Supplemental Instructions are issued by the Construction Manager to record a clarification or revision to the previously issued Contract Documentation as reflected by the attached information prepared by the identified Professionals.

The Construction Manager shall review the Supplemental Instruction and the attached information and issue to the affected Trade Contractors identifying the following course of action by the Trade Contractor.

Notify TAL-CO within 5 days of receipt, if the attached documents will require a change to Contract Price or Schedule.

TITLE: PRINTER STATION - GLASS PARTITION CLARIFICATION

Reference:

Architectural Construction Update 28-Jul-2017

Attachments:

ASK-202

Description of the Work:

To provide clarification on glazed screen panel at the SW Printer Station on Floor 4.

Reason:

To provide clarification on glazed screen dimensions and type.

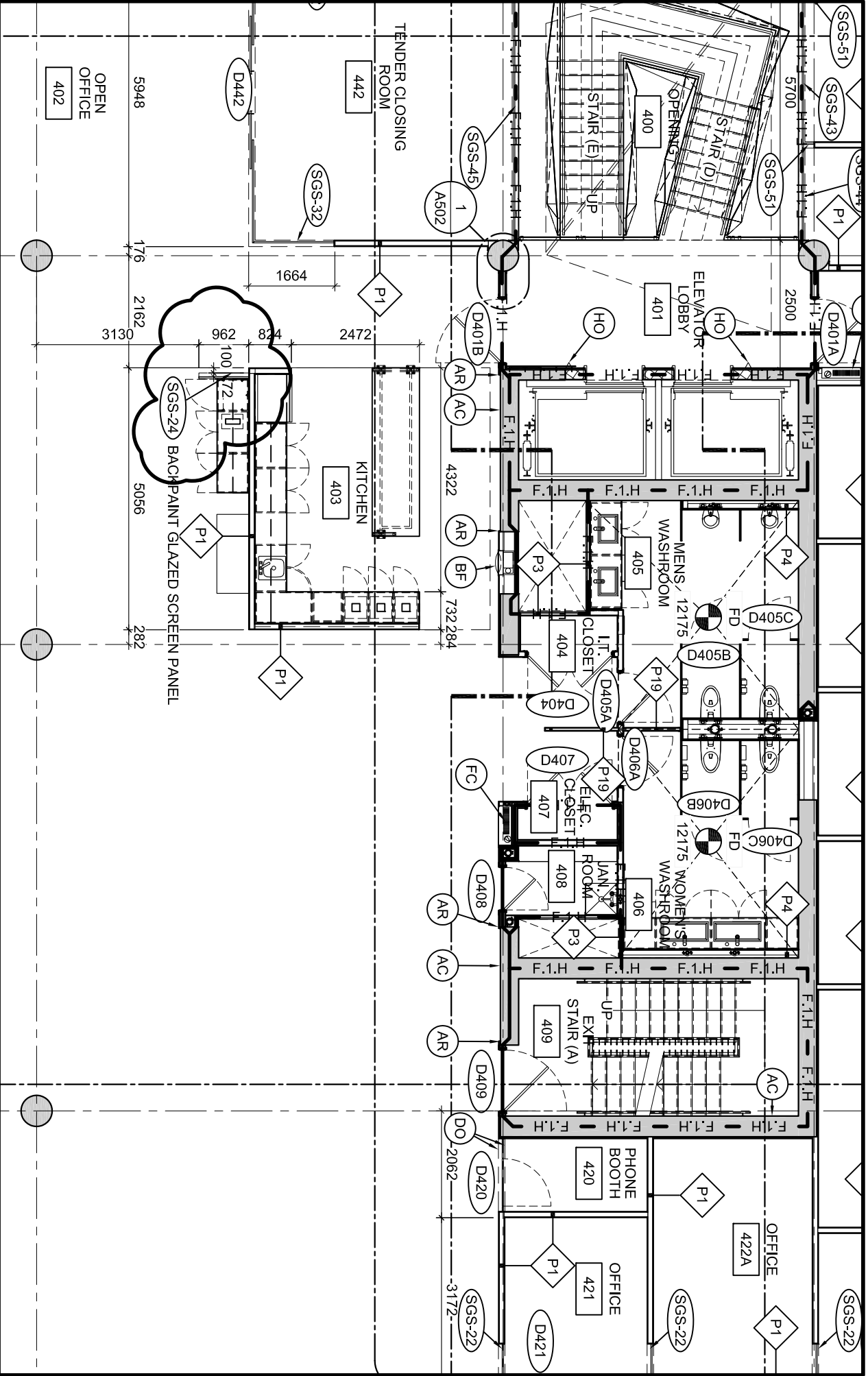

THE ANNEX/480 EGLINTON ST. OTTAWA, ON K1R6G5
 613.567.7888 PHONE / 613.567.7528 FAX
 csaarchitect.com

Christopher Simmonds
 Architect

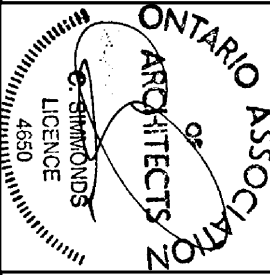

PROJECT:
TOMLINSON NEW BUILDING

DRAWING TITLE:
REFERENCE PARTIAL PLAN 1/A104

DATE: 11/08/2017
 SCALE: 1:100
 DRAWN BY: JK
 JOB No: 574-15
 DRAWING No: ASK-202