



<b>TAL-CO SUPPLEMENTAL INSTRUCTION #70 REV 01</b>			
<b>CAFETERIA - REVISED CLOSER PANEL DETAIL</b>			
Project Name:	<b>RW TOMLINSON - NEW HEAD OFFICE</b>		
Project Location:	<b>100 CitiGate Drive, Ottawa, Ontario</b>		
ARCH. SI #:	<b>ASK 206 REV 01</b>	Issued By:	<b>Farah Bano</b>
STRUC. SI #:	<b>N/A</b>	Date Issued:	<b>November 9, 2017</b>
MECH. SI #:	<b>N/A</b>	Revision #:	<b>01</b>
ELEC. SI #:	<b>N/A</b>	Revision Date:	<b>November 13, 2017</b>

Supplemental Instructions are issued by the Construction Manager to record a clarification or revision to the previously issued Contract Documentation as reflected by the attached information prepared by the identified Professionals.

The Construction Manager shall review the Supplemental Instruction and the attached information and issue to the affected Trade Contractors identifying the following course of action by the Trade Contractor.

Notify TAL-CO within 5 days of receipt, if the attached documents will require a change to Contract Price or Schedule.

**TITLE: CAFETERIA - REVISED CLOSER PANEL DETAIL**

**Reference:**

Architectural Construction Update 28-Jul-2017  
Millwork Shop Drawings

**Attachments:**

ASK-206 (REV 01) - Issued November 13th, 2017.

**Description of the Work:**

Closer Panel detail at Ground Floor Cafeteria Millwork piece M20 revised.

The ice maker issued in the previous instruction has now been cancelled as per owner's request.

**Reason:**

Closer Panel detail revised to accommodate refrigerator.

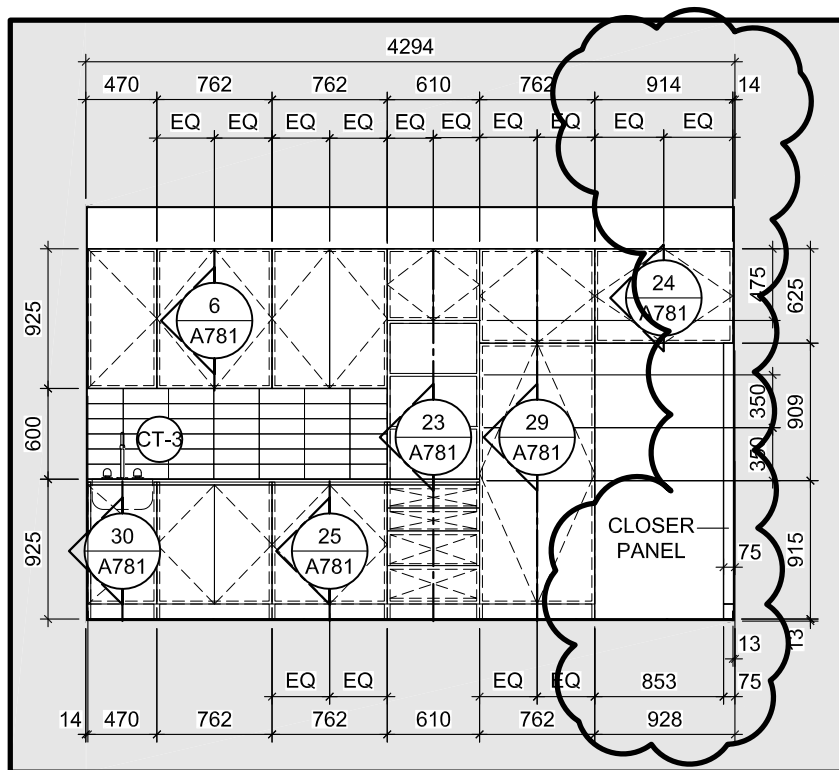

**22** ROOM 114 SOUTH ELEVATION  
 A771 SCALE = 1:50



THE ANNEX / 450 CECIL ST. OTTAWA ON K1R 6S3  
 613.567.7888 PHONE / 613.567.7528 FAX  
 csarchitect.com

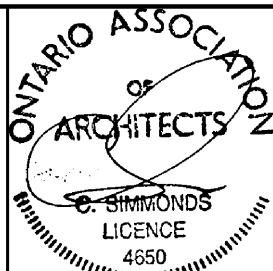

PROJECT:  
 TOMLINSON NEW BUILDING

DRAWING TITLE:  
 REF. REVISED DETAIL AS INDICATED

DATE: 11/13/2017  
 SCALE: AS INDICATED  
 DRAWN BY: JK  
 JOB No: 574-15  
 DRAWING No:

**ASK-206**