



TAL-CO SUPPLEMENTAL INSTRUCTION #76 Rev 01			
EXIT CORRIDORS - FIREWALL SEPARATION DETAIL			
Project Name:	RW TOMLINSON - NEW HEAD OFFICE		
Project Location:	100 CitiGate Drive, Ottawa, Ontario		
ARCH. SI #:	ASK 129, 207 & 209	Issued By:	Farah Bano
STRUC. SI #:	N/A	Date Issued:	December 13, 2017
MECH. SI #:	N/A	Revision #:	01
ELEC. SI #:	N/A	Revision Date:	January 2, 2018

Supplemental Instructions are issued by the Construction Manager to record a clarification or revision to the previously issued Contract Documentation as reflected by the attached information prepared by the identified Professionals.

The Construction Manager shall review the Supplemental Instruction and the attached information and issue to the affected Trade Contractors identifying the following course of action by the Trade Contractor.

Notify TAL-CO within 5 days of receipt, if the attached documents will require a change to Contract Price or Schedule.

TITLE: EXIT CORRIDORS - FIREWALL SEPARATION DETAIL

Reference:

Architectural Construction Update 28-Jul-2017

Attachments:

ASK 129 (Dated 11/21/2017)

ASK 207 (Dated 01/02/2018)

ASK 209 (Dated 12/14/2017)

Description of the work:

Exit Corridor Fire-rated assembly detail provided in attached sketches. Refer to ASKs 129 & 209 for Ceiling Detail, and M&E Penetration Detail respectively.

Reason:

Requested by Building Inspector to maintain integrity of fire exits.

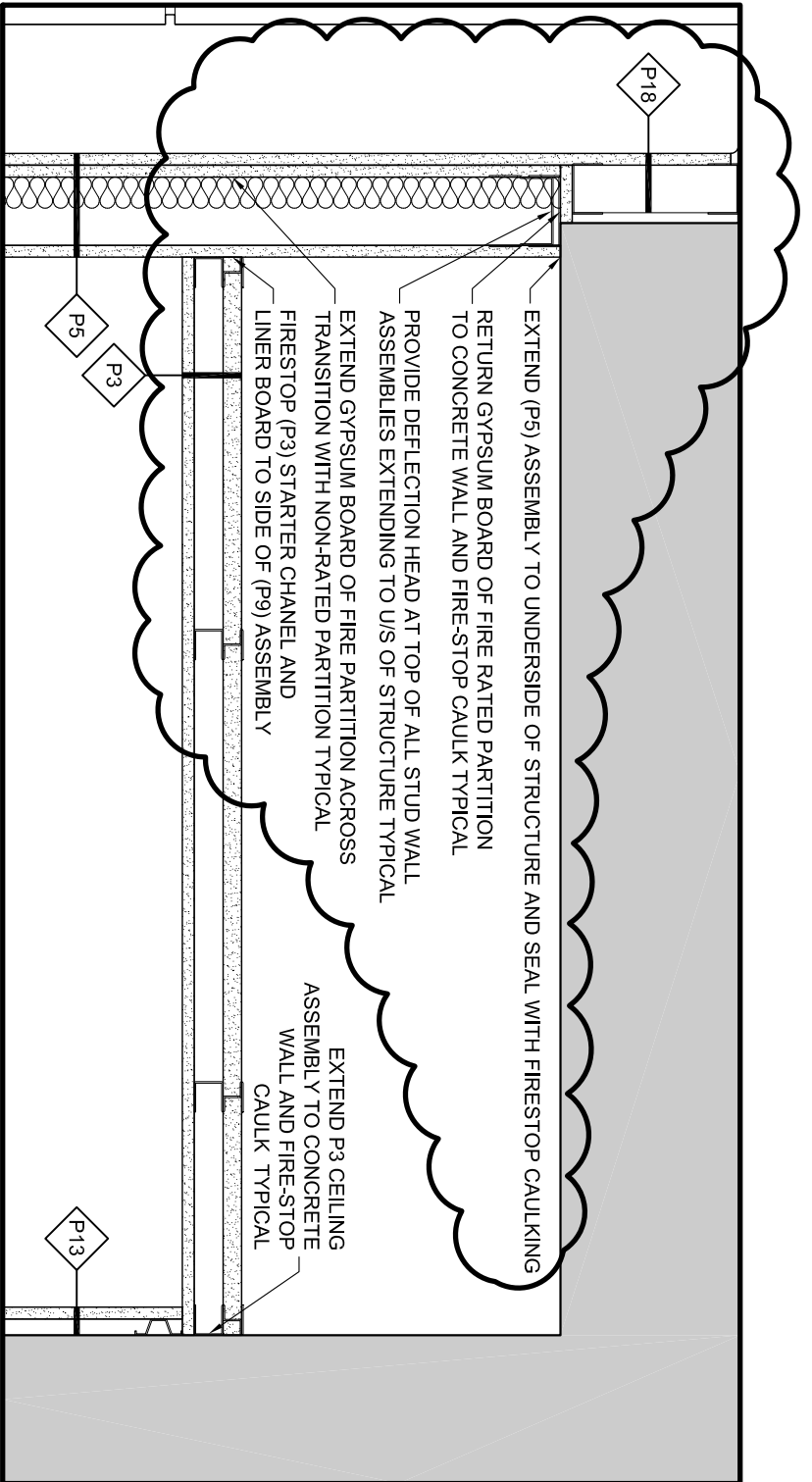

2
A124

CEILING DETAIL

SCALE = 1:10

**Christopher
Simmonds
Architect**

THE ANNEX, 48 EGLINTON ST. OTTAWA, ON K1R6G5
613.567.7888 PHONE / 613.567.7528 FAX
csw@architect.com

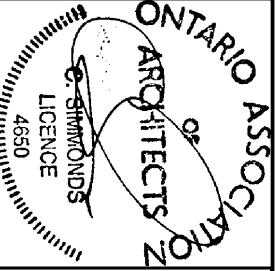

PROJECT:
TOMLINSON NEW BUILDING

DRAWING TITLE:
REF. REVISED DET. AS INDICATED

DATE: 11/21/2017

SCALE: AS INDICATED

DRAWN BY: JK

JOB No: 574-15

DRAWING No: ASK-129

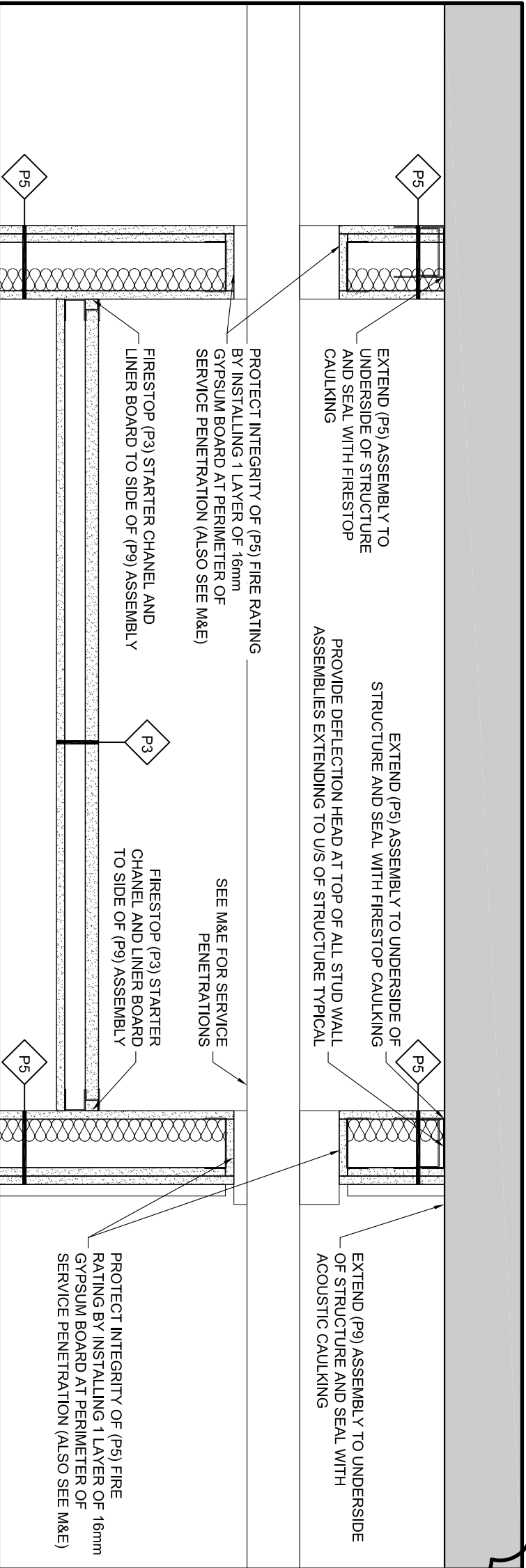

16 M&E EXIT PENETRATION DETAIL

A602

SCALE = 1:10

**Christopher
Simmonds**
Architect

THE ANNEX, 480 EGLINTON ST. OTTAWA, ON K1G 0G8
613.567.7888 PHONE / 613.567.7538 FAX
csw@architect.com

PROJECT:
TOMLINSON NEW BUILDING

DRAWING TITLE:
REFERENCE NEW DET. AS INDICATED

DATE:
12/14/2017

SCALE:
AS INDICATED

DRAWN BY:
JK

JOB No.:
574-15

DRAWING No.:

ASK-209