



TAL-CO SUPPLEMENTAL INSTRUCTION #83			
Ground Floor - Atrium Glazing			
Project Name:	RW TOMLINSON - NEW HEAD OFFICE		
Project Location:	100 CitiGate Drive, Ottawa, Ontario		
ARCH. SI #:	Various	Issued By:	Farah Bano
STRUC. SI #:	N/A	Date Issued:	February 23, 2018
MECH. SI #:	N/A	Revision #:	N/A
ELEC. SI #:	N/A	Revision Date:	N/A

Supplemental Instructions are issued by the Construction Manager to record a clarification or revision to the previously issued Contract Documentation as reflected by the attached information prepared by the identified Professionals.

The Construction Manager shall review the Supplemental Instruction and the attached information and issue to the affected Trade Contractors identifying the following course of action by the Trade Contractor.

Notify TAL-CO within 5 days of receipt, if the attached documents will require a change to Contract Price or Schedule.

TITLE: Ground Floor - Atrium Glazing

Reference:

Architectural Construction Update 28-Jul-2017

Attachments:

ASK-223	ASK-232
ASK-228	ASK-233
ASK-229	ASK-234
ASK-230	ASK-235
ASK-231	ASK-236

Description of the work:

Architectural detail provided for Atrium Glazing.

Reason:

For further clarification and detail

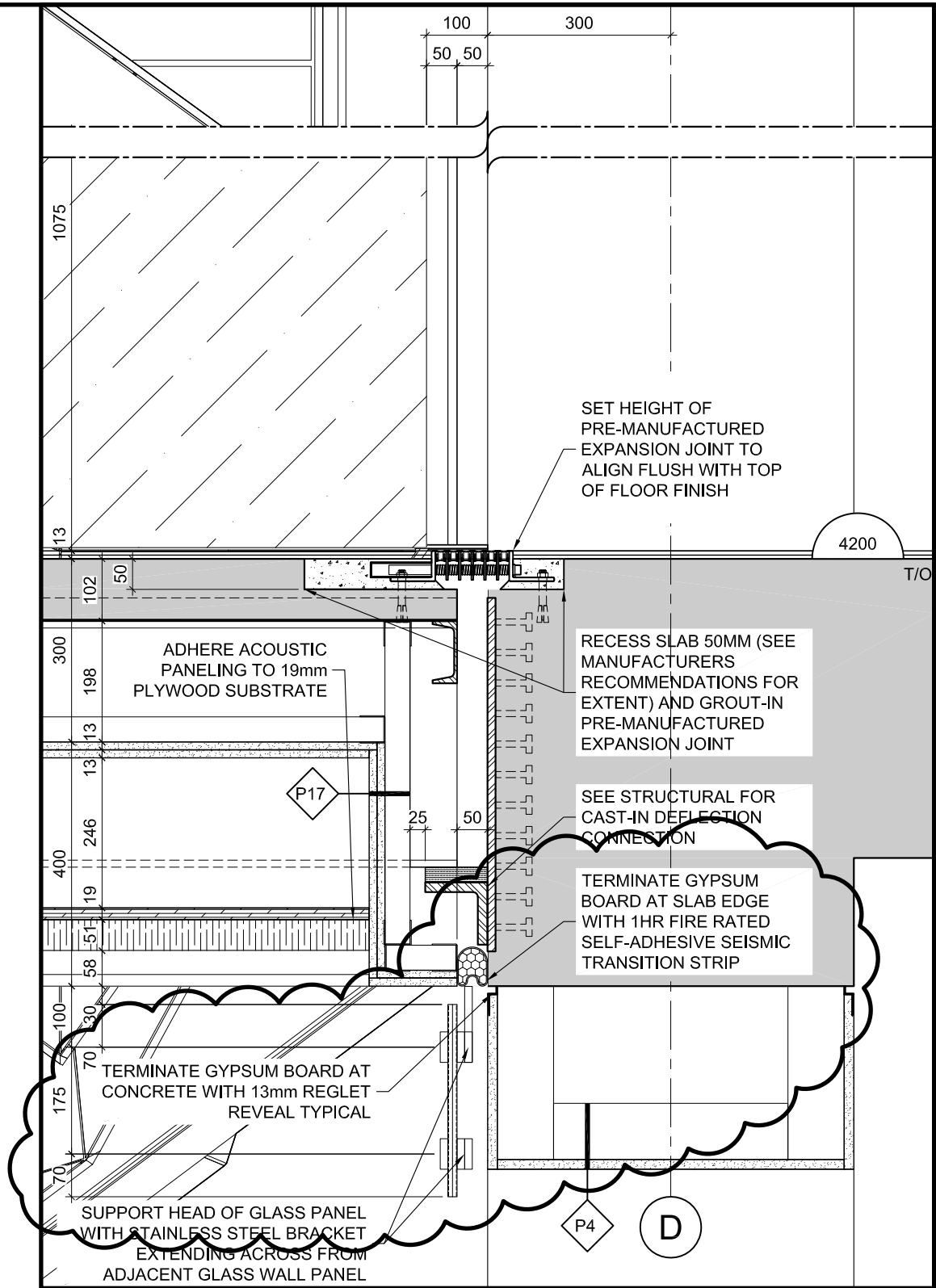

5 LARGE POD BRIDGE CONNECTION DETAIL
A604 SCALE = 1:10



PROJECT:
TOMLINSON NEW BUILDING

DATE: 01/14/2018
 SCALE: AS INDICATED
 DRAWN BY: JK

DRAWING TITLE:
REF. REVISED DET. AS INDICATED

JOB No: 574-15

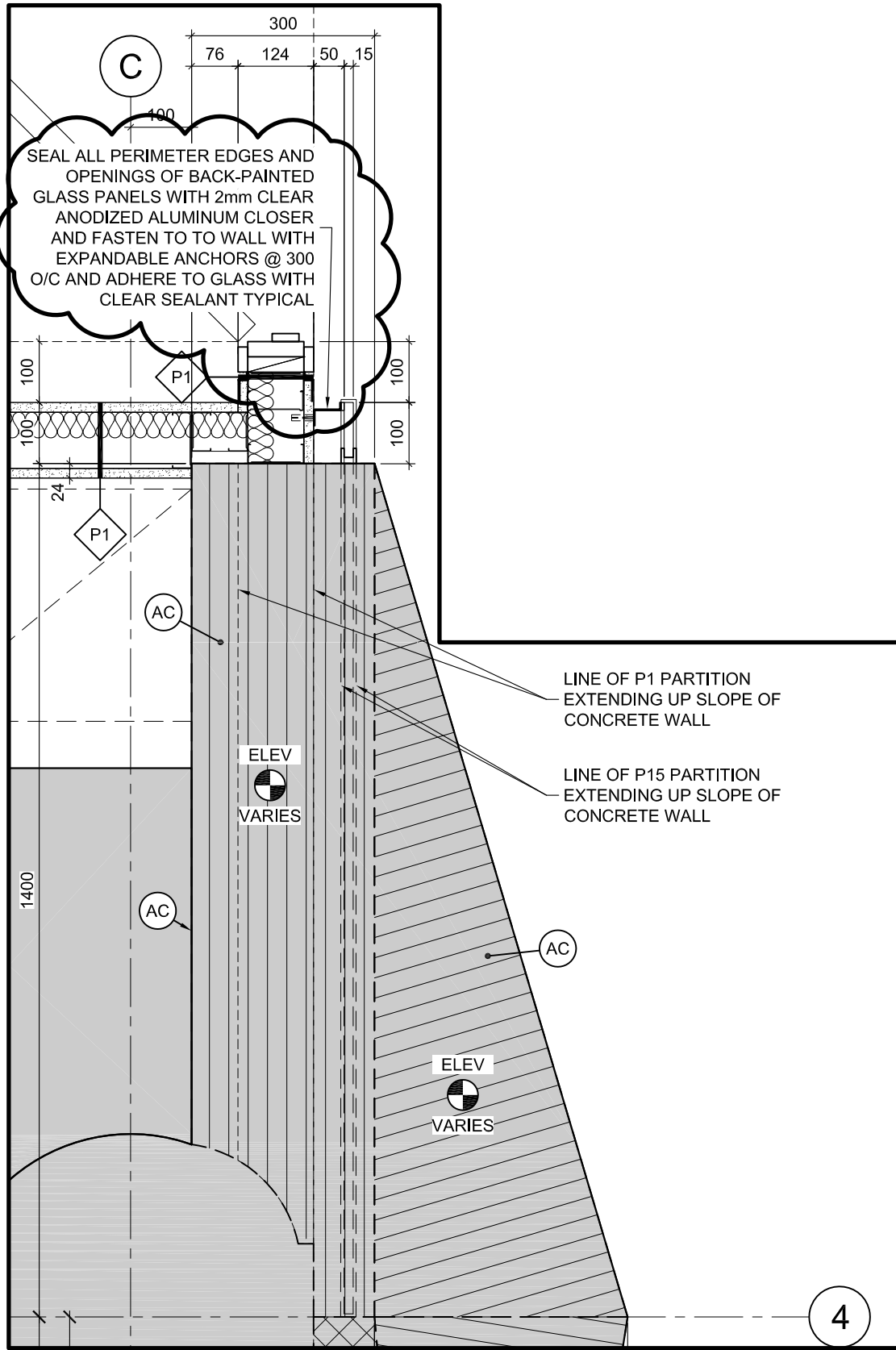

THE ANNEX / 450 CECIL ST. OTTAWA ON K1R 6S3
 613.567.7888 PHONE / 613.567.7528 FAX
 csarchitect.com



PROJECT:
 TOMLINSON NEW BUILDING

DATE: 01/14/2018
 SCALE: 1:10
 DRAWN BY: JK

DRAWING TITLE:
 REFERENCE REVISED DETAIL 36/A501

JOB No: 574-15
 DRAWING No:

ASK-228

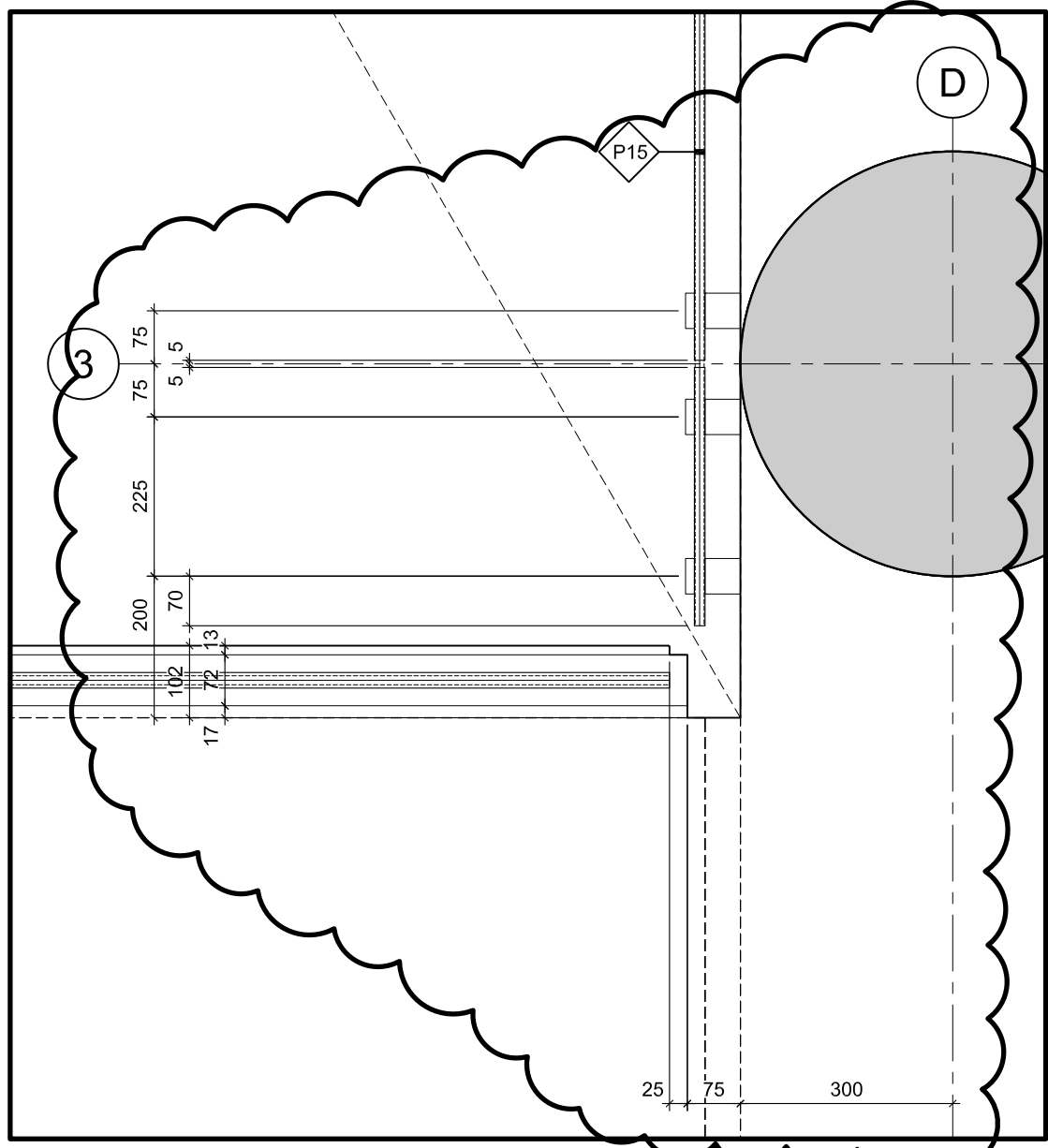

19 TYPICAL BRIDGE LANDING DETAIL
 A502 SCALE = 1:10



THE ANNEX / 450 CECIL ST. OTTAWA ON K1R 6S3
 613.567.7888 PHONE / 613.567.7528 FAX
 csarchitect.com



PROJECT:
 TOMLINSON NEW BUILDING

DATE: 01/14/2018
 SCALE: AS INDICATED
 DRAWN BY: JK

DRAWING TITLE:
 REF. REVISED DETAIL AS INDICATED

JOB No: 574-15
 DRAWING No:

ASK-229

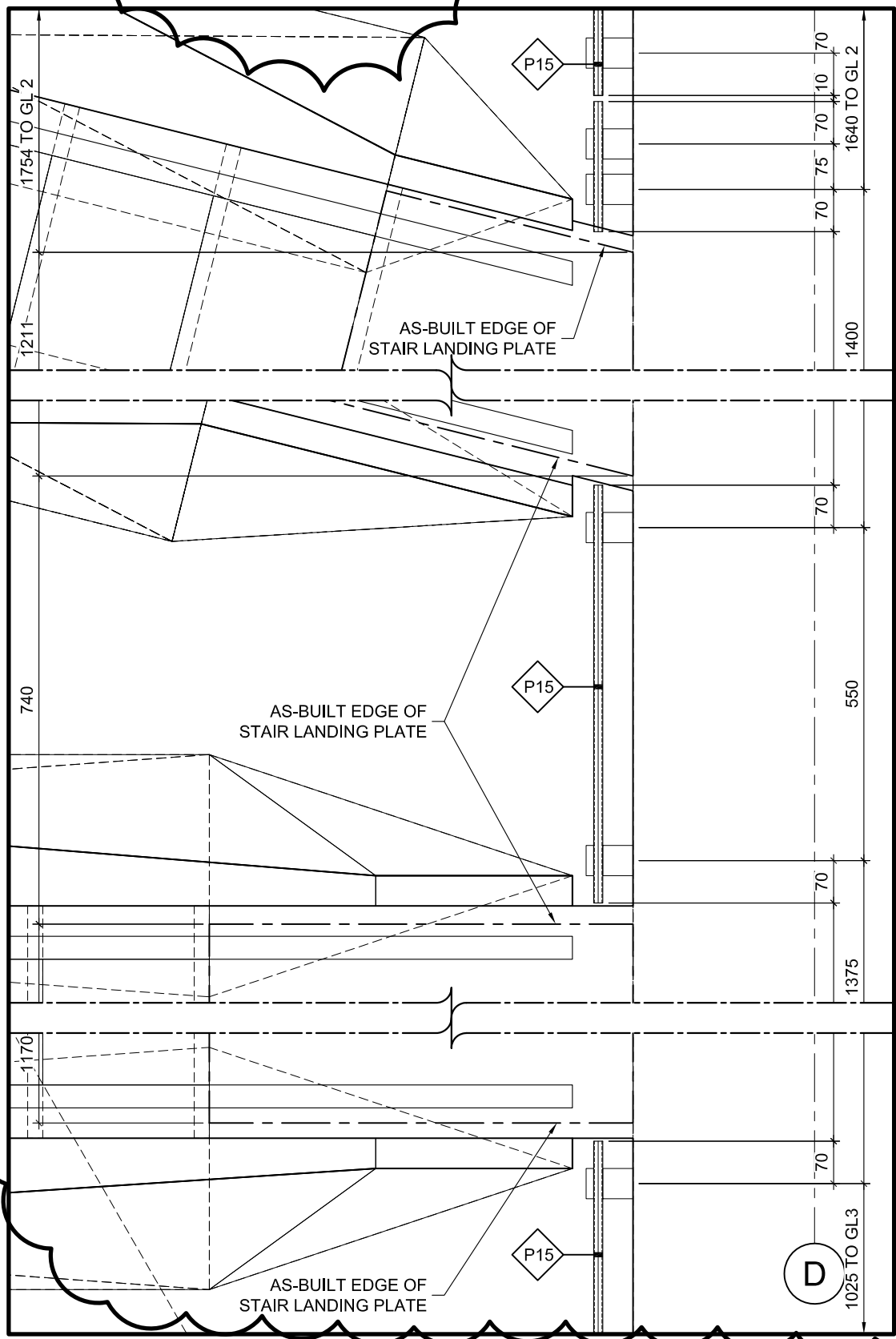

12 TYPICAL ELEVATOR LANDING DETAIL
 A502 SCALE = 1:10



THE ANNEX / 450 CECIL ST. OTTAWA ON K1R 6S3
 613.567.7888 PHONE / 613.567.7528 FAX
 csarchitect.com



PROJECT:	TOMLINSON NEW BUILDING	DATE:	01/30/2018
DRAWING TITLE:	REF. REVISED DETAIL AS INDICATED	SCALE:	AS INDICATED
		DRAWN BY:	JK
		JOB No:	574-15
		DRAWING No:	ASK-230

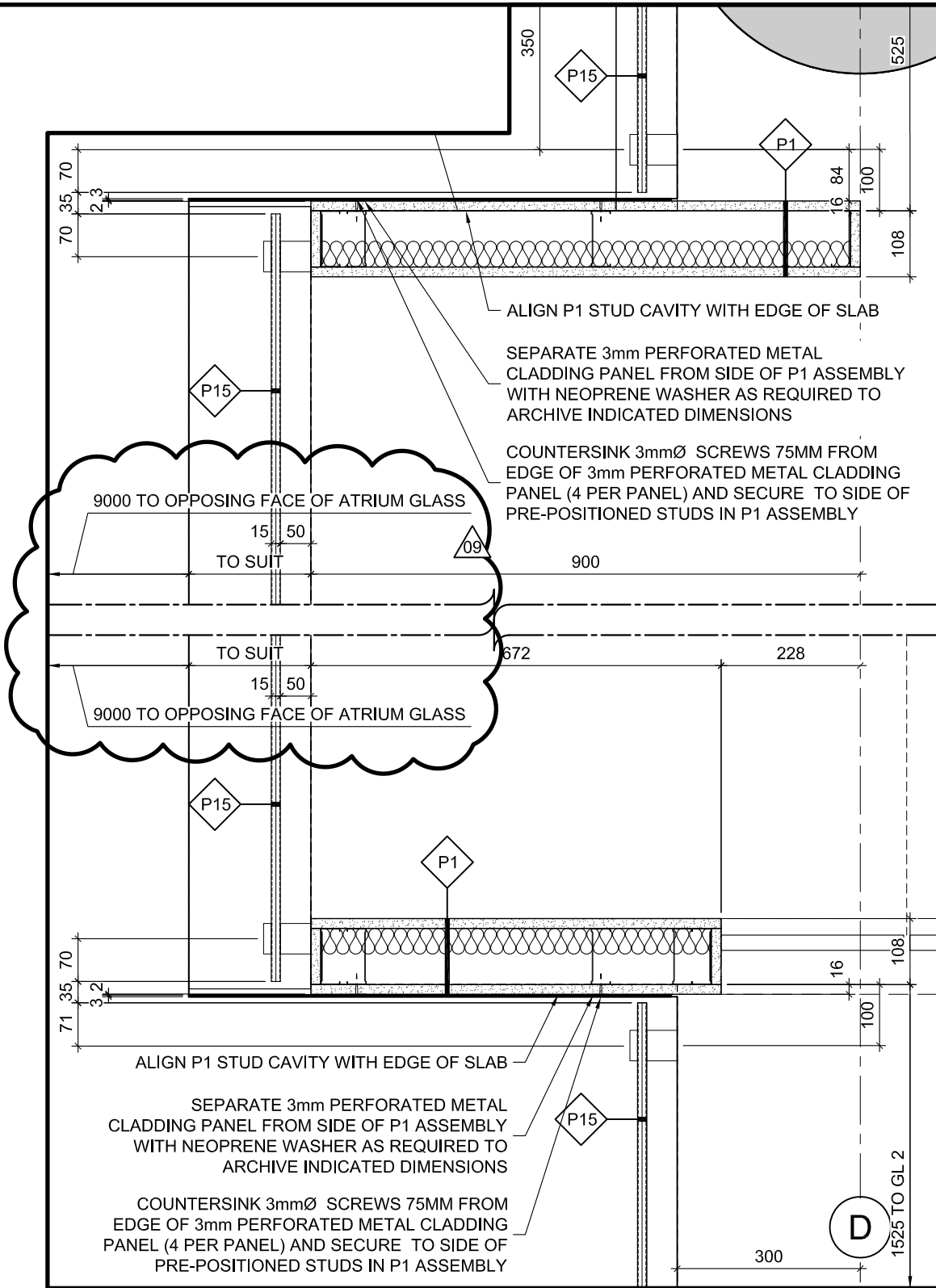

13
A502

OVERHANGING BOARD ROOM DETAIL

SCALE = 1:10



**Christopher
Simmonds
Architect**

THE ANNEX / 450 CECIL ST. OTTAWA ON K1R 6S3
613.567.7888 PHONE / 613.567.7528 FAX
csarchitect.com



PROJECT:
TOMLINSON NEW BUILDING

DRAWING TITLE:
REF. REV. PART. DETAIL AS INDICATED

DATE: 01/14/2018
SCALE: AS INDICATED
DRAWN BY: JK
JOB No: 574-15
DRAWING No:

ASK-231

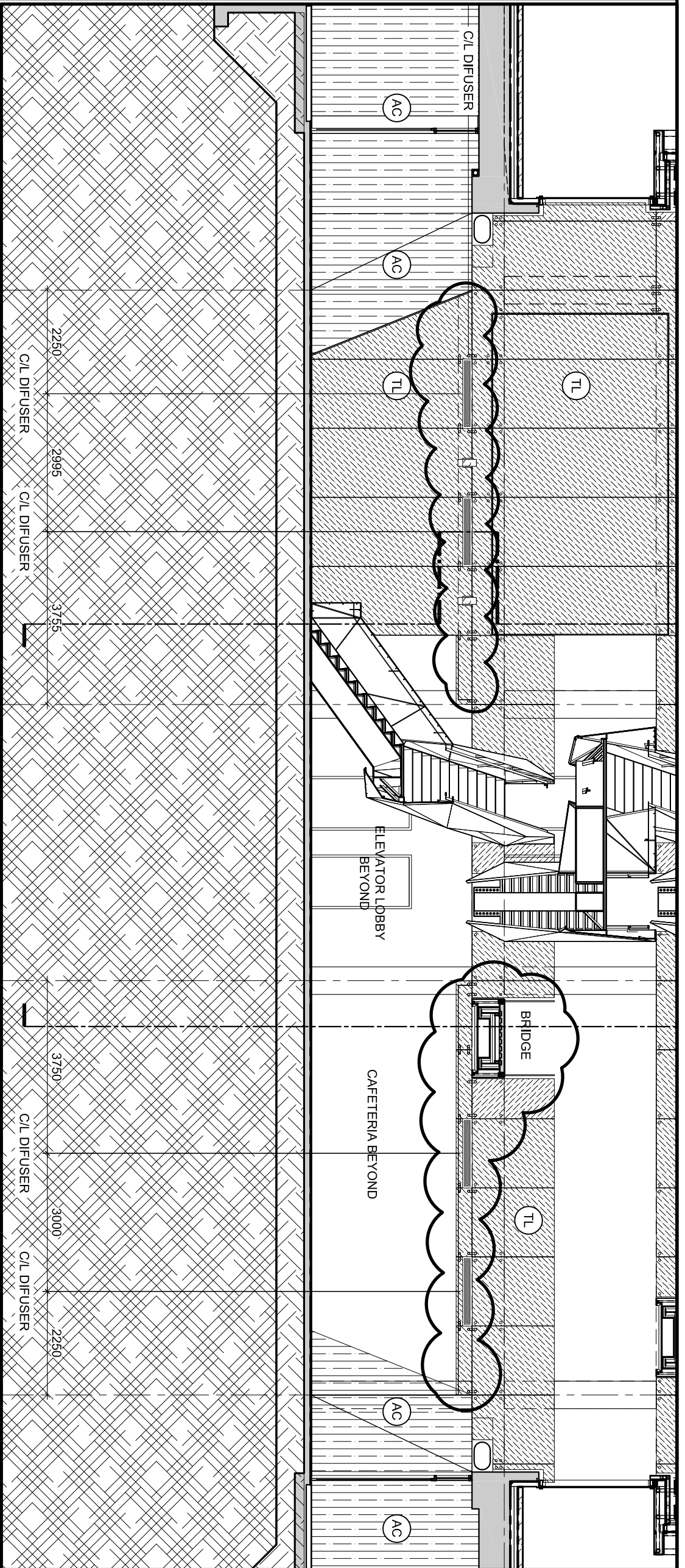

2 SHORT SECTION THROUGH ATRIUM LOOKING SOUTH

A301

SCALE = 1:100



**Christopher
Simmonds**
Architect

THE ANNEX, 480 CECIL ST. OTTAWA, ON K4R6S1
613.567.7888 PHONE / 613.567.7538 FAX
csaarchitect.com

PROJECT:
TOMLINSON NEW BUILDING

DRAWING TITLE:
REF. PART. REV. DET. AS INDICATED

DATE: 01/14/2018

SCALE: AS INDICATED

DRAWN BY: JK

JOB No: 574-15

DRAWING No:

ASK-232

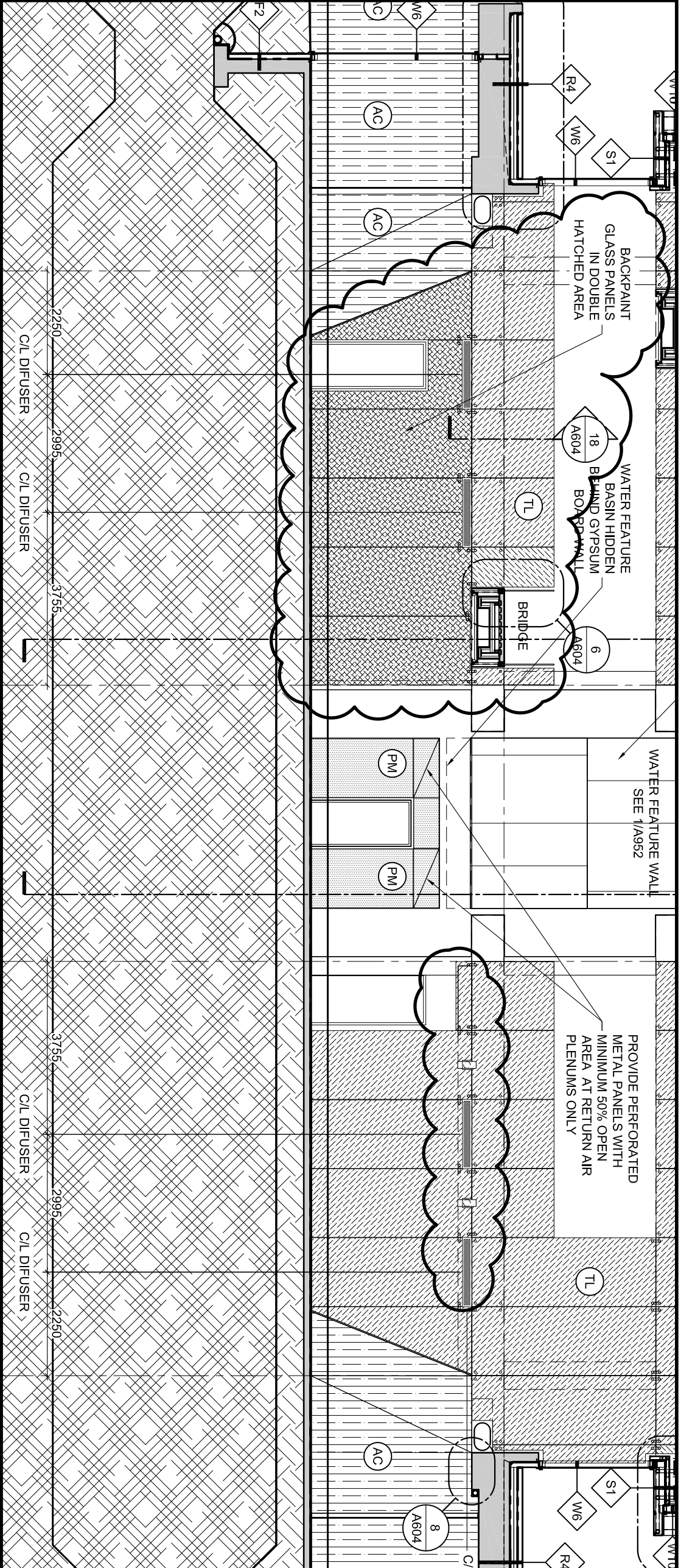

3 SHORT SECTION THROUGH ATRIUM LOOKING NORTH

SCALE = 1:100

A301



**Christopher
Simmonds**
Architect

THE ANNEX/480 EGLINTON ST. OTTAWA, ON K1R6S1
613.567.7888 PHONE / 613.567.7538 FAX
csaarchitect.com

PROJECT:
TOMLINSON NEW BUILDING

DRAWING TITLE:
REF. PART. REV. DET. AS INDICATED

DATE: 01/14/2018

SCALE: AS INDICATED

DRAWN BY: JK

JOB No: 574-15

DRAWING No:
ASK-233

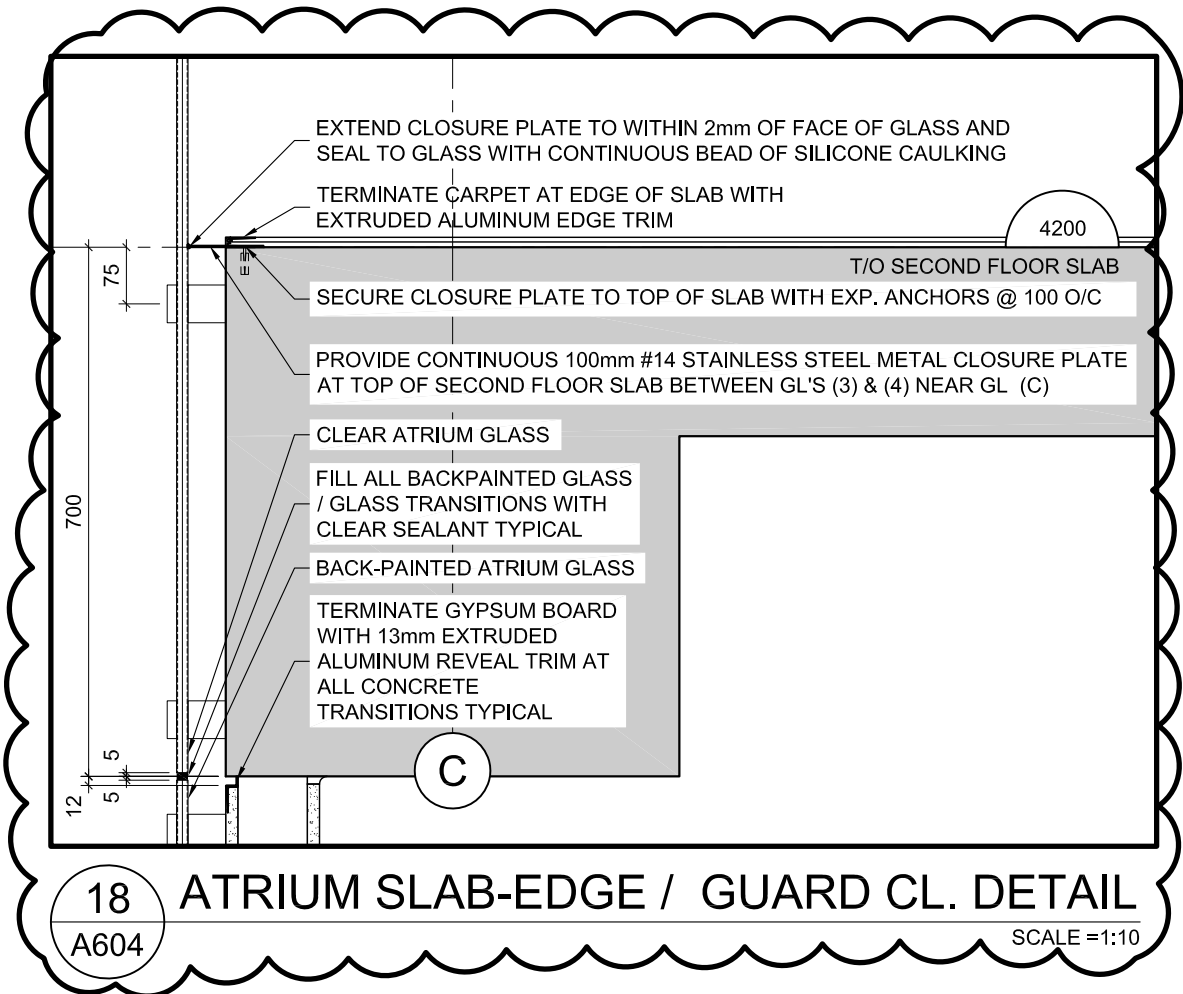

THE ANNEX / 450 CECIL ST. OTTAWA ON K1R 6S3
 613.567.7888 PHONE / 613.567.7528 FAX
 csarchitect.com



PROJECT:
 TOMLINSON NEW BUILDING

DRAWING TITLE:
 REF. REVISED DET. AS INDICATED

DATE: 01/14/2018
 SCALE: AS INDICATED
 DRAWN BY: JK
 JOB No: 574-15
 DRAWING No: **ASK-234**

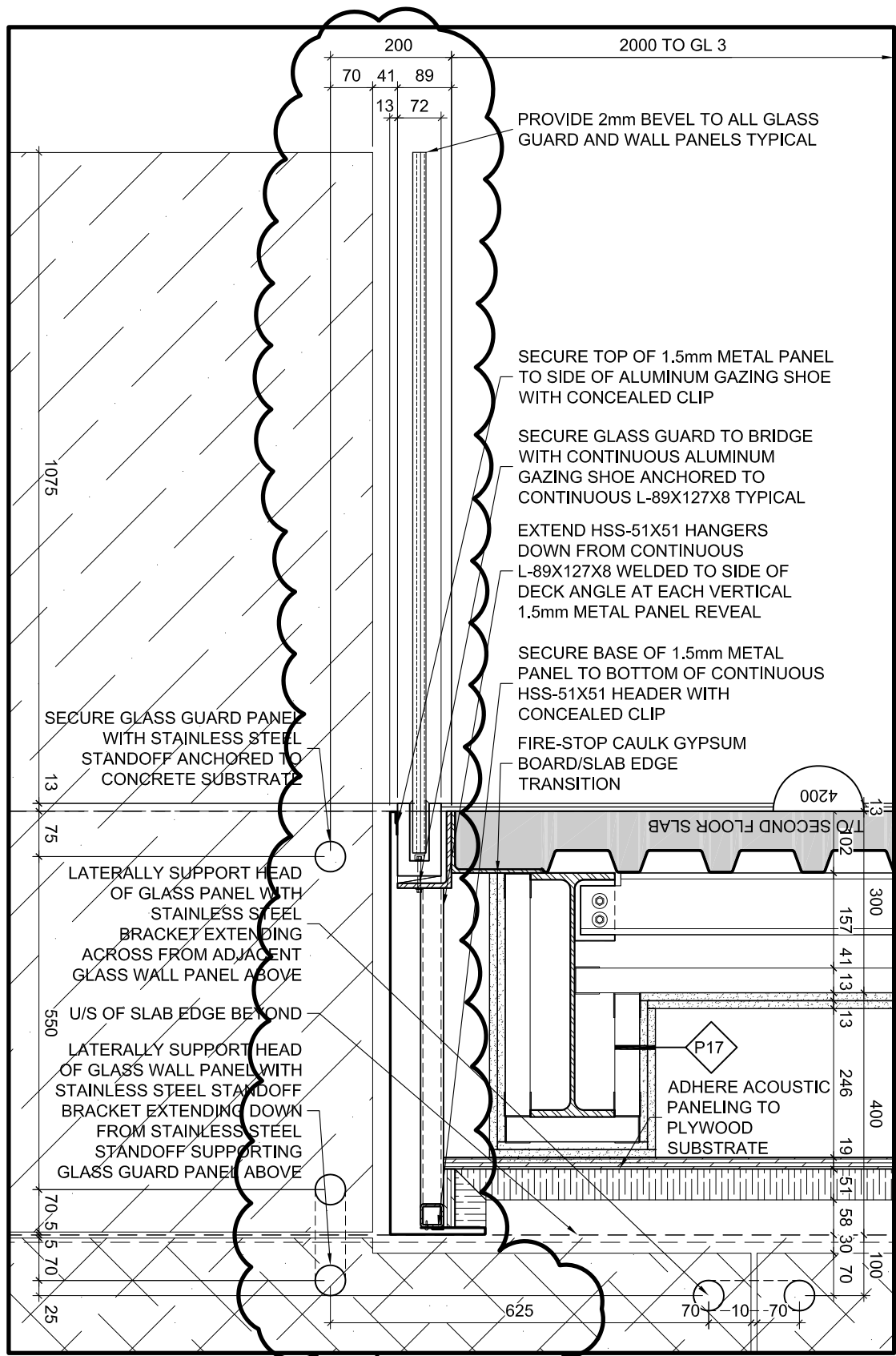

6 TYPICAL BRIDGE SECTION DETAIL
 A604 SCALE =1:10



PROJECT:
 TOMLINSON NEW BUILDING

DRAWING TITLE:
 REFERENCE REV'D DET. AS INDICATED

DATE: 01/14/2018

SCALE: AS INDICATED

DRAWN BY: JK

JOB No: 574-15

DRAWING No: **ASK-235**

S:\CSA Jobs\2015 Projects\574-15 Tomlinson Corporate Headquarters, Nepean\03 Working Drawings\0-Sheets\574-15-A604.dwg

Layout: ASK-236

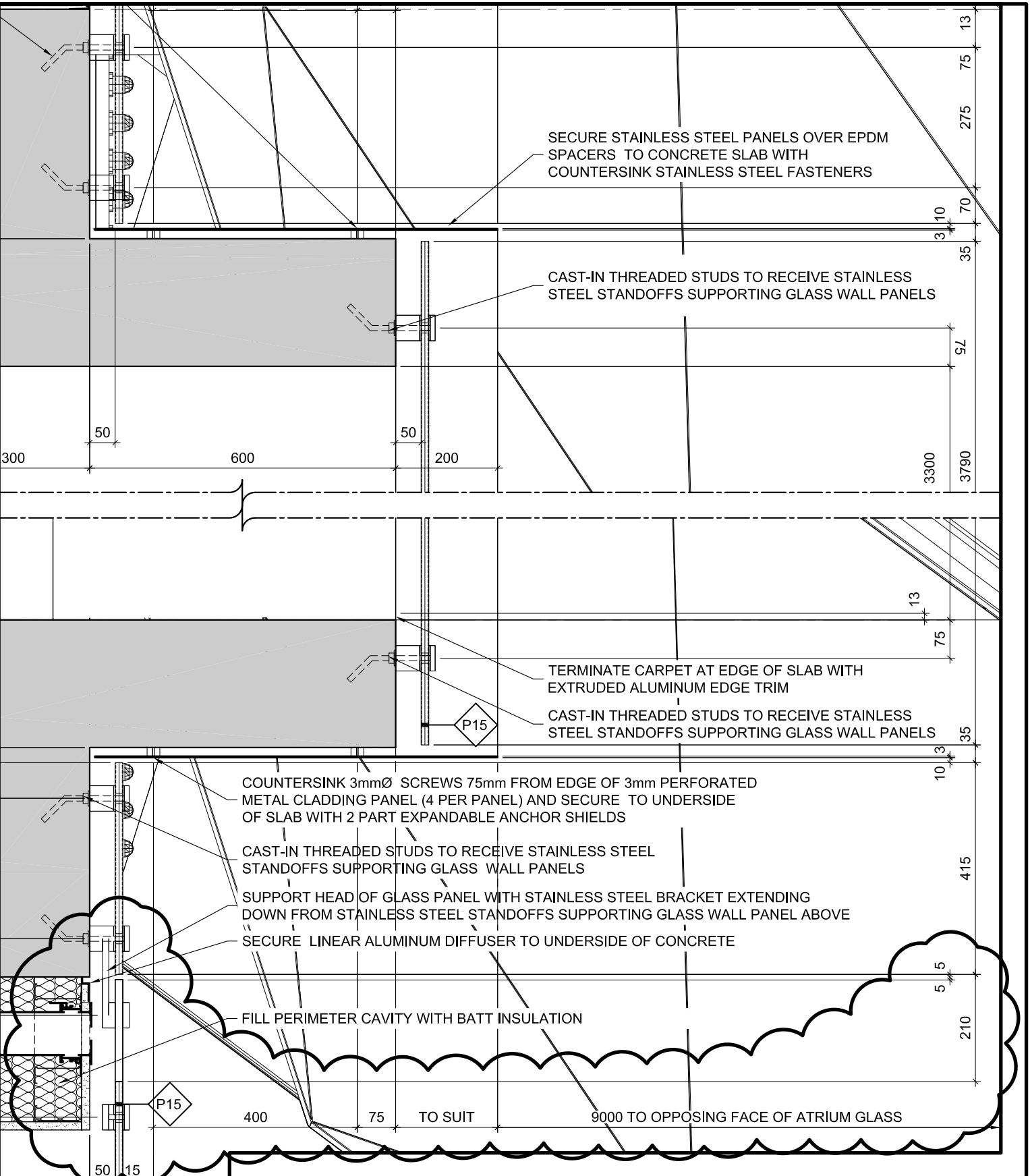

THE ANNEX / 450 CECIL ST. OTTAWA ON K1R 6S3
613.567.7888 PHONE / 613.567.7528 FAX
csarchitect.com



PROJECT:
TOMLINSON NEW BUILDING

DRAWING TITLE:
REFERENCE PART. REV. DET. 16/A604

DATE: 01/14/2018

SCALE: 1:10

DRAWN BY: JK

JOB No: 574-15

DRAWING No: ASK-236