

1 EXTERIOR STAIR PLAN  
SCALE: 1/2" = 1'-0"

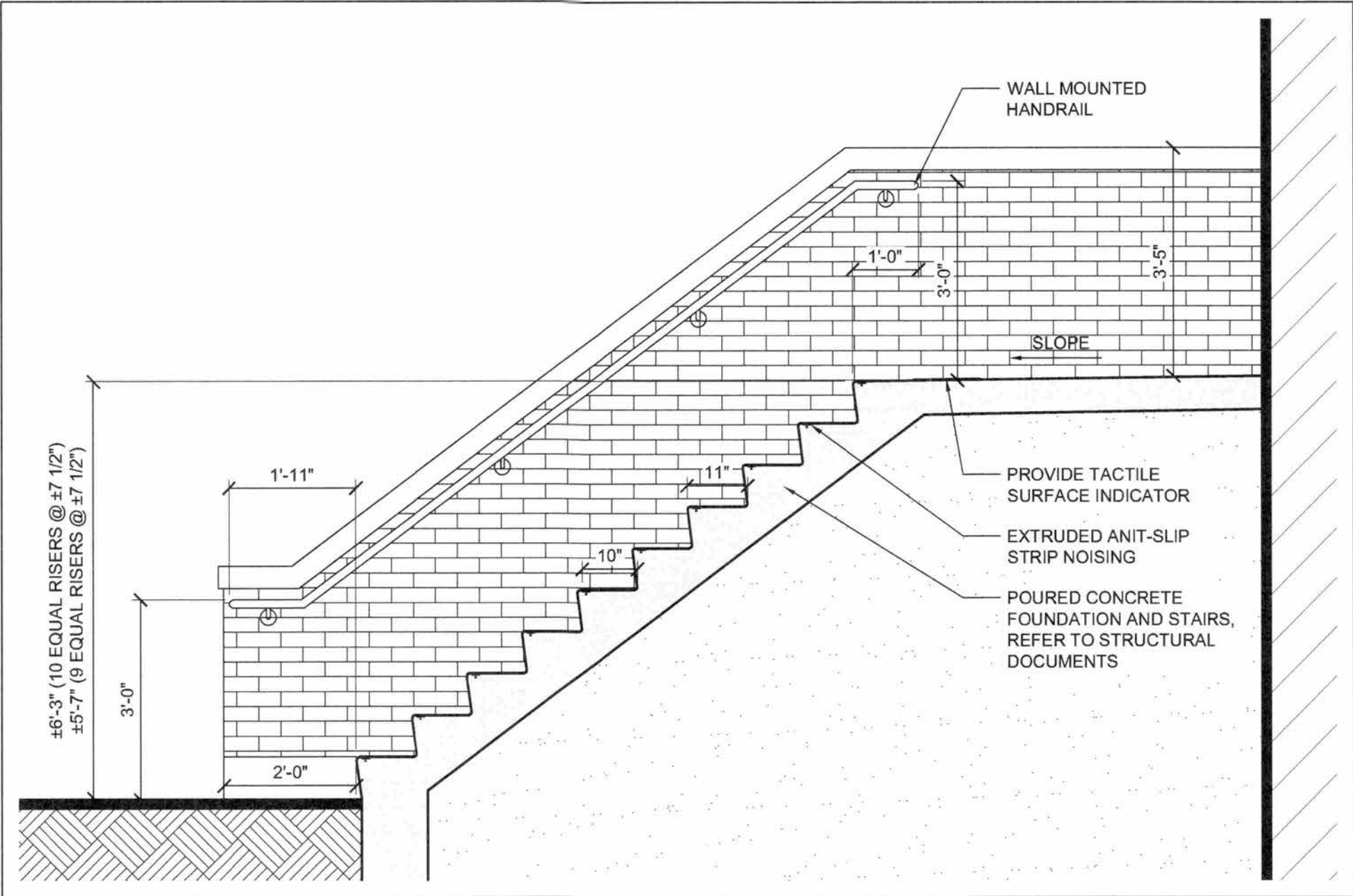

2 EXTERIOR STAIR SECTION  
SCALE: 1/2" = 1'-0"

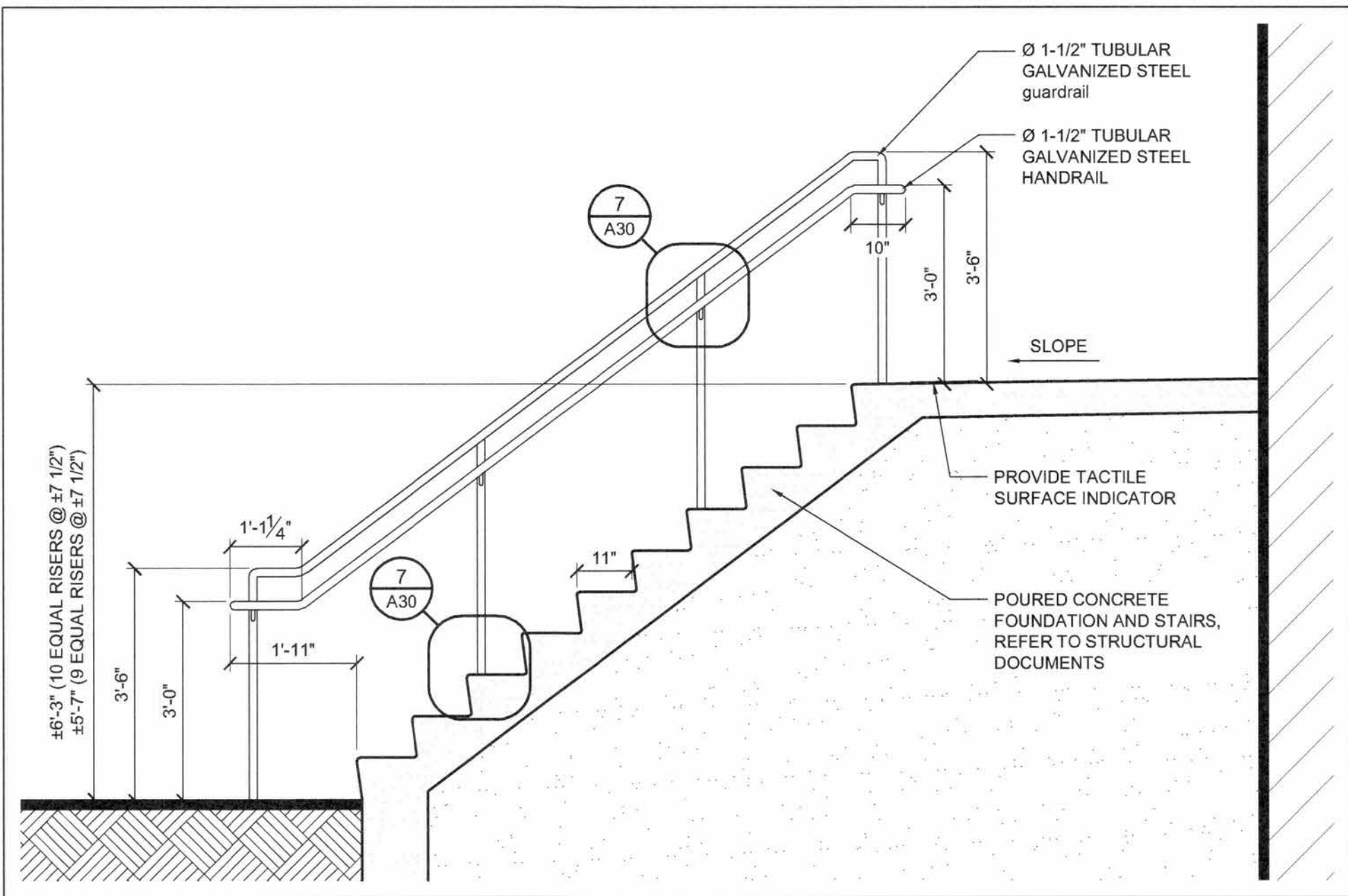

3 EXTERIOR STAIR SECTION  
ÉCHELLE: 1/2" = 1'-0"

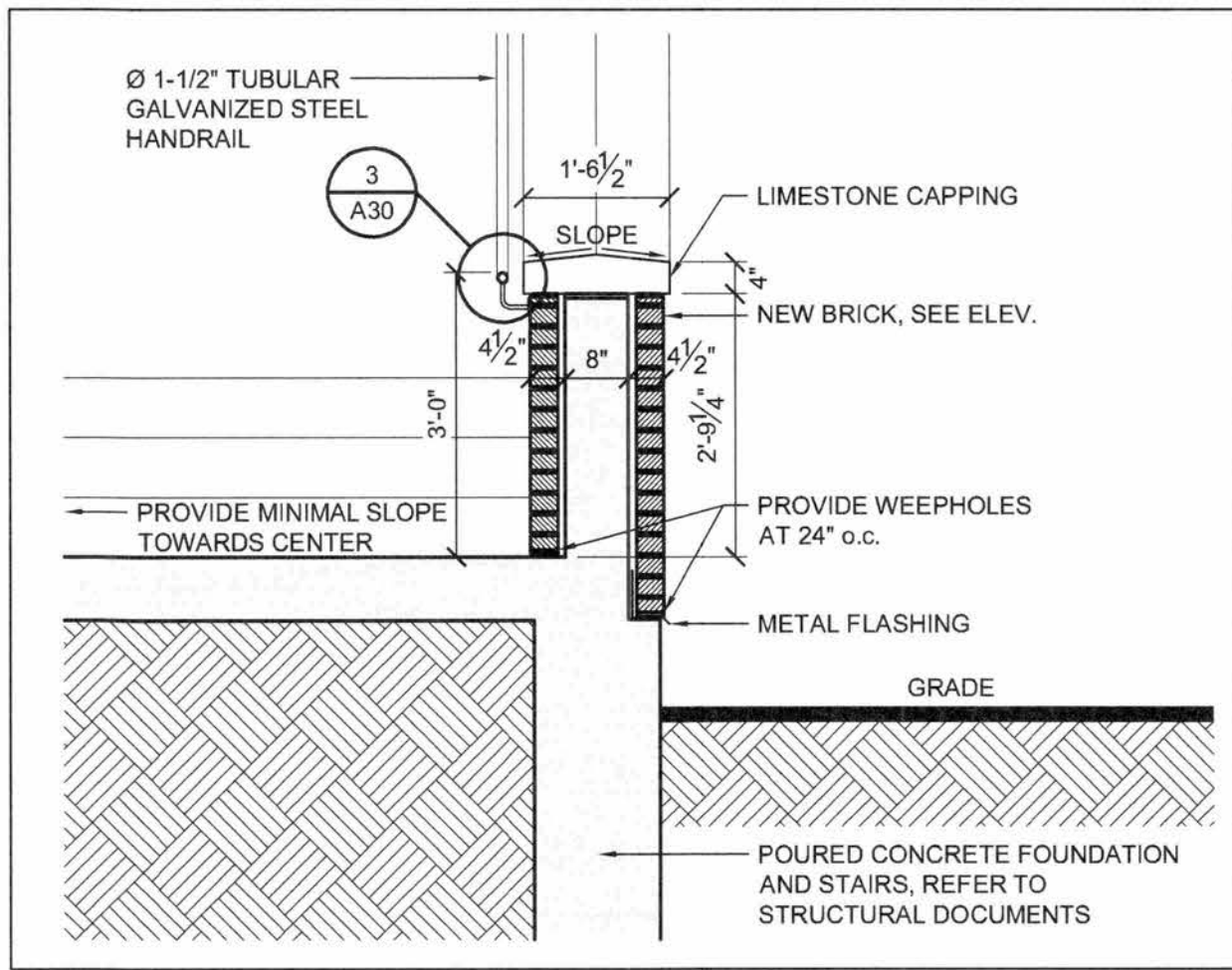

4 EXTERIOR STAIR WALL SECTION  
SCALE: 1/2" = 1'-0"

1	FOR TENDER	01/06/18
No.	ISSUE / REVISION	DDMMYY

This drawing is copyright protected and may not be reproduced or used for purposes other than execution of the described work without the express written consent of J.L. Richards & Associates Limited.

VERIFY SHEET SIZE AND SCALES. BAR TO THE RIGHT IS 1" IF THIS IS A FULL SIZE DRAWING.

SCALE: 0 1'

CLIENT:  
 Conseil des écoles publiques de l'Est de l'Ontario

CONSULTANT:  
 McIntosh Perry Consulting Engineers Ltd.

CONSULTANT:  
 J.L. Richards ENGINEERS - ARCHITECTS - PLANNERS

CONSULTANT:  
 PAGEAU MOREL  
www.pageaumorel.com  
Gatineau

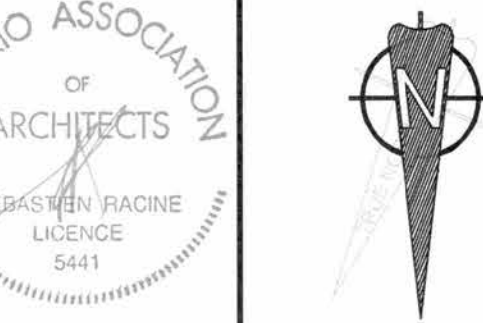
PROFESSIONAL STAMP  
 ONTARIO ASSOCIATION OF ARCHITECTS  
SÉBASTIEN RACINE  
LICENCE  
5441

PROJECT:  
MAISON DE LA FRANCOPHONIE D'OTTAWA  
2720 RICHMOND ROAD, OTTAWA

DRAWING:  
EXTERIOR STAIR PLAN AND DETAILS

DESIGN: SD	DRAWING #:
DRAWN: MM	
CHECKED: SD	
JLR # 27672-001	A35