

File Location: R:\27000\27672-000.1 - cspco - 2720 richmond road (ontio)\JLR DWG\Struct\27672 S10.dwg

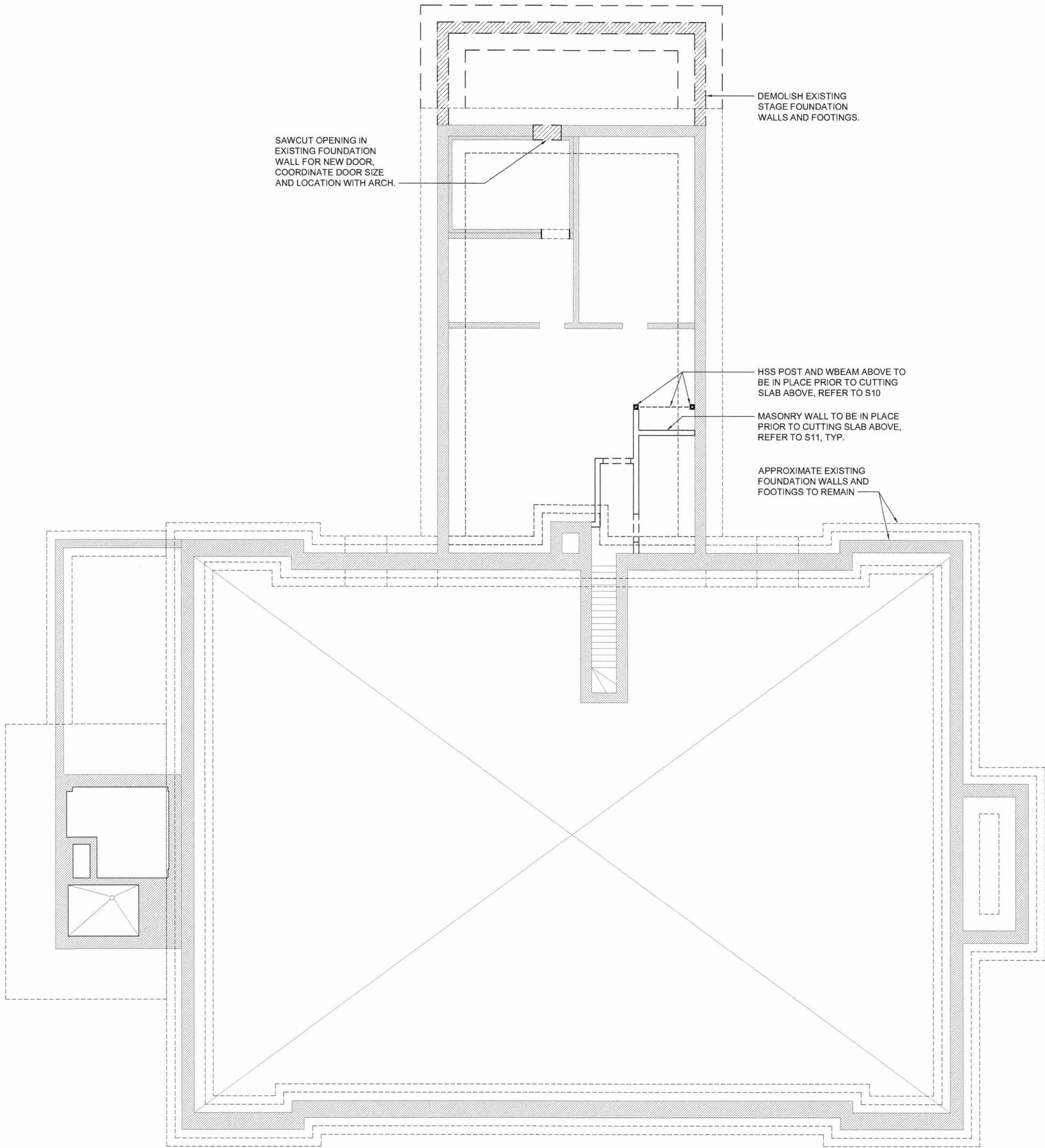

1 DEMOLITION FOUNDATION PLAN
DS10 SCALE: 1/8" = 1'-0"

1.0 DEMOLITION NOTES

- 1.1 COMPLY WITH LOCAL, PROVINCIAL AND FEDERAL ENVIRONMENTAL REGULATIONS WHEN PERFORMING ALL WORK. COMPLY WITH ALL WORKPLACE HEALTH AND SAFETY REGULATIONS.
- 1.2 DO NOT SCALE THE DRAWINGS.
- 1.3 INFORMATION REGARDING THE EXISTING STRUCTURAL SYSTEMS AND ARCHITECTURAL SYSTEMS ARE BASED ON THE FOLLOWING:
 - REFERENCE DST GEOTECHNICAL INVESTIGATION REPORT AND DST GEOTECHNICAL INVESTIGATION REPORT ADDENDUM NO.1 - GS-OT-015122 - AUGUST 2012
 - REFERENCE ERA-SPE STRUCTURAL DEMOLITION DRAWINGS AND RECOMMENDATIONS - FILE NO. 171-0002-04 - DECEMBER 2017.
 - REFERENCE DST ADDITIONAL FIELD GEOTECHNICAL INVESTIGATION AND FOUNDATION RECOMMENDATIONS - IN-SO-31236 - FEBRUARY 2018
 - REFERENCE EHS' DESIGNATED SUBSTANCE REPORT- OCTOBER, 2017
 - EXISTING STRUCTURAL DRAWINGS
- 1.4 THE CONTRACTOR IS RESPONSIBLE TO REVIEW AND UNDERSTAND THE FACTUAL RESULTS OF THE ABOVE NOTED INVESTIGATION REPORTS, SATISFY THEMSELVES AS TO THE ADEQUACY OF THE INFORMATION FOR CONSTRUCTION/DEMOLITION AND MAKE THEIR OWN INTERPRETATION OF THE FACTUAL DATA AS IT AFFECTS THEIR PROPOSED CONSTRUCTION TECHNIQUES, SCHEDULE, EQUIPMENT CAPABILITIES, COSTS, SEQUENCING AND THE LIKE.
- 1.5 THE CONTRACTOR SHALL BE RESPONSIBLE FOR COORDINATING AND PAYING FOR ANY AND ALL LOCATES (INCLUDING PRIVATE) REQUIRED TO COMPLETE THE WORK, INCLUDING, BUT NOT LIMITED TO, HYDRO, TELEPHONE, GAS, PROCESS, FIBRE, ETC.
- 1.6 SCOPE OF WORK FOR DEMOLITION IS LIMITED TO THE AREAS SHOWN IN THE PARTIAL PLANS.
- 1.7 IT IS THE CONTRACTOR'S RESPONSIBILITY TO RELOCATE ANY EXISTING MECHANICAL AND ELECTRICAL SERVICES THAT ARE TO REMAIN AND ARE AFFECTED BY THE SLAB DEMOLITION. THE CONTRACTOR IS TO TAKE CARE NOT TO DAMAGE THE EXISTING SERVICES AND PROVIDE SUPPORT, AS REQUIRED, TO FACILITATE THE DEMOLITION.
- 1.8 DRAWINGS ARE PROVIDED TO GIVE A GENERAL INDICATION OF THE SCOPE OF THE WORK ONLY. CONFIRM EXACT EXTENT OF THE DEMOLITION ON SITE. THE CONTRACTOR IS RESPONSIBLE TO LOCATE ALL EXISTING MECHANICAL AND ELECTRICAL SERVICES AND CAREFULLY REVIEW THE REMOVAL METHODOLOGY OF THESE SERVICES PRIOR TO THE COMMENCEMENT OF WORK.
- 1.9 CONTRACTOR MUST MAKE AN INDEPENDENT ASSESSMENT OF THE DIFFICULTIES LIKELY TO BE ENCOUNTERED DURING THE PROJECT AND MAY NOT CLAIM AT ANY TIME AFTER SUBMISSION OF TENDER THAT THE CONTRACT DOCUMENTS WERE UNCLEAR, INCOMPLETE OR INCORRECT WITH REGARDS TO SITE CONDITIONS.
- 1.10 CONTRACTOR TO GIVE ALL NECESSARY NOTICES, OBTAIN ALL NECESSARY PERMITS AND PAY ALL FEES IN ORDER THAT THE WORK MAY BE CARRIED OUT.
- 1.11 CONTRACTOR TO REVIEW DESIGNATED SUBSTANCE SURVEY REPORTS, ENVIRONMENTAL SITE ASSESSMENT REPORTS AND TAKE PRECAUTIONS TO PROTECT THE ENVIRONMENT, OWNER'S PERSONNEL AND WORKERS.
- 1.12 CONTRACTOR TO CARRY OUT DEMOLITION WORK IN ACCORDANCE WITH THE CSA CODE OF PRACTICE FOR SAFETY IN DEMOLITION OF STRUCTURES (CSA S350 - M1980 (R2003)).
- 1.13 COMPLY WITH THE OCCUPATIONAL HEALTH AND SAFETY ACT OF ONTARIO.
- 1.14 CONTRACTOR TO COMPLY WITH THE THREE R'S REGULATION IN ONTARIO. PRIOR TO COMMENCEMENT OF DEMOLITION CONTRACTOR TO SUBMIT A WASTE AUDIT IN ACCORDANCE WITH ONTARIO REGULATION 102/94. CONTRACTOR TO COMPLY WITH THE SOURCE SEPARATION PROGRAM IN ACCORDANCE WITH ONTARIO REGULATION 103/94. THE CONTRACTOR MUST ALSO COMPLY WITH ONTARIO REGULATION 326/03, WASTE MANAGEMENT.
- 1.15 THE CONTRACTOR IS RESPONSIBLE FOR THE OVERALL SEQUENCE OF WORK AND TO ENSURE THE BUILDING AND ALL ITS COMPONENTS ARE STABLE AND SAFE AT ALL TIMES. PROVIDE SHOP DRAWINGS SHOWING CLEAR DECONSTRUCTION METHOD AND SEQUENCING. DRAWINGS ARE TO BE SEALED BY A PROFESSIONAL ENGINEER LICENCED BY THE PROVINCE OF ONTARIO.

1	FOR TENDER	01/06/18
No.	ISSUE / REVISION	DDMMYY

This drawing is copyright protected and may not be reproduced or used for purposes other than execution of the described work without the express written consent of J.L. Richards & Associates Limited.

VERIFY SHEET SIZE AND SCALES. BAR TO THE RIGHT IS 1" IF THIS IS A FULL SIZE DRAWING.

SCALE: AS NOTED

CLIENT:
 Conseil des écoles publiques de l'Est de l'Ontario

CONSULTANT:
 

CONSULTANT: www.jlrchards.ca

 J.L. Richards
ENGINEERS - ARCHITECTS - PLANNERS

CONSULTANT:
 PAGEAU MOREL
www.pageaumorel.com
Gatineau

PROFESSIONAL STAMP
 M.J. BURTT
100111392
PROVINCE OF ONTARIO

PROJECT NORTH

PROJECT:
MAISON DE LA FRANCOPHONIE D'OTTAWA
2720 RICHMOND ROAD, OTTAWA

DRAWING:
DEMOLITION FOUNDATION PLAN

DESIGN: SDB	DRAWING #: DS10
DRAWN: JPS	
CHECKED: MJB	
JLR #: 27672-001	

PLOT DATE: May 31, 2018 4:12:54 PM