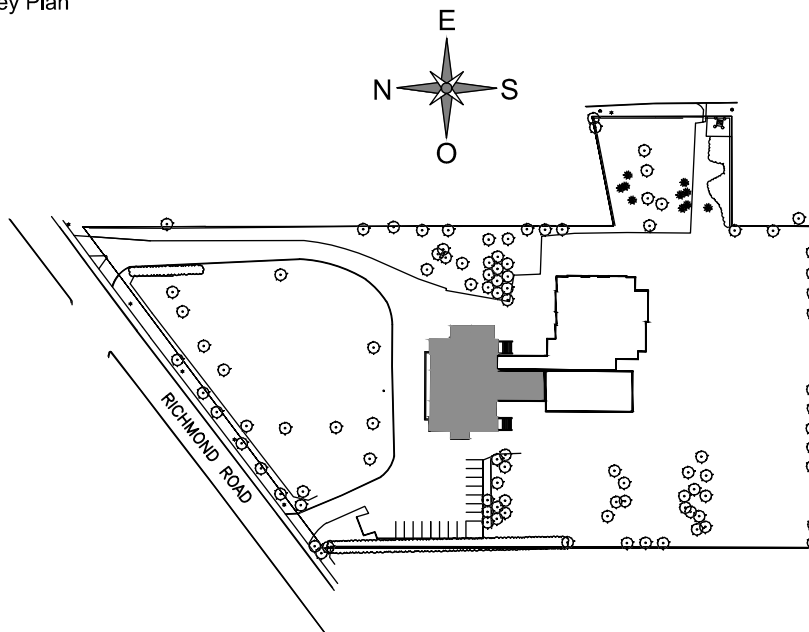

- 1- UNLESS NOTED OTHERWISE, ALL NORMAL SERVICES ARE CONNECTED ON ELECTRICAL PANEL P-03.
- 2- SEE ELECTRICAL PANEL FOR ALL MECHANICAL EQUIPMENT CIRCUIT INFORMATION.
- 3- INSTALL A SAFETY SWITCHES FOR ALL EV UNITS IN CEILING SPACE.
- 4- ALL WIRING DEVICES INSTALLED ON EXISTING WALL TO BE SURFACE MOUNTED UNLESS OTHERWISE SPECIFIED.

- A. NEW 6"x6"x2" BOX BEHIND THE TV. EXACT LOCATION TO BE DETERMINED ON SITE. PROVIDE ONE 27mm CONDUIT TO THE FLOOR BOX AND ONE 41mm CONDUIT TO ANOTHER NEW 6"x6"x2" BOX 6" FROM THE FLOOR. PROVIDE AN ACCESS DOOR TO COVER IT (EXAMPLE AND FROM CENDEX); EXACT LOCATION OF THAT BOX TO BE DETERMINED ON SITE.
- B. NEW POKE THROUGH FLOOR BOXES WITH TWO REGULAR DUPLEX PLUGS AND TWO DECORA COMMUNICATION OPENINGS, #476-6-83-XCF FROM WELLMARK.
- C. JUNCTION BOX IN CEILING SPACE FOR AUTOMATIC DOOR SYSTEM 2"X1" CONDUIT AND PULS BUTTONS. FOR REQUIRED ACCESSIBILITY COORDINATE EXACT LOCATION WITH ARCHITECT, MOUNTED HEIGHT OF PUSH BUTTONS IS 40" ABOVE FLOOR.

- 1 INSTALL THE PLUG BEHIND THE TV. EXACT LOCATION TO BE DETERMINED ON SITE.
- 2 INSTALL AN ELECTRICAL OUTLET FOR WATER FOUNTAIN AT 16"(400mm) AFF.
- 3 CIRCUIT IN CEILING SPACE RESERVED FOR CONTROL EQUIPMENT. COORDINATE CONNECTIONS AND LOCATION ON SITE WITH DIVISION 25.
- 4 4" FIRESTOP SLEEVE.
- 5 TWO(2) NEW CABLE TRAYS MODEL OF 150/150 FROM LEGRAND. INSTALL CABLE TRAYS ONE OVER THE OTHER.
- 6 COORDINATE EXACT HEIGHT AND LOCATION WITH OWNER.
- 7 CONNECT THE CABLE TRAY TO THE GROUND BAR WITH A 12 AWG GREEN CONDUCTOR.
- 8 COORDINATE EXACT HEIGHT AND LOCATION WITH OWNER. PLUG IS APPROXIMATELY AT 72" FROM THE FLOOR AND DATA AT 60".
- 9 2" SLEEVE.

[illegible]

Architect

## Structure

Sea

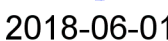

Project

Title

Drawn by :	F.BR.	Project n°:	7342-001-00
Design by :	J.RI.	Date :	2018-06-01
Verified by :	M.L.E.	Scale :	1/8" = 1'-0"

Drawing n°

\_\_\_\_\_

Project n°: 7342-001-00

Date : 2018-06-01

Scale : 1/8" = 1'-0"

Scale : 1/8" = 1'-0"

Drawing n°

Revision

THIS DRAWING SHALL NOT BE USED FOR  
CONSTRUCTION OR INSTALLATION  
PURPOSES.

## MODIFIED

E-204

0