

PLUMBING EQUIPMENT SCHEDULE

	WATER CLOSET WITH ELONGATED BOWL, VITREOUS CHROME MODEL ZB685 FROM ZURN FURNISHED WITH MOUNTED ELECTRONIC FLUSH VALVE .6L PER FLUSH, MODEL ZSE6M90-1V-I/S-WHSI, PLASTIC SEAT, FRONT OPENED WITH WHITE HINGES, MODEL ZB95SS-MMS-AJTS, CONVERTER 120V/6DVDC, 2 AMP, MODEL P6000-HWG AND ELECTRIC CONNECTION BOX P6000-MM.
WC.3	WATER CLOSET FOR CHILDREN, 2 PIECES, ELEGANT "H" HIGH BOWL, TANK COVER LOCKING DEVICE, 1.6 GPF, INTERNAL FLUSH WALK, VANDAL-PROOF LOCKING LID, OPEN FRONT JUVENILE TOILET SEAT COVER WITH STAINLESS STEEL CHECK HINGE.
L.1	COUNTERTOP MOUNTED LAVATORY, VITREOUS PORCELAIN, ADA COMPLIANT, MODEL Z134 FROM ZURN CW ELECTRONIC FAUCET, WIRED TYPE, 1.5 USGPM, MODEL ZB91SLX-CWB-J, CONVERTER 120V/BVC, 2 AMP, MODEL P6000-HWG AND ELECTRIC CONNECTION BOX P6000-MM, THERMOSTATIC MIXING VALVE ZWI70TX/L, PHC TRAP 2870-S-P-B-D, DAISY GRID LAVATORY DRAIN, CHROME, 3/7D, CONCEALED ARM SYSTEM, Z1231 AND THERMAL AND CHOC PROTECTOR KIT ZN946-3-N/T.
L.2	MOUNT LAVATORY, VITREOUS PORCELAIN, ADA COMPLIANT, MODEL Z3324 FROM ZURN CW ELECTRONIC FACUT, WIRED TYPE, 1.5 USGPM, MODEL ZB91SLX-CWB-J, CONVERTER 120V/DVDC, 2 AMP, MODEL P6000-HWG AND ELECTRIC CONNECTION BO P6000-MM, THERMOSTATIC MIXING VALVE ZWI70TX/L, PHC TRAP 2870-S-P-B-D, DAISY GRID LAVATORY DRAIN, CHROME, 3/7D, CONCEALED ARM SYSTEM, Z1231 AND THERMAL AND CHOC PROTECTOR KIT ZN946-3-N/T.
L.3	DECK LAVATORY SYSTEM MODEL EXD-ZNVWH-4 SET WH-6324-T/M FROM BRADLEY COW TWO (2) ELECTRONIC FAUETS MODEL S91TOZS6TR FROM DELTA (4 CENTER HOLES), HARD WIRED WITH BATTERY BACKUP, 110V /TQ24V CLASS II, 20VA TRANSFORMER , OFFSET CHROME PLATED GRIP STRAINER MODEL 155CW FROM MCQUIRE, SUPPLY VALVES MODEL H216SKXS16 from McGUIRE and TP" TRAP MODEL 8872C FROM MGUIRE AND MIXING VALVE FROM BRADLEY (GROUPS OF LAVATORY CAN BE CONNECTED TO THE SAME MIXING VALVE), BRAIDED STAINLESS LAVATORY RISERS, CONNECTION: DRAINAGE 1"-1+1/4". DCW & DHW 1/2".
L.4	STAINLESS STEEL SINK, DROP IN MODEL Y1821 FROM FRANKF, CA FAUCET LAUGE, 18, UNDERCOATED, CENTER BACK WASTE, 1 FAUCET HOLE 1-1/8" DIAMETER, 4" CENTERSET AUTOMATIC FAUCET ADA COMPLIANT, MODEL.
UR.1	WALL HUNG URINAL WITH ELECTRONIC FLUSH VALVE MODEL CASCADE 410 FROM MANSFIELD, 0.5 LPF, ELECTRONIC FLUSH VALVE WITH BY-PASS BUTTON MODEL 811231BTA-AMO FROM DELTA, URINAL CARRIER CAR WALL HANGER BRACKETS, CONNECTION: DRAINAGE 2"/O, DOW 1/2"
GR.1	GREASE INTERCEPTOR, CAPACITY 15lbs, FLOW RATE 15GPM MODEL WO-1S-B-HD FROM WATTS.
WHY.1	NON FREEZE WALL HYDRANT CW WATER BREAKER AND BACKFLOW, MODEL Z1320 FROM ZURN.
K.S.1	DROP IN SINK, SINGLE COMPARTMENT IN STAINLESS STEEL, 3 FAUCET HOLES, 8" CENTERSET, 6" DEPTH MODEL ALB860R-1/O3 FROM FRANKF COW KITCHEN SINK FAUCET, 2.2 GPM, MODEL ZBT7IG-L-XL-HS-AF FROM ZURN, STAINLESS STEEL BASKET STRAINER,
K.S.2	DROP IN SINK, DOUBLE COMPARTMENTS IN STAINLESS STEEL, 3 FAUCET HOLES, 8" CENTERSET, 6" DEPTH, MODEL ALB860R-1/O3 FROM FRANKF COW KITCHEN SINK FAUCET, 2.2 GPM, MODEL ZBT7IG-L-XL-HS-AF FROM ZURN, STAINLESS STEEL BASCKET STRAINER,
MS.1	MOP SINK FOR JANITOR, FLOOR MOUNTED, MODEL EB-54(2'x24") FROM STERN WILLIAMS CW WALL MOUNTED FAUCET MODEL 2879-A/C FROM DELTA, ALL ACCESSORIES FROM STERN WILLIAMS WHICH INCLUDES : MOP HANGER MODEL T-40, BUMPER GUARD MODEL A-20, MOP SINK DRAIN GASKEt MODEL TC-3, STAINLESS STEEL BACK SPLASH PANEL MODEL BP CONNECTION: DRAINAGE 3"/O, DCW & DHW 1/2".
S.S.1	SERVICE SINK MODEL FL-1 FROM FIAT CP ANGLE LOS, DRAIN KIT AND FAUCET MODEL A-1. CONNECTION: DRAINAGE 2"/O, DCWV & DHW 1/2".
TP.1	TRAP PRIMER MODEL P2-500 FROM PRECISION PLUMBING PRODUCT. CONNECTION: DCW 1/2".
DF.1	DOUBLE NON REFRIGERATED DRINKING FOUNTAIN WITH HAND FREE BOTTLLE FILLER MODEL MRSLRFBF LEFT(HIGH, RIGHT LOW) FROM OASIS, RATED CAPACITY 8 OGPH, UNIT C/W BUILT-IN 100 MICRON STRAINER, LEAF FEED MATERIALS, STAINLESS STEEL TOP, CHROME PLATED BRASS ONE PIECE, TAMPER RESISTANT BUBBLER, ADA BOTTLLE FILLER ACTIVATION LEVER, HEAVY DUITY GALVANIZED STEEL FRAME, REFRIGERANT R-134a, PUSH PAD ACTIVATION, ADJUSTABLE EXTERNAL STEM HEIGHT, FINISH IS BRUSHED STAINLESS STEEL, FINISH, ELECTRICAL CONNECTION TO 120VOLTS FROM 1/2" DIA ORCUIT CONNECTION: DRAINAGE 1-1/4"D, DCW 1/2"
F.D.1	FLOOR DRAIN WITH REVERSIBLE MEMBRANE CLAMP MODEL FD-100-C FROM WATTS DRAINAGE, C/W TRAP PRIMER OR TRAP GUARD, CONNECTION & SIZE: SEE DRAWING.
F.D.2	FLOOR DRAIN MODEL FD-200 FROM WATTS DRAINAGE, C/W TRAP PRIMER OR TRAP GUARD, CONNECTION & SIZE: SEE DRAWING.
FFD.1	FUNNEL FLOOR DRAIN WITH REVERSIBLE MEMBRANE CLAMP MODEL FD-100-C-E-G - FROM WATTS DRAINAGE, C/W TRAP PRIMER OR TRAP GUARD, CONNECTION & SIZE: SEE DRAWING.
FFD.2	FUNNEL FLOOR DRAIN WITH REVERSIBLE MEMBRANE CLAMP MODEL FD-200-C-E-G-1 FROM WATTS DRAINAGE, C/W TRAP PRIMER OR TRAP GUARD, CONNECTION & SIZE: SEE DRAWING.
R.O.X	ROOF DRAIN MODEL RD-100-BED FROM WATTS DRAINAGE.
CO	CLEAN OUT WITH ROUND TOP MODEL CO-20-R FROM WATTS DRAINAGE. CONNECTION & SIZE: SEE DRAWINGS.
H.B.I	INTERIOR HOUSE CONNECTION MODEL MHY-90 FROM MFIB AW/CNTI-SIPHON VACUUM BREAKER, DCW CONNECTION 3/4".
RP.1	DOMESTIC HOT WATER RECIRCULATION PUMP MODEL ASTRO 210CI-SWT-T/A FROM ARMRSTRONG (SET TO SPEED 1), CAPACITY OF 10GPM AT 2.5' OF HEAD, ELECTRICAL CONNECTION 120V/1/60, FLA 1.72A, 75 WATTS CW 5 FOOT OF POWER CORD, 24HR TIMER WITH 15 MINUTE INTERVAL SETTING AND AQUASTAR. ALL ELECTRICAL CONNECTION BY DIVISION 28.
SP.1	ELEVATOR SUMP PIT PUMP MODEL OSP50 FROM HYDRAMATIC, CAPACITY 40GPM WITH 15" OF HEAD, ELECTRICAL CONNECTION 120V/1/60, 1.72A, 75 WATT MAXIMUM CURRENT, 24 HOUR RUN TIME, 1/2" NPT Q.A.L.E.T XT FROM HYDRAMATIC, ELECTRICAL CONNECTION 120V/160, 7W, WIDE ANGLE FLOAT SWITCH WITH 20" CABLE, SEE DETAIL ON DRAWING, IT IS ALREADY INSTALLED AND PIPING IN THE SLAB, ALL OTHER ACCESSORIES AND PUMPS TO BE SUPPLIED AND INSTALLED.
SP.2	BASEMENT SUMP PIT C/P PUMP MODEL 41 GAL PTIFRM FROM BARNES PROFESSIONAL PLUMBING, CAPACITY 41GPM WITH 15" OF HEAD MIN., ELECTRICAL CONNECTION 120V/1/60, 1/2 HP, C/W AUTO MATIC ALARM PANEL WITH RESET, ELECTRICAL CONNECTION 120V/1/60, 7W, WIDE ANGLE FLOAT SWITCH WITH 20" CABLE, IT IS ALREADY INSTALLED AND PIPING IN THE LANDARD SHOWER ACOD, ARM & WALL FLANGES ARE TO BE SUPPLIED AND INSTALLED.
WM.1	DOMESTIC WATER METER WITH PULSE OUTPUT TO BA S SYSTEM MODEL FTB800OB-PR, CAPACITY OF SYSTEM IS +/- 6.5SGPM ON THE 2-1/2 DOMESTIC Cold WATER MAIN, UNIT COMPLETE WITH SOLID STATE SENSOR, 12V / 6mA FOR OPERATION AND 24V / 20ma FOR UNIT, ACCURACY 1.5% OF READING, FLOW RANGE MIN. 2 GPM TO 132 GPM MAX.
NGM.1	NATURAL GAS METER FOR ENERGY MEASUREMENTS MODEL 301-400-S150FL/G40-ACC115-N0 FROM SAGA METERING INC. OR EQUIVALENT, PIPE SIZE 4", I.N LINE INSTALLATION, MOUNTING FLANGE, POWER 115V, RANGE FROM 0 To Spisg @ -.340 scfd, DVPE=OUTW CONNECTION FOR BA,S,I, INTERCONNECTION.
SH.1	SHOWER UNIT MODEL Z7121-SL-4H-VDPZH-HW, SINGLE HANDLE PRESSURE BALANCING MIXING SHOWER UNIT WITH VOLUME CONTROL, SINGLE BRONZE STEM, STAINLESS STEEL BALANCING PIJTON INTEGRAL WITH STEM ASSEMBLY, METAL LEVER HANDLE, INTEGRAL SERVICE STOPS AND BRASS ADJUSTMENT LID STOP SCREW IN CAP, CWO DOUBL SEAL PACKING, ADJUSTABLE BRASS PACKING Nut, AND REMOVABLE BRASS SEATS; ALL EXPOSED TRIM WITH POLISHED NICKEL CHROME PLATED SURFACE, VALVE SUPPLIED WITH TWO-WAY BRASS RETURNER VALVE, HAND-WALL SHOWER HEAD, 80"(152MM)) FLEXIBLE METAL HOSE, 24"(610MM) MOUNTING SIDE BALL JOINT CONNER, 1/2" X 1/2" SHOWER ACOD, ARM & WALL FLANGES, THE WAIVE INLETS, AND SHOWER OUTLET, ARE 1/2" FEMALE COPPER SWEEt CONNECTIONS.
DWP.1 DWP.2	ARMSTRONG DESIGN ENVELOPE SERIES 6880 POOLCOVER BOOSTER SYSTEM MODEL NG30202, INITIAL DESIGN POINT OF 132 USGPM AT 26.0 PSI HEAD, 2 HP, CK# 9753980 /VOIR PREMIUM EFFICIENCY MOTOR AND AN ARMSTRONG UL TYPE-12 ENCLOSURE VARIABLE SPEEd DRIVE, WHICH SHALL BE INTEGRATED WITH THE MOTOR, AND 52 US GALLON DRAWDOWN TANK DATA MOUNted REMOTELY, SHELL MADE OF CARBON STEEL AND BUTYL RUBBER BLADDER.
RHW.P.1	DOMESTIC HOT WATER RECIRCULATING PUMP MODEL ASTRO 210 FROM ARMRSTRONG, CAPACITY OF 16 USGPM AT 8' OF HEAD LOSS, ELECTRICAL CONNECTION 120/1/60, 100w, 3 SPEEDS, AND CAST IRON BODY C/W 5' OF POWER CORD, TIMER SETTING AND AQUASTAR
H.WT.1 HWT-2	NATURAL GAS FIREd HOT WATER TANK, 100 GALLONS STORAGE TANK, WARRANTY OF 3 YEARS, 2" THICK FIBERGLASS INSULATION UNDER A PAINTED STEEL JACKET, FLEXIBLE TEMPERATURE SETTING POTIONS, 15.000 BT/H, Model 6TH-150 FROM A.O. SMITH, MUST BE SUPPLIED AND INSTALLED WITH ALL ACCESSORIES AS SHOWN ON DETAILS.

NOTES:

1. TRAP GUARD TO BE INSTALLED IN ALL FLOOR DRAINS WHERE POSSIBLE MODEL TG34H FROM ProSet SYSTEMS. IF UNABLE, USE STANDARD TRAP PRIMER MODEL P2-500 FROM PRECISION PLUMBING PRODUCT (PPP)
2. OPEN DRAIN TRAP GUARD MODEL TG22 FROM ProSet SYSTEMS ON ALL OPEN DRAINS.
3. ALL TRAP GUARD TO BE GLUED IN PLACE OR AS PER CITY REQUIREMENTS.

GENERAL NOTE(S):

1- SCHEDULE INDICATES THE SPECIFIC EQUIPMENT USED AS THE STANDARD OF ACCEPTANCE. PROPOSED EQUIVALENTS TO THOSE SPECIFIED MAY BE ACCEPTED BY CONSULTANT.

Key Plan

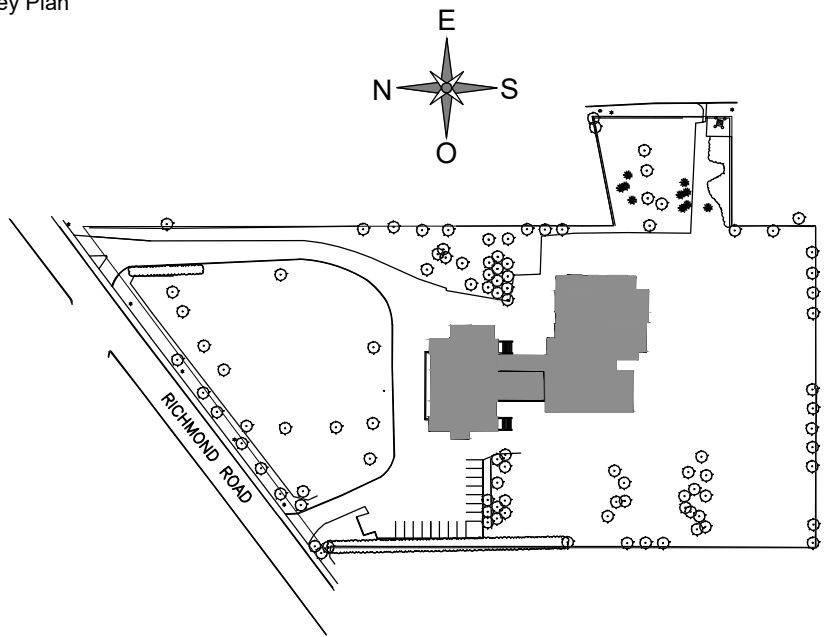

 REVIEW

Nº	Date	Description
0	2018-07-06	FOR TENDER



Architect



Structure

Seal

Project

MAISON DE
DE LA FRANCOPHONIE D'OTTAWA
2720 RICHMOND ROAD, OTTAWA

Title

MECHANICAL PLUMBING

Drawn by :	B. TREMBLAY	Project n°:	7342-001-000
Design by :	B. TREMBLAY	Date :	2018-07-06
Verified by :	F. DIONNE	Scale :	1/8" = 1'-0"

Drawing n°

Revision

M-210

0