

File Location: c:\27000\27672-000-1 - cepso - 2720 richmond road (cm6)\LLR DWG\Struct\27672 S12.dwg

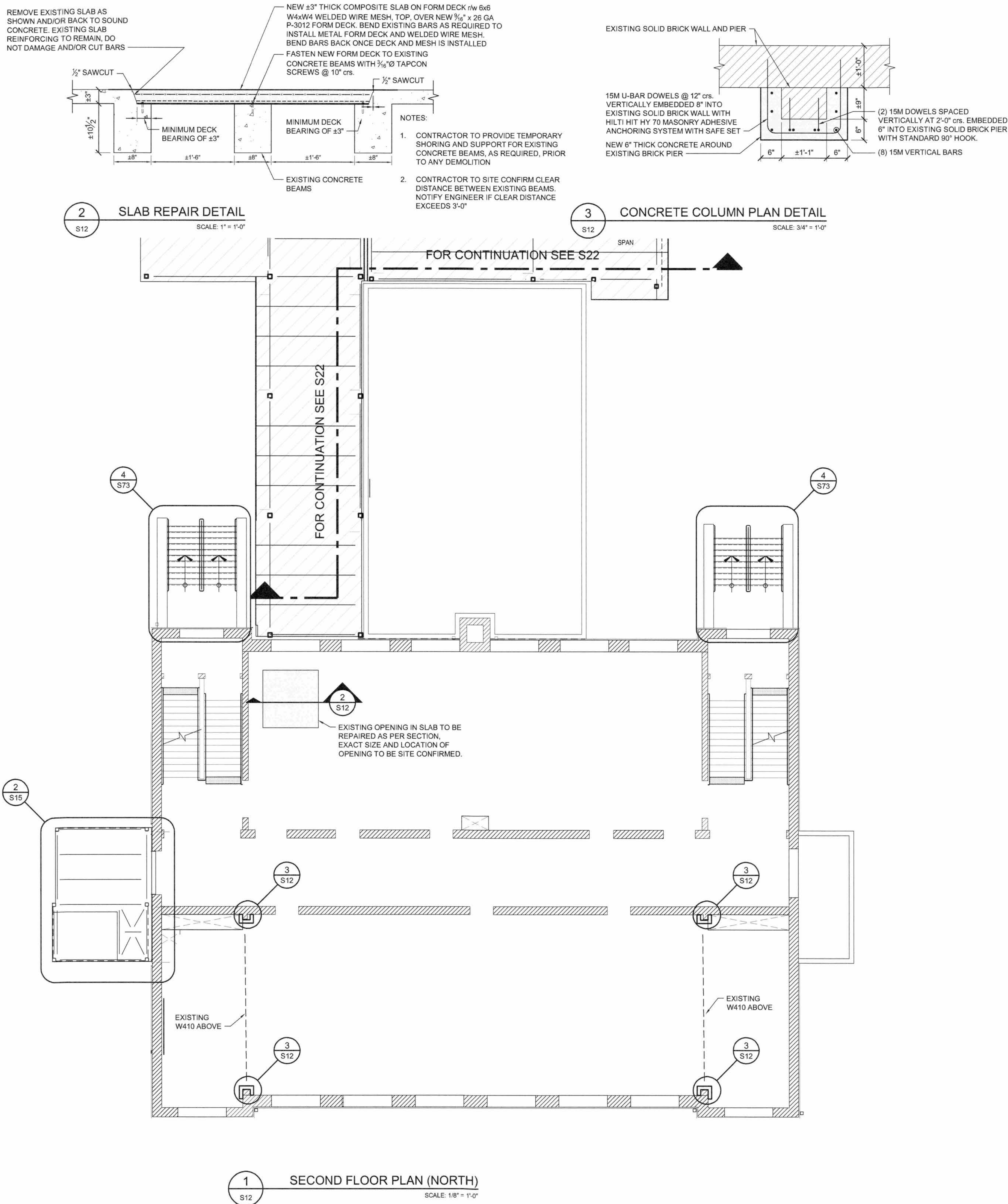

- NOTES:
- REFER TO DRAWING S01 FOR GENERAL NOTES.
 - CONTRACTOR TO ADVISE CONSULTANT FOLLOWING REMOVAL OF INTERIOR FLOOR FINISHES FOR REVIEW OF EXISTING BARE CONCRETE SLAB.

1	FOR TENDER	01/06/18
No	ISSUE / REVISION	DDMMYY

This drawing is copyright protected and may not be reproduced or used for purposes other than execution of the described work without the express written consent of J.L. Richards & Associates Limited.

VERIFY SHEET SIZE AND SCALES. BAR TO THE RIGHT IS 1" IF THIS IS A FULL SIZE DRAWING.

SCALE: AS NOTED

CLIENT:

 Conseil des écoles publiques de l'Est de l'Ontario

CONSULTANT:

 McINTOSH PERRY Consulting Engineers Ltd.

CONSULTANT: www.jrichards.ca

 J.L. Richards
ENGINEERS · ARCHITECTS · PLANNERS

CONSULTANT:

 PAGEAU MOREL
www.pageaumorel.com
Gatineau

PROFESSIONAL STAMP

 M. J. BURTT
100111392
PROVINCE OF ONTARIO

PROJECT NORTH



PROJECT:

MAISON DE LA FRANCOPHONIE D'OTTAWA

2720 RICHMOND ROAD, OTTAWA

DRAWING:

SECOND FLOOR PLAN (NORTH)

DESIGN: SDB	DRAWING #:
DRAWN: JPS	S12
CHECKED: MJB	
JLR #: 27672-001	

PLOT DATE: May 31, 2018 1:33:02 PM