



SUPPLEMENTAL INSTRUCTION

CONTRACTOR:
Tal-Co Building Innovations
4728 Bank Street, Suite A
Ottawa, ON, K1T 3W7
Attention: **Farah Bano**

PROJ.: **Turnbull School Music Room Addition**
PROJ. No.: 1705
DATE: October 22, 2018
S.I. No. **S.I. - 002**

Supplemental Instructions are issued only for the purpose of recording any clarification or interpretation of the contract documents or giving direction on problems resulting from field conditions. These instructions are subject to the provisions of the contract documents and unless stated herein and specifically co-authorized by the Client, will not affect the contract. Should the Contractor require a change in the contract price or project schedule, he shall submit to the Architect within ten (10) days of the date hereof, an itemized proposal. If the proposal is accepted by the Client, this Supplemental Instruction will be superseded by a Change order.

Partners

Barry J. Hobin
OAA, FRAIC, Hon. Fellow AIA

William A. Davis
OAA, MRAIC, Associate AIA

Gordon Lorimer
OAA, FRAIC, Associate AIA

Wendy Brawley
OAA, MRAIC, Associate AIA

Douglas Brooks
Senior Arch. Tech.

Directors

Marc Thivierge
OAA, MRAIC

Reinhard Vogel
Senior Arch. Tech.

Associates

Bryan Bonell
OAA, MRAIC, Associate AIA

William Ritcey
MRAIC

Dan Henhoeffter
Senior Arch. Tech.

Hobin Architecture Incorporated

63 Pamilla Street
Ottawa, Ontario
Canada K1S 3K7

t 613-238-7200
f 613-235-2005

hobinarc.com

1.1 TITLE

Roof Drain Location

1.2 REFERENCE

CCO-002
CIR #7

1.3 DESCRIPTION OF THE WORK

.1 Refer to the attached **Architectural Sketch SI-002.01** for roof and rainwater leader location added into Contract under Contemplated Change Order CCO-002.

1.4 ATTACHMENTS

SI-002.01 – Roof Drain & RWL Location

1.5 REASON

Clarification

Distribution:

- | | | | | |
|------------------------------------------------|------------------------------------------|-------------------------------------|----------------------------------|--------------------------------------|
| <input checked="" type="checkbox"/> Owner | <input type="checkbox"/> City Authority | <input type="checkbox"/> Electrical | <input type="checkbox"/> Struct. | <input type="checkbox"/> Landscaping |
| <input checked="" type="checkbox"/> Contractor | <input checked="" type="checkbox"/> File | <input type="checkbox"/> Mech. | <input type="checkbox"/> Civil | <input type="checkbox"/> Other |

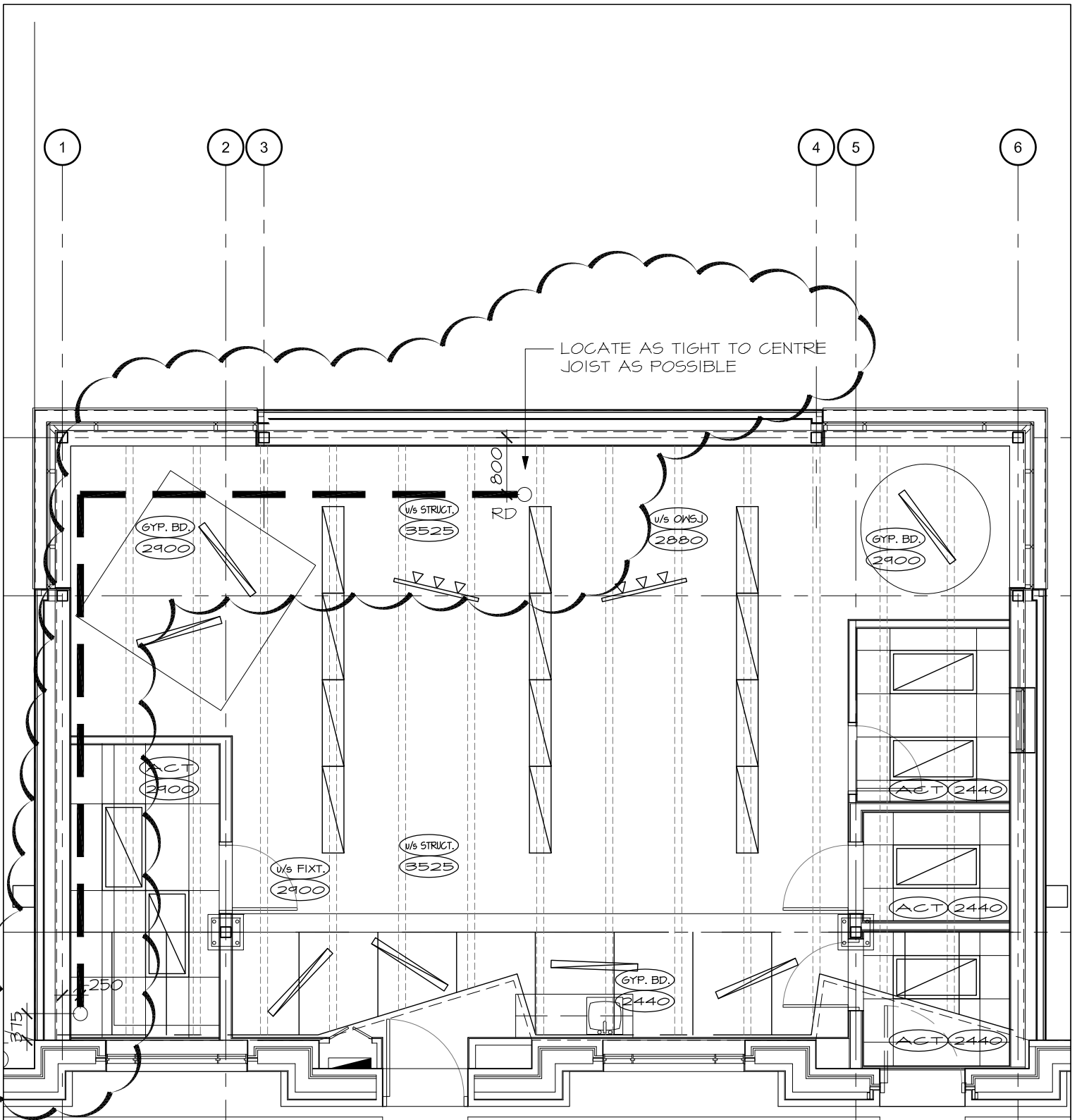

SLOPED
GYP. BD.
2200 TO 2800

GYP. BD.
@ 2965

SLOPED
GYP. BD.
2200 TO 2800

SLOPED
GYP. BD.
2200 TO 2800

@ 2965

220

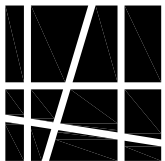

HOBIN
ARCHITECTURE

PROJECT / LOCATION:

**TURNBULL SCHOOL
MUSIC ROOM ADDITION**
1132 Fisher Avenue, Ottawa

Hobin Architecture Incorporated

63 Pamilla Street T: 613-238-7200
Ottawa, ON K1S 3K7 F: 613-235-2005
hobinarc.com E: mail@hobinarc.com

DRAWING NAME:

**ROOF DRAIN
& RWL
LOCATION**

DATE:

OCT. 22 / 18

DRAWN BY:

RV

SCALE:

1:75

PROJECT NO.:

1705

ASK NO.

SI-002.01