



SUPPLEMENTAL INSTRUCTION

CONTRACTOR:
Tal-co Building Innovations
Address:
Sutie 2, 1341 Coker Street
Greely, Ontario, K4P 1A1

PROJ.: **Dovercourt Phase 2**
PROJ. No.: **1713**
DATE: **February 8, 2019**
S.I. No. **S.I. - 012**

Supplemental Instructions are issued to the Construction Manager to record a clarification or revision to the previously issued Contract Documentation as reflected by the attached Information Bulletin prepared by the identified Consultant.

The Construction Manager shall review the Supplemental Instruction and the attached Information Bulletin and issue to the effected Trade Contractors identifying the following course of action by the trade contractor:

- Proceed with Instruction. Issued for general information, no change to Contract price or schedule. (Site Instruction)
- Proceed with Instruction and provide a quotation within 10 days, identifying change to Contract price and schedule (Change Directive)
- Do not proceed. Provide quotation identifying change to Contract price and schedule within 10 days. (CCO)

Partners

Barry J. Hobin
OAA, FRAIC, Hon. Fellow AIA

William A. Davis
OAA, MRAIC, Associate AIA

Gordon Lorimer
OAA, FRAIC, Associate AIA

Wendy Brawley
OAA, MRAIC, Associate AIA

Douglas Brooks
Senior Arch. Tech.

Associates

Bryan Bonell
OAA, MRAIC, Associate AIA

Marc Thivierge
OAA, MRAIC

William Ritcey
MRAIC

Reinhard Vogel
Senior Arch. Tech.

1.1 TITLE

Updated Painting colours and locations

1.2 DESCRIPTION OF THE WORK

.1 Refer to attached IB-A008 for revised locations and paint colours for the office areas, corridor, washrooms and multipurpose space.

1.3 ATTACHMENTS

Dovercourt PH2-IB-A008

1.4 REASON

Updated information and clarification requested by contractor.

Hobin Architecture Incorporated

63 Pamilla Street
Ottawa, Ontario
Canada K1S 3K7

t 613-238-7200
f 613-235-2005

hobinarc.com

Distribution:

- | | | | | |
|--|--|-------------------------------------|----------------------------------|--------------------------------------|
| <input checked="" type="checkbox"/> Owner | <input type="checkbox"/> City Authority | <input type="checkbox"/> Electrical | <input type="checkbox"/> Struct. | <input type="checkbox"/> Landscaping |
| <input checked="" type="checkbox"/> Contractor | <input checked="" type="checkbox"/> File | <input type="checkbox"/> Mech. | <input type="checkbox"/> Civil | <input type="checkbox"/> Other |



INFORMATION BULLETIN

CONSTRUCTION MANAGER:
Tal-co Building Innovations
Address:
Sutie 2, 1341 Coker Street
Greely, Ontario, K4P 1A1

PROJ.: **Dovercourt Phase 2**
PROJ. No.: **1713**
DATE: February 8, 2019
I.B. No. **IB-A008**

The following Information Bulletin is issued to the Construction Manager to describe additional information, or a revision to, previously issued documentation.

1.1 TITLE

Updated Painting colours and locatoins

1.2 REFERENCE

A8.01 Finishes Plan

1.3 DESCRIPTION OF WORK

.1 Please see attached documents for a revised schedule and plan for paint colours and locations

1.4 ATTACHMENTS

A8.01 Finishes Plan
Specifications 09 00 00 Room Finish Schedule
Dovercourt Paint Sample Chips

1.5 REASON

Updated information and clarification requested by contractor.

Issued by:
Doug van den Ham

Partners

Barry J. Hobin
OAA, FRAIC, Hon. Fellow AIA

William A. Davis
OAA, MRAIC, Associate AIA

Gordon Lorimer
OAA, FRAIC, Associate AIA

Wendy Brawley
OAA, MRAIC, Associate AIA

Douglas Brooks
Senior Arch. Tech.

Associates

Bryan Bonell
OAA, MRAIC, Associate AIA

Marc Thivierge
OAA, MRAIC

William Ritcey
MRAIC

Reinhard Vogel
Senior Arch. Tech.

Hobin Architecture Incorporated

63 Pamilla Street
Ottawa, Ontario
Canada K1S 3K7

t 613-238-7200

f 613-235-2005

hobinarc.com

1.0 ROOM FINISH SCHEDULE INDEX

Room Finish Schedule Refer to Schedule on drawing

2.0 GENERAL NOTES

- .1 Ceiling heights given Above Finished Floor (AFF) unless noted otherwise.
- .2 All steel brackets and covers to be painted.
- .3 Heating units supplied primed for paint to be finished to match wall finish on which they occur.
- .4 Closets to have same finish as room in which they occur.
- .5 All exposed piping, ductwork, conduit and equipment inside and outside of mechanical and electrical service rooms to be painted.
- .6 All gas piping (exposed and concealed) to be painted.
- .7 All surfaces visible through ceiling openings to be painted out. Refer to room schedule for same as wall colour or painted noted accent colour. To be confirmed.
- .8 All wood millwork such as handrails, wood ceiling panels are to be pre-finished by Section 06 40 00. All site applied finish carpentry to be stained unless otherwise noted. Refer to Section 09 91 23 for finishing formulas.
- .9 Paint all exposed steel supports, framing and connectors of millwork to match adjacent finish unless otherwise noted.
- .10 All mounting boards and backing furring/studs for electrical equipment to be painted with two coats of fire retardant paint.
- .11 Paint fire extinguisher cabinets to match adjacent wall colour unless stainless steel.
- .12 All steel stairs, railings, trim brackets, access ladders, manhole covers and sump pit covers to be painted
- .13 All discrepancies between documents and drawings are to be reported to the Architect.
- .14 Grout lines width are 3mm wide. Align grout lines with wall and floor grout lines.
- .15 Provide MG1 corner guards or Architect approved equals on all outside corners in public corridor spaces. Approx quantities
- .16 Paint in Wet Areas to have anti-mildew additive. Rooms such as washrooms, showers and lockers

3.0 MATERIAL CODES

WALLS

CONC	Reinforced Poured Concrete – refer Section 03 30 00
CBLOCK	Concrete Block – refer Section 04 22 00
GB GWB	Gypsum Board – refer Section 09 21 16
CB	Cement Board backing – refer Section 09 21 16
PT_	Paint finish – refer Section 09 91 23
CT_	Ceramic Tile – refer Section 09 30 13
PC	Precast Concrete – refer Section 03 45 00
TBB	Tile Backer Board

CEILINGS

GB GWB	Gypsum Wall Board – refer Section 09 21 16
PT_	Paint Finish – refer Section 09 91 23
ACT_/	Acoustical Ceiling Tile– refer Section 09 51 13 & 09 53 00
/G_	Suspended Grid for Ceiling Tile - refer Section 09 51 13 & 09 53 00
CT_	Ceramic Tile – See Section 09 30 13
ASD	Acoustic Steel Deck

MILLWORK

WS_	Wood Stained – refer Specification 06 40 00
SS	Stainless Steel – refer Specification 06 40 00
WD_	Wood Species – refer Section 06 40 00
HD_	Hardware Drawer/Door Pulls for Millwork
MT_	Metal Trim
TSM_	Through Solid Surface Material
ST_	Stone

FLOORING

CT_	Ceramic Tile – refer specification 09 30 13
CAR_	Carpet Tile – refer Specification 09 68 13
RT_	Resilient Tile – refer Specification 09 65 50
MT_	Metal Trim
WD	Wood Activity Floor(Robbins BioCushion Standard of Acceptance)

BASE

RB_	Resilient Base and Transitions – refer Specification 09 65 50
BT_	Base Tile - Ceramic Tile – refer specification 09 30 13
GB	Gym Base (Robbins compatible and as per spec Section 09 64 30)

4.0 INTERIOR FINISHES LEGEND

A RUBBER BASE

SECTION 09 68 13

NOTE: FLOOR BASE APPLY TO MILLWORK BASE UNLESS OTHERWISE NOTED

CODE	MFTR / CO	PRODUCT	PROFILE/SIZE	GENERAL ROOM / AREA
RB-1	Rep: Centura Harry Davis 613-229-4308	Roppe Wall Base – 129 Dolphin	4"	Offices, Meeting Room, Corridor
GB	Robbins	Robbins Vented Base		Multipurpose Room

B CARPET = CAR-(NO.)

SECTION 09 68 13

CODE	MFTR / CO	PRODUCT	BASE	GENERAL ROOM / AREA
CAR-1	Rep: Centura Harry Davis 613-229-4308	Venture Tribeca 50cm X 50 cm(20"x20") Rain 10050, Style 400059 Stacked or brick(1/4 turn)	CB	Office, Meeting Room

C CERAMIC/PORCELAIN TILE = CT-(NO.)

SECTION 09 30 13

Note: Grout product is specific match to the Tile supplier and is not be substituted

CODE	MFTR / CO	PRODUCT	SIZE	GROUT	GENERAL ROOM / AREA
CT-1	Vitra Rep: Centura Harry Davies 613.229.4308	Dotti Series Dark Grey 835604	12"x12"	Power Grout TEC #929 Charcoal Gray	Corridor
CT-2	Rep: Centura Harry Davies 613.229.4308	D.Positive Series LOBBLO White Mat 0	500mm x 200mm	Power Grout TEC #910 Bright White	Millwork Reception Desk backsplash

CT-3	Rep: Centura Harry Davies 613.229.4308	D.Positive Series LOGGR3 Grey 3	500mm x 200mm	Power Grout TEC #910 Bright White	Washrooms
BT-1	Rep: Centura Harry Davies 613.229.4308	Dotti Series Dark Grey 835604	4"x12"	Power Grout TEC #929 Charcoal Gray	Corridor

D INTERIOR PAINT = PT-(NO.)

SECTION 09 91 23

CODE	MFTR / CO	COLOUR	GENERAL ROOM / AREA
PT-1	Benjamin Moore	CC-40 Cloud White	GWB Ceiling, Multipurpose walls, Offices (except as noted), Storage
PT-2	Benjamin Moore	HC-168 Chelsea Gray	Doors and Frames, Accent
PT-3	Benjamin Moore	2066-30 Big Country Blue	Reception Walls
PT-4	Benjamin Moore	HC-145 Van Courtland Blue	Accent
PT-5	Benjamin Moore	2122-40 Smoke	Accent
PT-6	Benjamin Moore	OC-51 Intense White	Field color - walls
PT-7	Benjamin Moore	2072-30 Purple Lotus	Accent
PT-8	Benjamin Moore	2065-10 Admiral Blue	Accent
PT-9	Benjamin Moore	2021-20 Lemon	Outside Washrooms
PT-10	(to match) Para P5214-44 Tower of London	(to match) Para P5214-44 Tower of London	All exposed steel deck and structure
PT-X	Accent Paints	To be selected from above	Confirm colour prior to implementing

E WOOD STAIN = ST-(NO.)

SECTION 06 40 00

WOOD SPECIES = /WD-(NO.)

SECTION 06 40 00

CODE	SPECIES	FINISH	GENERAL LOCATION
WD-1	Birch Select	Clear stain to match existing. Provide samples for Architect's review prior to implementation.	Fitness Room Window Sills
WD-2	Maple Select	Stain finish Provide samples for Architect's review prior to implementation.	Doors, millwork

F SUSPENDED CEILING SYSTEM = G#/T#

SECTION 09 53 00

T-BAR GRID = /G-(NO.)

SECTION 09 51 13

LAY-IN TILE = ACT-(NO.)

CODE	MFTR / CO	PRODUCT	SIZE	GENERAL ROOM / AREA
/G1	Opt 1: CGC Donn DXT	Two directional exposed tee bar grid. Colour: White	Suitable for 2x2 or 4x2 system	Office
ACT-1/	CGC	Ceiling Panel ASTM E 1264 Type	60cmx60cm	Office

	Mars ClimaPlus Edge: SQ Square	IV, form 1 & 2, pattern EG Colour: White		
--	---	--	--	--

**G STONE = STN-(NO.)
THROUGH SOLID SURFACE MATERIAL = TSM-(NO.)**

SECTION 06 40 00
SECTION 09 72 00

CODE	MFTR / CO	PRODUCT	SIZE	GENERAL ROOM / AREA
STN-1	Ceasarstone Joan Lyon 514.389.2999	Classico 5000 London Grey		Concierge Desk
STN-2	Ceasarstone Joan Lyon 514.389.2999	Classico 4230 Shitake		Office, Multipurpose

H CABINETS HARDWARE = HD-(NO.)

SECTION 08 07 05

CODE	MFTR / CO	PRODUCT	GENERAL LOCATION
HD01	Hafele Cabinet pull	Aluminum Handles Silver Coloured Anodized 116.05.931 128mm	Typical unless noted
HD02	Deleted		
HD03	Hafele Coat Hook	Anodized aluminium, silver 842.20.959 Or approved equal.	Family Change B/F W/C
HD04	Deleted		
HD05	Hafele Metal Shelf Supports	Steel, nickel plated 282.43.727	Millwork
HD06	Hafele Cable Grommets	Push and Pinch Grommet Grey, 80cm 631.21.510	Reception, Lifeguard Station
HD07	Hafele Cable Grommets	Flexi-Top Grommets Silver, 80cm 631.43.902	Reception

END SECTION

6	RE-ISSUED FOR PAINTING	20190208	DV
5	RE-ISSUED FOR CONSTRUCTION	20180514	DV
4	ISSUED FOR CONSTRUCTION	20171003	DV
3	ISSUED FOR INFORMATION (RFP001)	20170810	DV
2	ISSUED FOR PERMIT	20170725	DV
1	ISSUED FOR INFORMATION	20170623	DV

DESIGNED BY / CONÇU PAR	CHECKED BY / VÉRIFIÉ PAR
DATE / DATE	DATE / DATE
SCALE / ÉCHELLE	SCALE / ÉCHELLE

1	DETAIL NUMBER	DRAWING TITLE
1.1	SCALE	SCALE
1	SHEET NUMBER	SHEET NUMBER

THIS DRAWING IS THE PROPERTY OF THE CITY OF OTTAWA AND ALL COPYRIGHT IS RESERVED. DIMENSIONS ON DRAWING ARE FOR ESTIMATING PURPOSES ONLY. IT IS THE RESPONSIBILITY OF EACH CONTRACTOR AND SUB-CONTRACTOR OR CONSULTANT TO CHECK AND VERIFY ALL DIMENSIONS AND CONDITIONS ON SITE. NOTIFY OWNER OF ANY ERRORS OR OMISSIONS PRIOR TO COMMENCING THE WORK. DO NOT SCALE THE DRAWINGS.

CE Dessin constitue la propriété de la Ville d'Ottawa et tout droit d'auteur est réservé. Les dimensions utilisées se sont à des fins d'estimation seulement. Il incombe à chaque entrepreneur, sous-contractant ou consultant de vérifier toutes les dimensions et les conditions sur le chantier. Veuillez informer le propriétaire de toute erreur ou omission avant d'entamer les travaux. Ne dressez pas les plans à l'échelle.

ARCHITECT / ARCHITECTE	CONSULTANT / EXPERT-CONSEIL
------------------------	-----------------------------

CONSULTANT / EXPERT-CONSEIL	CONSULTANT / EXPERT-CONSEIL
-----------------------------	-----------------------------

PROJECT / LOCATION / PROJET / ENDROIT	DOVERCOURT PHASE 2 ADDITION & RENOVATION
FACILITY NO. / NO. DE INSTALLATIONS	411 DOVERCOURT OTTAWA, ONTARIO
DRAWING / DESSIN	FINISHES PLAN GROUND FLOOR

FACILITY NO. / NO. DE INSTALLATIONS	SHEET NO. / FEUILLE No.
PROJECT NO. / PROJET No.	A8.01
	1713

GENERAL NOTES:

1. WALLS ARE PTI UNLESS OTHERWISE NOTED. REFER TO FINISHES SCHEDULE FOR ADDITIONAL INFORMATION
2. FOR INTERIOR FINISHES, THIS DRAWING IS TO BE READ IN CONJUNCTION WITH FINISHES LEGEND, ROOM FINISH SCHEDULE 04-00-01
3. GC TO SUPPLY AND INSTALL SCHLUTER METAL TRIM AT ALL CHANGES IN FLOOR MATERIAL AS REQ'D.
4. TRANSITION OF FLOOR MATERIAL TO BE INSTALLED ON CENTER OF DOOR LEAF
5. CONTRACTOR TO ENSURE ALL FINISHES ARE APPLIED TO CLEAN, PRIMED SURFACES. CONTRACTOR RESPONSIBLE TO ENSURE ALL MATERIALS USED ARE FREE OF DEFECTS.
6. ALL 6MM CEILINGS ARE PTI UNLESS OTHERWISE NOTED. REFER TO CEILING PLANS & FINISHES SCHEDULE FOR CEILING FINISHES & TYPES
7. FOR DOOR AND FRAMES FINISHES REFER TO DOOR SCHEDULE
8. GROUT LINES ARE 3mm WIDE ON FLOORS AND WALLS UNLESS OTHERWISE NOTED
9. REPORT ANY DISCREPANCIES TO ARCHITECT. CONTRACTOR TO BUDGET THE GREATER SUM ITEM UNTIL CLARIFIED BY ARCHITECT
10. FEATHER UP FLOOR UNDER THINNER MATERIAL FOR SMOOTH / LEVEL TRANSITION BETWEEN DIFFERENT FLOOR MATERIALS
11. FLOOR INSTALLATIONS NOTED AS TILE WIDTH ARE FULL TILE WIDTH. MUST CONFIRM MATERIAL LOCATION PRIOR TO IMPLEMENTING. DIMENSIONS ARE ROUNDED TO THE NEAREST DENOMINATOR BUT ARE INTENDED AS FULL TILE DIMENSION.
12. ALL FURNITURE, KITCHEN APPLIANCES, OFFICE EQUIPMENT & SYSTEMS ARE TO BE SUPPLIED BY OWNER AND ARE NOT IN CONTRACT UNLESS OTHERWISE SPECIFIED. SIZES FOR CLEARANCE MUST BE VERIFIED ON SITE PRIOR TO IMPLEMENTING FOR MILLWORK & ALCOVES.
13. ALL RUBBERBASE TO BE TOE-LESS.
14. ALL ELECTRICAL COVER PLATES/SWITCHES TO BE STAINLESS STEEL & ALIGN WITH TILE EDGE TO AVOID EXCESS CUTTING/PATCHING OF TILES.
15. FLOOR FINISHES TO BE INSTALLED PRIOR TO INSTALLATION OF DEMOUNTABLE PARTITIONS.
16. PROTECT ALL FINISHED SURFACES, FLOORING, WALLS, GLAZING & MILLWORK UNTIL WORK IS COMPLETE. REPAIR IF REQUIRED.
17. CONTRACTOR TO PROVIDE ONE UNOPENED BOX OF SPARES OF EACH COLOR & TYPE FLOORING MATERIAL, WALL TILES & CEILING TILES USED & HANDOVER TO CLIENT FOR INVENTORY.

FINISH LEGEND:

- PAINTED CONCRETE
- CARPET TILE
- CERAMIC TILE USE APPROPRIATE METAL TRIM TO SUIT TRANSITION OF MATERIAL AND EDGES OUTSIDE CORNERS
- 100mm BASE TILE w/SCHLUTER RENO-U TRIM
- PAINT FINISH ON WALL FROM CORNER TO CORNER. ADDITIONAL CLARIFICATION OF PAINT TYPE/LOCATION PER DWS.
- 100mm RUBBER BASE
- STONE MATERIAL
- SOLID SURFACE MATERIAL HARDWOOD - SEE FINISHES LEGEND FOR SPECIES
- SPRUNG WOOD FLOOR SYSTEM
- VENTED RUBBER BASE W/ - SEE DETAIL 2/A8.01
- VT: VINYL COMPOSITE TILE
- CAR-II: CARPET TILE
- CT I: CERAMIC FLOORING TILE
- CT 6: CERAMIC FLOORING TILE
- WF I: SPRUNG HARDWOOD FLOOR SYSTEM

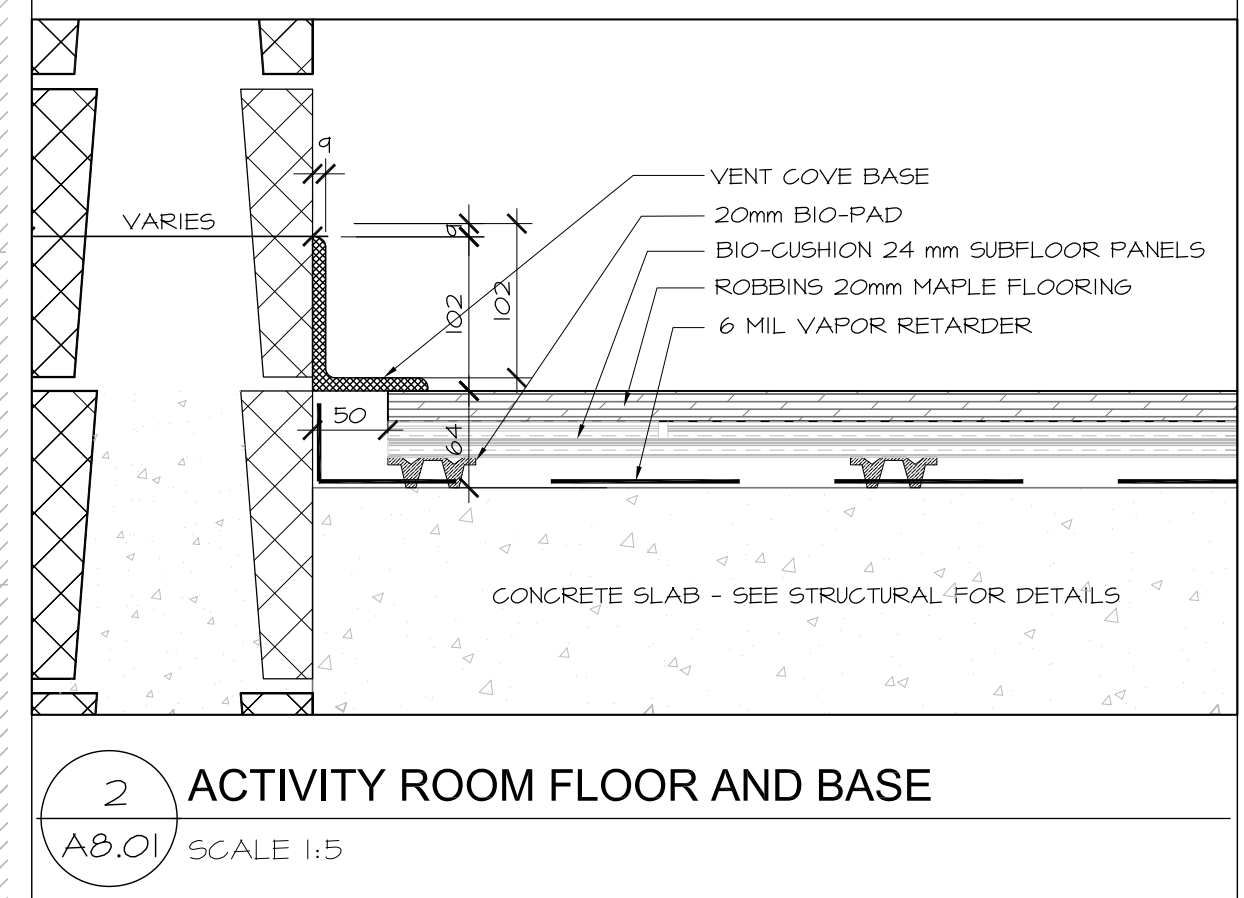

2 ACTIVITY ROOM FLOOR AND BASE
A8.01 SCALE 1:5

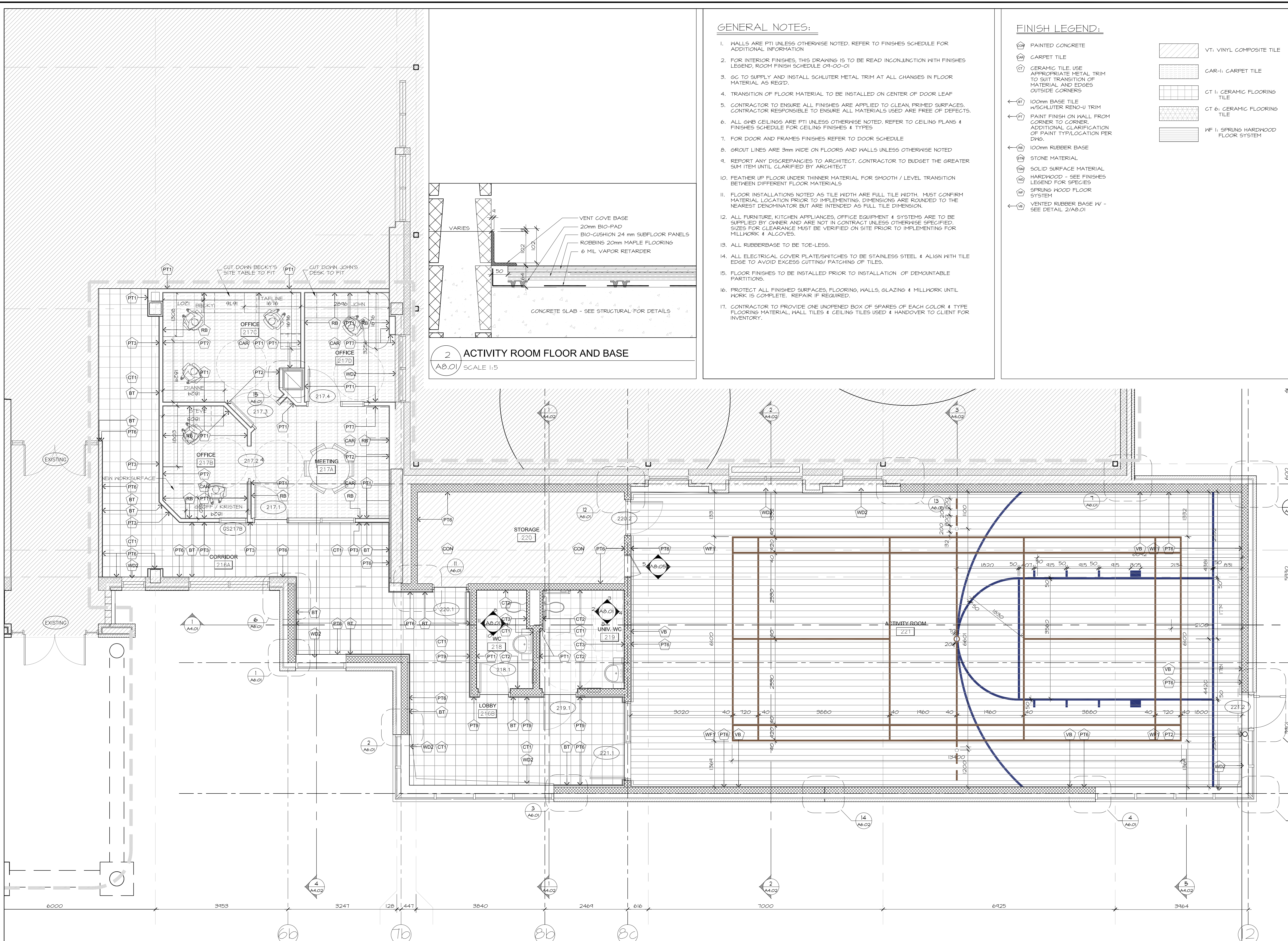

1 GROUND FLOOR FINISHES PLAN
A8.01 SCALE 1:50

Project: DOWNTOWN PAINT COLOURS

Date:

Meeting Location:

Project No:

Item

Comment

Action By

PT-1
CLOUD WHITE

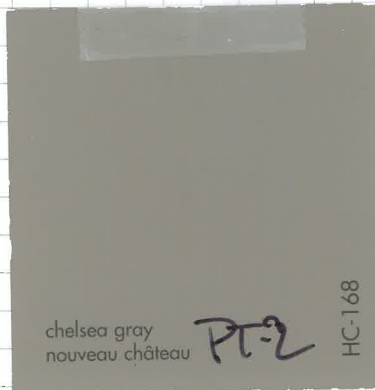

CHELSEA GREY



BIG COUNTRY BLUE



VAN CONTRACT BLUE

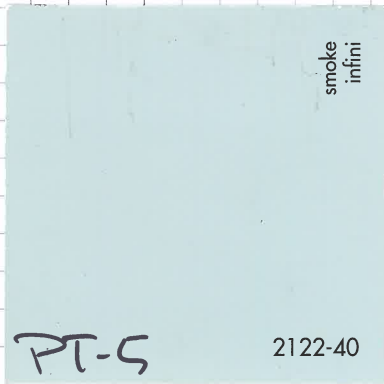

Benjamin Moore
SMOKE
2122

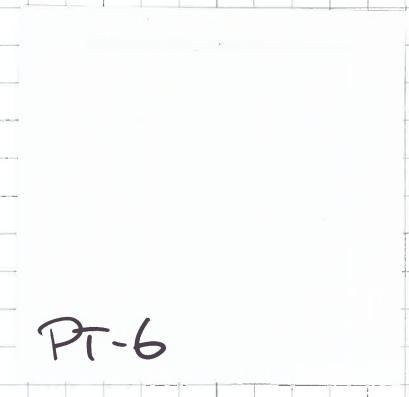

INTENSE WHITE



PT-7
purple lotus
pourpre lotus



ADMIRAL BLUE



PT-9
lemon
citronnier