

1 UPPER TERRACE – EXISTING CONDITIONS

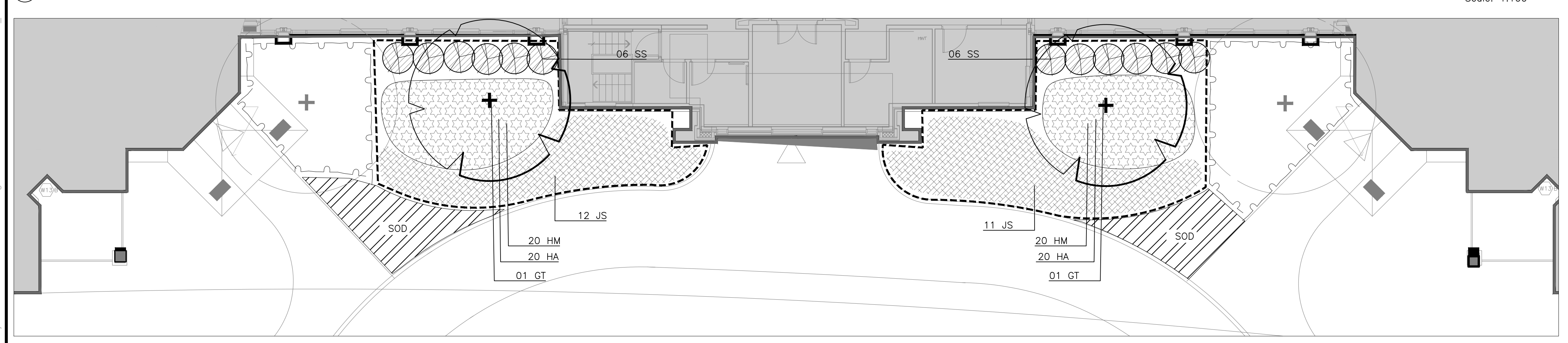

2 GROUND LEVEL – EXISTING CONDITIONS

Code	Qty.	Botanical Name	Common Name	Size	Remarks
GROUND FLOOR					
GT	2	Gleditsia triacanthos "Shademaster"	Shademaster Honeylocust	70mm cal	B&B staked
SHRUBS					
JS	23	Juniperus sabina "Calgary Carpet"	Calgary Carpet Juniper	500mm spd.	Potted
SS	12	Sorbaria sorbifolia	False Spirea	500mm ht.	Potted
PERENNIALS					
HM	40	Hemerocallis "Miniature King"	Miniature King Daylily	#1 container, heavy 2 fan division	
HW	40	Hemerocallis "Little Wine Cup"	Little Wine Cup Daylily	#1 container, heavy 2 fan division	
ROOF DECK					
SHRUBS					
BM	3	Buxus microphylla "Little Gem"	Boxwood	450mm height	Potted
CW	1	Caragana arborescens "Walker"	Weeping Peashrub	1500mm height	Potted
CC	1	Cotinus coggygria	Smoke Bush	900mm height	Potted
EF	5	Euonymus fortunei "Emerald Gaiety"	Winter Creeper	450mm height	Potted
HP	19	Hydrangea paniculata "Little Lime"	Little Lime Hydrangea	450mm height	Potted
JS	14	Juniperus sabina "Calgary Carpet"	Calgary Carpet Juniper	450mm spread	Potted
JsM	12	Juniperus scopulorum "Moffetii"	Moffat Blue Juniper	1800mm height	Potted
PF	7	Potentilla fruticosa "Abbotswood"	Abbotswood Potentilla	450mm height	Potted
RL	1	Rhododendron "Lemon Lights"	Lemon Lights Azalea	600mm height	Potted
RC	3	Rosa "Champlain"	Champlain Rose	450mm height	Potted
SbT	5	Spiraea betulifolia "Tor"	Tor Spirea	450mm height	Potted
SbG	25	Spiraea bumalda "Goldflame"	Goldflame Spirea	450mm height	Potted
SP	5	Sayruga pubescens subsp. "Miss Kim"	Miss Kim Lilac	450mm height	Potted
TO	21	Thuja occidentalis "Emerald"	Emerald Cedar	1500mm height	Potted
WF	19	Weigela florida "Minuet"	Minuet Weigela	450mm height	Potted
PERENNIALS					
EP	20	Echinacea purpurea "Pow Wow"	Pow Wow Coneflower	#1 container	
GM	35	Geranium Macrorrhizum	Cranesbill Geranium	#1 container	
HA	15	Hemerocallis "Autumn Red"	Autumn Red Daylily	#1 container, heavy 2 fan division	
HM	32	Hemerocallis "Miniature King"	Miniature King Daylily	#1 container, heavy 2 fan division	
HW	50	Hemerocallis "Little Wine Cup"	Little Wine Cup Daylily	#1 container, heavy 2 fan division	
Hgm	143	Hosta "Ground Master"	Ground Master Hosta	#1 container	
Hkr	45	Hosta "Krossa Regal"	Krossa Regal Hosta	#1 container	
Hrs	94	Hosta "Royal Standard"	Royal Standard Hosta	#1 container	
Is	31	Iris sibirica	Siberian Iris	#1 container	
La	12	Lavandula angustifolia "Munstead"	Lavender	#1 container	
SsA	21	Sedum spectabile "Autumn Joy"	Autumn Joy Sedum	#1 container	
SF	88	Sedum spurius "Fuldaglut"	Fulda Glow Sedum	#1 container	
VM	65	Vinca minor	Periwinkle	#1 container	
YF	6	Yucca filamentosa	Yucca	#2 container	
GRASSES					
Fs	40	Festuca "Skinner's Blue"	Skinner Blue Fescue	#1 container	
Ca	25	Calamagrostis acutiflora "Karl Foerster"	Forester's Reed Grass	#1 container	

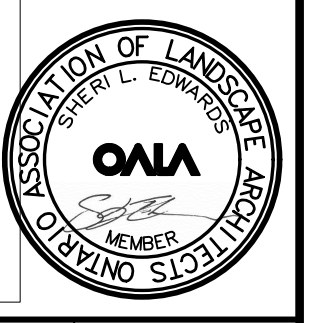

EXISTING

- Existing Conifer to be retained
- Existing planting bed / shrubs to be retained (weed and improve soils as per specifications)

PAVING

- Proposed Unit Paving–Type 1
- Proposed Unit Paving–Type 2 (Paving Bands)
- Salvaged Unit Paving
- Existing pea gravel area–clear debris, weed and top up pea gravel as required to provide 50mm depth

PLANTING

- Proposed Topsoil and Sod
- Proposed Conifer
- Proposed Perennial / Shrub Planting
- Existing area drain to retain and protect
- New area drain (existing area drain location)

2	ISSUED FOR TENDER	08/03/2019
1	ISSUED FOR REVIEW	17/12/2018
No.	Revision	Date

CSW Landscape Architecture
Urban Design
Site Planning
Recreation and Park Planning
Project Management

319 McRae Avenue, Suite 502, Ottawa, Ontario, K1Z 0B9
Tel: (613) 729-4536

- All measurements in millimeters unless specified otherwise. Do not scale drawing. All drawings to be read in conjunction with written specifications.
- Copyright reserved. This drawing is the exclusive property of CSW Landscape Architects Ltd. and shall not be used without the consent thereof.
- This Drawing may not be used for construction until signed by the landscape architect. It is the responsibility of the contractor to:
 - check and verify all dimensions on site;
 - report all errors and/or omissions to the landscape architect;
 - comply with all pertinent codes and by-laws;
 - check and verify locations of all underground services with all local utilities prior to any digging.

Project:

MERIDIAN AT CENTREPOINTE

NEPEAN, OTTAWA, ONTARIO

Drawing:

LANDSCAPE PLAN OPTION 01 (as existing)

Scale:	1:100	Date:	JANUARY 2019
Design By:	SE	Drawn By:	SE
Project Number:	2005-01	Sheet Number:	L 2.0

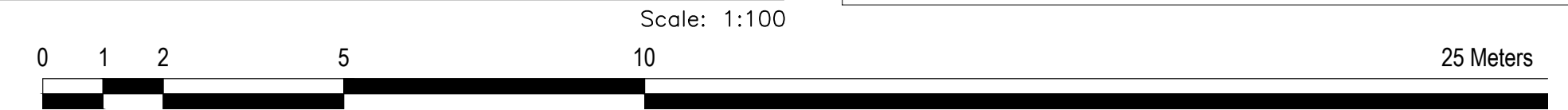

Last Save: 2/13/2019 9:56:49 AM
 File Location: C:\Projects\2005-01 The Meridian\Drawings\TENDER\DOCS\2005-01 The Meridian_Landscape Plan_L2_0_Option 1_Replace As Existing.dwg

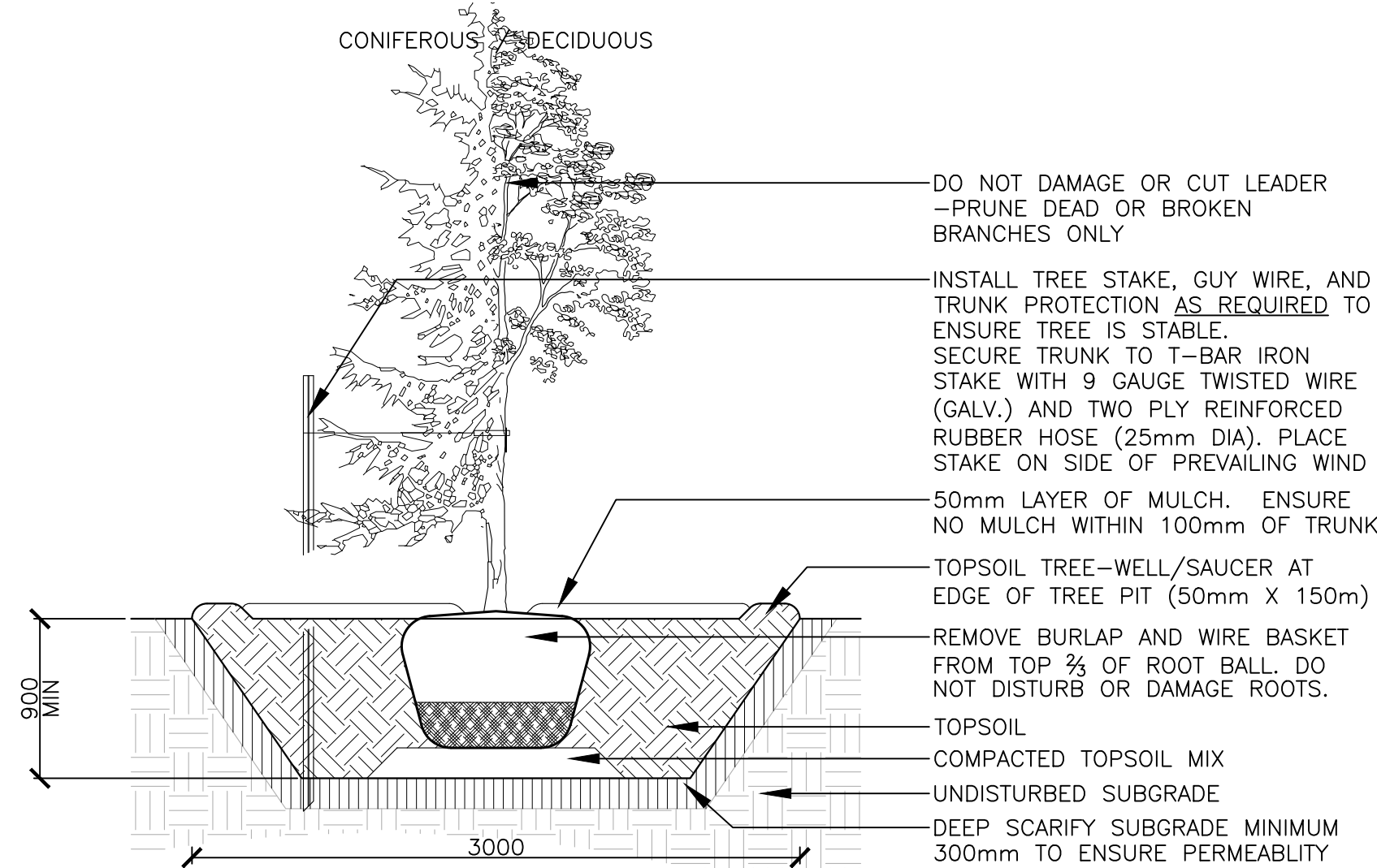

- NOTES:
- TREE STAKES ARE GENERALLY ARE TO BE USED FOR CONDITIONS WHERE THE INSTALLED TREE IS UNSTABLE AND/OR BECOMES UNSTABLE
 - ALLOW 10mm TO 25mm SLACK ON GUY WIRE SUPPORT FOR TREE
 - TOP OF ROOT BALL TO RETAIN SAME ELEVATION AS GROWING CONDITIONS
 - REMOVE STAKES ONE YEAR AFTER INSTALL
 - INSTALL STAKE BEYOND EDGE OF ROOT BALL

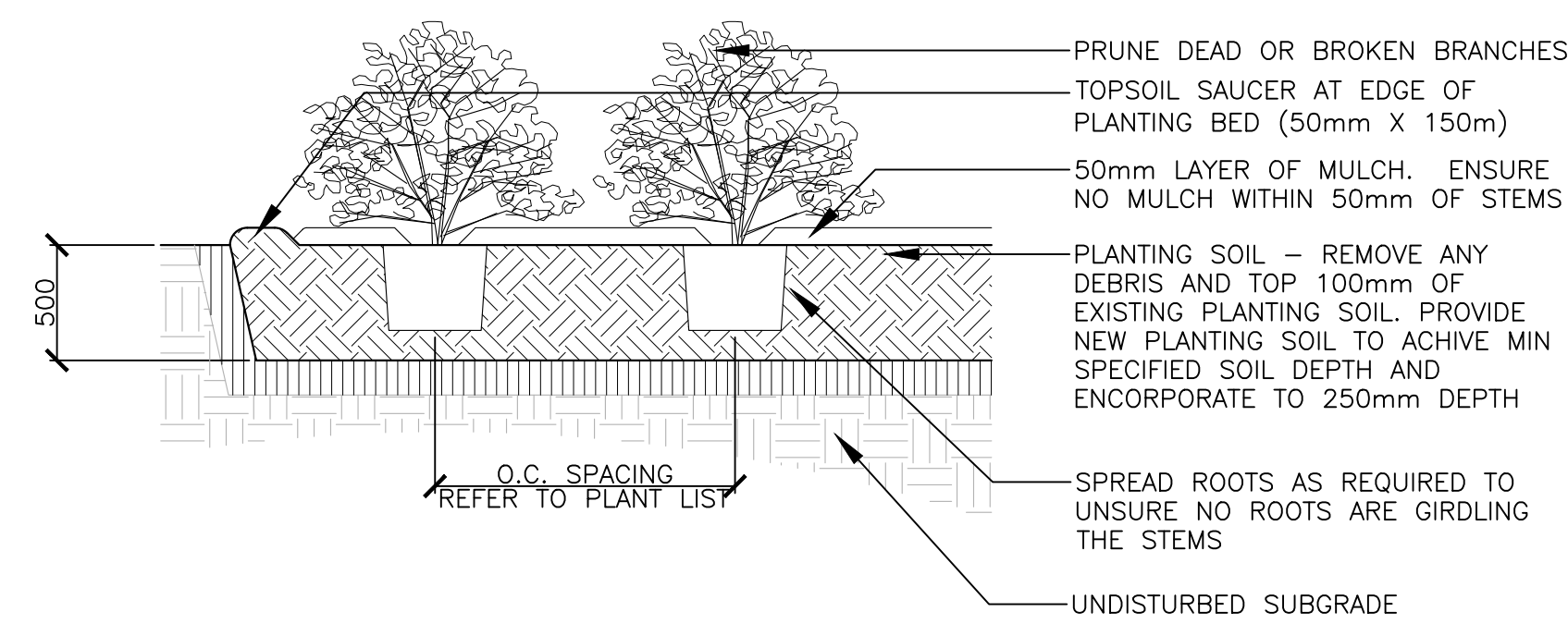

- NOTES:
- TOP OF ROOT BALL TO RETAIN SAME ELEVATION AS GROWING CONDITIONS

1 GROUND LEVEL PLANTING DETAILS Scale: NTS

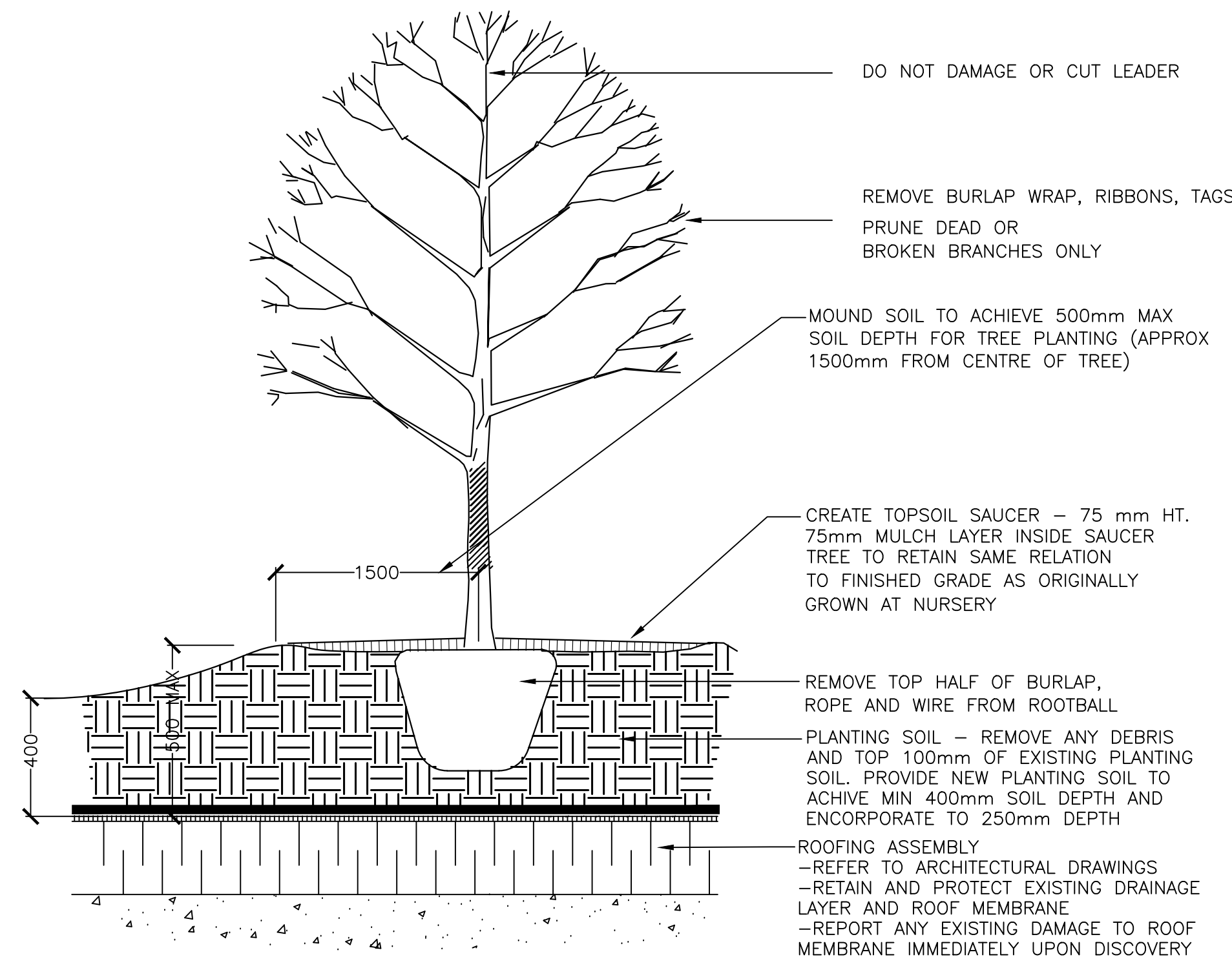

SMALL DECIDUOUS TREE PLANTING

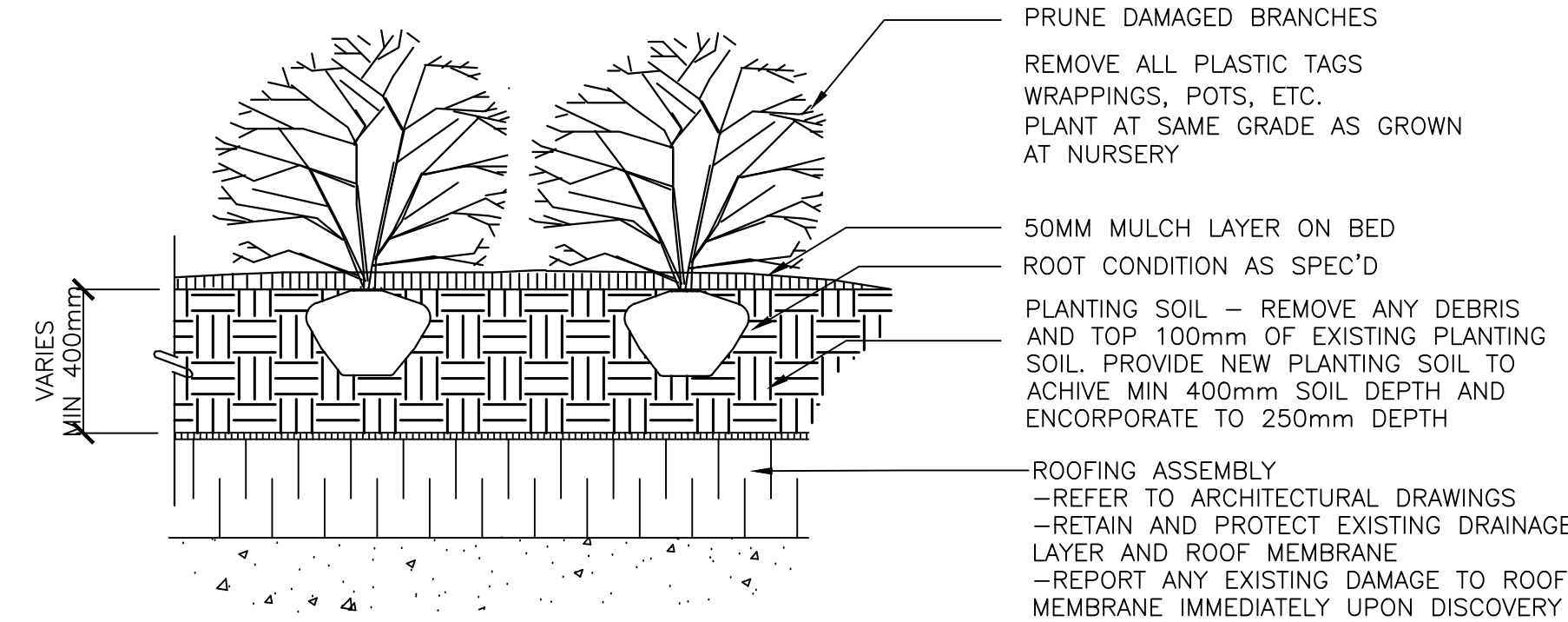

PERENNIAL / SHRUB PLANTING

2 TERRACE LEVEL PLANTING DETAILS Scale: NTS

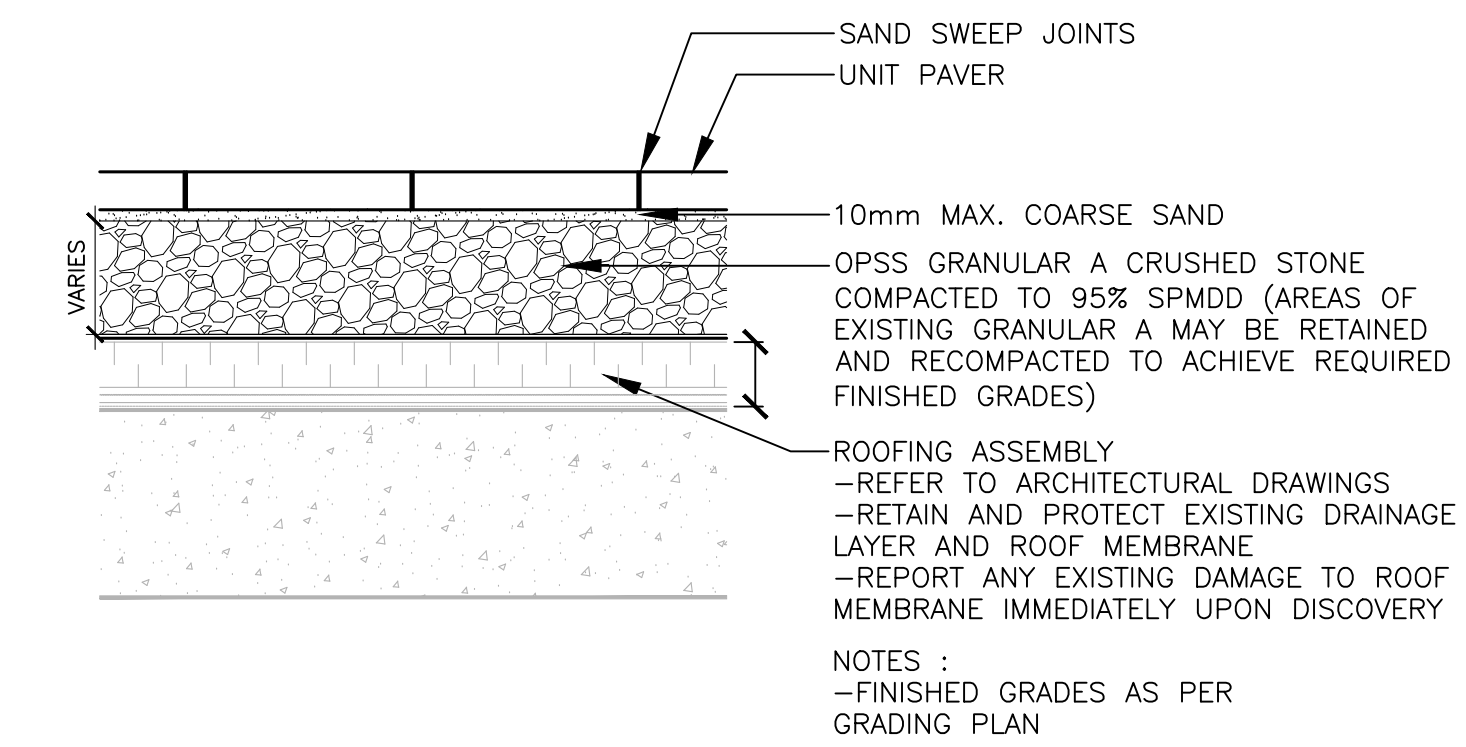

3 TERRACE LEVEL - UNIT PAVING Scale: 1:10

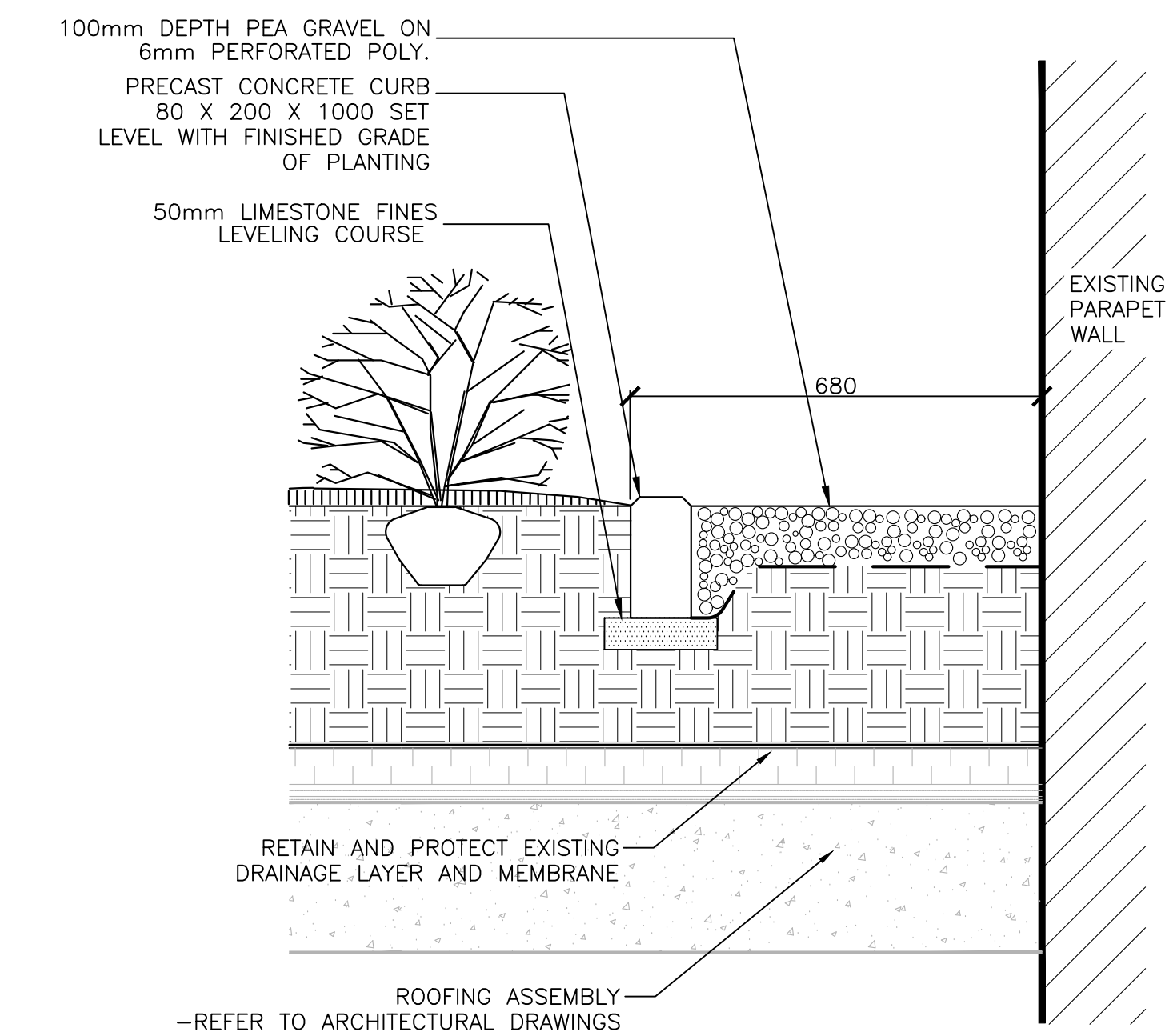

4 TERRACE LEVEL - MAINTENANCE EDGE Scale: 1:10

Key Plan		
2	ISSUED FOR TENDER	08/03/2019
1	ISSUED FOR REVIEW	08/02/2019
No.	Revision	Date

North:	Stamp:

CSW Landscape Architecture
 Urban Design
 Site Planning
 Recreation and Park Planning
 Project Management

319 McRae Avenue, Suite 502, Ottawa, Ontario, K1Z 0B9
 Tel: (613) 729-4536

- All measurements in millimeters unless specified otherwise. Do not scale drawing. All drawings to be read in conjunction with written specifications.
- Copyright reserved. This drawing is the exclusive property of CSW Landscape Architects Ltd. and shall not be used without the consent thereof.
- This Drawing may not be used for construction until signed by the landscape architect. It is the responsibility of the contractor to:
 - check and verify all dimensions on site;
 - report all errors and/or omissions to the landscape architect;
 - comply with all pertinent codes and by-laws;
 - check and verify locations of all underground services with all local utilities prior to any digging.

Project:
MERIDIAN AT CENTREPOINTE
 NEPEAN, OTTAWA, ONTARIO

Drawing:
LANDSCAPE DETAILS

Scale: 1:100	Date: JANUARY 2019
Design By: SE	Drawn By: SE
Project Number: 2005-01	Sheet Number: L 4.0



Label Save: 3/8/2019 2:12:15 PM
 File Location: C:\Projects\2005-01 The Meridian\Drawings\TENDER DOC\2005-01 The Meridian_Landscape_Details.dwg