



The following information supplements and/or supersedes the bid documents.

This addendum forms part of the contract documents and is to be read, interpreted, and coordinated with all other parts. The cost of all contained herein is to be included in the contract sum. The following revisions supplements and/or supercede the information contained in the original drawings and specifications issued for the above-named project to the extent referenced and shall become part thereof.

Partners

Barry J. Hobin
OAA, FRAIC, Hon. Fellow AIA

William A. Davis
OAA, MRAIC, Associate AIA

Gordon Lorimer
OAA, FRAIC, Associate AIA

Wendy Brawley
OAA, MRAIC, Associate AIA

Douglas Brooks
Senior Arch. Tech.

Associates

Bryan Bonell
OAA, MRAIC, Associate AIA

Marc Thivierge
OAA, MRAIC

William Ritcey
MRAIC

Reinhard Vogel
Senior Arch. Tech.

**Hobin Architecture
Incorporated**

63 Pamilla Street
Ottawa, Ontario
Canada K1S 3K7

t 613-238-7200
f 613-235-2005

hobinarc.com

Item No.	Drawing or Spec Section	Description
Specifications		
A1.1.1	08 71 00	<p>Add:</p> <p>1 SGLE DOOR 109.3 FITNESS 109 FROM POCKET DOOR CLOSET LHR 382 x 2750 x 45 SCWD/WF TYPE B/9</p> <hr/> <p>4 EA HINGE 1279.114 x 101mm 646 1 EA TURNBOLT B580 619 1 EA FLUSH PULL H403 646</p> <hr/> <p>1 SGLE DOOR 114.3 CRAFTS/HOBBY 114 FROM POCKET DOOR CLOSET 340 x 2750 x 45 SCWD/WF RHR TYPE B/9</p> <hr/> <p>4 EA HINGE 1279.114 x 101mm 646 1 EA TURNBOLT B580 619 1 EA FLUSH PULL H403 646</p>
A1.1.2	09 21 16	<p>Add: Sentence 2.1.22 as follows: .22 Reveal molding adjacent to wood door frames at pockets for accordion partitons: "Z" Reveal Molding DRMZ-50-50 by Fry Reglet Corporation.</p>
Drawings		
A1.2.1	A2.02	<p>ADD: Door 109.3 at the pocket for the accordion door in Fitness Room 109. Refer to attached sketch ADD-A01.1. ADD: Door 114.3 at the pocket for the accordion door in Crafts/Hobby 114. Refer to attached sketch ADD-A01.1.</p>
A1.2.2	A2.03	<p>ADD: Wall Type 20 as follows: SHAFT WALL ULI U469 - 1HR (ULC W508 SIMILAR) BOARD & PANELS AS PER ULC GUIDE NO. 40 U8.23 16mm TYPE C GYPSUM BOARD 25mm GYPSUM LINER/PANEL SET BETWEEN 64MM C-H STUDS @ 600 o/c AT HORIZ. SHAFT WALL ADD AN ADDITIONAL LAYER OF 16mm GYPSUM BOARD (FIRE-RATED)</p>
A1.2.3	A2.05	<p>REVISE: Ceiling height of bulkheads in Fitness 109, Common Room 111 and Crafts/Hobby 114 from 2970mm as shown on drawing A2.05 to 2750mm as shown in the Finish Schedule on drawing A9.01.</p>

A1.2.4	A2.05	ADD: Horizontal shaft wall ceiling (Wall Type 20) throughout Stair 101, below the sheathing at the underside of the roof trusses. Mount ceiling as high as possible.
A1.2.5	A9.01	ADD: Doors 109.3 and 114.3 to the Door Schedule – refer to attached sketch ADD-A01.1.
A1.2.6	A9.01	ADD: Door Jamb Type 9 – Refer to attached sketch ADD-A01.1.

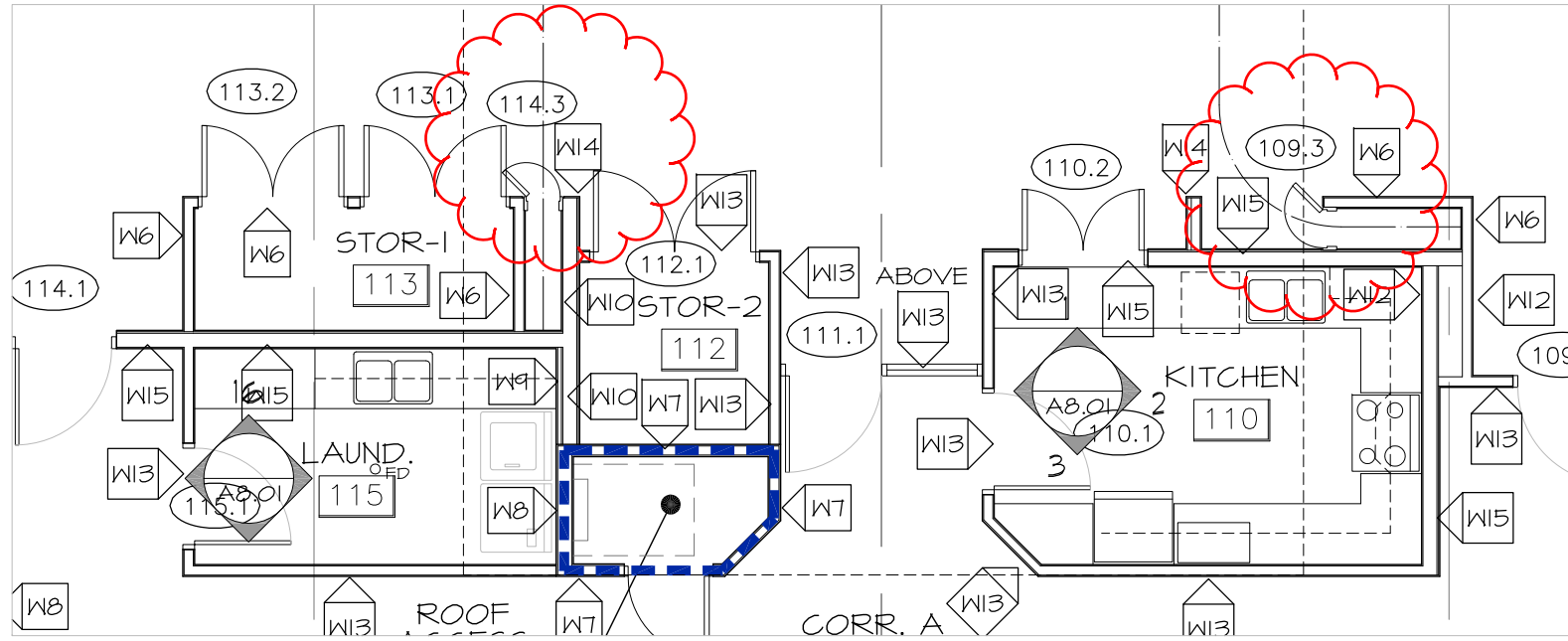

PARTIAL GROUND FLOOR

SCALE 1 : 75

JAMB DETAIL 9

SCALE: NTS

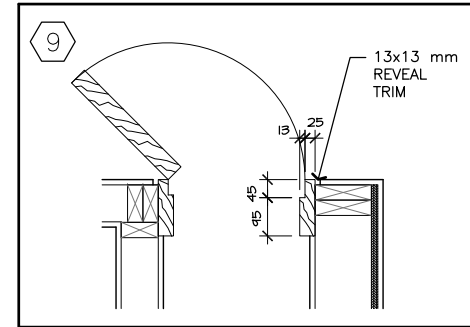

NO.	ROOM	SIZE	MATERIALS	STY	FINISH	F.R.	FRAME	TYP.	FINISH	F.R.	REMARKS
109.3	FITNESS 109	382 X 2750 X 45	SOLID CORE WOOD	B	PAINT	-	WOOD	9	PAINT	-	170 DEG. OPENING ACCORDION PARTITION POCKET DOOR
114.3	CRAFTS/HOBBY 114	340 X 2750 X 45	SOLID CORE WOOD	B	PAINT	-	WOOD	9	PAINT	-	170 DEG. OPENING ACCORDION PARTITION POCKET DOOR

PARTIAL DOOR SCHEDULE

SCALE: NTS