

REVIEWED   
 NOT REVIEWED   
 AMEND AS NOTED   
 REVISE & RESUBMIT

DATE 10 JULY 2019

Review indicates general conformance with structural requirements only

GOODEVE STRUCTURAL INC.  
 18-77 Auriga Dr.  
 Ottawa ON K2E 7Z7  
 613-226-4555

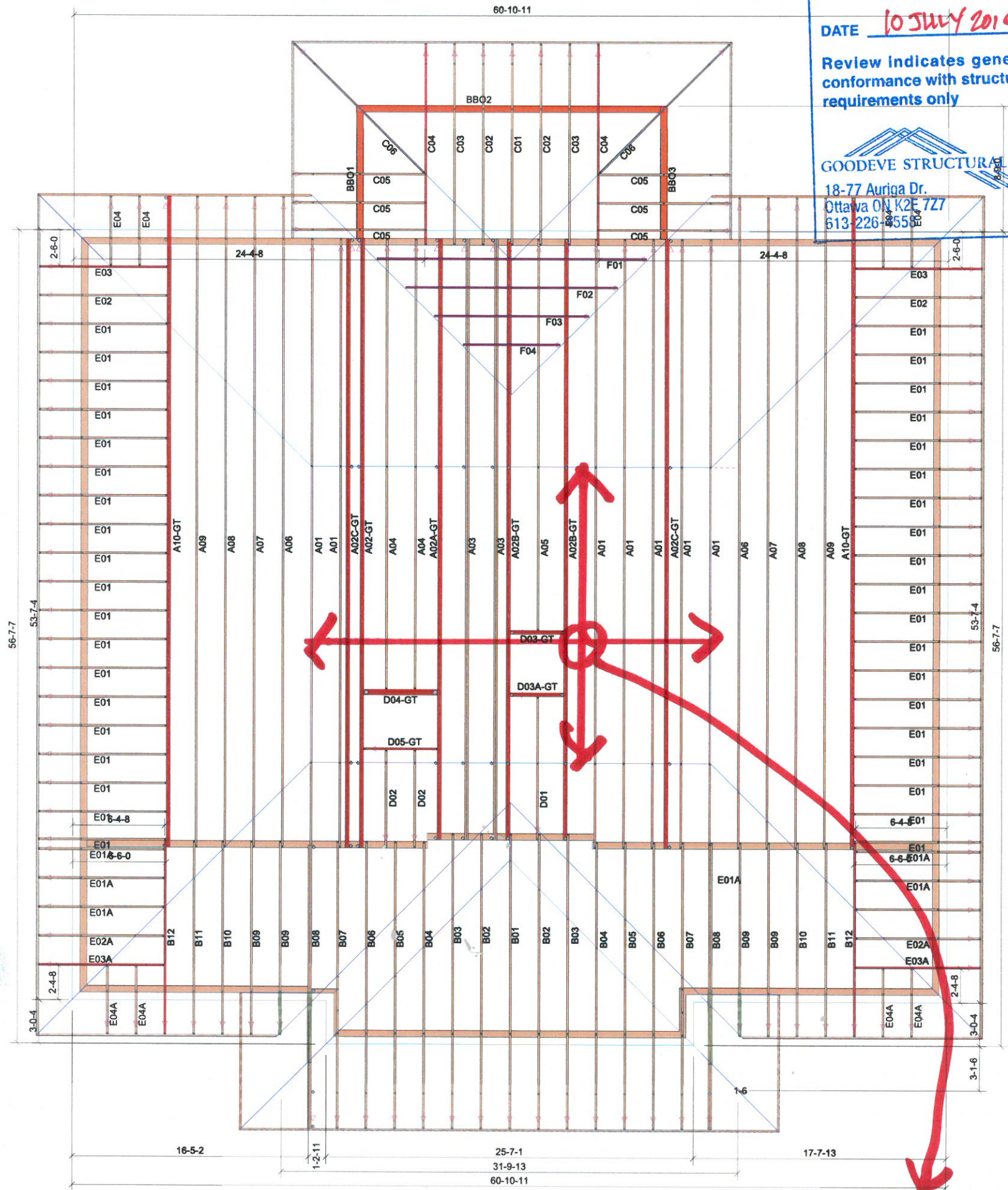

**HANGER SCHEDULE**  
 LUS24..... C05,E01-E04(70)  
 LJS26DS.... D01,D02,D05-GT(5)  
 HGUS28..... A04,A05(3)  
 HGUS26-2.. D03-GT,D03A-GT(4)  
 TJC57..... C06(2)  
 HGUS28-3... D04-GT(2)  
 H2.5A..... A02B-GT,A02C-GT,A03-A05,B01,B02,B04,B05,B06,B09-B11,C01-C03,C05,D01,D02,E01-E04(174)  
 2x H2.5A.... A02-GT,A02A-GT,A06-A09,B03,B07,B08,B12,C04,C06(80)  
 LGT3-SDS... A10-GT(4)  
 SBP6x2..... A01,A02-GT,A02A-GT,A02B-GT(36)

Additional 15psf DL and 80psf SL added to the flat roof area to accommodate additional building materials and accumulated snow load.

Flat Roof Area Loading	
Top chord LL	- 129.9 psf
Top chord DL	- 20 psf
Bottom chord LL	- 10 psf
Bottom chord DL	- 7 psf
<b>Total Load</b>	<b>- 166.9 psf</b>

Roof Area = 5093.23

**REVIEWED**  
 By Farah Bano at 12:50 pm, Jul 10, 2019

LOADING ON TRUSS  
 DETAIL DRAWINGS  
 DO NOT INDICATE THIS  
 LOADING -  
 CONFIRM THIS IS THE  
 LOADING USED IN  
 DESIGN

**LEGEND**  
 ◀ Left end truss/joint  
 ▬ RIM/Beam/Blocking  
 ▬ Girder  
 ▬ Gable/Valley  
 ▬ Ceiling Line  
 ▬ Roof Line  
 ▬ Post  
 ▬ Site framing

**TERRA NOVA TRUSS**  
**INI**  
 2602 Perth Road, Box 178  
 Glenburnie, ON K0H 1S0  
 Telephone: 613-546-5850  
 3009 CR-29  
 Brockville, ON, K6V 5T7  
 Telephone: 613-342-2388  
 www.terrannotruss.com  
 Floor and roof trusses, engineered wood products.  
 Residential, Commercial, and Agricultural

**Design Criteria**  
 Specified Loads - Ottawa, ON  
 Top Chord Live Load - 49.9 psf  
 Top Chord Dead Load - 5.0 psf  
 Bottom Chord Live Load - 10.0 psf  
 Bottom Chord Dead Load - 7.0 psf  
 Total Load - 71.9 psf  
 This design complies with:  
 -OBC 2012  
 -CSA 086.1  
 -ON regulation 350/06 as amended  
 -TPIC 2014  
 -Limited States Design (wood)  
 All roof trusses maximum 24" spacing unless noted on drawing. Total load deflection L/360  
 Refer to MITek Engineering Reference Sheet: MII-7473C  
 It is the responsibility of the owner, builder, contractor, or architect to verify all design criteria, dimensions and roof styles prior to production.

Client: Tai-Co Building Innovations Ltd.  
 Job Name: Communal Building Fire Reconstruction  
 Model:  
 Address: 1 - 3 Meridian Place  
 Ottawa, ON  
 Type: Roof  
 Date: 7/10/2019  
 Designer: Dustin Warren  
 Job: 1904-0607A  
 This drawing is not to scale  
**MITek**