

SUPPLEMENTAL INSTRUCTION



CONTRACTOR:
Tal-co Building Innovations Ltd.
Suite A, 4728 Bank Street
Ottawa, ON K1T 3W7

PROJ.: Meridian Community
Building Rebuild
PROJ. No.: 1841
DATE: July 3, 2019
S.I. No. S.I. – A004

Supplemental Instructions are issued only for the purpose of recording any clarification or interpretation of the contract documents or giving direction on problems resulting from field conditions. These instructions are subject to the provisions of the contract documents and unless stated herein and specifically co-authorized by the Client, will not affect the contract. Should the Contractor require a change in the contract price or project schedule, he shall submit to the Architect within ten (10) days of the date hereof, an itemized proposal. If the proposal is accepted by the Client, this Supplemental Instruction will be superseded by a Change order.

4.1 TITLE

Revised Casement Window Size – Windows W38, W38R, W39 & W39R

4.2 REFERENCE

A3.01 Elevations & Window Schedule
A3.02 Elevations

4.3 DESCRIPTION OF THE WORK

- .1 Increase the width of the casement operators on windows W38, W38R, W39 & W39R to +/- 610mm to allow for the installation of limiting hardware on the W38 and W38R windows on the west elevation of the links – see sketch below.

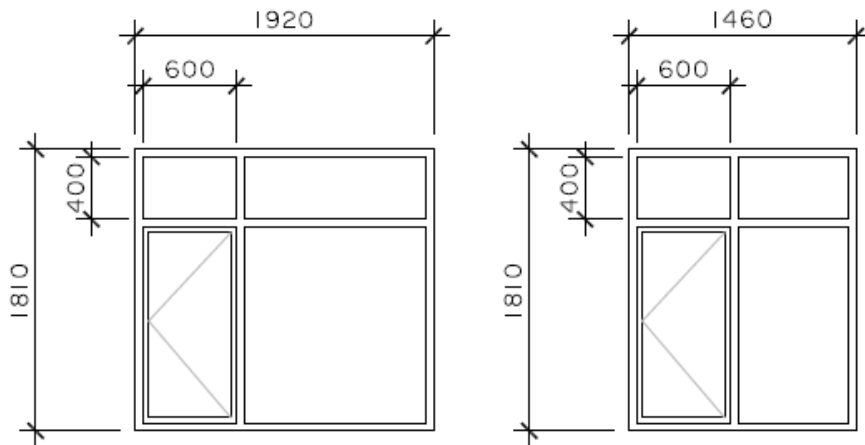

CLAD WOOD WINDOW
SOLAR REFLECTIVE GLASS
(SEE SPECIFICATION)



REVERSED



CLAD WOOD WINDOW
SOLAR REFLECTIVE GLASS
(SEE SPECIFICATION)



REVERSED

Partners

Barry J. Hobin
OAA, FRAIC, Hon. Fellow AIA

William A. Davis
OAA, MRAIC, Associate AIA

Gordon Lorimer
OAA, FRAIC, Associate AIA

Wendy Brawley
OAA, MRAIC, Associate AIA

Douglas Brooks
Senior Arch. Tech.

Directors

Marc Thivierge
OAA, MRAIC

Reinhard Vogel
Senior Arch. Tech.

Associates

Bryan Bonell
OAA, MRAIC, Associate AIA

William Ritcey
MRAIC

Dan Henhoeffler
Senior Arch. Tech.

Hobin Architecture Incorporated

63 Pamilla Street
Ottawa, Ontario
Canada K1S 3K7

t 613-238-7200
f 613-235-2005

hobinarc.com

Distribution:

- | | | | | |
|--|--|-------------------------------------|----------------------------------|--------------------------------------|
| <input checked="" type="checkbox"/> Owner | <input type="checkbox"/> City Authority | <input type="checkbox"/> Electrical | <input type="checkbox"/> Struct. | <input type="checkbox"/> Landscaping |
| <input checked="" type="checkbox"/> Contractor | <input checked="" type="checkbox"/> File | <input type="checkbox"/> Mech. | <input type="checkbox"/> Civil | <input type="checkbox"/> Other |

SUPPLEMENTAL INSTRUCTION

SI-A004

Project: Meridian Community Building Rebuild

Project No: 1841



4.4 ATTACHMENTS

N/A

4.5 REASON

Shop drawing coordination – to meet minimum size requirement for installation of limiting hardware on windows of alternate supplier.