

SUPPLEMENTAL INSTRUCTION



CONTRACTOR:
Tal-co Building Innovations Ltd.
Suite A, 4728 Bank Street
Ottawa, ON K1T 3W7

PROJ.: Meridian Community
Building Rebuild
PROJ. No.: 1841
DATE: Sept. 17, 2019
S.I. No. S.I. – A010

Supplemental Instructions are issued only for the purpose of recording any clarification or interpretation of the contract documents or giving direction on problems resulting from field conditions. These instructions are subject to the provisions of the contract documents and unless stated herein and specifically co-authorized by the Client, will not affect the contract. Should the Contractor require a change in the contract price or project schedule, he shall submit to the Architect within ten (10) days of the date hereof, an itemized proposal. If the proposal is accepted by the Client, this Supplemental Instruction will be superseded by a Change order.

10.1 TITLE

Interior Finishes

10.2 REFERENCE

Section 09 00 00 Room Finish Schedule Legend
Section 09 00 01 Room Finish / Colour Schedule

10.3 DESCRIPTION OF THE WORK

.1 Refer to attached Room Finish Schedule Legend and Room Finish / Colour Schedule for final colour selections for wall, floor and ceiling finishes.

.2 See sketch below for typical VCT tile pattern at links (Field VCT 1, Accents (toned tiles in sketch) VCT 2):

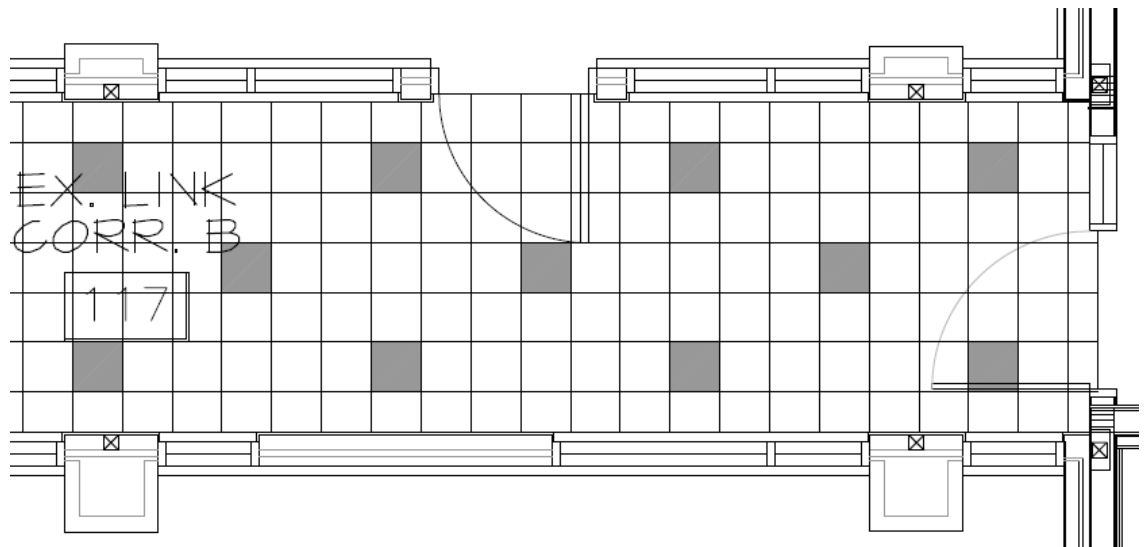

10.4 ATTACHMENTS

Section 09 00 00 Room Finish Schedule Legend
Section 09 00 01 Room Finish / Colour Schedule

10.5 REASON

Clarification.

Distribution:

- | | | | | |
|--|--|-------------------------------------|----------------------------------|--------------------------------------|
| <input checked="" type="checkbox"/> Owner | <input type="checkbox"/> City Authority | <input type="checkbox"/> Electrical | <input type="checkbox"/> Struct. | <input type="checkbox"/> Landscaping |
| <input checked="" type="checkbox"/> Contractor | <input checked="" type="checkbox"/> File | <input type="checkbox"/> Mech. | <input type="checkbox"/> Civil | <input type="checkbox"/> Other |

Partners

Barry J. Hobin
OAA, FRAIC, Hon. Fellow AIA

William A. Davis
OAA, MRAIC, Associate AIA

Gordon Lorimer
OAA, FRAIC, Associate AIA

Wendy Brawley
OAA, MRAIC, Associate AIA

Douglas Brooks
Senior Arch. Tech.

Directors

Marc Thivierge
OAA, MRAIC

Reinhard Vogel
Senior Arch. Tech.

Associates

Bryan Bonell
OAA, MRAIC, Associate AIA

William Ritcey
MRAIC

Dan Henhoeffler
Senior Arch. Tech.

Hobin Architecture
Incorporated

63 Pamilla Street
Ottawa, Ontario
Canada K1S 3K7

t 613-238-7200

f 613-235-2005

hobinarc.com

1.0 ROOM FINISH SCHEDULE INDEX

Room Finish Schedule 09 00 01

2.0 GENERAL NOTES

- .1 Ceiling heights given Above Finished Floor (AFF) unless noted otherwise.
- .2 All steel brackets and covers to be painted.
- .3 Heating units supplied primed for paint to be finished to match wall finish on which they occur.
- .4 Closets to have same finish as room in which they occur.
- .5 All exposed piping, ductwork, conduit and equipment outside of mechanical and electrical service rooms to be painted.
- .6 All gas piping (exposed and concealed) to be painted.
- .7 All surfaces visible through ceiling openings to be painted out. Refer to room schedule for same as wall colour or painted noted accent colour. To be confirmed.
- .8 All wood millwork such as handrails, wood ceiling panels are to be pre-finished by Section 06 40 00. All site applied finish carpentry to be stained unless otherwise noted. Refer to Section 09 91 23 for finishing formulas.
- .9 Paint all exposed steel supports, framing and connectors of millwork to match adjacent finish unless otherwise noted.
- .10 All mounting boards and backing furring/studs for electrical equipment to be painted with two coats of fire retardant paint.
- .11 Paint fire extinguisher cabinets to match adjacent wall colour unless stainless steel.
- .12 All steel stairs, railings, trim brackets, access ladders, manhole covers and sump pit covers to be painted
- .13 All discrepancies between documents and drawings are to be reported to the Architect.
- .14 Grout lines width are 3mm wide. Align grout lines with wall and floor grout lines.
- .15 Paint in Wet Areas to have anti-mildew additive. Rooms such as washrooms, kitchens and janitor rooms.

3.0 MATERIAL CODES

WALLS

BV	Brick Veneer
CONC	Reinforced Poured Concrete
Conc. Block	Concrete Block – see Section 04 22 00
Drywall	Gypsum Board – see Section 09 21 16
Paint	Precast Concrete – see Section 03 45 00
PT_	Paint finish – see Section 09 91 23

CEILINGS

Drywall	Gypsum Board – see Section 09 21 16
Paint_	Paint Finish – see Section 09 91 23
Lay-in-tile	Suspended Grid and Acoustical Ceiling Tile– see Sections 09 51 13 & 09 53 00

FLOORING

WL Wood Look Vinyl Tile Flooring – see specification 09 65 19
CPT Carpet – see specification 09 68 13
PT_ Paint finish – see Section 09 91 23
VCT_ Vinyl Composite Tile – See section 09 65 16

BASE

VB_ Resilient Base and Transitions – see Specification 09 65 16

MILLWORK

PL_ Plastic Laminate – see Specification 064000

4.0 INTERIOR FINISHES LEGEND

A VINYL COMPOSITE TILE = VCT (NO.)

SECTION 09 65 19

CODE	MFTR / CO	PRODUCT	SIZE	BASE MATCH	GENERAL ROOM / AREA
VCT 1	Tarkett VCT	Vinyl Composition Tile Colour: 1365 Dark Taupe	12" X 12"	Refer to Vinyl Floor Base (VB 1)	Stor -5, Water Closet, Jan/Stor, Stor -3, Kitchen, Laundry, Roof Access, Exit Link Corridor B, Exit Link Corridor C
VCT 2	Tarkett VCT	Vinyl Composition Tile Colour: 1824 Sand Castle	12 X 12"	Refer to Vinyl Floor Base (VB 1)	Accent - Exit Link Corridor B, Exit Link Corridor C

B VINYL FLOOR BASE = VB (NO.)

SECTION 09 65 19

NOTE: FLOOR BASE APPLY TO MILLWORK BASE UNLESS OTHERWISE NOTED

CODE	MFTR / CO	PRODUCT	PROFILE/SIZE	GENERAL ROOM / AREA
VB 1	ROPPE	Pinnacle Wall Rubber Base, Type TS – 1/8" Colour: Fig (125)	4" High Standard Toe	All rooms unless stated otherwise

C WOOD-LOOK VINYL TILE FLOORING = WL (NO.)

SECTION 09 64 29

CODE	MFTR / CO	COLOUR /PATTERN	GENERAL ROOM / AREA
WL 1	Tarkett	Ridge Oak 2505	Fitness, Common Room, Stor-2, Stor-1, Crafts/Hobby

D CARPET TILE = CPT (NO.)

SECTION 09 68 13

CODE	MFTR / CO	COLOUR /PATTERN	GENERAL ROOM / AREA
CPT 1	Tarkett	Storm 24106	Corridor A, Vestibule A&B, Library, Office

E INTERIOR PAINT = PT (NO.)

SECTION 09 91 23

CODE	MFTR / CO	COLOUR	GENERAL ROOM / AREA
PT 1	Dulux	Southern Breeze DLX1097 -2	All interior walls excluding accent walls (PT 2) and Fireplace
PT 2	Sherwin-Williams	Majolica Green SW 0013	Library, Office accent
PT 3	Dulux	Stonehenge Greige DLX1024-5	Fireplace surround
PT 4	Dulux	Patches DLX1024-6	Interior Doors
PT 5	Dulux	Commercial White DLX 1025-1	All door trims
PT 6	Benjamin Moore	Oxford White CC-30	All ceilings
PT7	Sherwin Williams	Armor Seal Floor-Plex 7100 Haze Grey	Exposed concrete floors

F HIGH PRESSURE LAMINATE = PL (NO.)

SECTION 06 20 00

CODE	MFTR / CO	PRODUCT	SIZE	GENERAL ROOM / AREA
PL 1	FORMICA	Colour: Earth Wash – Matte Finish (7213-58)		Kitchen & Laundry Counter
PL 2	FORMICA	Colour: Raw Birchply - Natural grain (8910 – NG)		Kitchen & Laundry Cabinets,
PL 3	FORMICA	Colour: Otter – Matte Finish (3202-58)		Fireplace Cabinet Face

END SECTION

Room No	Room Name	Floor		Base		Walls				CG	Door			Ceiling		Millwork				Remarks
		Field	Accent	Mat.'l	Ht.	Material / Colour					Number	Door Colour	Frame Colour	Mat.'l	Fin.	Shelf	Wind. Sill	Counter	Cabinets	
						North	East	South	West											
GROUND LEVEL																				
101	STAIR	PT 7	-	VB 1	4"	PT 1	PT 1	PT 1	PT 1		101.1	PT 4	PT 5	GYP	PT 6		PT5			
102	STOR-5	VCT 1	-	VB 1	4"	PT 1	PT 1	PT 1	PT 1		102.1	PT 4	PT 5	GYP	PT 6					
103	WATER CLOSET	VCT 1	-	VB 1	4"	PT 1	PT 1	PT 1	PT 1		103.1	PT 4	PT 5	GYP	PT 6		PT5			
104	CORRDIOR A	CPT 1	-	VB 1	4"	PT 1	PT 1	PT 1	PT 1			PT 4	PT 5	GYP	PT 6					
104A	VESTIBULE	CPT 1	-	VB 1	4"	PT 1	PT 1	PT 1	PT 1			PT 4	PT 5	GYP	PT 6					
104B	VESTIBULE	CPT 1	-	VB 1	4"	PT 1	PT 1	PT 1	PT 1			PT 4	PT 5	GYP	PT 6					
105	LIBRARY	CPT 1	-	VB 1	4"	PT 2	PT 1	PT 1	PT 1		105.1	PT 4	PT 5	GYP	PT 6		PT5			
106	JAN/STOR	PT 7	-	VB 1	4"	PT 1	PT 1	PT 1	PT 1		106.1	PT 4	PT 5	GYP	PT 6		PT5			
107	OFFICE	CPT 1	-	VB 1	4"	PT 1	PT 1	PT 1	PT 2		107.1	PT 4	PT 5	GYP	PT 6		PT5			
108	STOR-3	PT 7	-	VB 1	4"	PT 1	PT 1	PT 1	PT 1		108.1	PT 4	PT 5	GYP	PT 6					
109	FITNESS	WL 1	-	VB 1	4"	PT 1	PT 1	PT 1	PT 1		109.1	PT 4	PT 5	GYP	PT 6		PT5			
110	KITCHEN	VCT 1	-	VB 1	4"	PT 1	PT 1	PT 1	PT 1		110.1	PT 4	PT 5	GYP	PT 6			PL 1	PL 2	
111	COMMON ROOM	WL 1		VB 1	4"	PT 1	PT 1	PT 1	PT 1		111.1	PT 4	PT 5	GYP	PT 6		PT5		PL 3	PT 3 AT FIREPLACE ENCLOSURE
112	STOR-2	WL 1	-	VB 1	4"	PT 1	PT 1	PT 1	PT 1		112.1	PT 4	PT 5	GYP	PT 6					
113	STOR-1	WL 1	-	VB 1	4"	PT 1	PT 1	PT 1	PT 1		113.1, 113.2	PT 4	PT 5	GYP	PT 6					
114	CRAFTS/HOBBY	WL 1	-	VB 1	4"	PT 1	PT 1	PT 1	PT 1		114.1	PT 4	PT 5	GYP	PT 6		PT5			
115	LAUNDRY	VCT 1	-	VB 1	4"	PT 1	PT 1	PT 1	PT 1		115.1	PT 4	PT 5	GYP	PT 6			PL 1	PL 2	
116	ROOF ACCESS	VCT 1	-	VB 1	4"	PT 1	PT 1	PT 1	PT 1		116.1	PT 4	PT 5	GYP	PT 6					
117	EX.LINK CORRIDOR B	VCT 1	VCT 2	VB 1	4"	PT 1	PT 1	PT 1	PT 1		117.1	PT 4	PT 5	GYP	PT 6		PT5			
118	EX.LINK CORRIDOR C	VCT 1	VCT 2	VB 1	4"	PT 1	PT 1	PT 1	PT 1		118.1	PT 4	PT 5	GYP	PT 6		PT5			