



**STRUCTURAL LUMBER**

1. ALL TIMBER CONSTRUCTION TO BE IN ACCORDANCE WITH THE 2012 ONTARIO BUILDING CODE, LATEST REVISIONS.
2. ALL STRUCTURAL LUMBER TO BE SPF #2 OR BETTER UNLESS OTHERWISE NOTED ON DRAWINGS. 'STUD' GRADE IS NOT ACCEPTABLE FOR BEARING WALLS, LINTELS AND POSTS.
3. PLYWOOD ROOF SHEATHING TO BE CONSTRUCTION GRADE, EXTERIOR GRADE, GOOD-ONE-SIDE SOFTWOOD PLYWOOD SOFTWOOD PLYWOOD TO CAN/CSA O151-M1978 OR DOUGLAS FIR PLYWOOD TO CAN/CSA 0121-M1978.
4. DESIGN-RATED OSB, TYPES 1, 2 AND 3 CERTIFIED FOR ENGINEERING USES TO CAN/CSA 0437.0-93 AND CAN/CSA 0452.0-94.
5. PROPRIETARY (ENGINEERED PRODUCTS AS SPECIFIED ON THE PLANS. SUBSTITUTIONS FROM THE SPECIFIED PRODUCTS BY WRITTEN APPROVAL OF THE ENGINEER ONLY.
6. ALL BEARING WALLS ARE TO HAVE HORIZONTAL BLOCKING AT SHEATHING JOINTS.
7. ALL BEAMS REQUIRE RESTRAINT AGAINST LATERAL DISPLACEMENT AND ROTATION AT THE POINTS OF BEARING.
8. FOR BUILT-UP BEAMS, IT IS ASSUMED THAT EACH PLY IS A SINGLE CONTINUOUS MEMBER, FASTENED TOGETHER SECURELY AT INTERVALS NOT EXCEEDING 4 TIMES THE DEPTH AND THAT EACH PLY IS EQUALLY LOADED.
9. BUILT-UP RECTANGULAR COMPRESSION MEMBERS SHALL CONSIST OF INDIVIDUAL MEMBERS OF EQUAL LENGTH FASTENED TOGETHER USING NAILS, LAG SCREWS OR BOLTS.
10. WHEN USED, NAILS SHALL PENETRATE THROUGH AT LEAST OF 3/4" OF THE THICKNESS OF THE LAST INDIVIDUAL PIECE, THE NAILS SHALL BE DRIVEN FROM EITHER FACE OF THE BUILT-UP MEMBER ALONG THE LENGTH.
11. WHEN INDIVIDUAL PIECES OF THE BUILT-UP MEMBER ARE WIDER THAN 3 TIMES THEIR THICKNESS, THERE SHALL BE AT LEAST 2 ROWS OF FASTENERS ACROSS THE MEMBER WIDTH.

**FORMWORK**

1. VERIFY LINES, LEVELS AND WALL CENTRES BEFORE PROCEEDING WITH FORMWORK AND ENSURE DIMENSIONS AGREE WITH DRAWINGS.
2. CONSTRUCT FORMS TO PRODUCE FINISHED CONCRETE CONFORMING TO SHAPE, DIMENSIONS, LOCATIONS AND LEVELS INDICATED WITHIN TOLERANCES REQUIRED BY CSA A23.1-04/A23.2-04 ALIGN FORM JOINTS AND MAKE WATERTIGHT. KEEP FORM JOINTS TO MINIMUM. LOCATE HORIZONTAL FORM JOINTS FOR EXPOSED WALLS TO APPROVAL OF ARCHITECT. CLEAN FORMWORK IN ACCORDANCE WITH CSA A23.1-04/A23.2-04, BEFORE PLACING CONCRETE.
3. FORM CHASES, SLOTS, OPENINGS, DRIPS, RECESSES EXPANSION AND CONTROL JOINTS AS INDICATED.
4. LEAVE FORMWORK IN PLACE FOR 48 HOURS MINIMUM PERIOD OF TIME AFTER PLACING CONCRETE. AFTER FORM REMOVAL COVER AND PROTECT CONCRETE FOR REMAINDER OF THE INITIAL CURING PERIOD. USE INSULATED TARPS FOR COLD WEATHER OPERATION.
5. OBTAIN ENGINEER'S PERMISSION BEFORE FRAMING OPENINGS NOT INDICATED IN CONCRETE SLABS, WALLS, PIERS AND FOOTINGS.

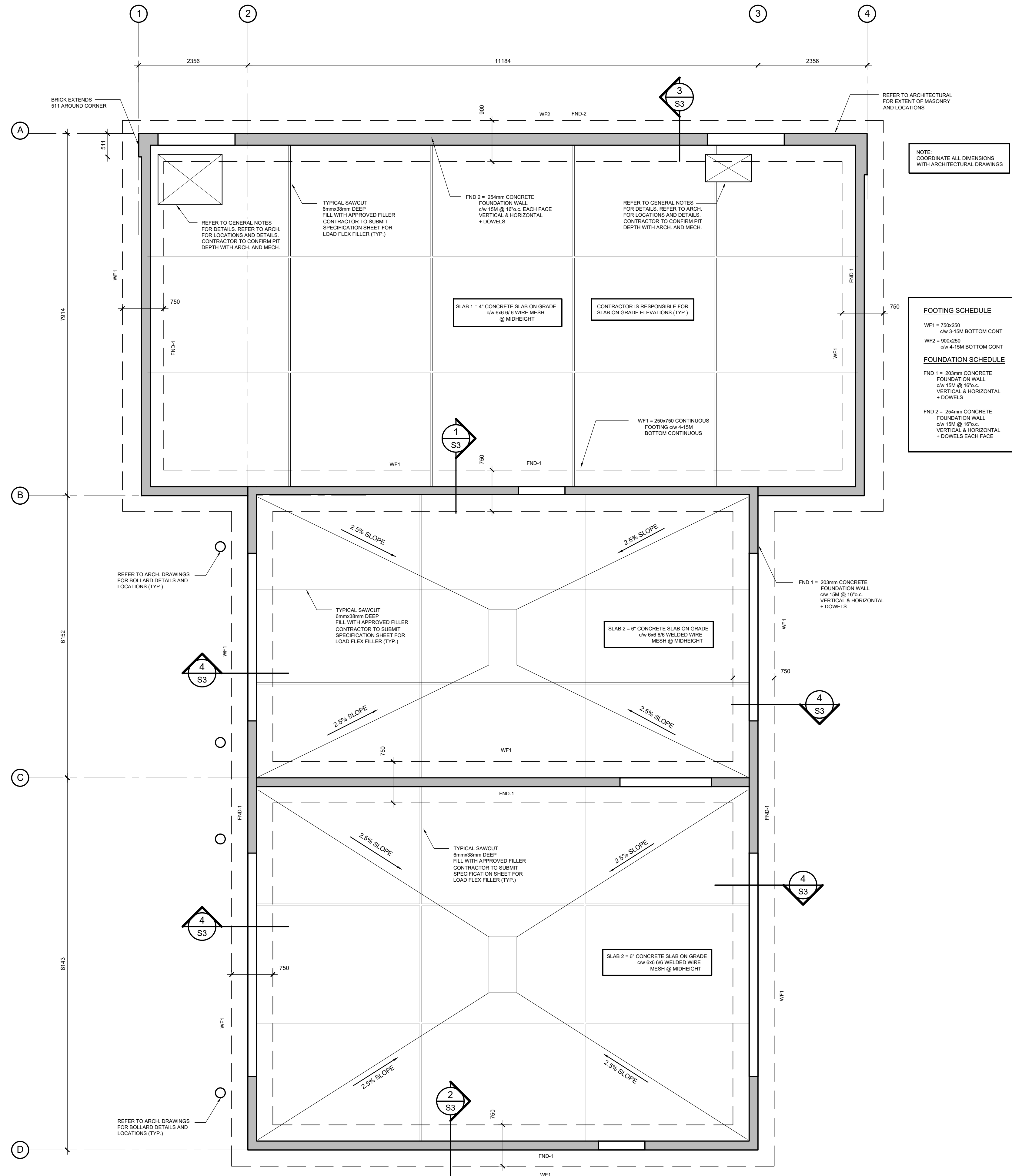

1 PLAN: FOUNDATION  
SCALE: 1:50

IT IS THE RESPONSIBILITY OF THE APPROPRIATE CONTRACTOR TO CHECK AND VERIFY ALL DIMENSIONS ON SITE AND TO REPORT ALL ERRORS AND/OR OMISSIONS TO THE ENGINEER.  
ALL CONTRACTORS MUST COMPLY WITH ALL PERTINENT CODES AND BY-LAWS.  
DO NOT SCALE DRAWINGS.  
COPYRIGHT RESERVED.

7	FEB 14/20	ISSUED FOR CONSTRUCTION
6	OCT 31/19	ISSUED FOR TENDER
5	MAR 20/19	ISSUED FOR PERMIT
4	JAN 03/18	RE-ISSUED FOR REVIEW
3	NOV 11/18	ISSUED FOR COORDINATION
2	OCT 29/18	RE-ISSUED FOR REVIEW
1	SEPT 11/18	ISSUED FOR REVIEW

PROFESSIONAL SEAL: NORTH ARROW:

CLIENT:



PROJECT TITLE:  
**ENTERPRISE RENT-A-CAR**

PALLADIUM DRIVE,  
OTTAWA, ONTARIO

SHEET TITLE:  
**FOUNDATION PLAN**

DRAWN: A.V.	CHECKED: J.V.
SCALE: AS SHOWN	SHEET No. <b>S1</b>
PROJECT No. S221-18	

IT IS THE RESPONSIBILITY OF THE APPROPRIATE CONTRACTOR TO CHECK AND VERIFY ALL DIMENSIONS ON SITE AND TO REPORT ALL ERRORS AND/OR OMISSIONS TO THE ENGINEER.  
 ALL CONTRACTORS MUST COMPLY WITH ALL PERTINENT CODES AND BY-LAWS.  
 DO NOT SCALE DRAWINGS.  
 COPYRIGHT RESERVED.

**DESIGN LOADS (ROOF)**  
 ROOFING = 0.5 kPa  
 ROOF JOIST + BEAM = 0.7 kPa  
 MISG = 0.25 kPa

DEAD LOAD = 1.45 kPa  
 SNOW LOAD = 2.2 kPa  
 + SNOW DRIFTING

**ROOF DIAPHRAGM**  
 12.5mm CSP PLYWOOD SHEATHING BLOCKED AT PANEL POINTS, 50mm NAILS @ 150mm AROUND PANEL PERIMETER AND 300mm AT INTERIOR JOINTS.  
 PLYWOOD SHEATHING HAS BEEN DESIGNED FOR DIAPHRAGM ACTION TO TRANSMIT HORIZONTAL LOADS (WIND AND/OR SEISMIC) TO THE WOOD PERIMETER WALLS IN ACCORDANCE WITH THE 2012 OBC.

NOTE:  
 COORDINATE ALL DIMENSIONS WITH ARCHITECTURAL DRAWINGS

**WOOD PERIMETER WALL SCHEDULE**  
 WALL STUDS = 2"x6" @ 400mm o.c.  
 NOTE:  
 TRUCK BAY HIGH WALLS TO BE 2x6 @ 300mm o.c. (SHADED) AS SHOWN ON PLAN

SHEATHING = 12.5mm CSP PLYWOOD (BLOCKED @ PANEL POINTS)  
 NAILING 75mm COMMON NAILS @ 100mm o.c. AROUND PANEL EDGES AND 300mm o.c. @ INTERIOR STUDS

**WOOD POST SCHEDULE**  
 P1 = 3-2x6 (2 JACK, 1 KING)  
 P2 = 4-2x6 (3 JACK, 1 KING)

**WOOD LINTEL SCHEDULE**  
 L1 = 3 - 1 1/2" x 9 1/2" LVL  
 L2 = 3 - 1 1/2" x 14" LVL

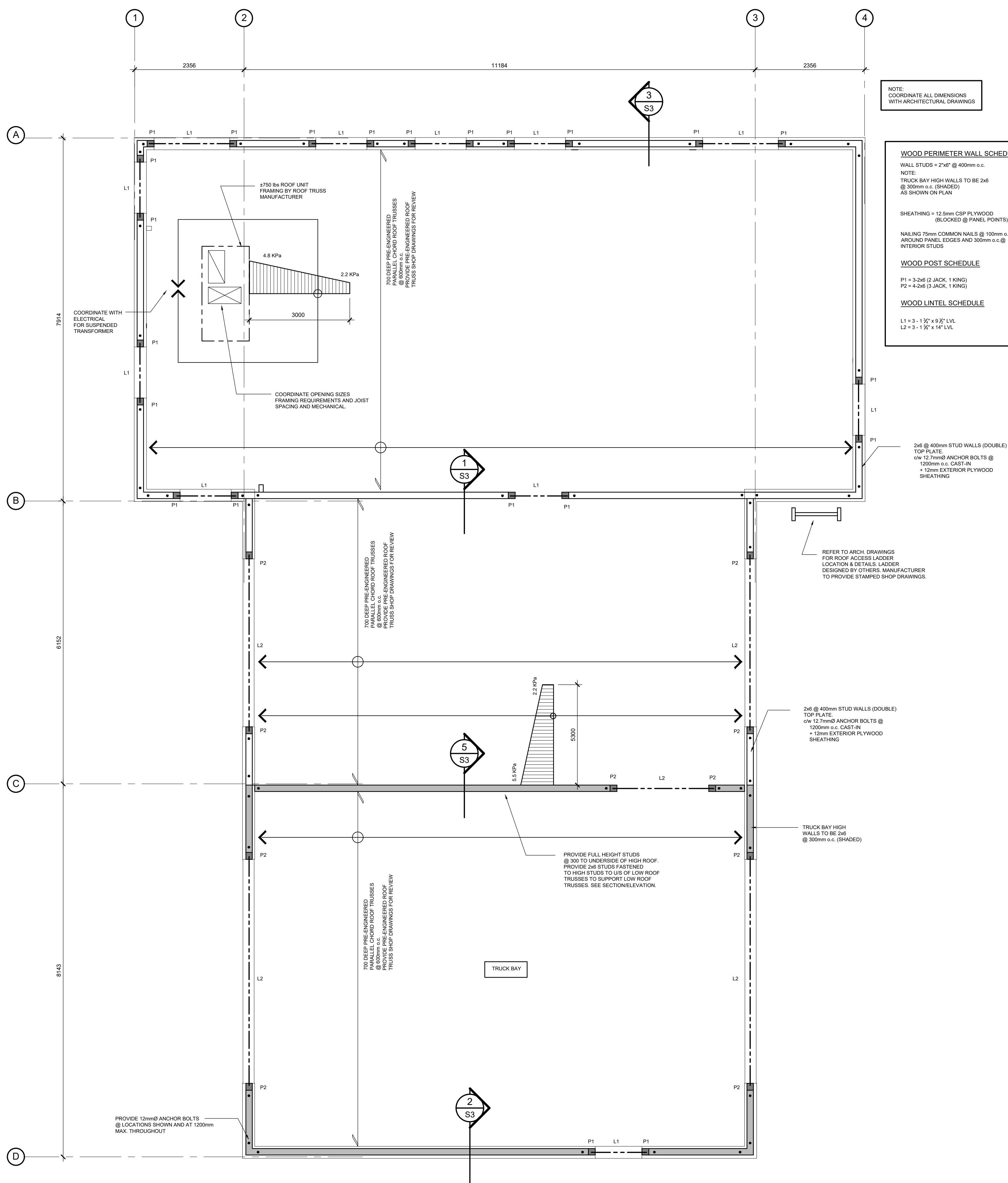

1 PLAN: GROUND FLOOR/ROOF  
 S2 SCALE: 1:50

7	FEB 14/20	ISSUED FOR CONSTRUCTION
6	OCT 31/19	ISSUED FOR TENDER
5	MAR 20/19	ISSUED FOR PERMIT
4	JAN 03/18	RE-ISSUED FOR REVIEW
3	NOV 11/18	ISSUED FOR COORDINATION
2	OCT 29/18	RE-ISSUED FOR REVIEW
1	SEPT 11/18	ISSUED FOR REVIEW

PROFESSIONAL SEAL: NORTH ARROW:

CLIENT:



PROJECT TITLE:  
**ENTERPRISE RENT-A-CAR**

PALLADIUM DRIVE,  
 OTTAWA, ONTARIO

SHEET TITLE:  
**GROUND FLOOR/ROOF PLAN**

DRAWN: A.V.	CHECKED: J.V.
SCALE: AS SHOWN	SHEET No. <b>S2</b>
PROJECT No. S221-18	

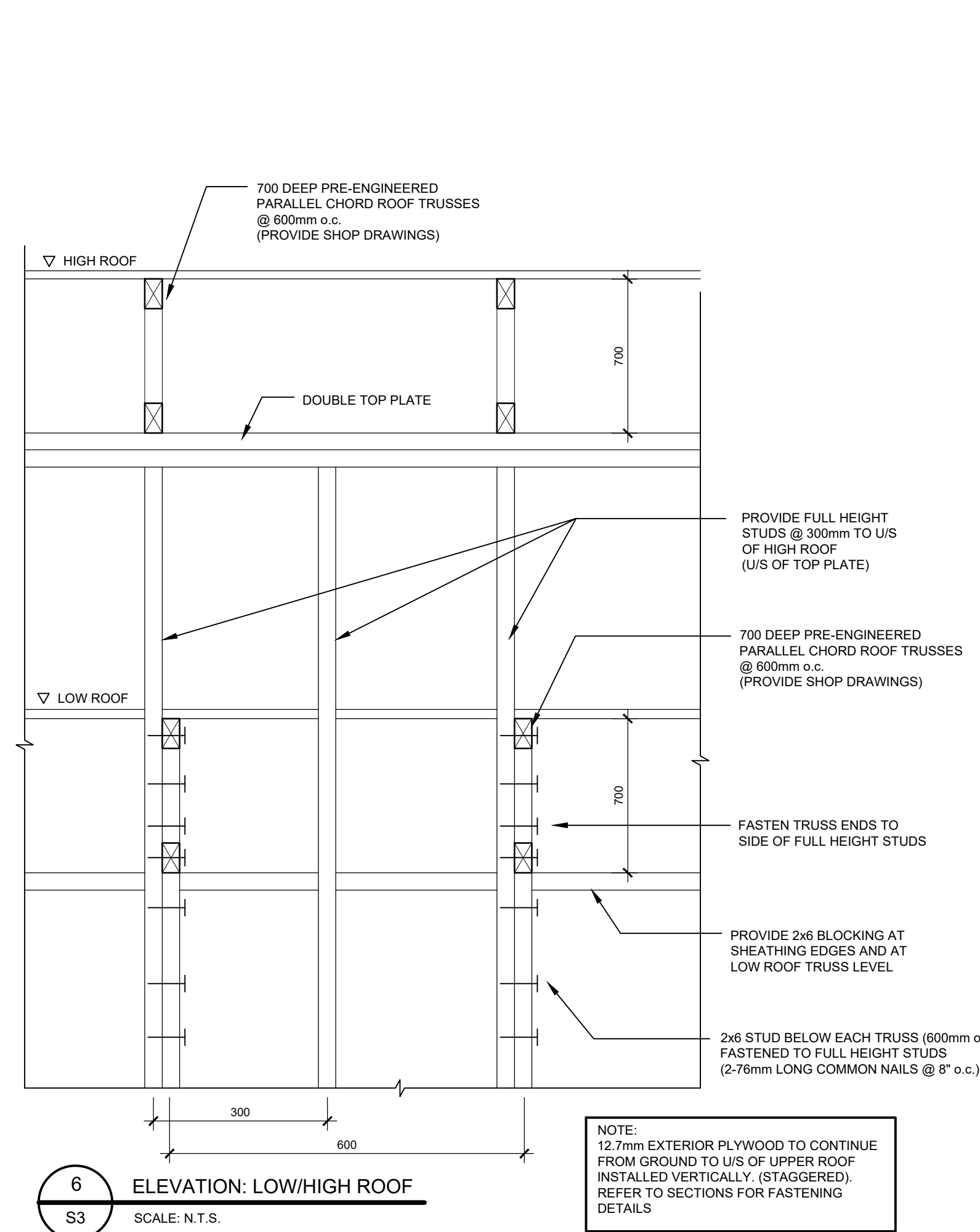

**6 ELEVATION: LOW/HIGH ROOF**  
SCALE: N.T.S.

NOTE:  
12.7mm EXTERIOR PLYWOOD TO CONTINUE FROM GROUND TO U/S OF UPPER ROOF INSTALLED VERTICALLY (STAGGERED). REFER TO SECTIONS FOR FASTENING DETAILS

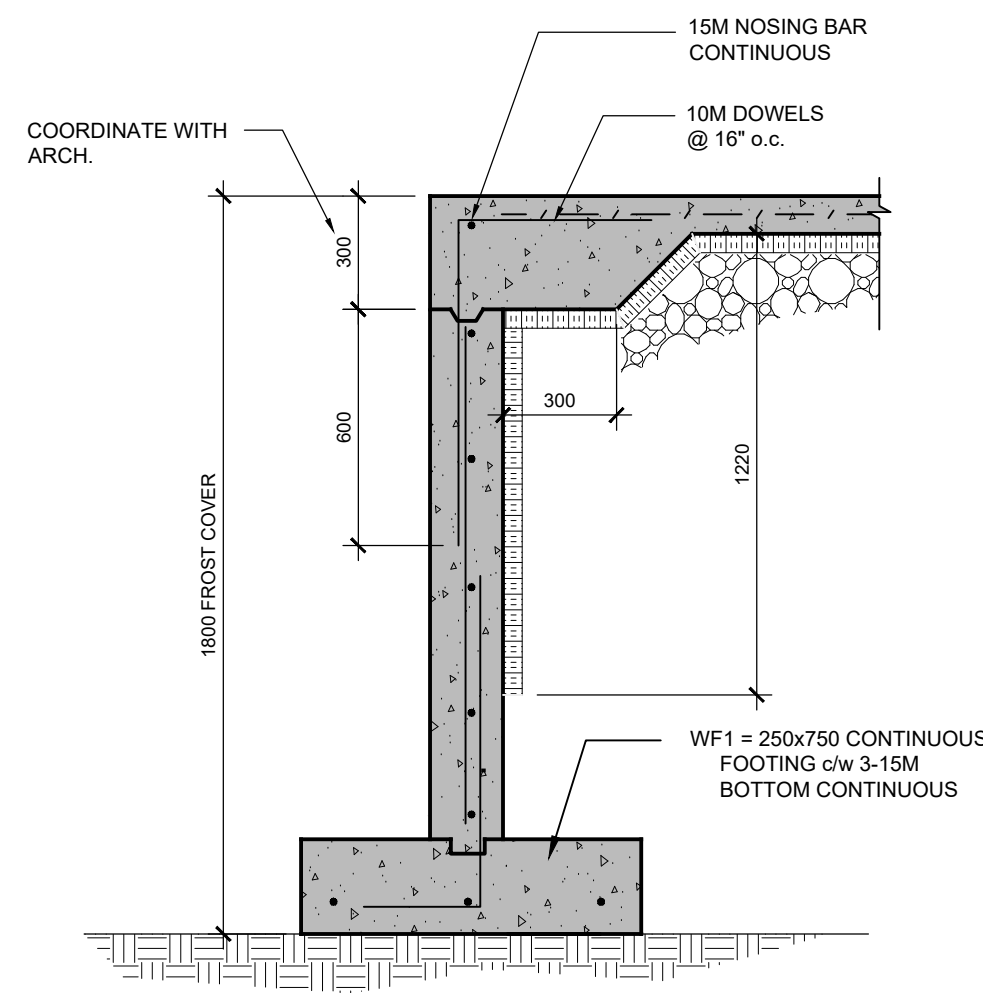

**4 SECTION: @ GARAGE DOOR**  
SCALE: 1:20

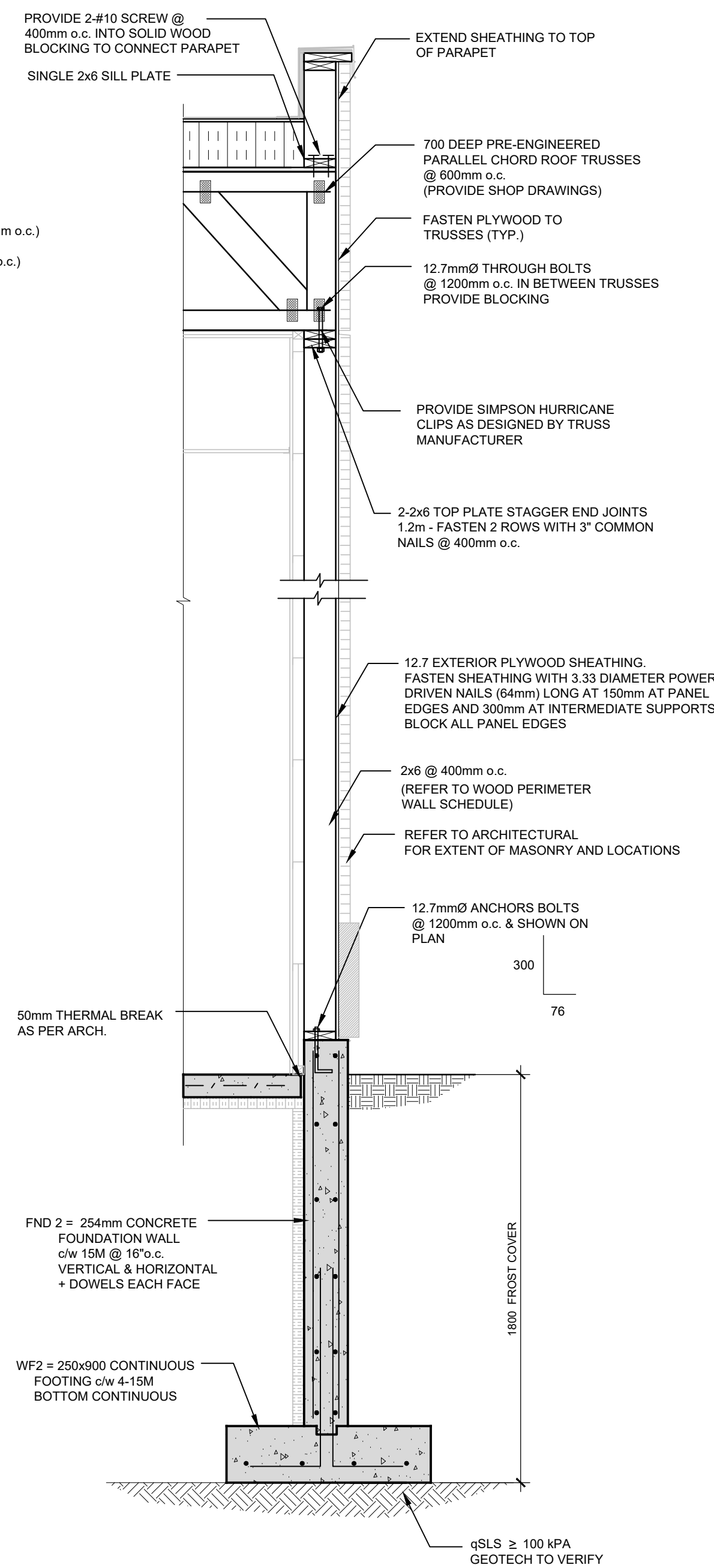

**3 SECTION: FRONT WALL**  
SCALE: 1:20

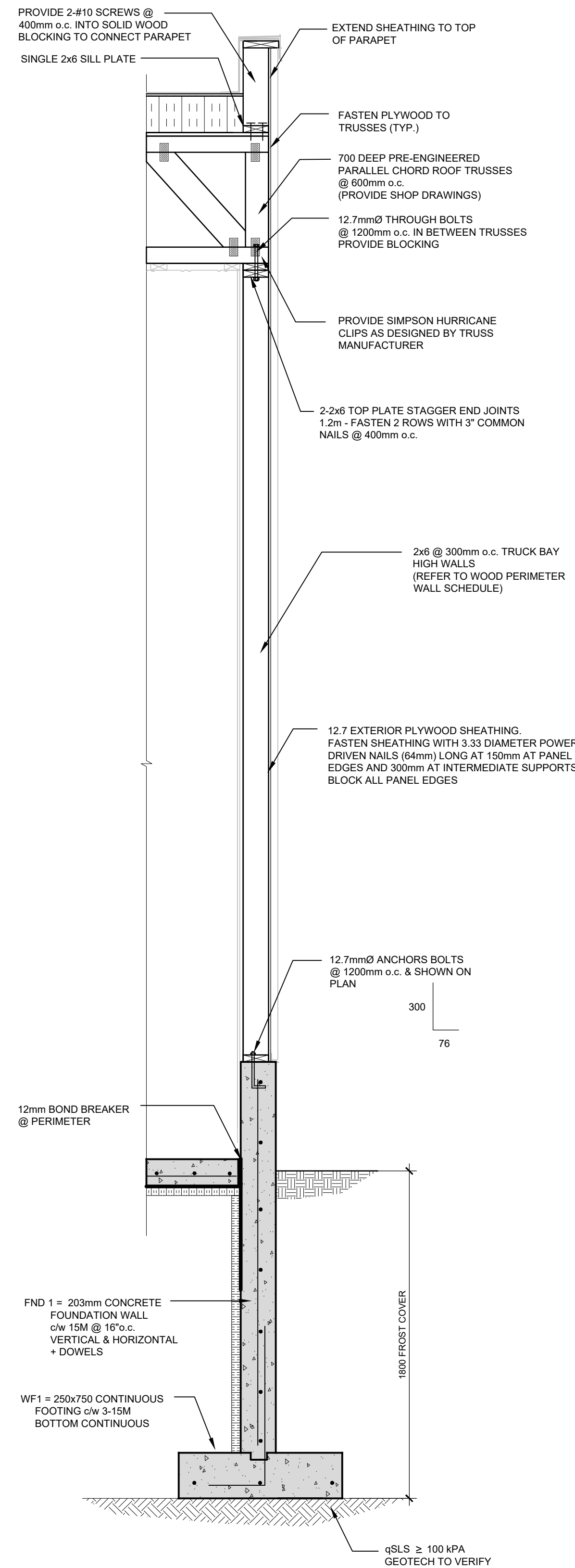

**2 SECTION: DOUBLE CLAD WALL**  
SCALE: 1:20

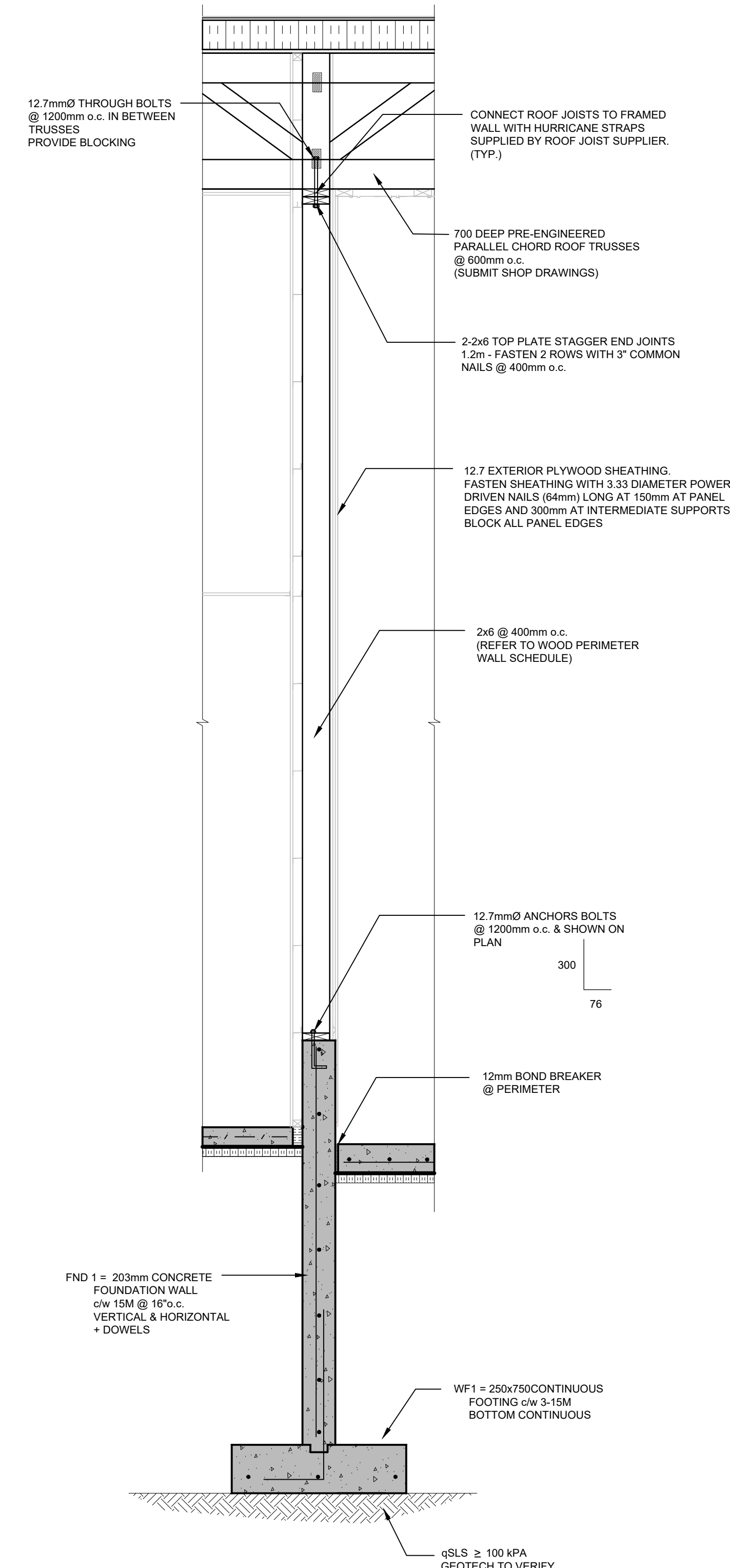

**1 SECTION: METAL WALL CLADDING**  
SCALE: 1:20

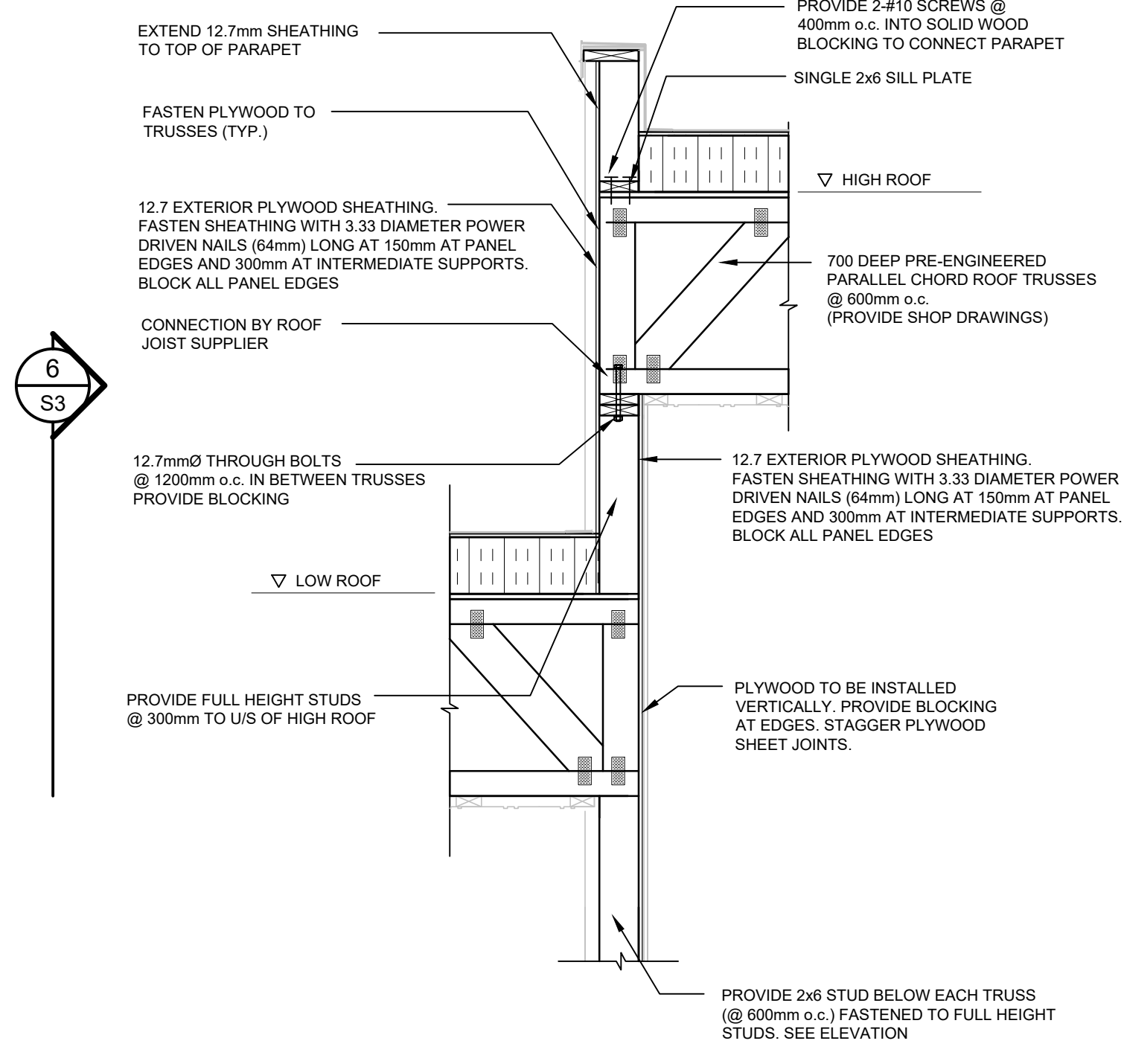

**5 SECTION: DETAIL @ TALL ROOF**  
SCALE: 1:20

IT IS THE RESPONSIBILITY OF THE APPROPRIATE CONTRACTOR TO CHECK AND VERIFY ALL DIMENSIONS ON SITE AND TO REPORT ALL ERRORS AND/OR OMISSIONS TO THE ENGINEER.  
ALL CONTRACTORS MUST COMPLY WITH ALL PERTINENT CODES AND BY-LAWS.  
DO NOT SCALE DRAWINGS.  
COPYRIGHT RESERVED.

7	FEB 14/20	ISSUED FOR CONSTRUCTION
6	OCT 31/19	ISSUED FOR TENDER
5	MAR 20/19	ISSUED FOR PERMIT
4	JAN 03/18	RE-ISSUED FOR REVIEW
3	NOV 11/18	ISSUED FOR COORDINATION
2	OCT 29/18	RE-ISSUED FOR REVIEW
1	SEPT 11/18	ISSUED FOR REVIEW

PROFESSIONAL SEAL:

NORTH ARROW:

CLIENT:



PROJECT TITLE:  
**ENTERPRISE RENT-A-CAR**

PALLADIUM DRIVE,  
OTTAWA, ONTARIO

SHEET TITLE:  
**SECTIONS & DETAILS**

DRAWN: A.V.	CHECKED: J.V.
SCALE: AS SHOWN	SHEET No. <b>S3</b>
PROJECT No. S221-18	