

March 6, 2020

VIA EMAIL: j.flynn@flynnarchitect.com

Flynn Architect
Ottawa, ON.

ATTENTION: Jason Flynn

SUBJECT: Structural Site Instruction 1 (SSI#1): Enterprise Kanata – 225 Huntmar Drive
Project Number: S221-18

1. Footings WF1 and WF2 are to be 700mm wide x 250 mm deep complete with 3-15M bottom continuous. Excavate to native silty clay as directed by the geotechnical engineer. Footings to bear on native silty clay as indicated in the geotechnical report. Allowable bearing capacity is to be 90 kPa (SLS) and 265 kPa (ULS) based on table 8.1 on page 11 in the geotechnical report. Bearing capacity to be confirmed by the geotechnical engineer on site and confirmed in writing by the geotechnical engineer. If step footings are required, please refer to detail 3-5 Footing Steps on drawing S0.

If you have any questions, please contact the undersigned.

Yours truly,

VRIEND ENGINEERING INC.

A handwritten signature in black ink, appearing to read "J. Vriend", is written over a horizontal line.

Jason Vriend, P. Eng.



STRUCTURAL LUMBER

1. ALL TIMBER CONSTRUCTION TO BE IN ACCORDANCE WITH THE 2012 ONTARIO BUILDING CODE, LATEST REVISIONS.
2. ALL STRUCTURAL LUMBER TO BE SPF #2 OR BETTER UNLESS OTHERWISE NOTED ON DRAWINGS. 'STUD' GRADE IS NOT ACCEPTABLE FOR BEARING WALLS, LINTELS AND POSTS.
3. PLYWOOD ROOF SHEATHING TO BE CONSTRUCTION GRADE, EXTERIOR GRADE, GOOD-ONE-SIDE SOFTWOOD PLYWOOD SOFTWOOD PLYWOOD TO CAN/CSA O151-M1978 OR DOUGLAS FIR PLYWOOD TO CAN/CSA 0121-M1978.
4. DESIGN-RATED OSB, TYPES 1, 2 AND 3 CERTIFIED FOR ENGINEERING USES TO CAN/CSA 0437.0-93 AND CAN/CSA 0452.0-94.
5. PROPRIETARY (ENGINEERED PRODUCTS AS SPECIFIED ON THE PLANS. SUBSTITUTIONS FROM THE SPECIFIED PRODUCTS BY WRITTEN APPROVAL OF THE ENGINEER ONLY.
6. ALL BEARING WALLS ARE TO HAVE HORIZONTAL BLOCKING AT SHEATHING JOINTS.
7. ALL BEAMS REQUIRE RESTRAINT AGAINST LATERAL DISPLACEMENT AND ROTATION AT THE POINTS OF BEARING.
8. FOR BUILT-UP BEAMS, IT IS ASSUMED THAT EACH PLY IS A SINGLE CONTINUOUS MEMBER, FASTENED TOGETHER SECURELY AT INTERVALS NOT EXCEEDING 4 TIMES THE DEPTH AND THAT EACH PLY IS EQUALLY LOADED.
9. BUILT-UP RECTANGULAR COMPRESSION MEMBERS SHALL CONSIST OF INDIVIDUAL MEMBERS OF EQUAL LENGTH FASTENED TOGETHER USING NAILS, LAG SCREWS OR BOLTS.
10. WHEN USED, NAILS SHALL PENETRATE THROUGH AT LEAST OF 3/4" OF THE THICKNESS OF THE LAST INDIVIDUAL PIECE, THE NAILS SHALL BE DRIVEN FROM EITHER FACE OF THE BUILT-UP MEMBER ALONG THE LENGTH.
11. WHEN INDIVIDUAL PIECES OF THE BUILT-UP MEMBER ARE WIDER THAN 3 TIMES THEIR THICKNESS, THERE SHALL BE AT LEAST 2 ROWS OF FASTENERS ACROSS THE MEMBER WIDTH.

FORMWORK

1. VERIFY LINES, LEVELS AND WALL CENTRES BEFORE PROCEEDING WITH FORMWORK AND ENSURE DIMENSIONS AGREE WITH DRAWINGS.
2. CONSTRUCT FORMS TO PRODUCE FINISHED CONCRETE CONFORMING TO SHAPE, DIMENSIONS, LOCATIONS AND LEVELS INDICATED WITHIN TOLERANCES REQUIRED BY CSA A23.1-04/A23.2-04 ALIGN FORM JOINTS AND MAKE WATERTIGHT. KEEP FORM JOINTS TO MINIMUM. LOCATE HORIZONTAL FORM JOINTS FOR EXPOSED WALLS TO APPROVAL OF ARCHITECT. CLEAN FORMWORK IN ACCORDANCE WITH CSA A23.1-04/A23.2-04, BEFORE PLACING CONCRETE.
3. FORM CHASES, SLOTS, OPENINGS, DRIPS, RECESSES EXPANSION AND CONTROL JOINTS AS INDICATED.
4. LEAVE FORMWORK IN PLACE FOR 48 HOURS MINIMUM PERIOD OF TIME AFTER PLACING CONCRETE. AFTER FORM REMOVAL COVER AND PROTECT CONCRETE FOR REMAINDER OF THE INITIAL CURING PERIOD. USE INSULATED TARPS FOR COLD WEATHER OPERATION.
5. OBTAIN ENGINEER'S PERMISSION BEFORE FRAMING OPENINGS NOT INDICATED IN CONCRETE SLABS, WALLS, PIERS AND FOOTINGS.

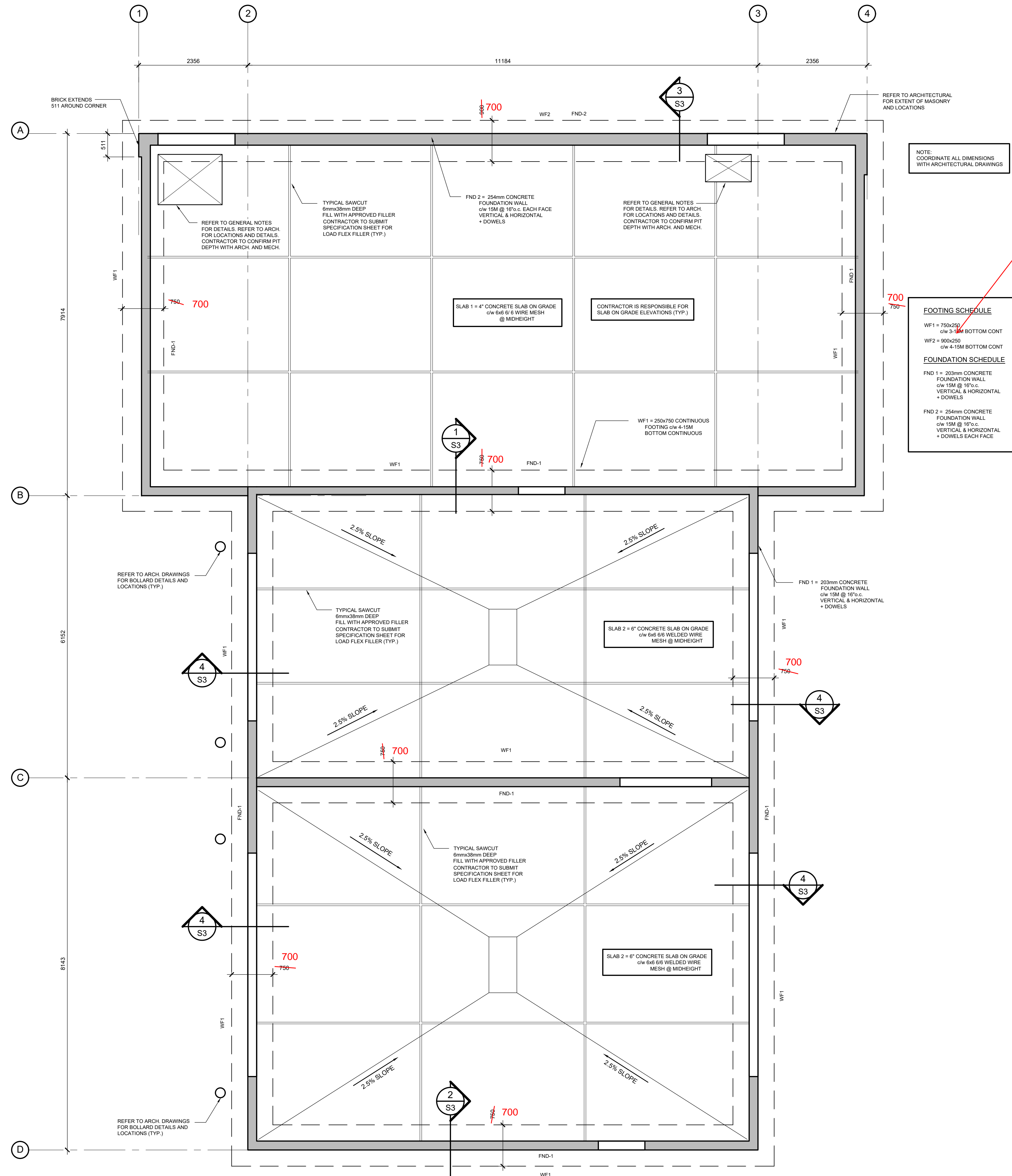

NOTE: COORDINATE ALL DIMENSIONS WITH ARCHITECTURAL DRAWINGS

FOOTING SCHEDULE

WF1 = 750x250 c/w 3-18M BOTTOM CONT

WF2 = 900x250 c/w 4-18M BOTTOM CONT

FOUNDATION SCHEDULE

FND 1 = 203mm CONCRETE FOUNDATION WALL c/w 15M @ 18% c. VERTICAL & HORIZONTAL + DOWELS

FND 2 = 254mm CONCRETE FOUNDATION WALL c/w 15M @ 18% c. VERTICAL & HORIZONTAL + DOWELS EACH FACE

WF1 = 700 x 250 c/w 3-15M bottom continuous
WF2 = 700 x 250 c/w 3-15M bottom continuous

Allowable Bearing SLS = 90 kPa or greater

8 Mar 6, 2020 Revised Footings

7	FEB 14/20	ISSUED FOR CONSTRUCTION
6	OCT 31/19	ISSUED FOR TENDER
5	MAR 20/19	ISSUED FOR PERMIT
4	JAN 03/18	RE-ISSUED FOR REVIEW
3	NOV 11/18	ISSUED FOR COORDINATION
2	OCT 29/18	RE-ISSUED FOR REVIEW
1	SEPT 11/18	ISSUED FOR REVIEW

PROFESSIONAL SEAL: NORTH ARROW:

CLIENT:



PROJECT TITLE:
ENTERPRISE RENT-A-CAR

PALLADIUM DRIVE,
OTTAWA, ONTARIO

SHEET TITLE:
FOUNDATION PLAN

DRAWN: A.V.	CHECKED: J.V.
SCALE: AS SHOWN	SHEET No. S1
PROJECT No. S221-18	

1 PLAN: FOUNDATION
SCALE: 1:50