

**DRAWING REVIEW**

The review of this drawing does not in any way relieve the Contractor of responsibility from its actions and compliance with the Contract Documents

ID: CARLETON PLACE ARENA	Contract #: 7558
X No Comment	Submission #: 1
Reviewed as Noted	Review By: SC
Rejected See Remarks	Date: 2020-08-26

Comments:  
 1. Contractor to verify all dimensions prior to fabrication.  
 2. All work to the 2012 Ontario Building Code.  
 3. Refer to EEG drawings S0 to S6 for full notes and details.

**EASTERN ENGINEERING GROUP INC.**  
 Consulting Engineers, Brockville, ON  
 Tel: (613)345-0400, Fax: (613)345-0008  
 www.easteng.com

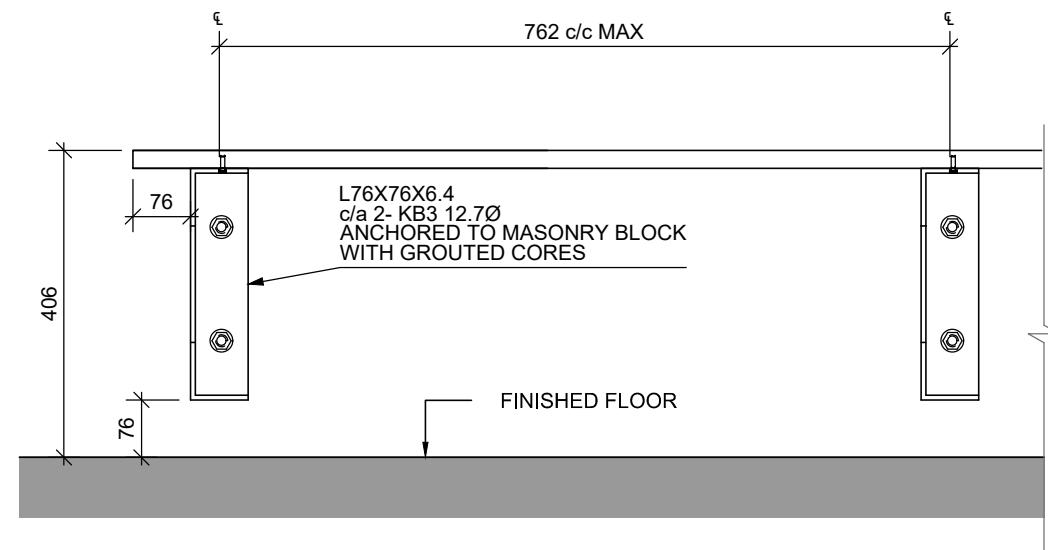

FRONT VIEW

SCALE - 1:10

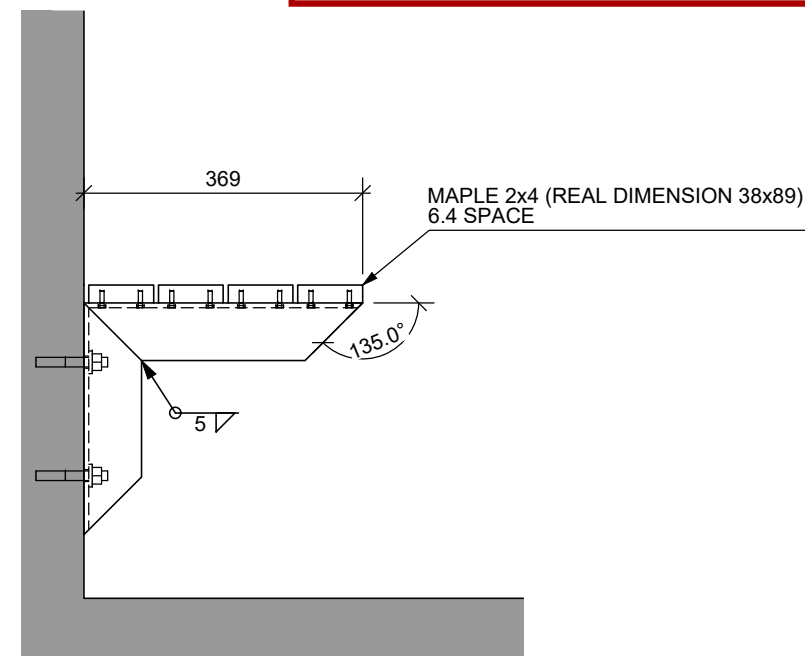

ELEVATION VIEW

SCALE - 1:10

**GENERAL NOTES**

**MATERIALS:** UNLESS NOTED OTHERWISE  
 - HSS = A500 (GRADE C) / G40.21M 350W  
 [SQUARE/REC. 345MPa ROUND 317 MPa]  
 - BEAM "W" = G40.21M 350W  
 - ALL OTHERS STEEL = G40.21M 300W

**WELDING STANDARD:**  
 - STEEL = CSA W47.1/W59  
 - ALUMINIUM = CSA W47.2/W59.2

**CONNECTOR:** UNLESS NOTED OTHERWISE  
 - STRUCTURAL BOLT = ASTM A325  
 - NONSTRUCTURAL BOLT = ASTM A307  
 - THREADED ROD = ASTM A307  
 - NELSON STUDS = AC 1020  
 - REBAR = G40.21M 400W

**MATERIALS / COATING:**  
 - STEEL / GALVANIZED

**NOTE:**

- 96 SUPPORT REQUIRED

FORMAT: 11"x17"

REV.	Date	Description
0	2020-08-13	ISSUED FOR APPROVAL

Project: Project No.: 78900-02

**CARRLETON PLACE ARENA**

Title: **BENCH SUPPORT**

Client : TAL-CO BUILDING INNOVATIONS LTD

Detailed by : J.J

Verified by : J.LANDRY

Project manager : ÉRIC MARINIER

Stamp :



Révision :



Page No. :

**02-S01**