

FORMAT - 11"x17" - 2018-04-20 10:00:00 COMMUNIS-DESSINS & CONCEPTION-78900_TALCO_CARLETON PLACE ARENA03_DESSINS DATELIERE66-SEAM001_DWG (ACTIF) 17890-0501AUSGA SHEET 1-0.DWG

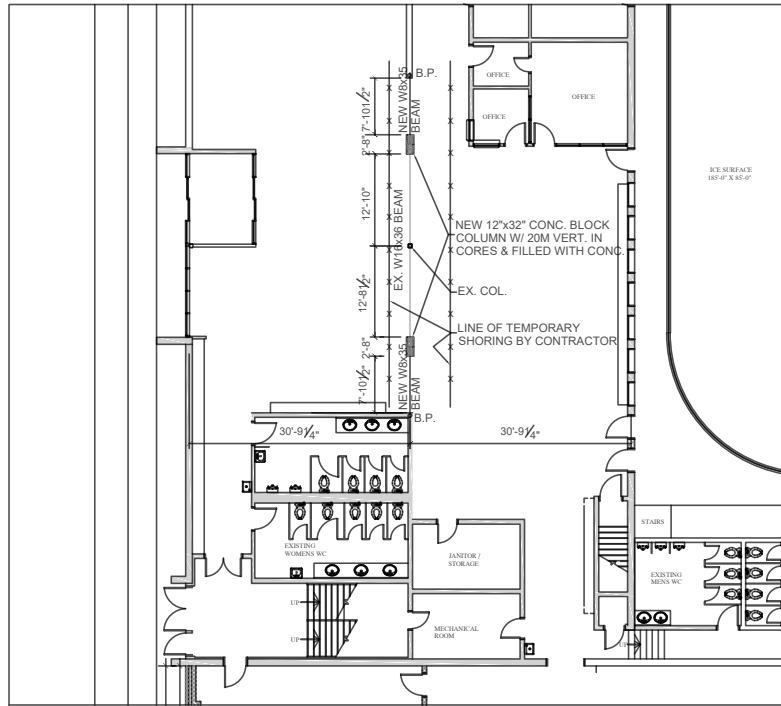

DRAWING REVIEW
The review of this drawing does not in any way relieve the Contractor of responsibility from its actions and compliance with the Contract Documents

ID: CARLETONS PLACE ARENA		Contract #: 7558	
No Comment	Submission #: 1		
X Reviewed as Noted	Review By: SC		
Rejected See Remarks	Date: 2020-08-26		

Comments:
1. General contractor to verify all dimensions prior to fabrication.
2. All work to be completed to the 2012 Ontario Building Code.
3. Refer to EEG drawing No. S0 to S6 for full notes and details.

EASTERN ENGINEERING GROUP INC.
Consulting Engineers, Brockville, ON
Tel: (613)345-0400, Fax: (613)345-0008
www.easteng.com

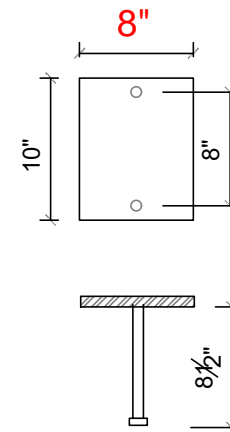

ANCHOR PLATE DETAIL
SCALE - N/A 2X

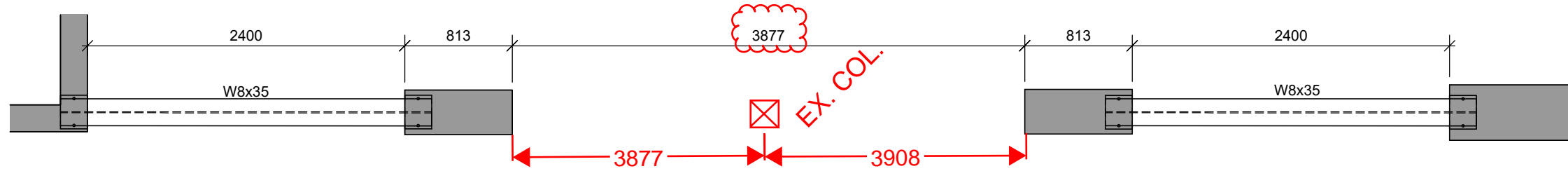

TOP VIEW
SCALE - 1:40



FRONT VIEW
SCALE - 1:40

GENERAL NOTES

MATÉRIALS: UNLESS NOTED OTHERWISE
- HSS = A500 (GRADE C) / G40.21M 350W [SQUARE/REC. 345MPa ROUND 317 MPa]
- BEAM "W" = G40.21M 350W
- ALL OTHERS STEEL = G40.21M 300W

WELDING STANDARD:
- STEEL = CSA W47.1/W59
- ALUMINIUM = CSA W47.2/W59.2

CONNECTOR: UNLESS NOTED OTHERWISE
- STRUCTURAL BOLT = ASTM A325
- NONSTRUCTURAL BOLT = ASTM A307
- THREADED ROD = ASTM A307
- NELSON STUDS = AC 1020
- REBAR = G40.21M 400W

MATÉRIALS / COATING:
- STEEL / PRIMED

FORMAT: 11"x17"

REV.	Date	Description
0	2020-08-25	ISSUED FOR APPROVAL

Project: Project No.: 78900-05
CARLETONS PLACE ARENA

Title: **2-BEAMS**

Client: TAL-CO BUILDING INNOVATIONS LTD

Detailed by: J.J

Verified by: J.LANDRY

Project manager: ÉRIC MARINIER

Stamp:



Révision:



Page No.:

S01