

# LARRY GAINES • ARCHITECT

Old Town Hall  
14 Bridge Street, PO 706  
Almonte, Ontario  
K0A 1A0

T: 613-256-3630  
gaines@bellnet.ca

## CIR Response

## CIR #20

**To:**

TALCO BUILDING INNOVATIONS LTD.  
4728 Bank Street, Suite A  
Ottawa, Ontario

**Project:**

Carleton Place Arena  
Renovation and Addition

**Date:**

October 27, 2020

---

CIR Responses are issued only for the purpose of recording any clarification or interpretation of the contract documents or giving direction on problems resulting from field conditions. These instructions are subject to the provisions of the contract documents and unless stated herein and specifically co-authorized by the Client, will not affect the contract

---

### REFERENCES:

CIR #20 submitted October 26, 2020

1. The location of the plumbing vent stack has been resolved in Site Instruction #1, attached.
2. Floor drains, in the toilet rooms, were indicated on the architectural drawings. They were not specified on the mechanical drawings. At the time of our site meeting, the associated plumbing had been complete. It was decided to leave the drains in place.
3. D5 is located in wall type W4 which is a full height wall.

**PER:**

Larry Gaines  
Architect



**CARLETON PLACE ARENA  
ADDITION AND RENOVATIONS  
75 Neelin Street Carleton Place, Ontario**

TAL-CO Building Innovations Limited  
4728 Bank Street, Suite A  
Gloucester, Ontario K1T 3W7  
Tel: 613-821-3959  
Fax: 613-821-2938

Issue date: Oct-26- 2020  
Revision date:  
Revision #:

---

**CIR #20 Detailed Summary**

**Question:**

1. Drawing M 101, 4" Sanitary pipe, requires a Venting Stack. There is no wall wide enough to house a 4" pipe through the roof and placing the pipe into an exterior wall would involve installing it through the floor and elbow into an exterior wall having a pipe exposed.

Please advise where to install the vent stack for the underground plumbing?

2. Drawing 1/A8 show a floor drain as a typical detail, but there no information regarding the floor drain in M-101. please advise if a drain is required in the Toilet area?
3. Interior partition walls are detail with a height of 6', please advise how door D 5's would be installed as the height of doors are 84"?

**End of CIR No. 20**

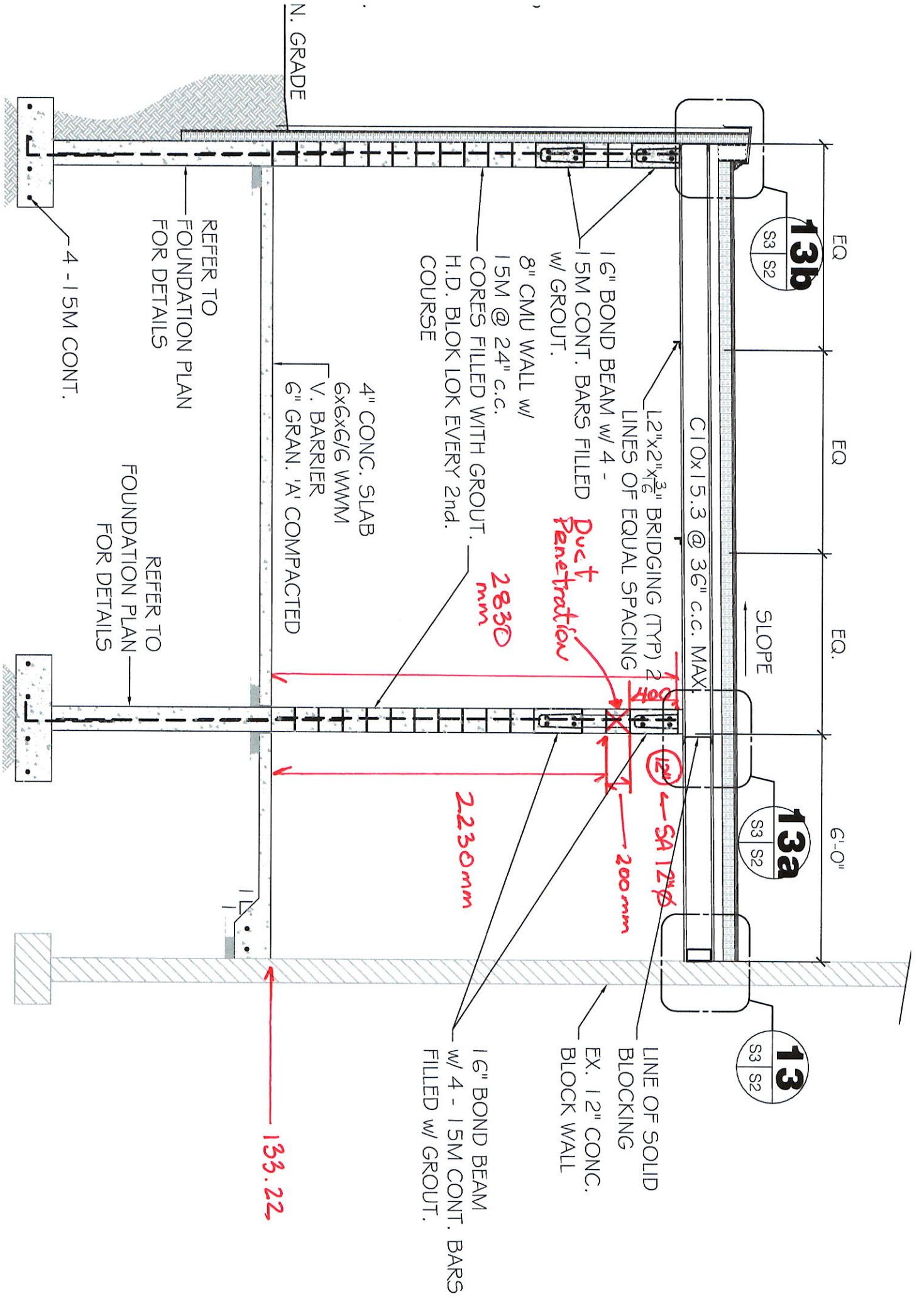

EQ

EQ

EQ

6'-0"

**13b**  
S3 S2

**13a**  
S3 S2

**13**  
S3 S2

C10x15.3 @ 36" c.c. MAX.

SLOPE

L2"x2"x3/8" BRIDGING (TYP) 2 LINES OF EQUAL SPACING

1 6" BOND BEAM w/ 4 - 1.5M CONT. BARS FILLED w/ GROUT.

1 5M CONT. BARS FILLED w/ GROUT.

8" CMU WALL w/ 15M @ 24" c.c.

CORES FILLED WITH GROUT. H.D. BLOK LOK EVERY 2nd. COURSE

4" CONC. SLAB 6x6x6/6 WMM

V. BARRIER 6" GRAN. 'A' COMPACTED

REFER TO FOUNDATION PLAN FOR DETAILS

REFER TO FOUNDATION PLAN FOR DETAILS

4 - 1.5M CONT.

N. GRADE

LINE OF SOLID BLOCKING EX. 12" CONC. BLOCK WALL

1 6" BOND BEAM w/ 4 - 1.5M CONT. BARS FILLED w/ GROUT.

1200 ← SA 12x12

200mm

2230mm

2830mm

Duct Penetration

133.22

# LARRY GAINES • ARCHITECT

Old Town Hall  
14 Bridge Street, PO 706  
Almonte, Ontario  
K0A 1A0

T: 613-256-3630  
gaines@bellnet.ca

## Site Instruction #01

**To:** Talco Building Innovations Ltd.  
4728 Bank Street, Suite A  
Ottawa, Ontario, K1T 3W7

**Project:** Carleton Place Arena  
Neelin Street

**Date:** Oct. 27, 2020

---

Site instructions are issued only for the purpose of recording any clarification or interpretation of the contract documents or giving direction on problems resulting from field conditions. These instructions are subject to the provisions of the contract documents and unless stated herein and specifically co-authorized by the Client, will not affect the contract. Should the contractor require a change in the contract price or project schedule, he shall submit to the architect within ten (10) days of the date hereof, an itemized proposal. If the proposal is accepted by the client, this site instruction will be superseded by a Change Order

---

### REFERENCES:

Site visits of Oct. 26 and 27

### GENERAL:

1. Ductwork shown in corridor on M102 is to feed into dressing rooms above bond beam between the C-channels.
2. Locate the plumbing vent stack in the corner of the corridor beside Grid Line 10 as opposed to in the adjacent shower room, as previously discussed.

**PER:** \_\_\_\_\_  
Larry Gaines  
Architect

