

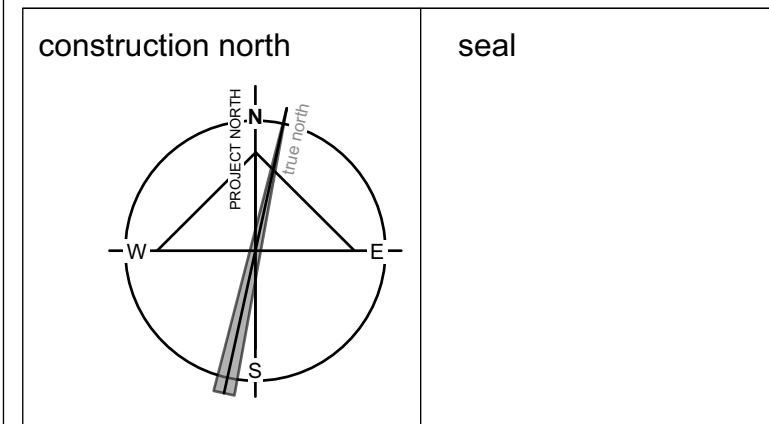

GENERAL NOTES

- All general site information and conditions compiled from existing plans, surveys and Consultant's field notes. Report all discrepancies prior to any work. No responsibility is born by the Consultant for unknown subsurface conditions.
- The location of the utilities is approximate only, and the exact location should be determined by consulting the Municipal Authorities and Utility Companies concerned. The Contractor shall prove the location of utilities and shall be responsible for adequate protection from damage.
- No tree, designated on this plan as to stay, shall be removed. Where conditions in the field affect the safety or retention of the designated tree, the Landscape Architect and Forestry Department (or Owner) are to be notified.
- Review project with Consultant and Owner prior to commencing any on site work.
- All dimensions shown are to be verified on site prior to any construction. No deviations are to be made from the layouts as shown on this plan without prior consultation with the Landscape Architect and Owner.
- Obtain approval of Consultant for subbases, base(s) and layout of all amenity areas prior to construction.
- Final subgrade is to be approved by the Consultant(s) prior to importing topsoil and sod / seeding operations.
- Maintain positive surface runoff through the entire construction period.
- Reinstate all areas and items damaged as a result of construction activities.

5		
4		
3		
2	ISSUED FOR TENDER: ADDENDUM 1	2021/06/15
1	ISSUED FOR TENDER	2021/06/04
no.	revision	date



project
**RUSSELL TOWNSHIP
RECREATION COMPLEX
PARK PROJECT**
TOWNSHIP OF RUSSELL,
ONTARIO, CANADA



drawing title
LANDSCAPE LAYOUT PLAN

scale 1:500	drawn by AA/TF
date	checked by MR
project # 20-620	drawing number L-01
RA project # 21-1633	revision

CONTRACTOR TO VERIFY ALL DIMENSIONS AND NOTIFY THE ARCHITECT OF ANY DISCREPANCIES BEFORE WORK COMMENCES.
DO NOT SCALE DRAWINGS.

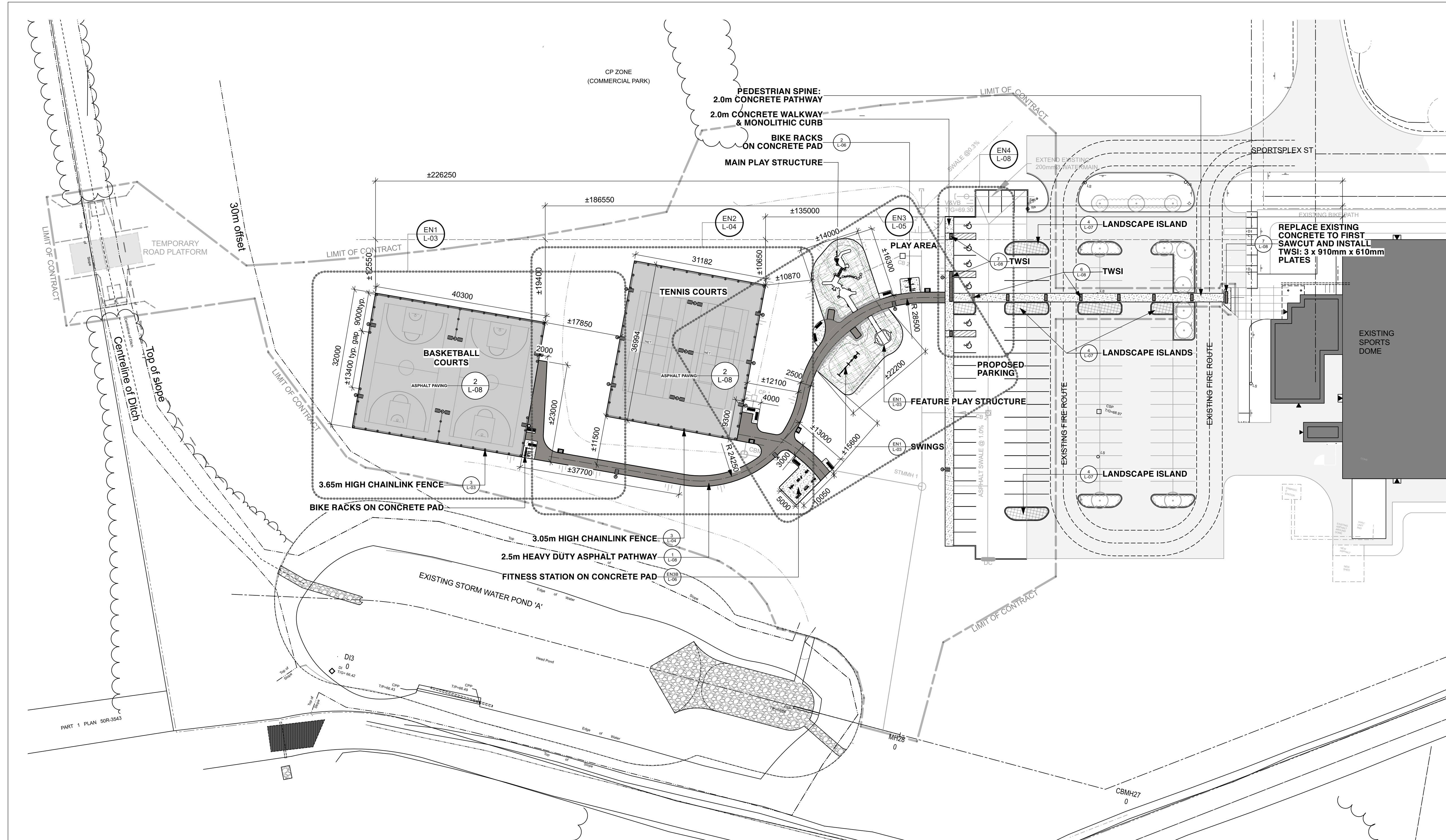

- LEGEND**
- LIMIT OF CONTRACT
 - - - - - PROPOSED CHAINLINK FENCE
 - EXISTING PARKING
 - PROPOSED PAINTED ASPHALT COURTS
 - PROPOSED EWF PLAY SURFACE
 - PROPOSED HEAVY DUTY ASPHALT PATHWAY
 - PROPOSED CONCRETE WALKWAY / PAVEMENT
 - PROPOSED LANDSCAPE ISLAND
 - PROPOSED BENCH
 - PROPOSED TRASH RECEPTACLE ON CONCRETE PAD
 - PROPOSED TWSI
 - NEW LIGHT
 - NEW ACCESSIBLE PARKING

**CONTRACT LIMITS SHOWN ARE APPROXIMATE.
REFER TO CIVIL DRAWING.**

**REFER TO A-001: SITE PLAN FOR PROJECT HOARDING
HOARDING TO SERVE AS TREE PROTECTION FENCE**



GENERAL NOTES

- 1 All general site information and conditions compiled from existing plans, surveys and Consultant's field notes. Report all discrepancies prior to any work. No responsibility is born by the Consultant for unknown subsurface conditions.
2 The location of the utilities is approximate only, and the exact location should be determined by consulting the Municipal Authorities and Utility Companies concerned. The Contractor shall prove the location of utilities and shall be responsible for adequate protection from damage.
3 No tree, designated on this plan as to stay, shall be removed. Where conditions in the field affect the safety or retention of the designated tree, the Landscape Architect and Forestry Department (or Owner) are to be notified.
4 Review project with Consultant and Owner prior to commencing any on site work.
5 Sod /seed areas: refer to details for depth of topsoil over graded sub-base / fill material. Do not use mesh. Sod shall come from an approved source and shall be laid within 24 hours of being cut in the nursery. Only nursery sod shall be used.
6 Stake planting locations and receive approval of Landscape Architect, prior to excavation of any planting pits. No substitutions of plant material shall be made without prior approval(s) of the Landscape Architect (and Planning Staff).
7 No substitutions of plant material shall be made without prior approvals of the Landscape Architect and Municipal staff.
8 Final subgrade is to be approved by the Landscape Architect prior to importing topsoil and sod being laid.
9 Maintain positive surface runoff through the entire construction period.
10 Reinststate all areas and items damaged as a result of construction activities.

Table with 3 columns: no., revision, date. Row 1: 1 ISSUED FOR TENDER: ADDENDUM 1 2021/06/15. Row 2: 2 ISSUED FOR TENDER 2021/06/04.

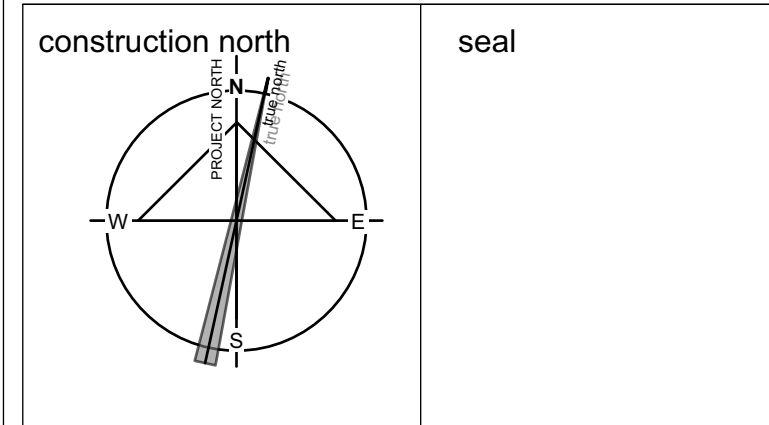

project
RUSSELL TOWNSHIP RECREATION COMPLEX PARK PROJECT
TOWNSHIP OF RUSSELL, ONTARIO, CANADA



Table with drawing title (PLANTING PLAN), scale (1:350), drawing number (L-02), and contractor verification notes.

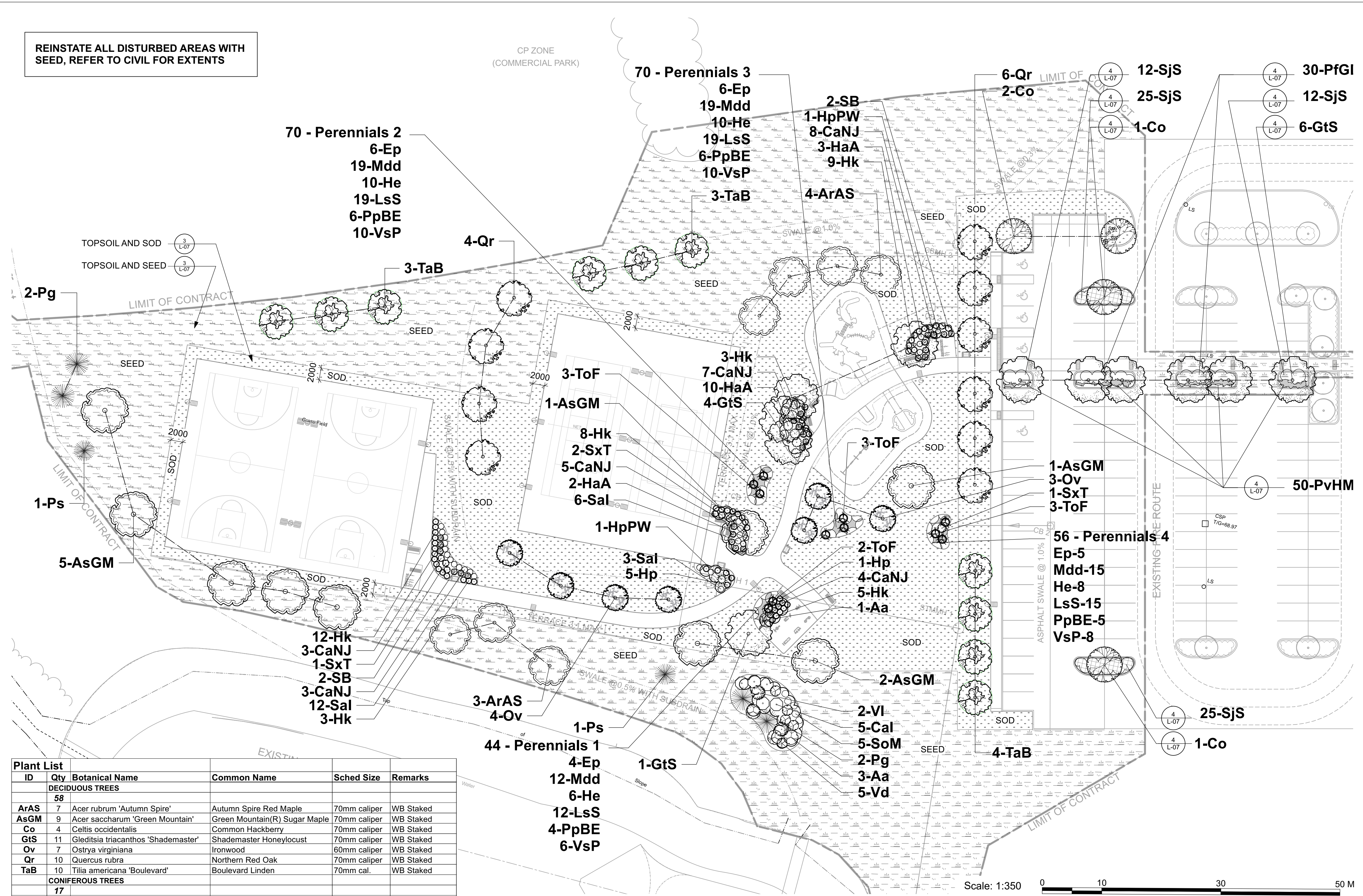

Plant List table with columns: ID, Qty, Botanical Name, Common Name, Sched Size, Remarks. Lists various trees, shrubs, and perennials with their quantities and specifications.

Scale: 1:350 0 10 30 50 M

LEGEND section defining symbols for existing trees, proposed landscape islands, trees, shrubs, grasses, flowering perennials, sod, seed, new storm drain, swale, and playground subdrain.



5		
4		
3		
2	ISSUED FOR TENDER: ADDENDUM 1	2021/06/15
1	ISSUED FOR TENDER	2021/06/04
no.	revision	date

construction north seal

project
**RUSSELL TOWNSHIP
RECREATION COMPLEX
PARK PROJECT**
TOWNSHIP OF RUSSELL,
ONTARIO, CANADA

Ruhland & Associates Ltd
landscape architecture • urban design • site planning
Ph 613-224-4244 Fx 613-224-1131 info@rala.ca www.rala.ca

drawing title BASKETBALL COURTS ENLARGEMENTS AND DETAILS	
scale	drawn by AATF
date	checked by MR
project # 20-620	drawing number L-03
RA project # 21-1633	revision
CONTRACTOR TO VERIFY ALL DIMENSIONS AND NOTIFY THE ARCHITECT OF ANY DISCREPANCIES BEFORE WORK COMMENCES. DO NOT SCALE DRAWINGS.	

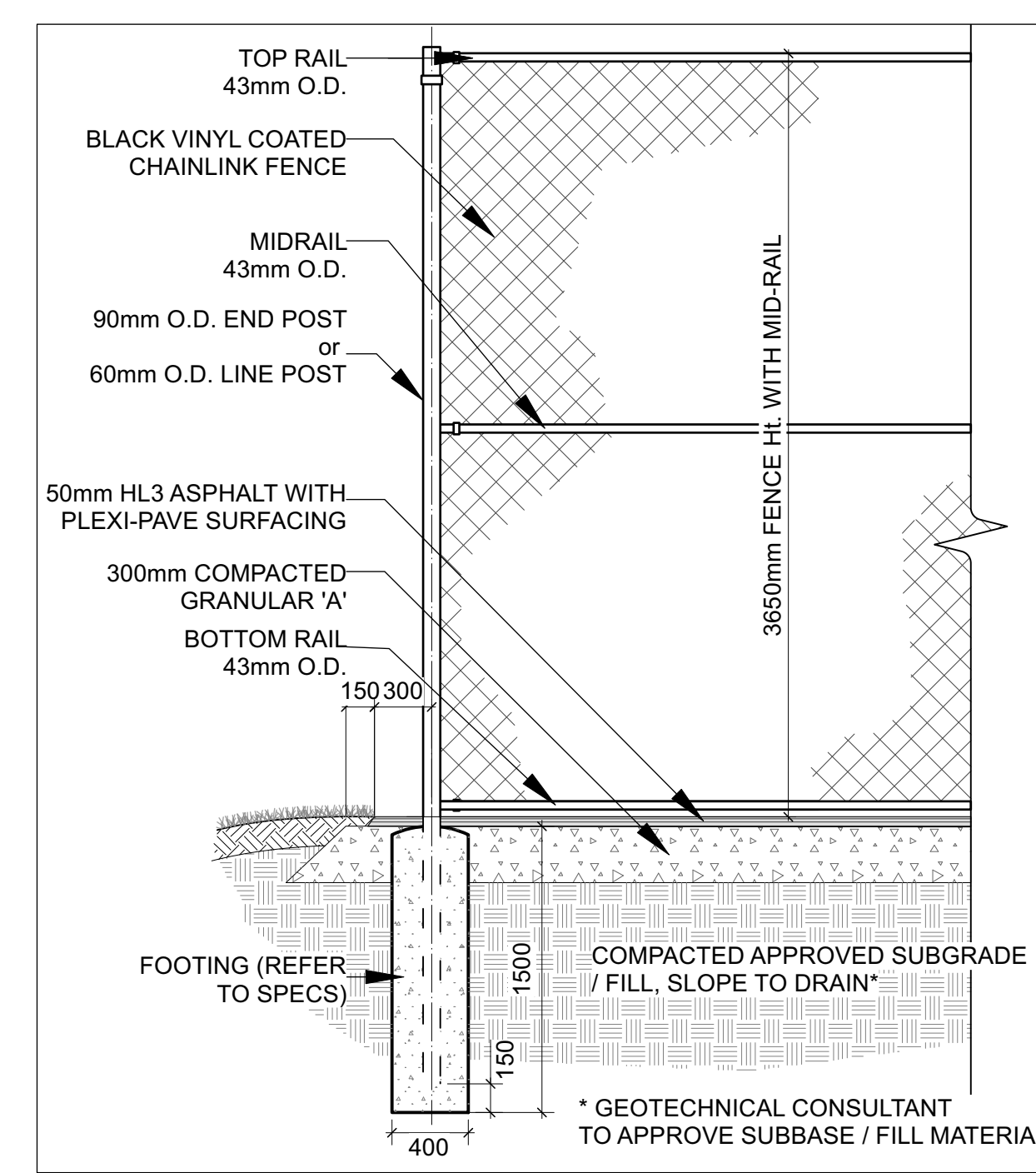
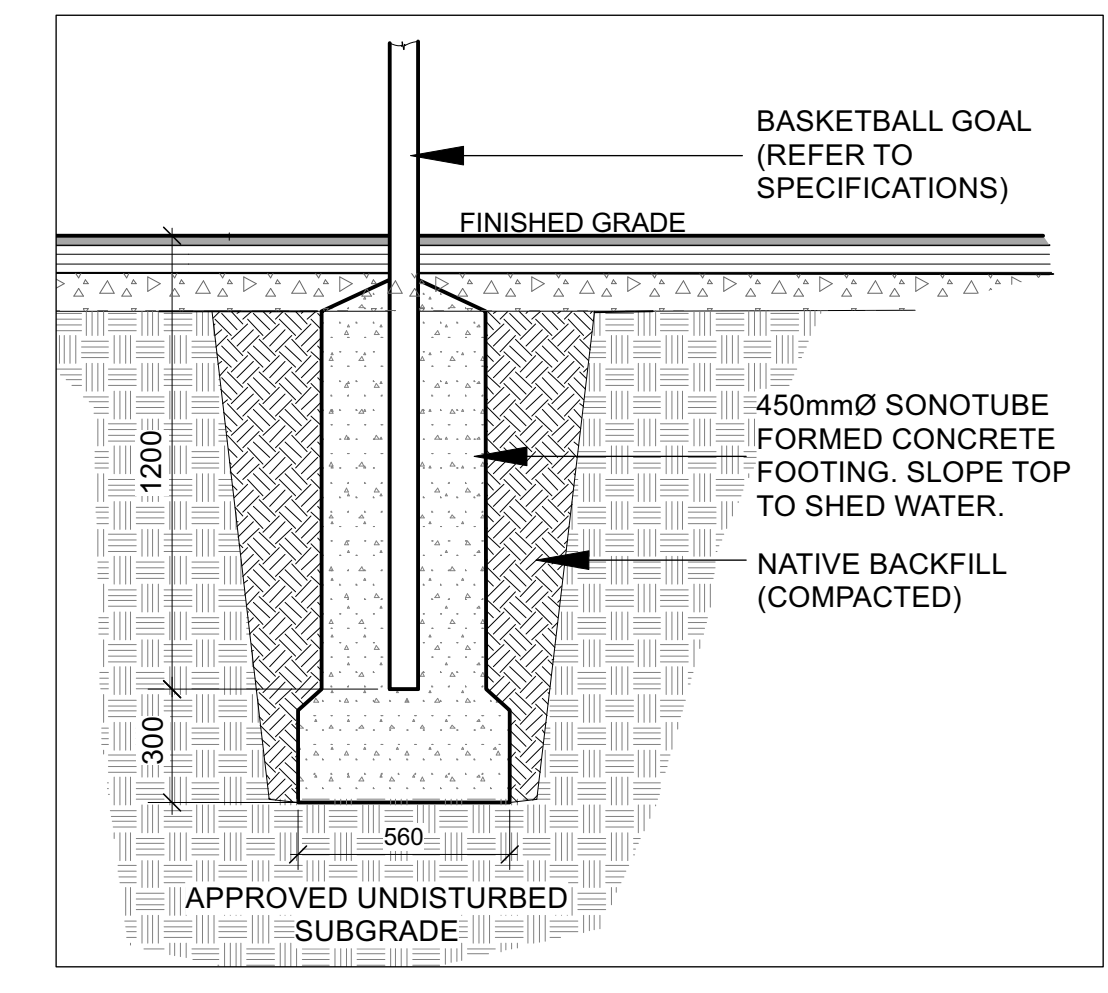
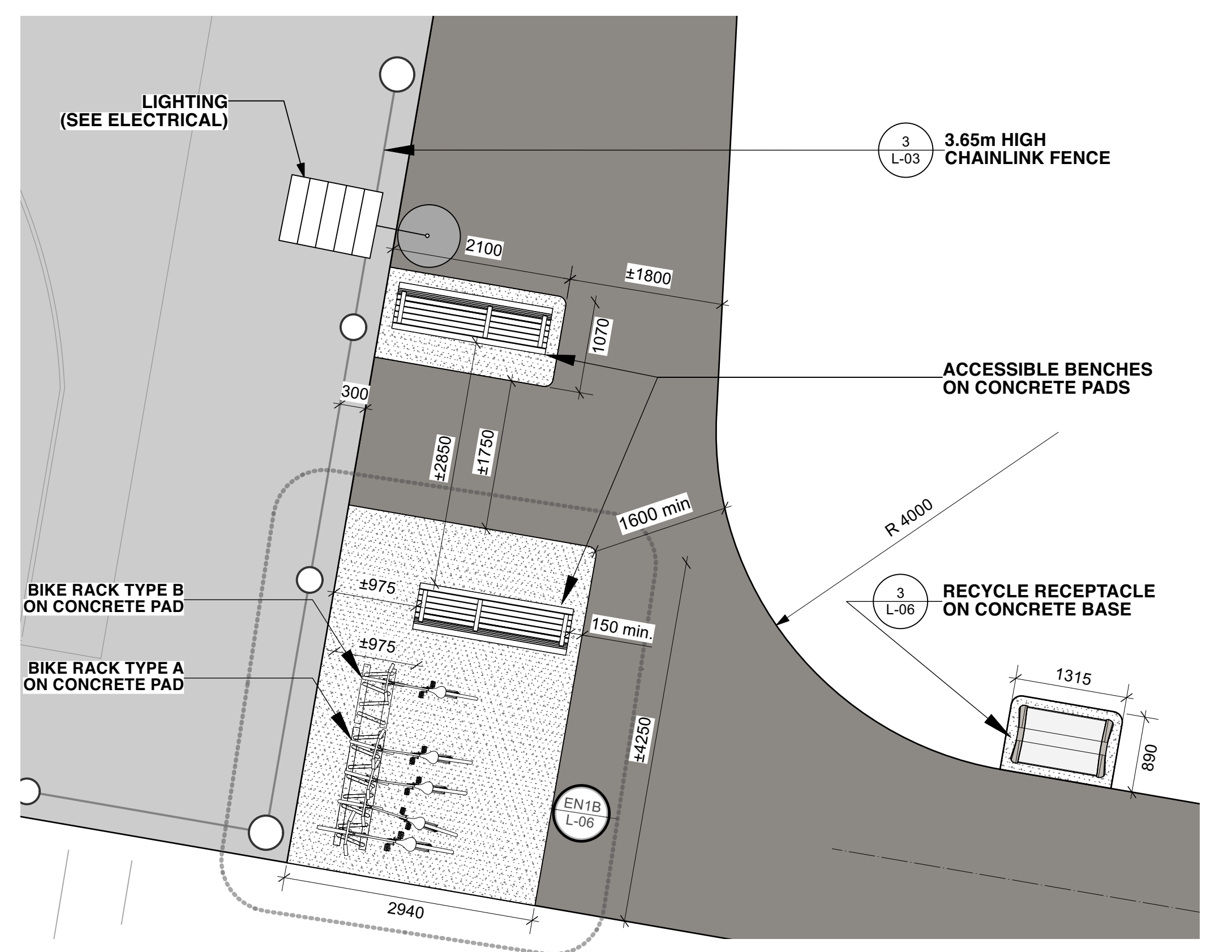
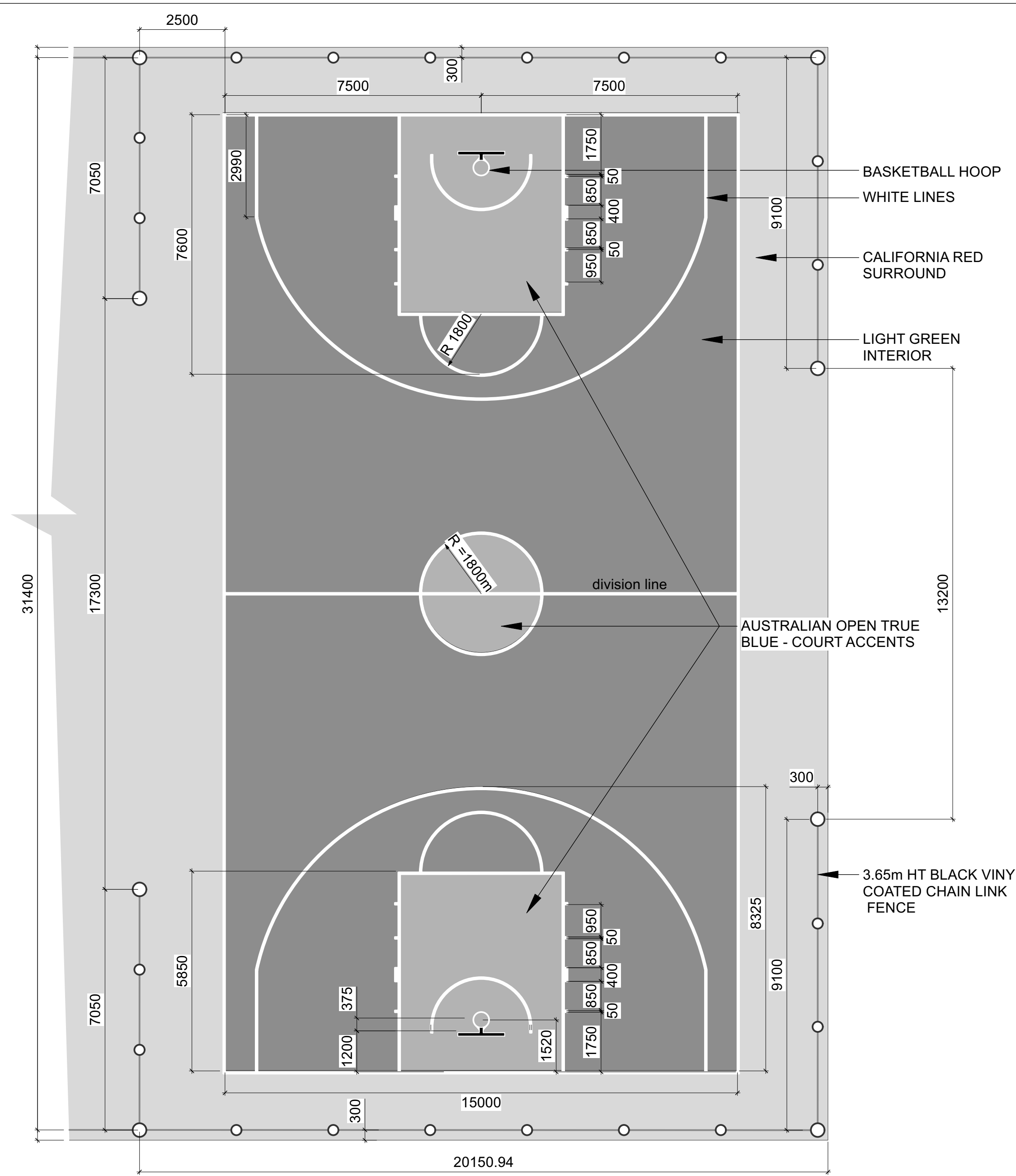
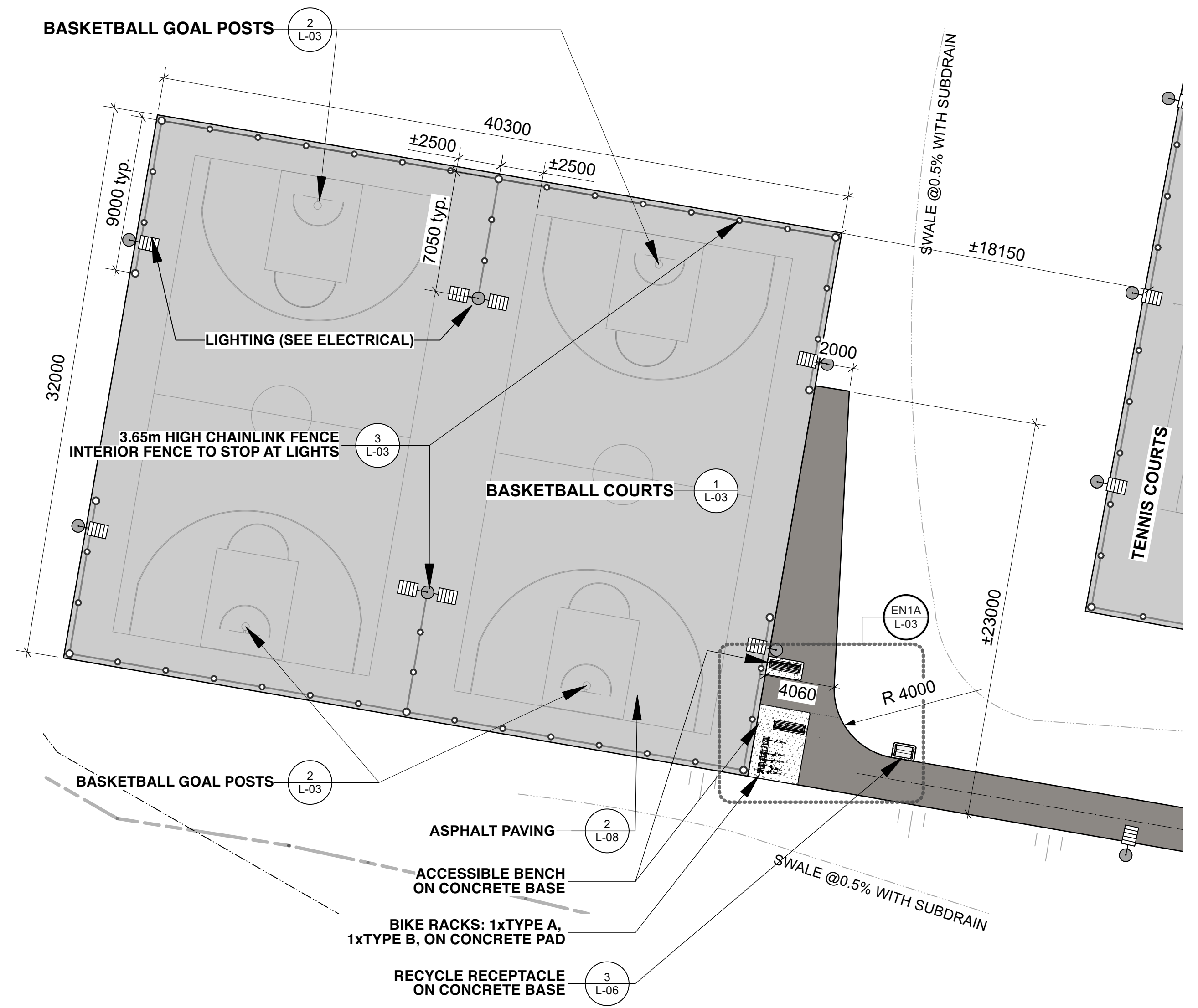

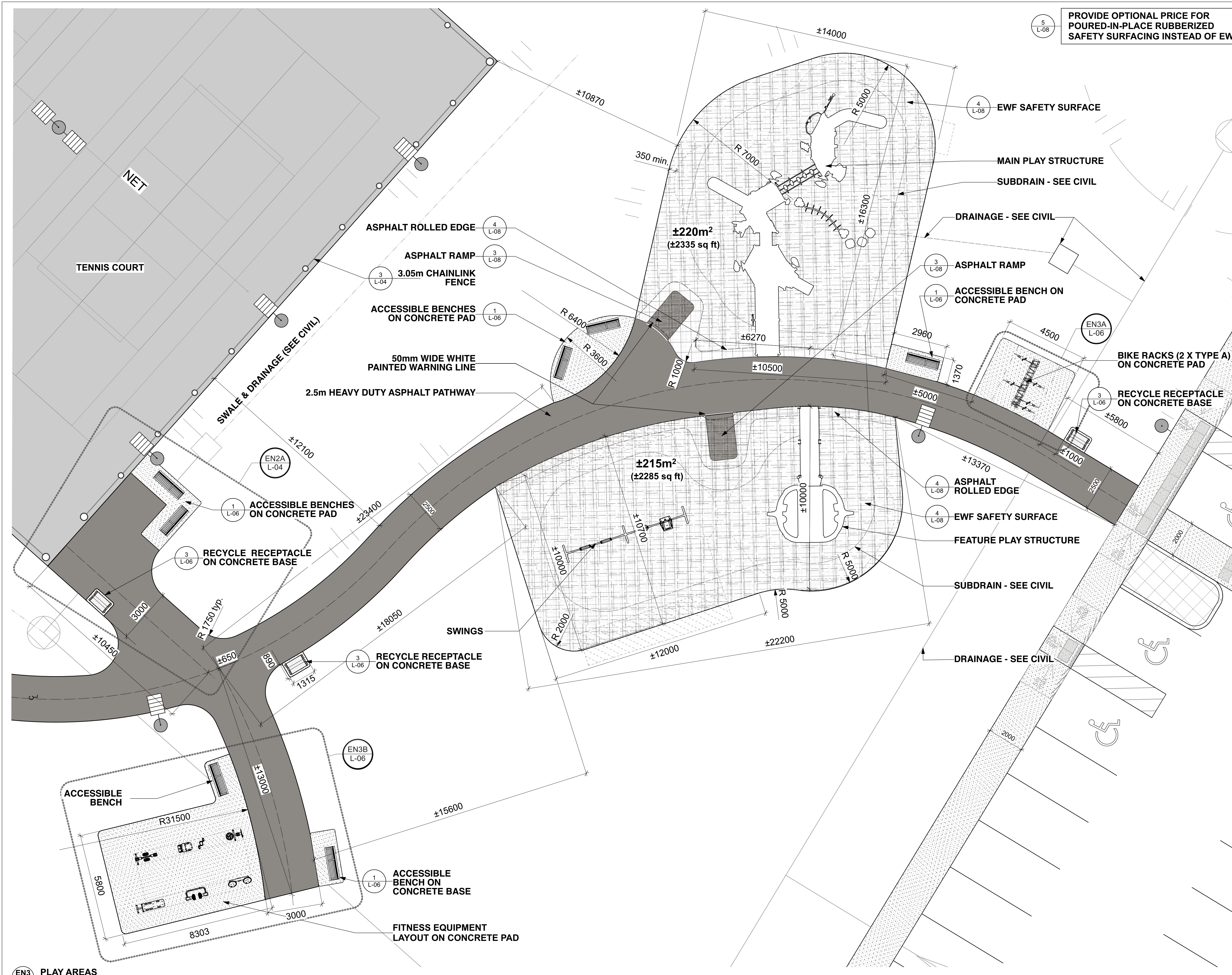

5 L-08 PROVIDE OPTIONAL PRICE FOR
POURED-IN-PLACE RUBBERIZED
SAFETY SURFACING INSTEAD OF EWF.

5		
4		
3		
2	ISSUED FOR TENDER: ADDENDUM 1	2021/06/15
1	ISSUED FOR TENDER	2021/06/04
no.	revision	date

construction north	seal

project
**RUSSELL TOWNSHIP
RECREATION COMPLEX
PARK PROJECT**
TOWNSHIP OF RUSSELL,
ONTARIO, CANADA

Ruhland & Associates Ltd
landscape architecture • urban design • site planning
Ph 613-224-4244 Fx 613-224-1111 info@rala.ca www.rala.ca

drawing title
**PLAY / EXERCISE
EQUIPMENT ENLARGEMENT**

scale	drawn by AA/TF
date	checked by MR
project # 20-620	drawing number L-05
RA project # 21-1633	revision

CONTRACTOR TO VERIFY ALL DIMENSIONS AND
NOTIFY THE ARCHITECT OF ANY DISCREPANCIES
BEFORE WORK COMMENCES.
DO NOT SCALE DRAWINGS.

EN3 L-05 PLAY AREAS Scale: 1:100

NOTE:
PLAY AREAS MAY REQUIRE ADJUSTMENT ON SITE TO MEET SAFETY SURFACE REQUIREMENTS. ENSURE ALL MINIMUM CLEARANCE DISTANCES ARE MET.
COORDINATE WITH PLAY GROUND INSTALLER. REFER TO SPECIFICATIONS FOR INDEPENDENT PLAYGROUND INSPECTION PROCEDURES AND TIMES.

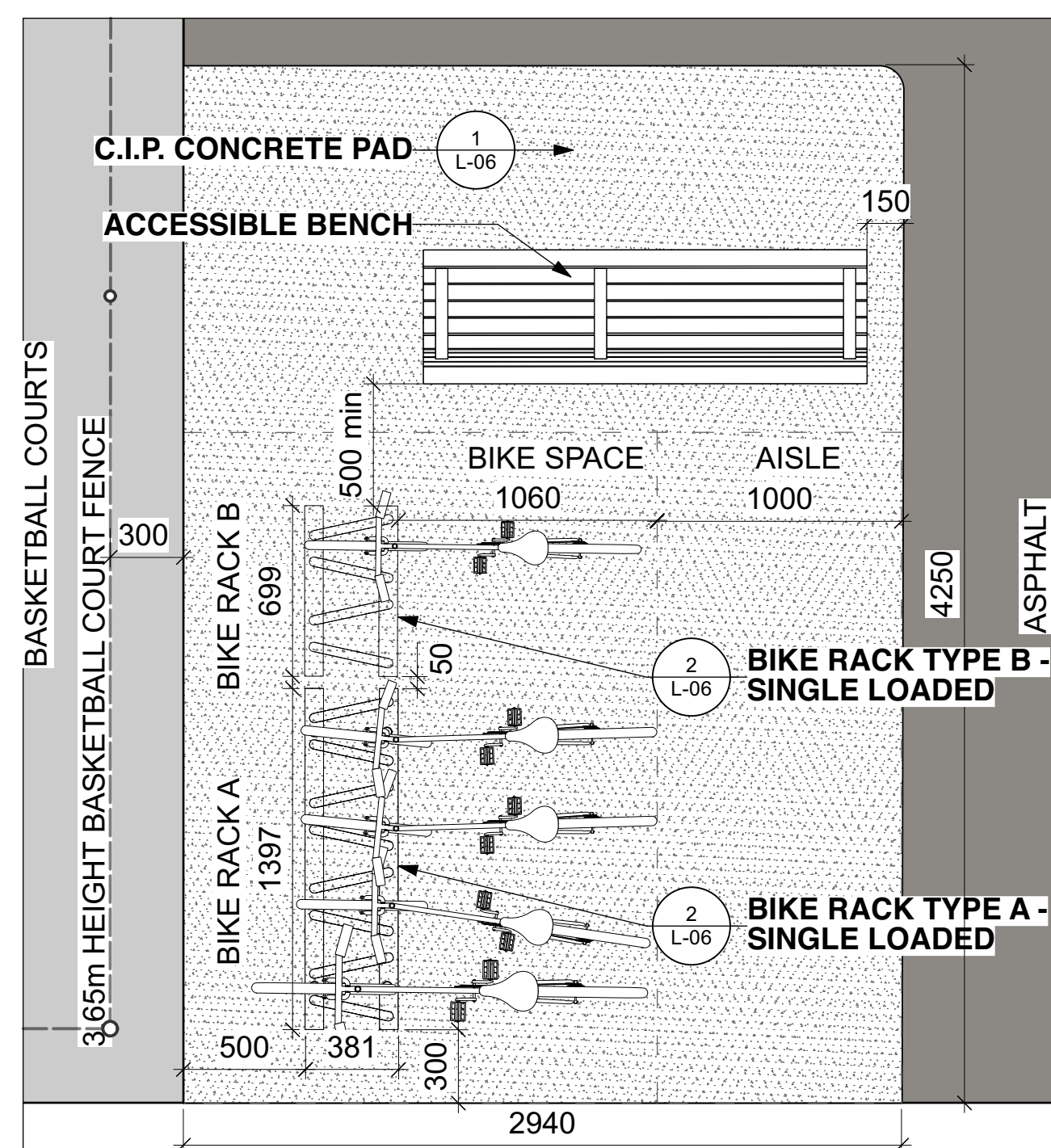

EN1B BIKE RACK LAYOUT AT BASKETBALL COURT
Scale: 1:25

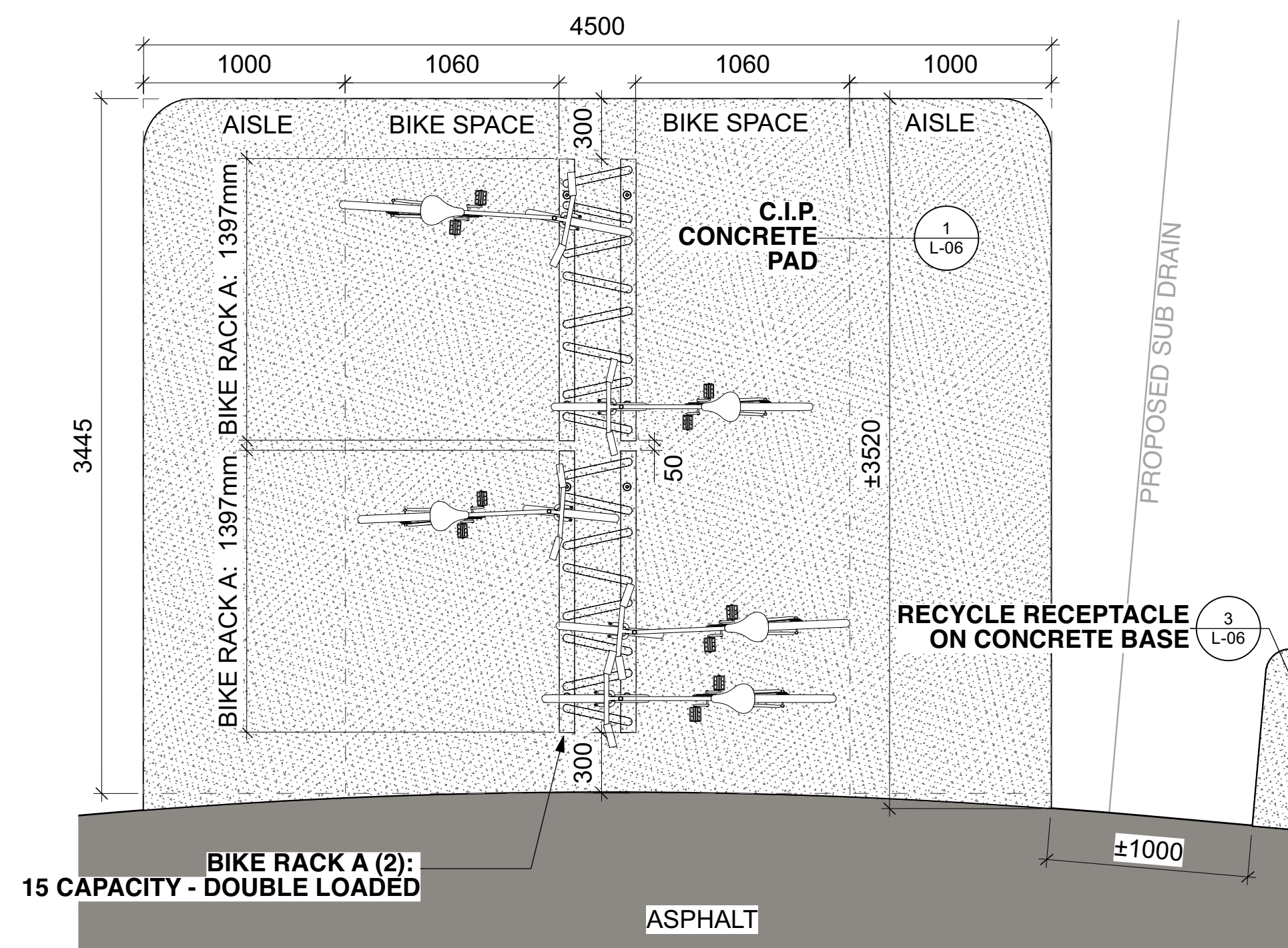

EN3A BIKE RACK LAYOUT AT PLAY AREA
Scale: 1:25

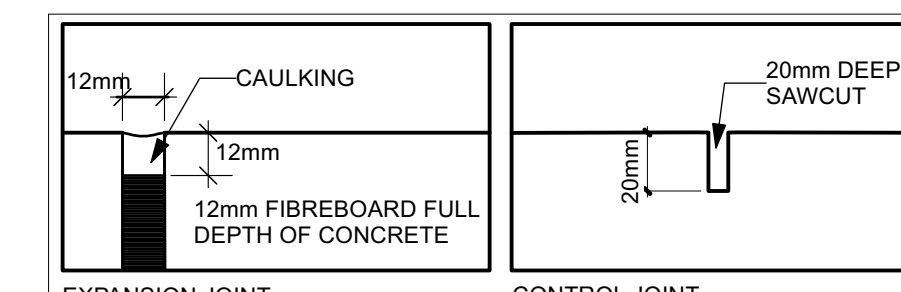

JOINTS:
 - SAWCUT CONTROL JOINTS AND EXPANSION JOINTS AS DETAILED.
 - ONLY TOOL EDGES AT BUILDINGS.
 - EXPANSION JOINTS TO BE SPACED AT 6m o.c. max.
 - CONTROL JOINTS TO BE SPACED AT 1.5m o.c. max.

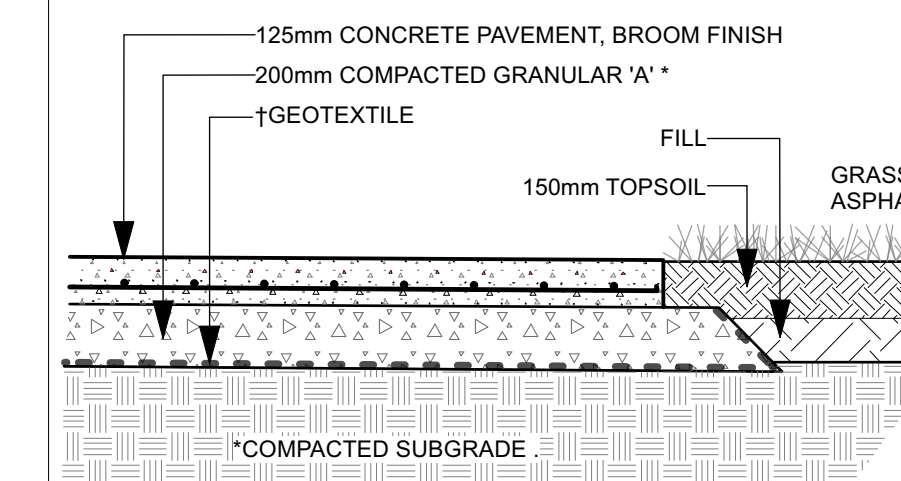

CONCRETE:
 - CONCRETE TO BE CLASS C-2 (32MPa, AIR 5-8%, TYPE 10 CEMENT, SLUMP 80mm WITH A TOLERANCE OF ±30mm).
 - AGGREGATE SIZE 20mm.

↑ USE OF GEOTEXTILE IF REQUIRED BY GEOTECHNICAL ENGINEER
 * GEOTECHNICAL CONSULTANT TO APPROVE SUBBASE / FILL MATERIAL

1 REINFORCED CONCRETE PAD: AMENITY SPACES / WASTE AND RECYCLING BINS
 Scale: NTS

REINFORCEMENT: 150 x 150mm GAUGE 6 WELDED WIRE MESH, MINIMUM 50mm FROM EDGE.

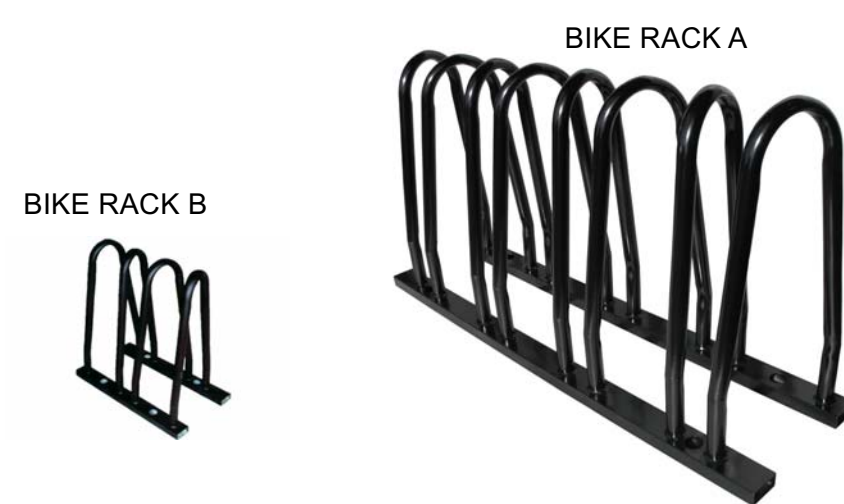

EP 5911 Bike rack

SPECIFICATIONS

Frame: Steel tubular
 Finish: Hot-dipped galvanized

AVAILABLE

5911-7 7 bikes rack 1397mm (55")
 5911-3 3 bikes rack 699mm (27 1/2")

OPTION

GP Galvanized and painted frame

Depth : 381mm (15") Length : 699mm (27 1/2") Height : 737mm (29") Weight : 18 kg (40 lbs)
 Depth : 381mm (15") Length : 1397mm (55") Height : 737mm (29") Weight : 32 kg (70 lbs)

This bike rack must be anchored.
 Our warranty applies when our product is properly assembled and anchored.

CONCRETE SLABS AND ANCHORS

7009 1 slab 483mm X 1397mm X 152mm (19" X 55" X 6")
 7028 2 slab 305mm X 711mm X 152mm (12" X 28" X 6")
 QS 4 stainless steel kwik bolts
 QAV 4 drop-in anchors with stainless steel theftproof bolts

Confidential information contained herein is the property of Equiparc. Intended use is limited to professionals specifying Equiparc's products and their direct clients. All information is not to be copied or disclosed to others without the written consent of Equiparc. All rights reserved - Equiparc Manufacturier d'Equipement de Parcs

T: 1 800 363 9264 www.equiparc.com 1001, rue James-Brodie
 F: 1 866 346 2538 info@equiparc.com Saint-Jean-sur-Richelieu, QC Canada J2X 0C1

2 BIKE RACKS A & B
 Scale: NTS

PROVIDE SHOP DRAWINGS FOR APPROVAL

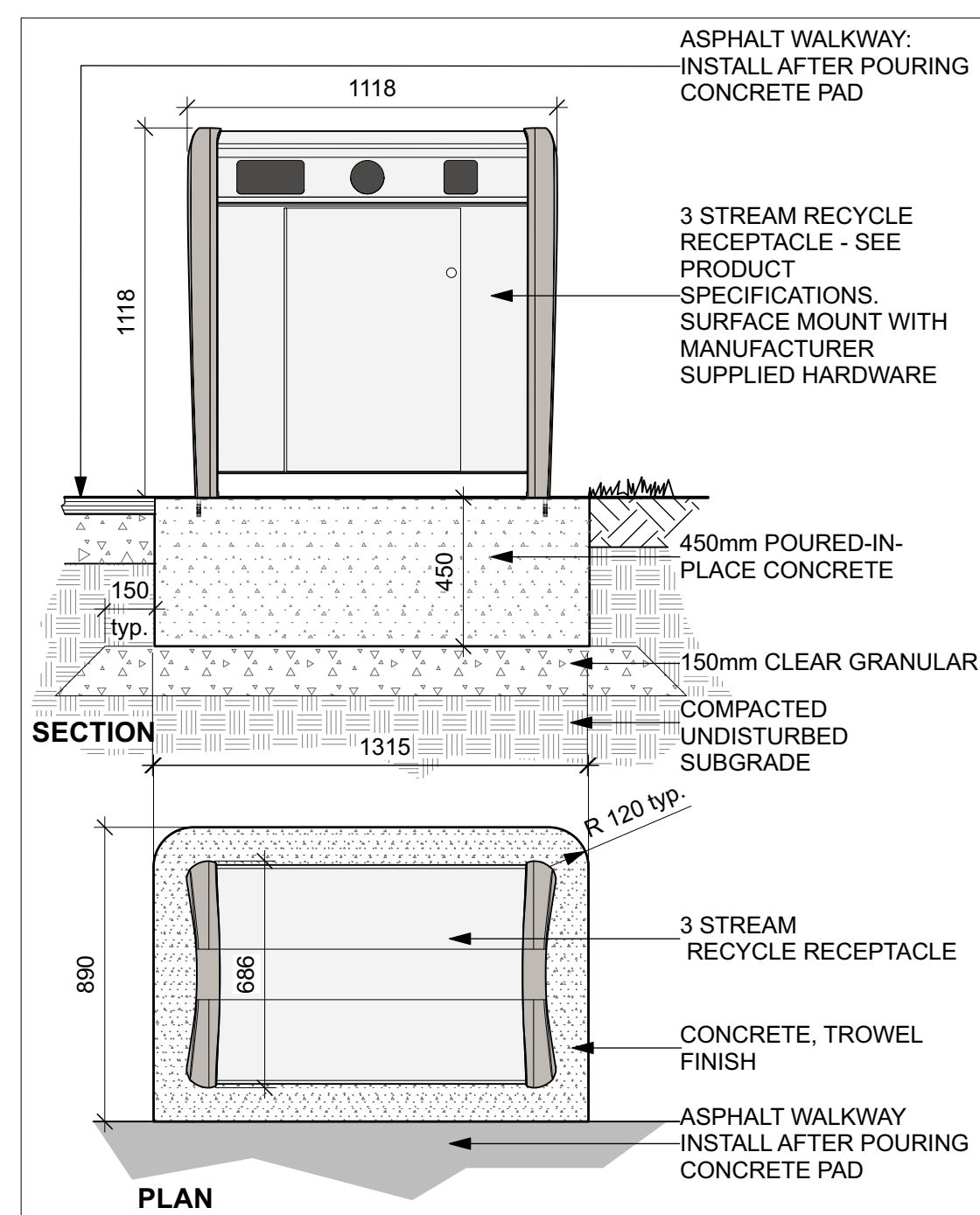

3 RECYCLE RECEPTACLE & BASE
 Scale: 1:20

PROVIDE SHOP DRAWINGS, INCLUDING ANCHORAGE, FOR APPROVAL

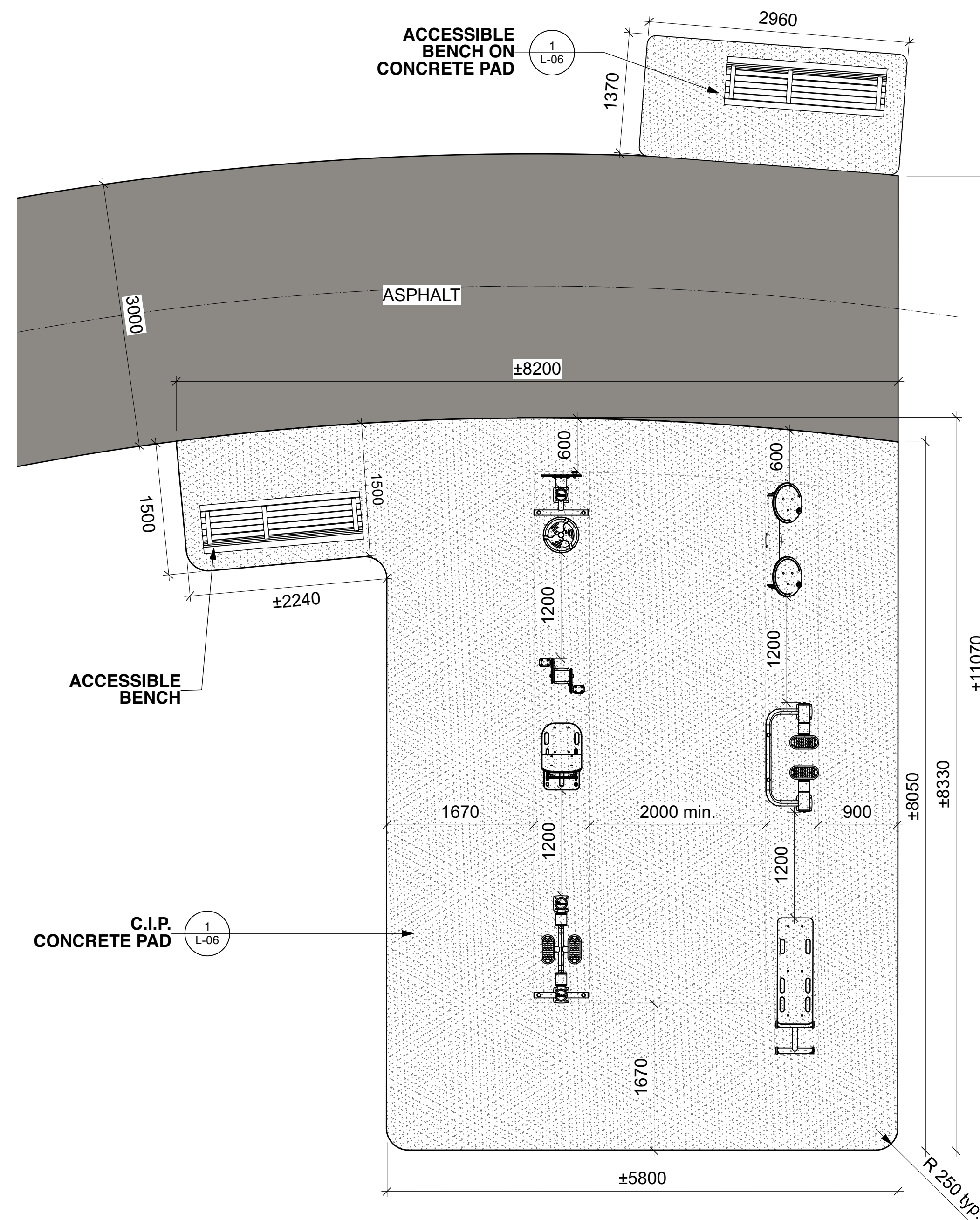

EN3B FITNESS EQUIPMENT LAYOUT
 Scale: 1:40

5		
4		
3		
2	ISSUED FOR TENDER: ADDENDUM 1	2021/06/15
1	ISSUED FOR TENDER	2021/06/04
no.	revision	date

construction north	seal
--------------------	------

project
RUSSELL TOWNSHIP RECREATION COMPLEX PARK PROJECT
 TOWNSHIP OF RUSSELL, ONTARIO, CANADA

Ruhland & Associates Ltd
 landscape architecture • urban design • site planning
 Ph: 613-224-4244 Fx: 613-224-1311 info@rala.ca www.rala.ca

drawing title **BIKE RACK, FITNESS EQUIPMENT LAYOUTS AND DETAILS**

scale **AS SHOWN** drawn by **AA/TF**

date checked by **MR**

project # **20-620** drawing number

RA project # **21-1633** **L-06**

CONTRACTOR TO VERIFY ALL DIMENSIONS AND NOTIFY THE ARCHITECT OF ANY DISCREPANCIES BEFORE WORK COMMENCES.
 DO NOT SCALE DRAWINGS.

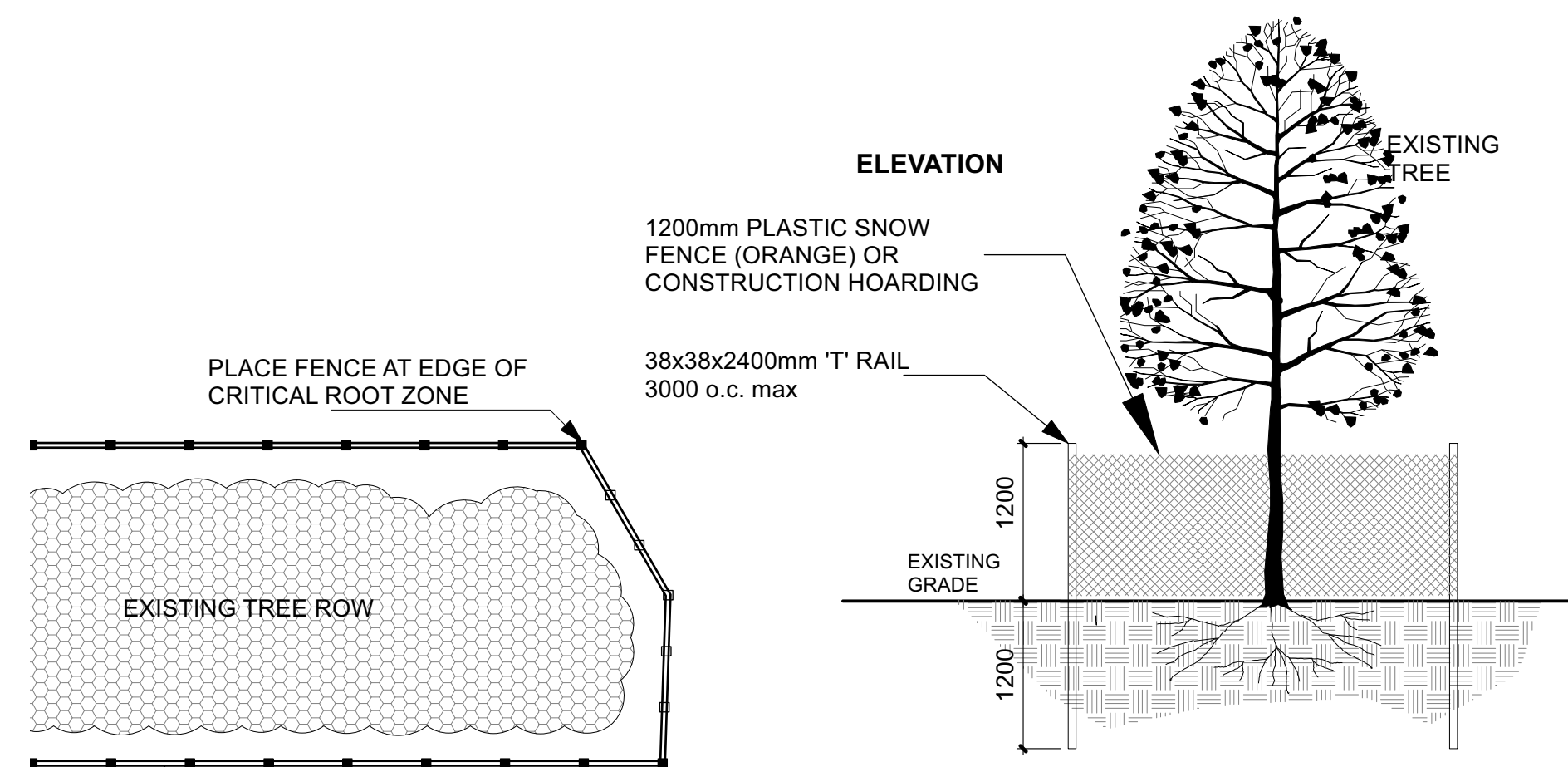

- CONTRACTORS WORKING NEAR TREES MUST:**
- ERECT A FENCE AT THE CRITICAL ROOT ZONE (CRZ) OF TREES;
 - NOT PLACE ANY MATERIAL OR EQUIPMENT WITHIN THE CRZ OF THE TREE;
 - NOT ATTACH ANY SIGNS, NOTICES OR POSTERS TO ANY TREE;
 - NOT RAISE OR LOWER THE EXISTING GRADE WITHIN THE CRZ WITHOUT APPROVAL;
 - TUNNEL OR BORE WHEN DIGGING WITHIN THE CRZ OF A TREE;
 - NOT DAMAGE THE ROOT SYSTEM, TRUNK OR BRANCHES OF ANY TREE;
 - ENSURE THAT EXHAUST FUMES FROM ALL EQUIPMENT ARE NOT DIRECTED TOWARDS ANY TREE'S CANOPY.

- NOTES:**
1. PROVIDE PROTECTION FOR TREES SHOWN AS REQUIRING PROTECTION ON CONTRACT DRAWINGS USING METHOD SHOWN. WHERE OPERATIONS THREATEN OTHER NEARBY TREES, APPLY SAME MEASURES.
 2. PROTECT ROOTS OF ALL TREES AS SHOWN ABOVE. NO EXCAVATION, FILLING, STORAGE OF MATERIALS, DISPOSAL OF CHEMICALS, VEHICLE TRAFFIC, OR OTHER ACTIVITY WHICH COULD CAUSE DISTURBANCE OF SOIL ROOT AREA, INCLUDING SOIL COMPACTION SHALL TAKE PLACE WITHIN THE PROTECTED AREA.

CRITICAL ROOT ZONE (CRZ) OF A TREE: ϕ (DIAMETER) OF TRUNK IN cm X 10cm = CRZ. THE CRZ IS ESTABLISHED AS BEING 10cm FROM THE TRUNK OF A TREE FOR EVERY cm OF TRUNK DIAMETER. THE TRUNK DIAMETER IS MEASURED AT A HEIGHT OF 1.2m FOR TREES OF 15cm ϕ AND GREATER AND AT A HEIGHT OF 0.3m FOR TREES OF LESS THAN 15cm ϕ . THE CONTRACTOR MUST OBTAIN ALL PERMITS AND APPROVALS PRIOR TO THE START OF CONSTRUCTION. THE CONTRACTOR MUST CALL A MUNICIPAL TREE INSPECTOR WHEN WORK IS REQUIRED NEAR A MUNICIPAL TREE.

1 TREE PROTECTION FENCE
Scale: NTS

- A COMPACTED PLANTING MEDIUM
- B ROOTBALL, TOP OF ROOT CROWN TO BE FLUSH WITH PLANTING SOIL AND 50mm ABOVE SOIL OUTSIDE PLANTING PIT
- C LOOSEN PIT BOTTOM TO DEPTH OF 200mm (EXCEPT IMMEDIATELY BENEATH ROOT BALL). IF BASE OF PIT IS OVER EXCAVATED RAISE TO PROPER LEVEL WITH COMPACTED TOPSOIL
- D EDGE TO DEPTH OF 100mm
- E 50-75 mm MULCH LAYER, KEEP MULCH AWAY FROM STEMS
- F PRUNE DAMAGE, DISEASED OR WEAK BRANCHES AS PER ACCEPTED HORTICULTURAL PRACTICE. DO NOT DAMAGE OR REMOVE LEADER
- G PROVIDE 150 mm DEEP SAUCER AT TREES
- H PROVIDE IRRIGATION COMPONENTS FOR TREES WITHIN IRRIGATION ZONES ONLY. REFER TO E2, L02

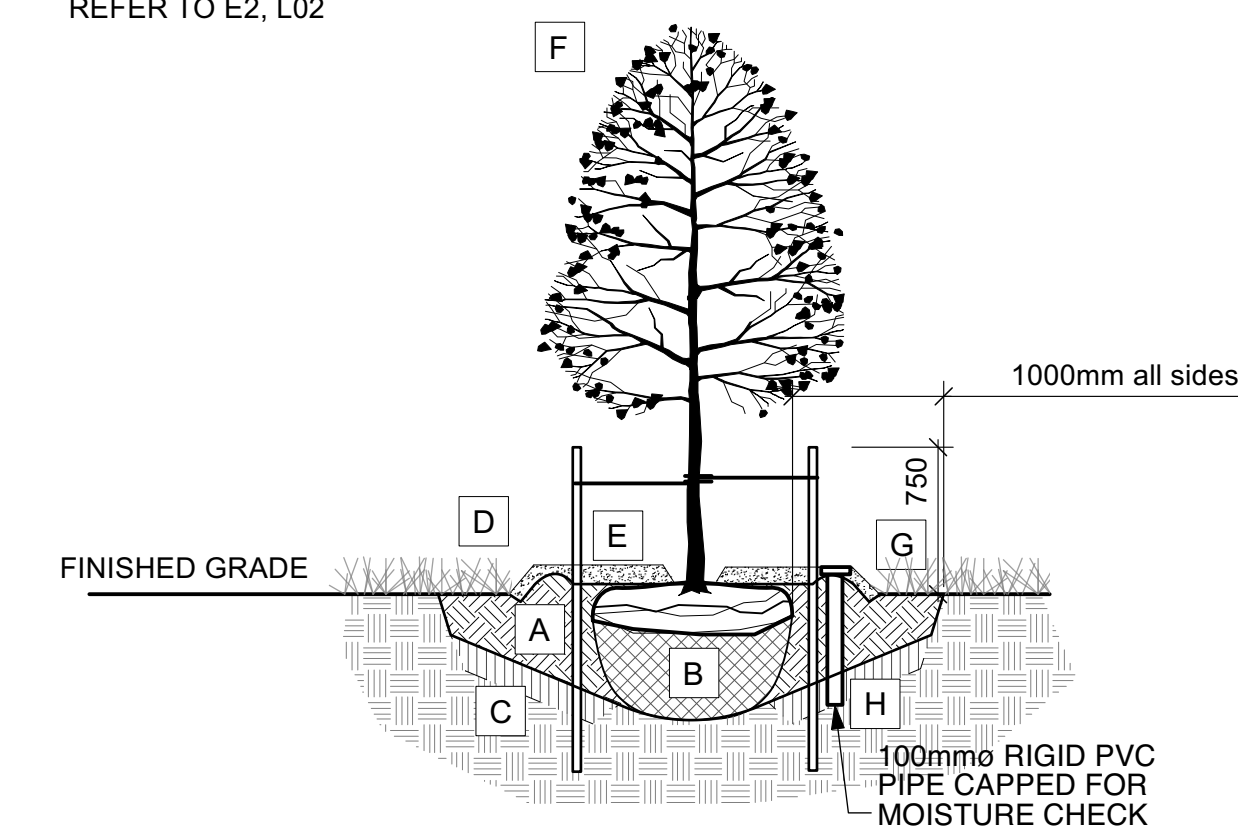

- TREE PLANTING:**
1. CUT AND REMOVE TOP 1/3 OF BURLAP AND WIRE BASKET FROM ROOTBALL.
 2. PLACE 2-METAL POSTS (40 x 40 x 2100 mm) AT OUTSIDE OF ROOTBALL AND FASTEN TO TRUNK WITH APPROVED TREE TIES.
 3. WATER THOROUGHLY SUBSEQUENT TO PLANTING.
 4. WRAP TREE TRUNK AFTER INSPECTION OF TREES BY LANDSCAPE ARCHITECT.
 5. PROTECT TREE FROM RODENT DAMAGE.
 6. REMOVE TREE RINGS, STAKES AND TRUNK WRAPPING AFTER WARRANTY PERIOD.

5 TREE PLANTING
Scale: NTS

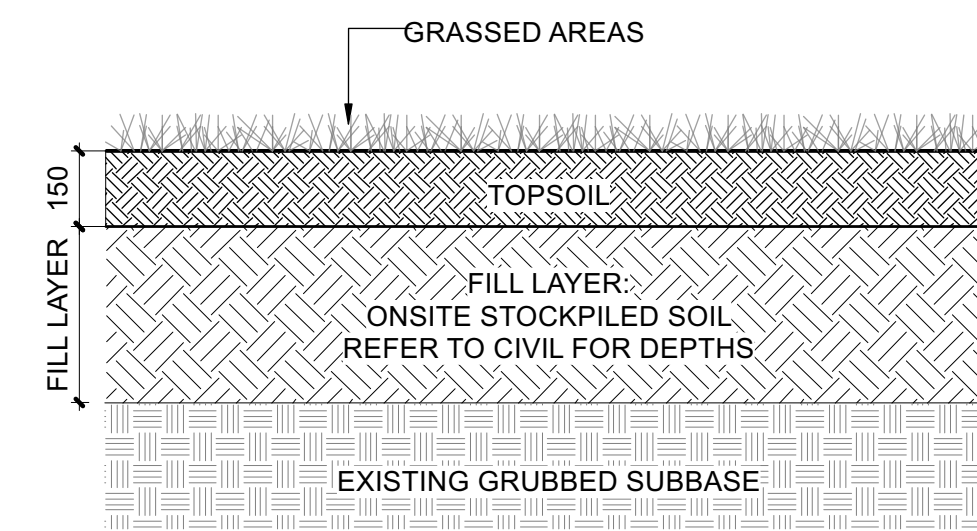

3 GRASSED AREA SOIL PROFILE
Scale: NTS

- Bed Preparation**
1. EXCAVATE OR PLACE FILL FOR PLANTING BED TO PROVIDE 450mm MINIMUM DEPTH OF PLANTING MEDIUM. PLANTING BED TO BE DEEPENED AT TREE LOCATIONS. IF BASE OF PIT IS OVER EXCAVATED, RAISE BOTTOM TO PROPER LEVEL WITH COMPACTED PLANTING MEDIUM.
 2. PLACE 150mm PLANTING MEDIUM ON SUBGRADE AND CULTIVATE INTO TOP 200mm OF SUBSOIL. SEE NOTE BELOW.
 3. PLACE REMAINDER OF PLANTING MEDIUM OVER CULTIVATED PORTION TO ACHIEVE FINAL GRADE.
 4. CENTRE OF BED TO BE CROWNED ABOVE ADJACENT GRADE TO APPROVAL OF CONSULTANT.
 5. ENSURE POSITIVE DRAINAGE AWAY FROM BUILDING WALLS WHERE APPLICABLE.

- A 450mm COMPACTED PLANTING MEDIUM, DEEPEN AT TREES
- B ROOTBALL, TOP OF ROOT CROWN TO BE FLUSH WITH PLANTING SOIL AND 50mm ABOVE SOIL OUTSIDE PLANTING PIT / POT
- C 350mm PLANTING MEDIUM / SUBSOIL CULTIVATED LAYER. CULTIVATE AT TREE PIT BOTTOM. SEE NOTE BELOW.
- D EDGE TO DEPTH OF 100mm
- E 50-75 mm MULCH LAYER, KEEP MULCH AWAY FROM STEMS
- F FIRST ROW OF PERENNIALS TO BE PLANTED 600mm FROM EDGE OF BED/CURB FIRST ROW OF SHRUBS TO BE PLANTED 900mm FROM EDGE OF BED/CURB
- G PRUNE DAMAGED, DISEASED OR WEAK BRANCHES AS PER ACCEPTED HORTICULTURAL PRACTICE. DO NOT DAMAGE OR REMOVE LEADER
- H PROVIDE 150 mm DEEP SAUCER AT TREES

6 PLANTING BED ON GRADE
Scale: NTS

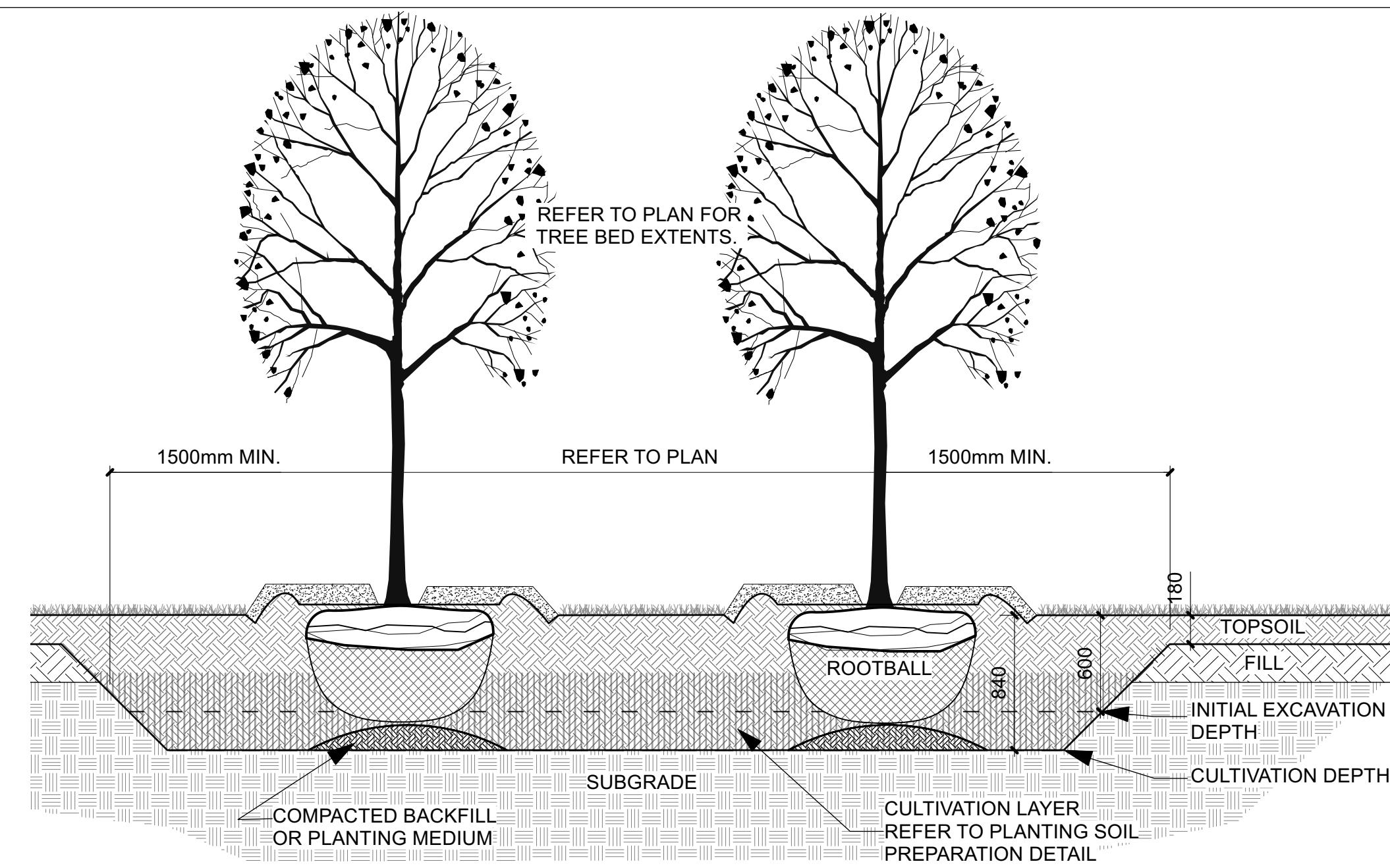

1. PREPARE ROUGH GRADE OF PLANT BEDS TO THE FOLLOWING DEPTHS BELOW FINISHED GRADE:
 - SHRUB BEDS: 200mm
 - TREE PLANT BEDS: 500mm
2. PLACE 200mm PLANTING MEDIUM (COMPACTED DEPTH) AND CULTIVATE INTO SUBGRADE TO A DEPTH OF 200mm PROVIDING A CULTIVATED SOIL LAYER DEPTH OF 400mm.
3. PLACE PLANTING MEDIUM OVER CULTIVATED SOIL LAYER TO COMPACTED DEPTHS OF:
 - SHRUB BEDS: 100mm (TOTAL 500mm PLANTING BED DEPTH)
 - TREE PLANT BEDS: 350mm (TOTAL 750mm PLANTING BED DEPTH)

2 TREE PLANTING IN AUGMENTED SOIL
Scale: NTS

- A PRUNE DAMAGE, DISEASED OR WEAK BRANCHES AS PER ACCEPTED HORTICULTURAL PRACTICE. DO NOT DAMAGE OR REMOVE LEADER
- B 2-METAL POSTS (40x 40x 2100 mm) PLACE AT OUTSIDE OF ROOTBALL AND FASTEN TO TRUNK WITH 3 mm ϕ GALVANIZED WIRE AND 25 mm ϕ 2 PLY REINFORCED HOSE (PARALLEL TO CURB)
- C FIRST ROW OF PERENNIALS TO BE PLANTED 600mm MINIMUM FROM FRONT OF CURB (AT TREE LOCATIONS, 900mm ELSEWHERE).
- D 50-75 mm MULCH LAYER, KEEP MULCH AWAY FROM STEMS AND PROVIDE 100mm DEEP SAUCER.
- E TOP OF ROOT CROWN TO BE FLUSH WITH PLANTING SOIL
- F SUBSOIL / SUBGRADE CULTIVATED LAYER
- G PLANTING MEDIUM
- H ROOTBALL / POT

Bed Preparation

1. EXCAVATE OR PLACE FILL FOR PLANTING BED TO PROVIDE 750mm MINIMUM DEPTH OF PLANTING MEDIUM AND 300mm DEPTH SUBSOIL (CONTINUOUS BETWEEN TREES). CULTIVATE PLANTING SUBSOIL INTO SUBGRADE TO A DEPTH OF 150mm.
2. PLACE COMPACTED PLANTING MEDIUM ON SUBSOIL TO ACHIEVE FINAL GRADE.
3. CENTRE OF BED TO BE CROWNED ABOVE ADJACENT GRADE TO APPROVAL OF CONSULTANT.

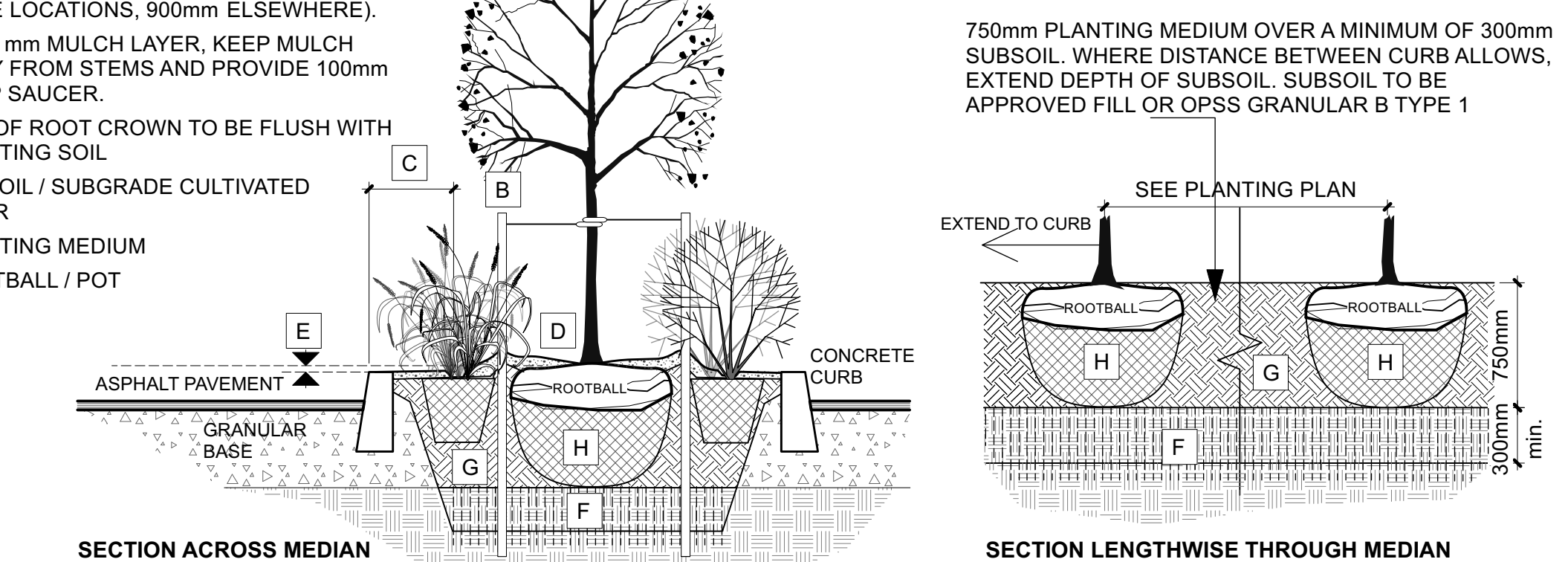

4 TREE PLANTING IN PARKING LOT ISLANDS
Scale: NTS

Tree Planting

1. CUT AND REMOVE TOP 1/3 OF BURLAP AND WIRE BASKET FROM ROOTBALL.
2. PLACE 2-METAL POSTS (40 x 40 x 2100 mm) AT OUTSIDE OF ROOTBALL AND FASTEN TO TRUNK WITH APPROVED TREE TIES.
3. WATER THOROUGHLY SUBSEQUENT TO PLANTING.
4. WRAP TREE TRUNK AFTER INSPECTION OF TREES BY LANDSCAPE ARCHITECT.
5. PROTECT TREE FROM RODENT DAMAGE.
6. REMOVE TREE RINGS, STAKES AND TRUNK WRAPPING AFTER WARRANTY PERIOD.

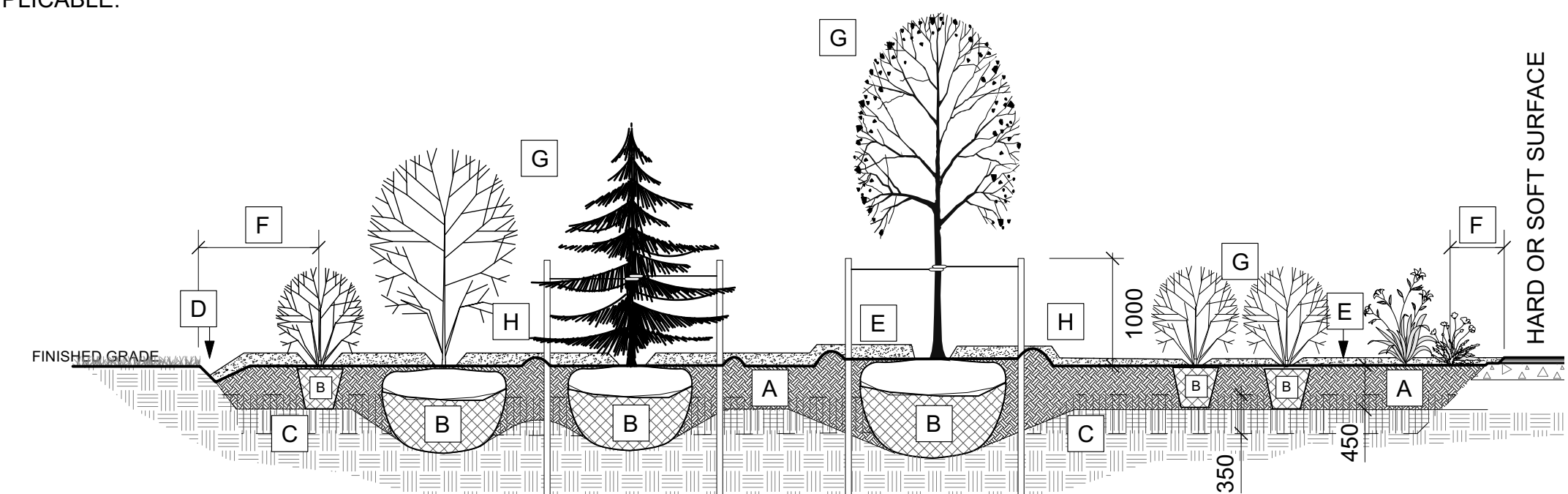

- NOTES:**
- PLANTING BED AREAS EXCAVATED TO 500mm BELOW FINAL GRADE FOR ROUGH GRADE.
 - REFER TO PLANT LIST FOR PLANT SPACING.

5		
4		
3		
2	ISSUED FOR TENDER: ADDENDUM 1	2021/06/15
1	ISSUED FOR TENDER	2021/06/04
no.	revision	date

construction north	seal
--------------------	------

project
**RUSSELL TOWNSHIP
RECREATION COMPLEX
PARK PROJECT**
TOWNSHIP OF RUSSELL,
ONTARIO, CANADA

Ruhland & Associates Ltd
landscape architecture • urban design • site planning
Ph 613-224-4244 Fx 613-224-1313 info@rala.ca www.rala.ca

drawing title PLANTING DETAILS	
scale AS SHOWN	drawn by AA/TF
date	checked by MR
project # 20-620	drawing number L-07
RA project # 21-1633	revision
CONTRACTOR TO VERIFY ALL DIMENSIONS AND NOTIFY THE ARCHITECT OF ANY DISCREPANCIES BEFORE WORK COMMENCES. DO NOT SCALE DRAWINGS.	

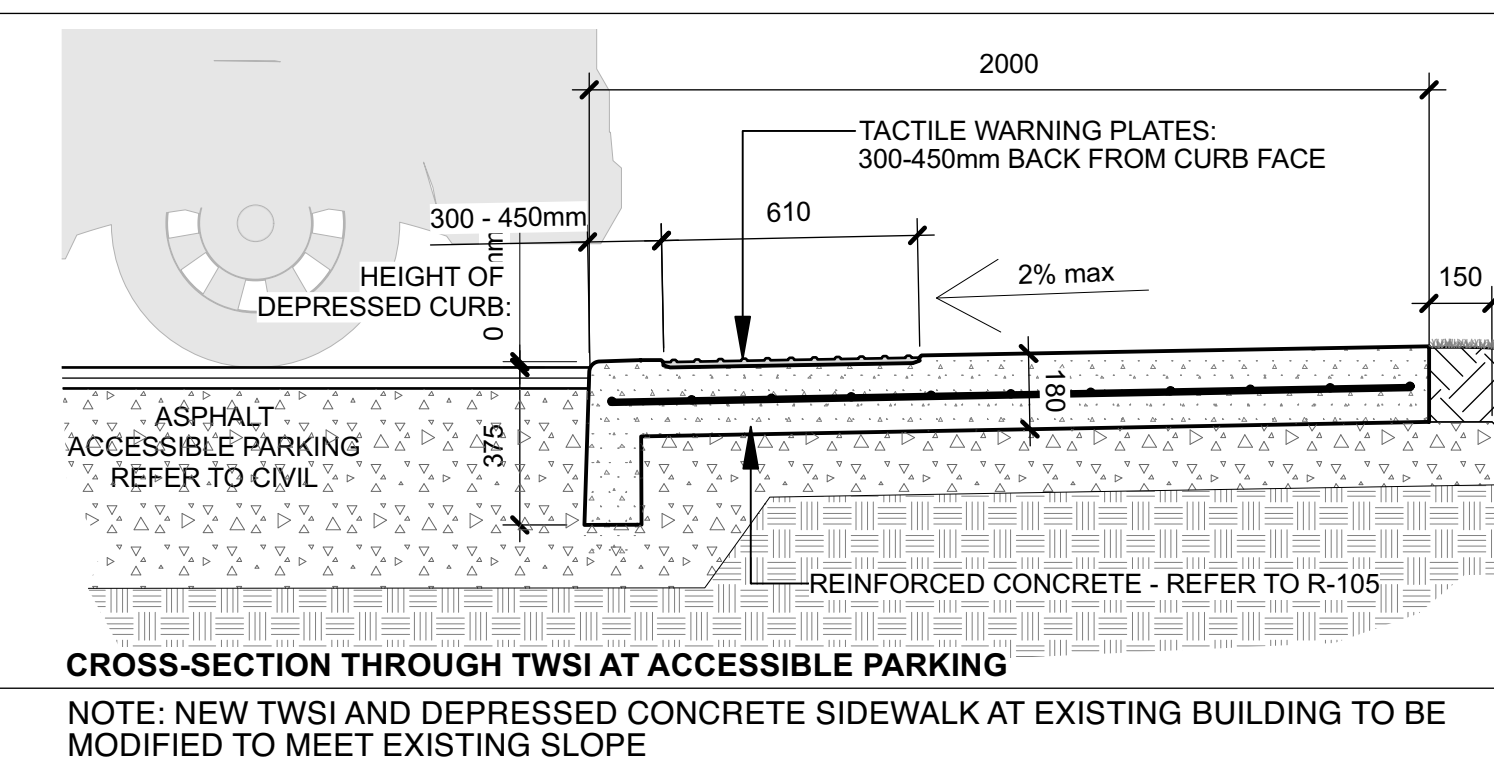
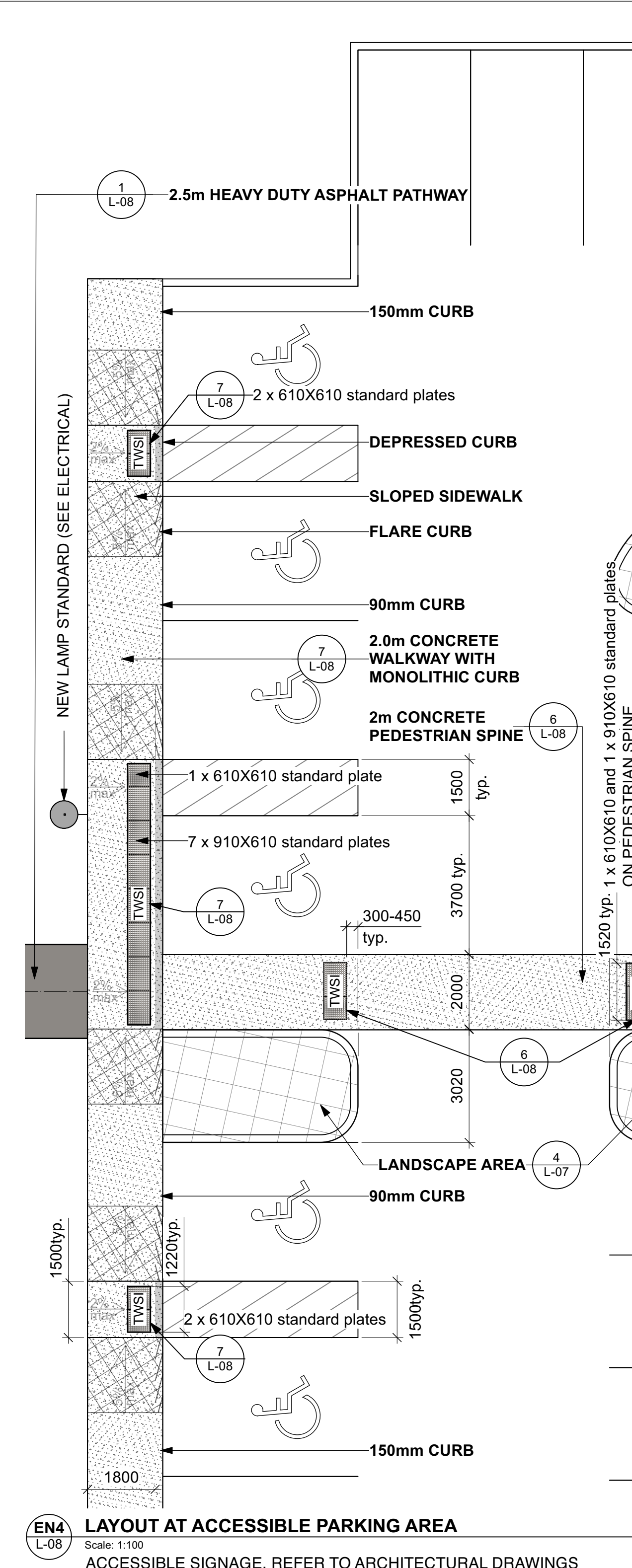
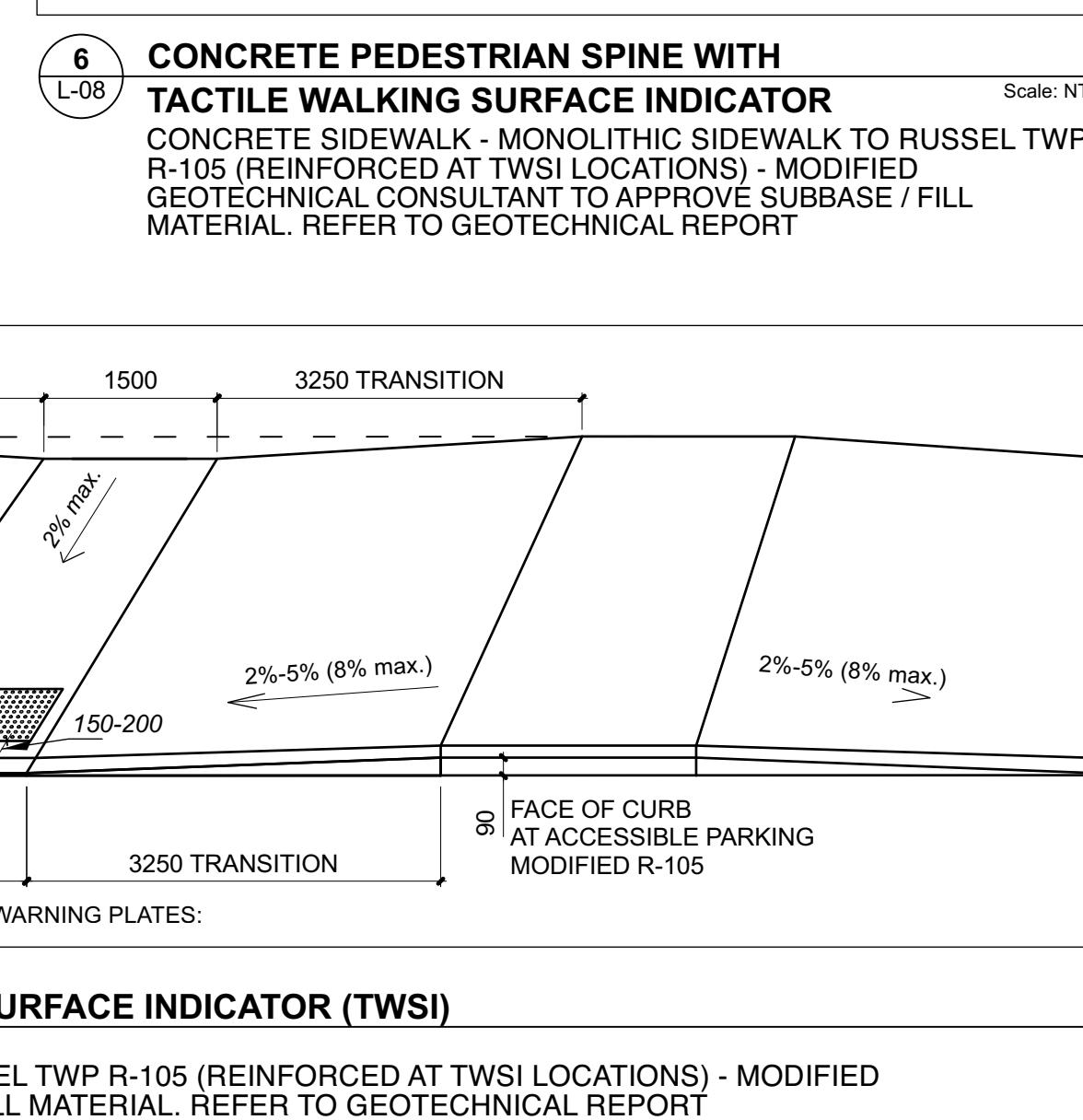
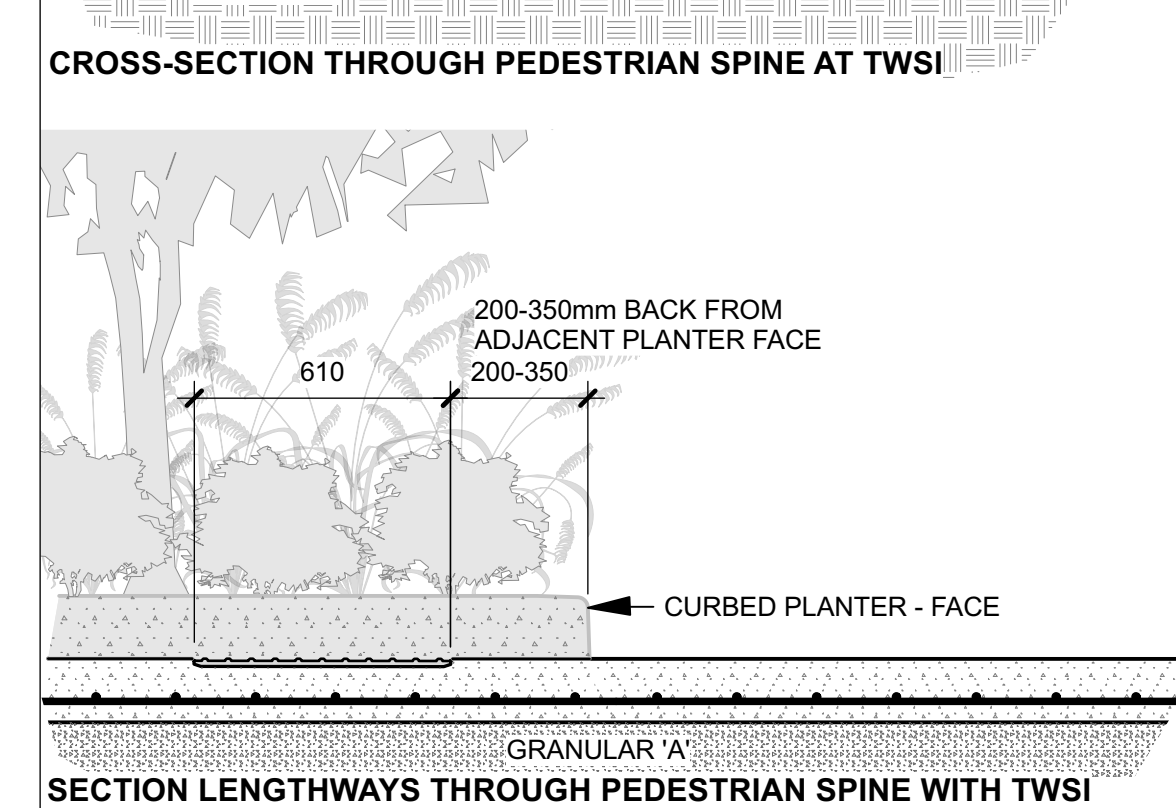
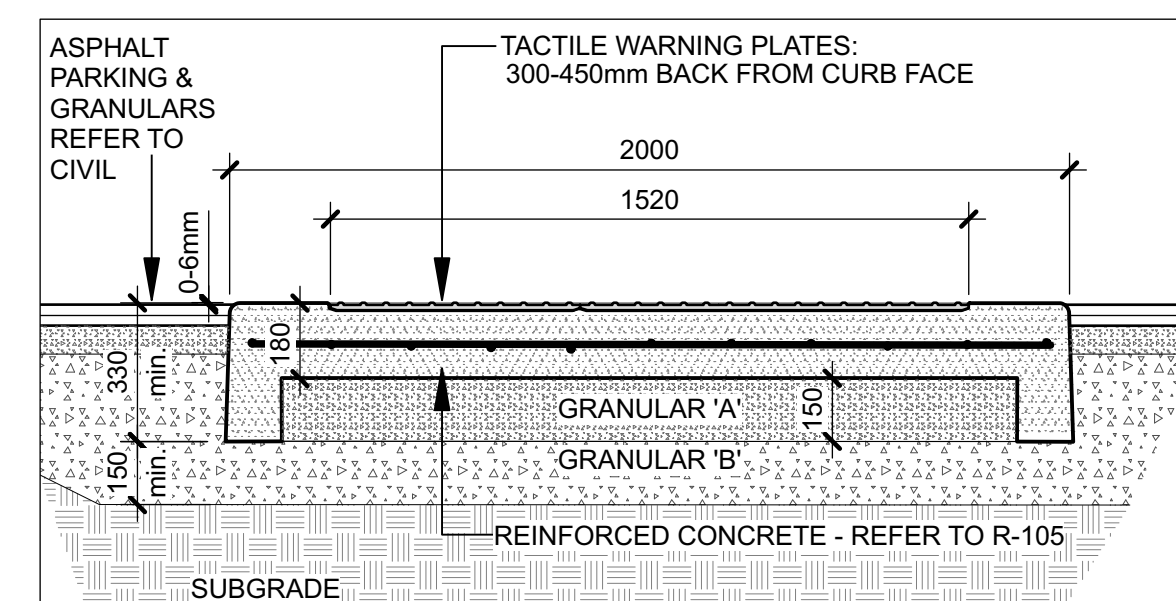
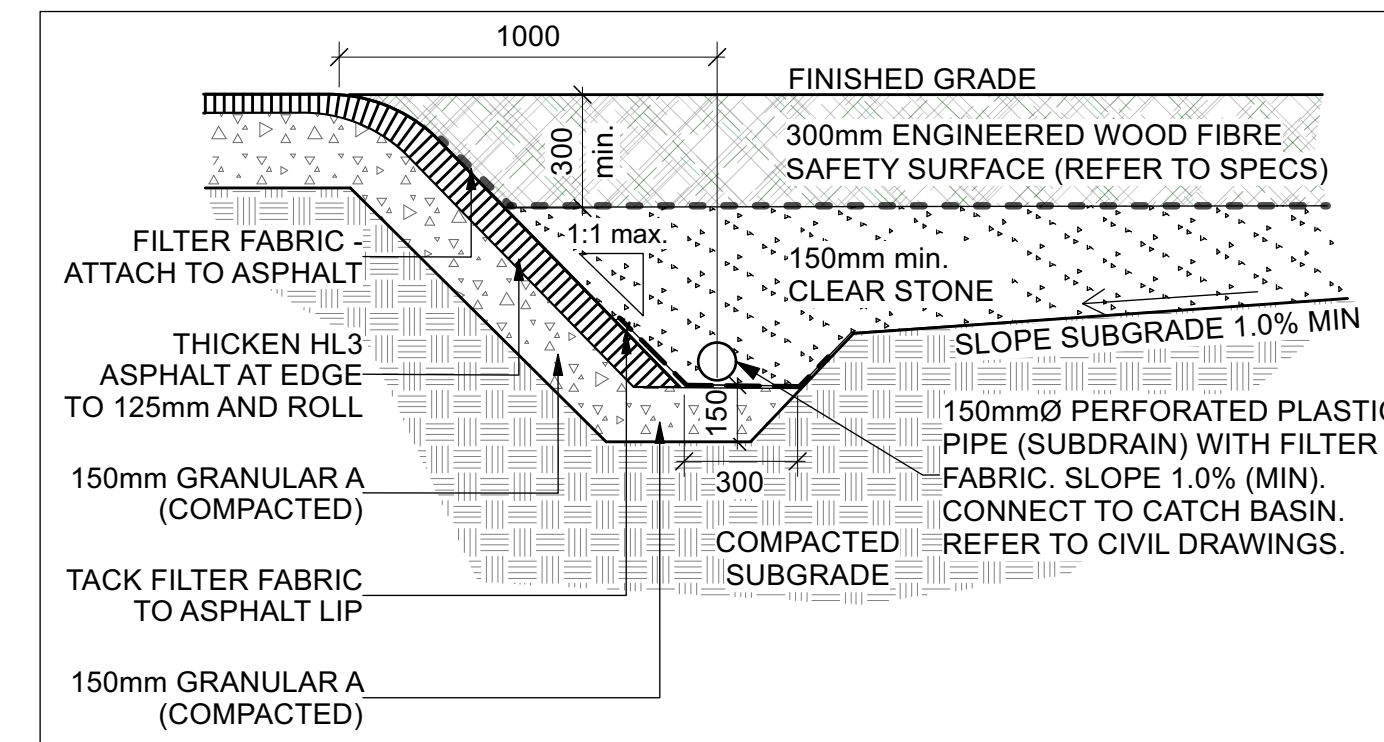
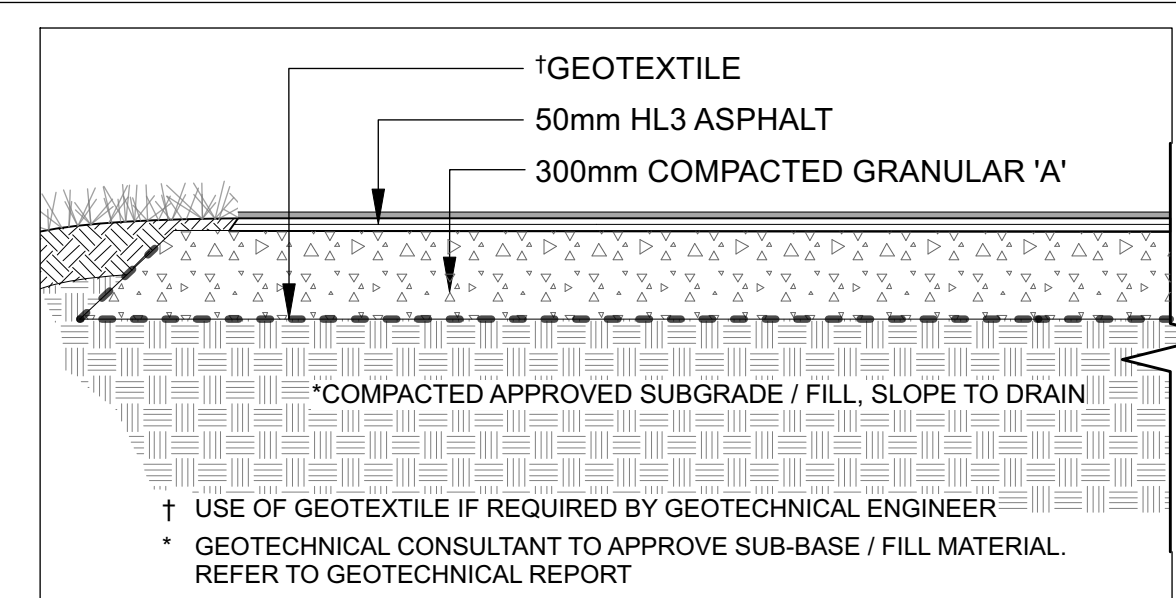
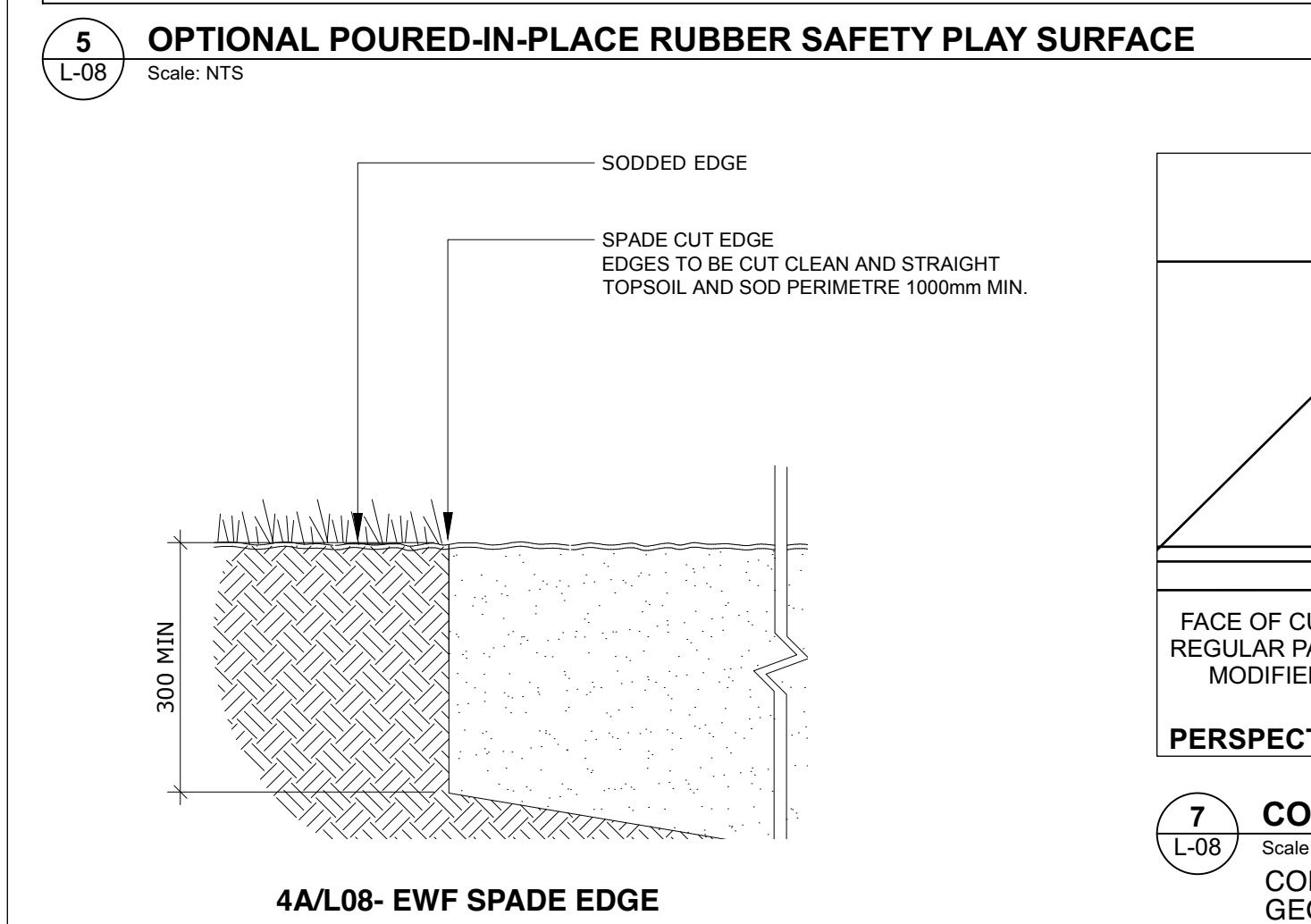
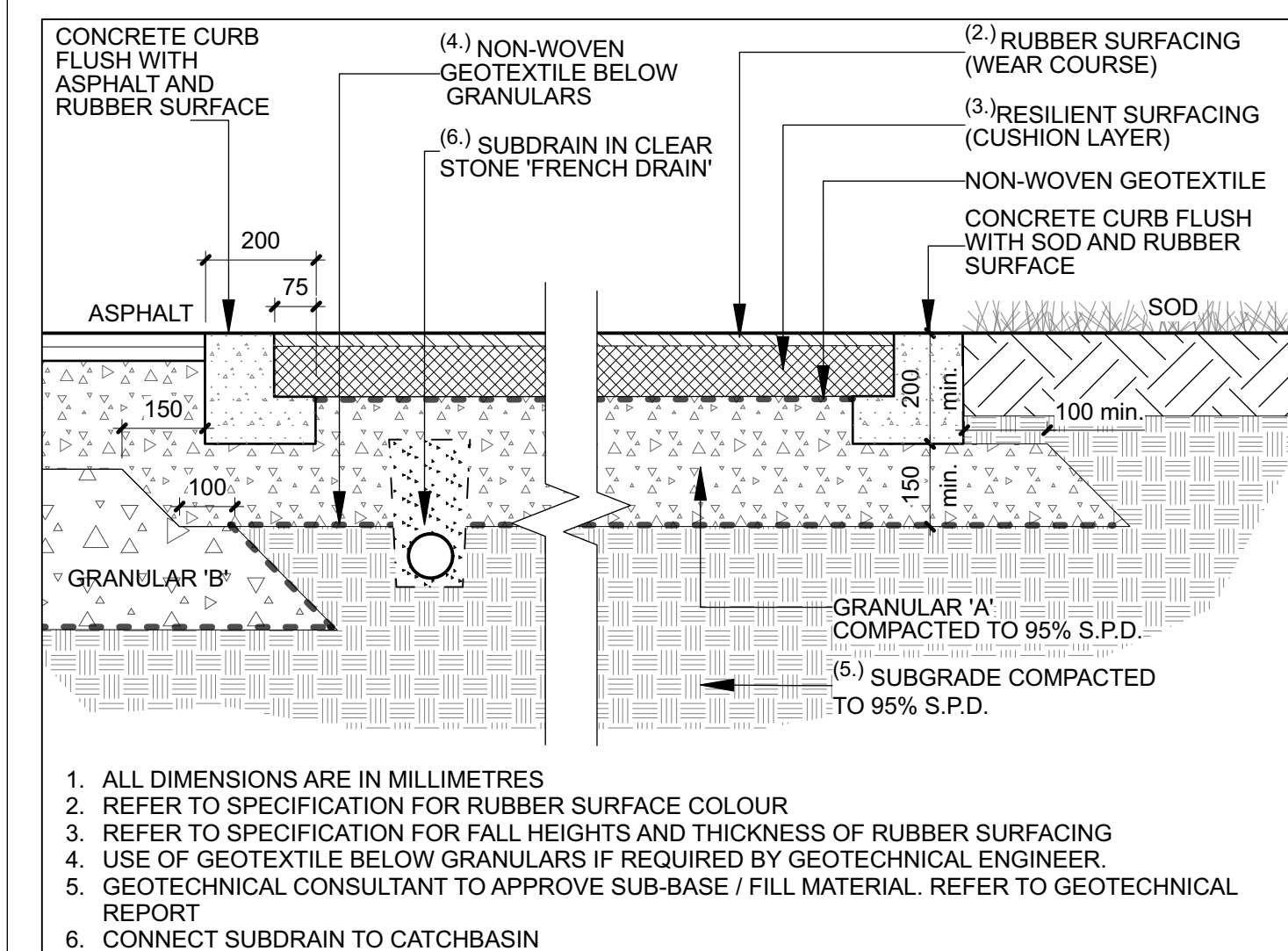
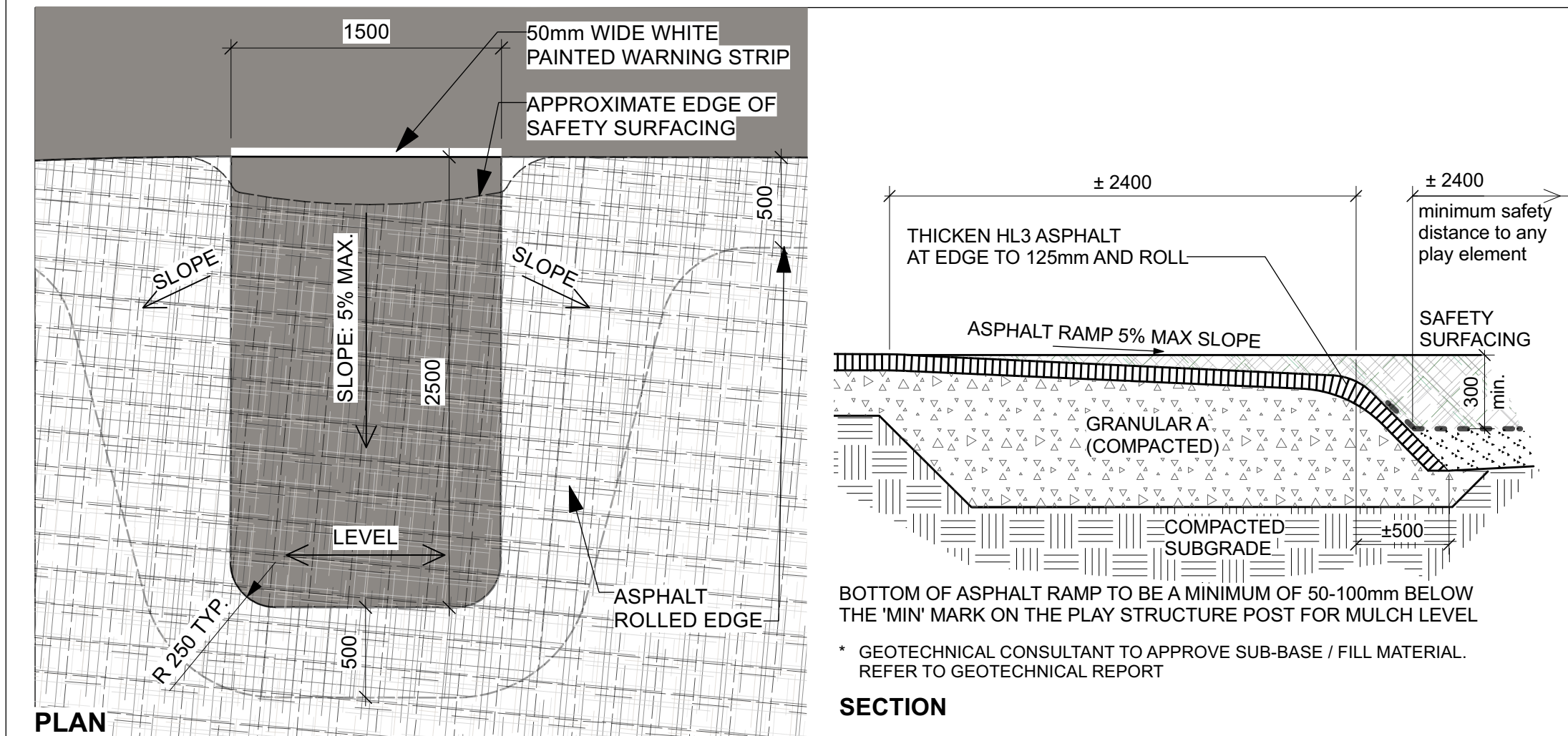
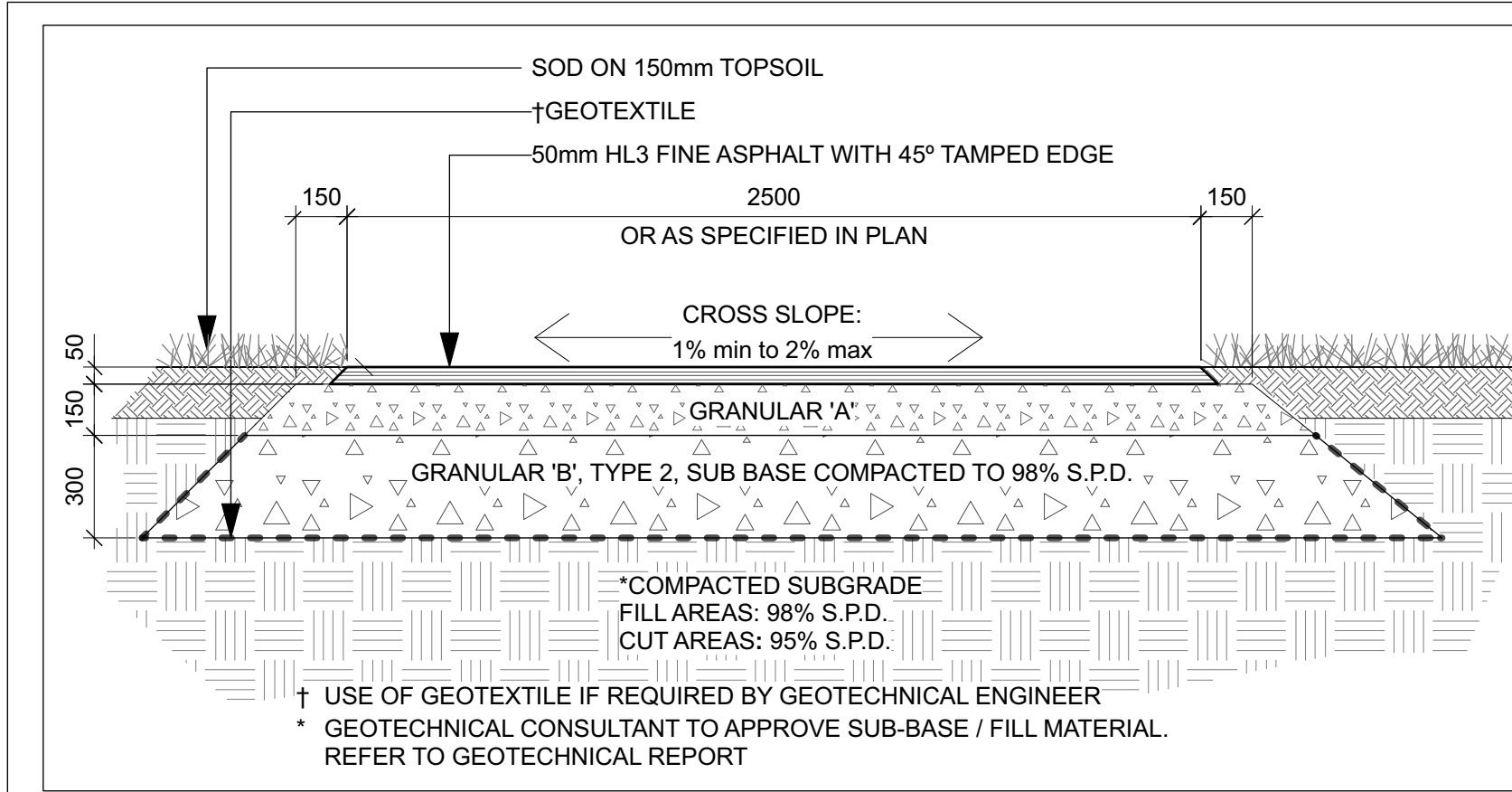

5		
4		
3		
2	ISSUED FOR TENDER: ADDENDUM 1	2021/06/15
1	ISSUED FOR TENDER	2021/06/04
no.	revision	date

construction north	seal
--------------------	------

project
RUSSELL TOWNSHIP RECREATION COMPLEX PARK PROJECT
TOWNSHIP OF RUSSELL, ONTARIO, CANADA

Ruhland & Associates Ltd
landscape architecture • urban design • site planning
Ph 613-222-4244 Fx 613-224-1111 info@rala.ca www.rala.ca

drawing title	ACCESSIBLE PARKING LAYOUT & HARD SURFACE DETAILS		
scale	AS SHOWN	drawn by	AA/TF
date		checked by	MR
project #	20-620	drawing number	L-08
RA project #	21-1633	revision	
CONTRACTOR TO VERIFY ALL DIMENSIONS AND NOTIFY THE ARCHITECT OF ANY DISCREPANCIES BEFORE WORK COMMENCES. DO NOT SCALE DRAWINGS.			